

# DISPLAY THIS CARD ON PRINCIPAL FRONTAGE OF WORK CITY OF PORTLAND

## BUILDING INSPECTION

Please Read Application And Notes, If Any, Attached

Permit Number: 061516

**PERMIT ISSUED**  
NOV - 9 2006  
CITY OF PORTLAND

This is to certify that WINSON ANDREA E & ROYALD H ITS / Joe Folsom  
has permission to Remove wall and enlarge window in kitchen and bathroom renovations

AT 34 BERKELEY ST CE 131 H019001

provided that the person or persons, firm or corporation accepting this permit shall comply with all of the provisions of the Statutes of the State and of the Ordinances of the City of Portland regulating the construction, maintenance and use of buildings and structures, and of the application on file in this department.

Apply to Public Works for street line and grade if nature of work requires such information.

Notification of inspection must be given and when permission procured before this building or part thereof is altered or otherwise closed-in. 24 HOUR NOTICE REQUIRED.

A certificate of occupancy must be procured by owner before this building or part thereof is occupied.

### OTHER REQUIRED APPROVALS

Fire Dept. \_\_\_\_\_  
Health Dept. \_\_\_\_\_  
Appeal Board \_\_\_\_\_  
Other \_\_\_\_\_  
Department Name

*[Signature]*  
11/3/06  
Director - Building & Inspection Services

**PENALTY FOR REMOVING THIS CARD**

**City of Portland, Maine - Building or Use Permit Application**

389 Congress Street, 04101 Tel: (207) 874-8703, Fax: (207) 874-8716

Permit No: 06-1516	Issue Date:	CBL: 131 H019001
-----------------------	-------------	---------------------

Location of Construction: 34 BERKELEY ST	Owner Name: WINSON ANDREA E & RONALD	Owner Address: 34 BERKELEY ST	Phone:
Business Name:	Contractor Name: Joe Folsom	Contractor Address: 12 Raymond Raymond	Phone: 2078311378
Lessee/Buyer's Name	Phone:	Permit Type: Alterations - Dwellings	Zone: R-5

Past Use: Single Family	Proposed Use: Single Family remove wall and enlarge window in kitchen and bathroom renovations	Permit Fee: \$590.00	Cost of Work: \$57,000.00	CEO District: 4
----------------------------	---	-------------------------	------------------------------	--------------------

**Proposed Project Description:**  
Remove wall and enlarge window in kitchen and bathroom renovations

**FIRE DEPT:**  Approved  Denied  
Signature: *[Signature]*

**INSPECTION:**  
Use Group: R-3 Type: SB  
IRC 2003  
Signature: *[Signature]*

**PEDESTRIAN ACTIVITIES DISTRICT (P.A.D.)**  
Action:  Approved  Approved w/Conditions  Denied  
Signature: \_\_\_\_\_ Date: \_\_\_\_\_

Permit Taken By: dmartin	Date Applied For: 10/16/2006	<b>Zoning Approval</b>
-----------------------------	---------------------------------	------------------------

- This permit application does not preclude the Applicant(s) from meeting applicable State and Federal Rules.
- Building permits do not include plumbing, septic or electrical work.
- Building permits are void if work is not started within six (6) months of the date of issuance. False information may invalidate a building permit and stop all work..

Special Zone or Reviews	Zoning Appeal	Historic Preservation
<input type="checkbox"/> Shoreland	<input type="checkbox"/> Variance	<input checked="" type="checkbox"/> Not in District or Landmark
<input type="checkbox"/> Wetland	<input type="checkbox"/> Miscellaneous	<input type="checkbox"/> Does Not Require Review
<input type="checkbox"/> Flood Zone	<input type="checkbox"/> Conditional Use	<input type="checkbox"/> Requires Review
<input type="checkbox"/> Subdivision	<input type="checkbox"/> Interpretation	<input type="checkbox"/> Approved
<input type="checkbox"/> Site Plan	<input type="checkbox"/> Approved	<input type="checkbox"/> Approved w/Conditions
Major <input type="checkbox"/> Minor <input type="checkbox"/> MM <input type="checkbox"/>	<input type="checkbox"/> Denied	<input type="checkbox"/> Denied
Date: <i>10/23/06</i>	Date: _____	Date: _____

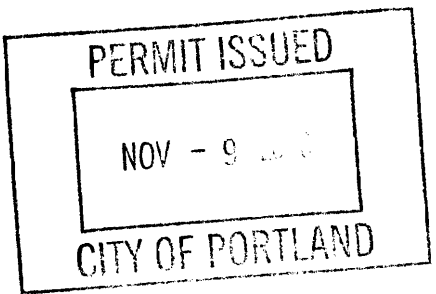

**CERTIFICATION**

I hereby certify that I am the owner of record of the named property, or that the proposed work is authorized by the owner of record and that I have been authorized by the owner to make this application as his authorized agent and I agree to conform to all applicable laws of this jurisdiction. In addition, if a permit for work described in the application is issued, I certify that the code official's authorized representative shall have the authority to enter all areas covered by such permit at any reasonable hour to enforce the provision of the code(s) applicable to such permit.

SIGNATURE OF APPLICANT	ADDRESS	DATE	PHONE
RESPONSIBLE PERSON IN CHARGE OF WORK, TITLE		DATE	PHONE



# General Building Permit Application

If you or the property owner owes real estate or personal property taxes or user charges on any property within the City, payment arrangements must be made before permits of any kind are accepted.

Location/Address of Construction: <u>34 Berkeley St. Portland, ME 04103</u>		
Total Square Footage of Proposed Structure		Square Footage of Lot
Tax Assessor's Chart, Block & Lot Chart#      Block#      Lot#	Owner: <u>Ronald Winson</u>	Telephone: <u>773-8523</u>
<u>x131      H      019</u>		
Lessee/Buyer's Name (If Applicable)	Applicant name, address & telephone: <u>Ronald Winson 34 Berkeley Street Portland, ME 04103</u>	Cost Of Work: \$ <u>57,000</u> Fee: \$ <u>590.00</u> C of O Fee: \$ <u>N/A</u>
Current Specific use: <u>SF</u>		
If vacant, what was the previous use? _____		
Proposed Specific use: _____		
Project description: <u>enlarge window in kitchen &amp; Bath Renovation remove one wall in kitchen</u>		
Contractor's name, address & telephone: <u>Joe Folsom 12 Raymond Hill Rd Raymond, ME 04071</u>		
Who should we contact when the permit is ready: <u>Ron Winson</u>		<u>831-1378</u>
Mailing address: <u>34 Berkeley St Portland ME 04103</u>		Phone: <u>773-8523</u>

Please submit all of the information outlined in the Commercial Application Checklist. Failure to do so will result in the automatic denial of your permit.

In order to be sure the City fully understands the full scope of the project, the Planning and Development Department may request additional information prior to the issuance of a permit. For further information visit us on-line at [www.portlandmaine.gov](http://www.portlandmaine.gov), stop by the Building Inspections office, room 315 City Hall or call 874-8703.

I hereby certify that I am the Owner of record of the named property, or that the owner of record authorizes the proposed work and that I have been authorized by the owner to make this application as his/her authorized agent. I agree to conform to all applicable laws of this jurisdiction. In addition, if a permit for work described in this application is issued, I certify that the Code Official's authorized representative shall have the authority to enter all areas covered by this permit at any reasonable hour to enforce the provisions of the codes applicable to this permit.

DEPT. OF BUILDING INSPECTION CITY OF PORTLAND, ME Signature of applicant: <u>Ronald H. Winson</u>	Date: <u>10/16/06</u>
---	-----------------------

OCT 16 2006

**RECEIVED**  
This is not a permit; you may not commence ANY work until the permit is issued.

*cc*

**City of Portland, Maine - Building or Use Permit**

389 Congress Street, 04101 Tel: (207) 874-8703, Fax: (207) 874-8716

<b>Permit No:</b> 06-1516	<b>Date Applied For:</b> 10/16/2006	<b>CBL:</b> 131 H019001
------------------------------	--	----------------------------

<b>Location of Construction:</b> 34 BERKELEY ST	<b>Owner Name:</b> WINSON ANDREA E & RONALD	<b>Owner Address:</b> 34 BERKELEY ST	<b>Phone:</b>
<b>Business Name:</b>	<b>Contractor Name:</b> Joe Folsom	<b>Contractor Address:</b> 12 Raymond Raymond	<b>Phone:</b> (207) 831-1378
<b>Lessee/Buyer's Name</b>	<b>Phone:</b>	<b>Permit Type:</b> Alterations - Dwellings	

<b>Proposed Use:</b> Single Family remove wall and enlarge window in kitchen and bathroom renovations	<b>Proposed Project Description:</b> Remove wall and enlarge window in kitchen and bathroom renovations
--	--

**Dept:** Zoning      **Status:** Approved with Conditions      **Reviewer:** Marge Schmuckal      **Approval Date:** 10/23/2006**Note:** **Ok to Issue:** 

- 1) This is NOT an approval for an additional dwelling unit. You SHALL NOT add any additional kitchen equipment including, but not limited to items such as stoves, microwaves, refrigerators, or kitchen sinks, etc. Without special approvals.
- 2) This property shall remain a single family dwelling. Any change of use shall require a separate permit application for review and approval.
- 3) This permit is being approved on the basis of plans submitted. Any deviations shall require a separate approval before starting that work.

**Dept:** Building      **Status:** Approved with Conditions      **Reviewer:** Tammy Munson      **Approval Date:** 11/03/2006**Note:** **Ok to Issue:** 

- 1) Separate permits are required for any electrical, plumbing, or HVAC systems. Separate plans may need to be submitted for approval as a part of this process.
- 2) Permit approved based on the plans submitted and reviewed w/owner/contractor, with additional information as agreed on and as noted on plans.
- 3) The design load spec sheets for any engineered beam(s) must be submitted to this office.

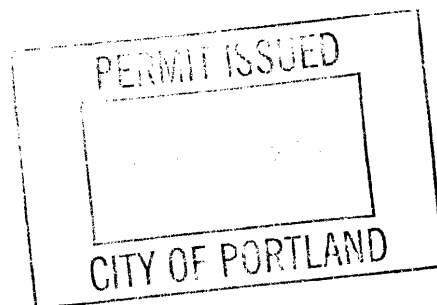

From: Theresa Folsom <TFolsom@maine.rr.com>  
 Subject: **drawing**  
 Date: October 16, 2006 8:48:27 AM EDT  
 To: rwinson@maine.rr.com  
 1 Attachment, 142 KB

Hello!  
 I've attached the drawing that Joe sketched, but please call if for some reason you can't open the file. I also have Levi's email:  
[levitrobinson@yahoo.com](mailto:levitrobinson@yahoo.com)

Thanks so much!  
 Theresa Folsom  
 655-7282

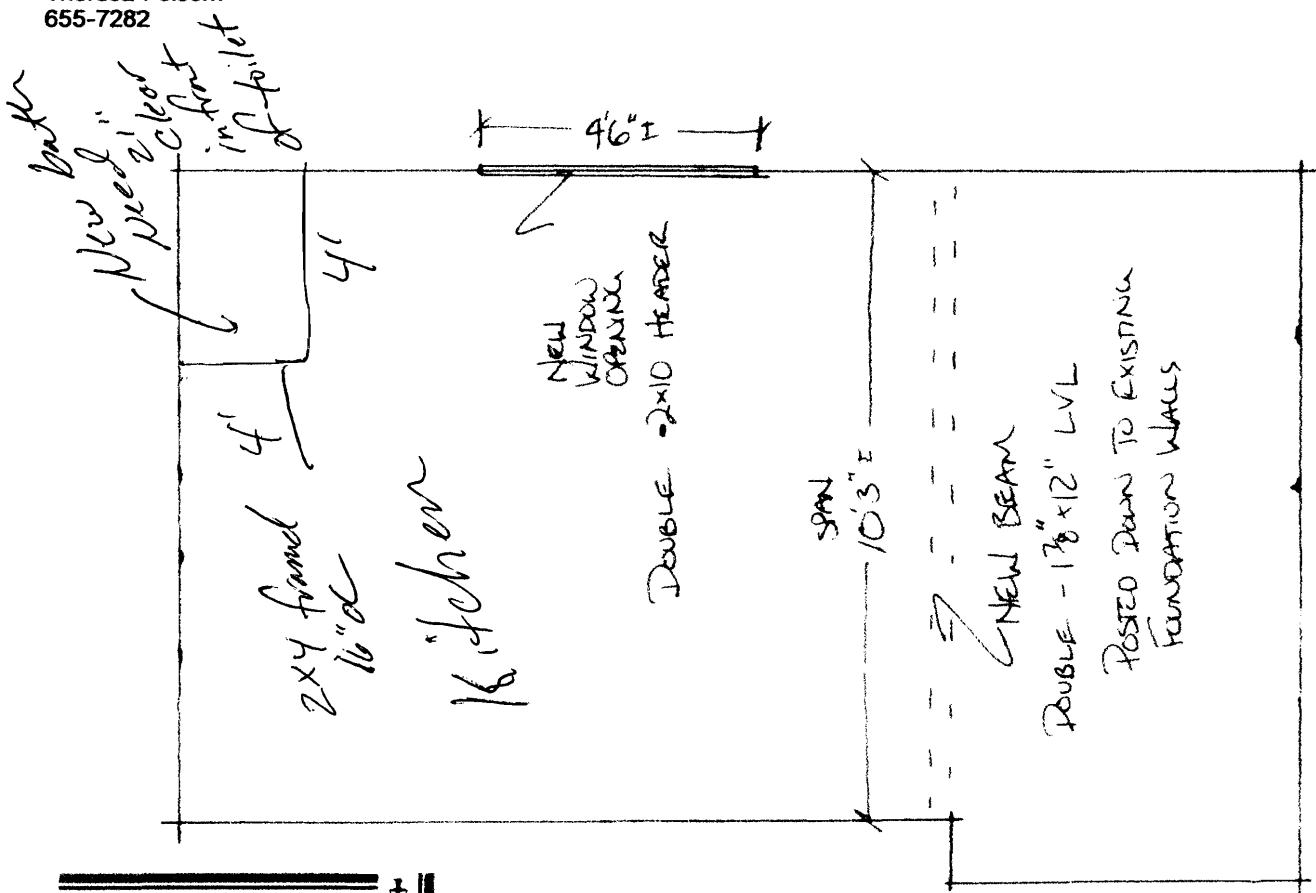

**FOLSON'S WOODSHOP, INC.**  
 Specializing in Cabinetry and Furniture

1240 Main St.  
 Portland, ME 04101  
 207-773-1234  
 207-773-1235

RON & ANDREA WINSON  
 34 BERKLEY STREET  
 PORTLAND, ME. 773-8523

Folsom's Woodshop  
 12 Raymond Hill Rd.  
 Raymond ME.  
 CONTACT # 831-1378  
 Joe

