

DISPLAY THIS CARD ON PRINCIPAL FRONTAGE OF WORK CITY OF PORTLAND

BUILDING INSPECTION

PERMIT

Permit Number: 050691

Please Read Application And Notes, if Any, Attached

This is to certify that Love Gregory F & /no contractor / self
has permission to repair rot on corner of house
AT 39 Lawn Ave Call 131 F005001

provided that the person or persons, firm or corporation accepting this permit shall comply with all of the provisions of the Statutes of Maine and of the ordinances of the City of Portland regulating the construction, maintenance and use of buildings and structures, and of the application on file in this department.

Notification of inspection must be given and written permission procured before this building or part thereof is altered or closed-in. **HEAVY NOTICE IS REQUIRED.**

A certificate of occupancy must be procured by owner before this building or part thereof is occupied.

Apply to Public Works for street line and grade if nature of work requires such information.

PERMIT ISSUED

OTHER REQUIRED APPROVALS

Fire Dept. _____

Health Dept. _____

Appeal Board _____

Other _____

JUN 3 2005

CITY OF PORTLAND

[Handwritten Signature] **6/3/05**
Director - Building Inspection Services

PENALTY FOR REMOVING THIS CARD

City of Portland, Maine - Building or Use Permit Application
 389 Congress Street, 04101 Tel: (207) 874-8703, Fax: (207) 874-8716

PERMIT ISSUED	
Permit No: 05-0691	Issue Date: JUN 3 2005
CB#: 111 F005001	
Owner Address: 39 Lawn Ave	Phone:
Contractor Address: Portland	Phone:

Location of Construction: 39 Lawn Ave	Owner Name: Love Gregory F &
Business Name:	Contractor Name: no contractor / self
Lessee/Buyer's Name	Phone:

Permit Type: Alterations - Dwellings	Zone: R-5
---	--------------

Past Use:	Proposed Use: single family - repair rot on corner of house
-----------	--

\$30.00	\$1,000.00	4
FIRE DEPT: <input type="checkbox"/> Approved <input type="checkbox"/> Denied <i>N/A</i>	INSPECTION: Use Group <i>R-3</i> Type <i>SB</i> <i>IRC 2003</i>	
Signature:	Signature:	
PEDESTRIAN ACTIVITIES DISTRICT (P.A.D.)		
Action: <input type="checkbox"/> Approved <input type="checkbox"/> Approved w/Conditions <input type="checkbox"/> Denied		
Signature:	Date:	

Proposed Project Description: repair rot on corner of house
--

Permit Taken By: tmm	Date Applied For: 06/03/2005
-------------------------	---------------------------------

Zoning Approval		
Special Zone or Reviews <input type="checkbox"/> Shoreland <input type="checkbox"/> Wetland <input type="checkbox"/> Flood Zone <input type="checkbox"/> Subdivision <input type="checkbox"/> Site Plan Maj <input type="checkbox"/> Minor <input type="checkbox"/> MM <input type="checkbox"/> Date: <i>6/3/05</i>	Zoning Appeal <input type="checkbox"/> Variance <input type="checkbox"/> Miscellaneous <input type="checkbox"/> Conditional Use <input type="checkbox"/> Interpretation <input type="checkbox"/> Approved <input type="checkbox"/> Denied Date:	Historic Preservation <input checked="" type="checkbox"/> Not in District or Landmark <input type="checkbox"/> Does Not Require Review <input type="checkbox"/> Requires Review <input type="checkbox"/> Approved <input type="checkbox"/> Approved w/Conditions <input type="checkbox"/> Denied Date: <i>6/3/05</i>

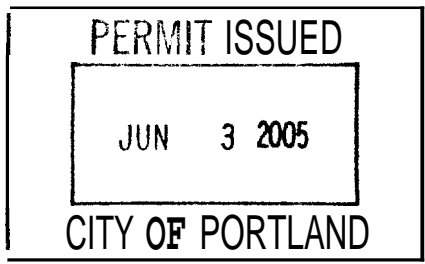

CERTIFICATION

I hereby certify that I am the owner of record of the named property, or that the proposed work is authorized by the owner of record and that I have been authorized by the owner to make this application as his authorized agent and I agree to conform to all applicable laws of this jurisdiction. In addition, if a permit for work described in the application is issued, I certify that the code official's authorized representative shall have the authority to enter all areas covered by such permit at any reasonable hour to enforce the provision of the code(s) applicable to such permit.

SIGNATURE OF APPLICANT	ADDRESS	DATE	PHONE
RESPONSIBLE PERSON IN CHARGE OF WORK, TITLE		DATE	PHONE



This page contains a detailed description of the Parcel ID you selected. Press the **New Search** button at the bottom of the screen to submit a new query.

Current Owner Information

Card Number	1 of 1
Parcel ID	L3L F005001
Location	39 LAWN AVE
Land Use	SINGLE FAMILY
Owner Address	LOVE GREGORY F 8 NARA E LOVE JTS 39 LAWN AVE PORTLAND ME 04103
Book/Page	21743/032
Legal	131-F-5 LAWN AVE 37-42 5355 SF

Current Valuation Information

Land	Building	Total
\$30,450	\$113,930	\$144,380

New Estimated Valuation Information

Land	Building	Total	Phase-In Value
\$86,200	\$256,800	\$343,000	\$243,690

Property Information

Year Built	Style	Story Height	sq. Ft.	Total Acres		
1910	Old Style	2	2685	0.123		
Bedrooms	Pull Baths	Half Baths	Total Rooms	Attic	Basement	
6	1		10	Full Finsh	Full	

Outbuildings

Type	Quantity	Year Built	Size	Grade	Condition
GARAGE-WD/CB	1	1910	18X18	C	A
SHED-FRAIE	1	1950	6X9	D	A

Sales Information

Date	Type	Price	Book/Page
09/02/2004	LAND + BLDING	\$320,000	21743-32

Picture and Sketch

Picture Sketch Tax Map

[Click here to view Tax Roll Information.](#)

Any information concerning tax payments should be directed to the Treasury office at 874-8490 or e-mailed.

[Click here to view comparable sales or below to view by:](#)



Residential Building Permit Application

If you or the property owner owes real estate or personal property taxes or user charges on any property within the City, payment arrangements must be made before permits of any kind are accepted.

Location/Address of Construction- 39 Lawn Ave.

Total Square Footage of Proposed Structure 0

Square Footage of Lot 5358

Tax Assessor's Chart, Block & Lot
Chart# 131 Block# F Lot# 5

Owner:
Greg + Mara Love

Telephone:
207-838-0493

Lessee/Buyer's Name (If Applicable)

Applicant name, address & telephone:
Greg + Mara Love
39 Lawn Ave
Portland, ME 04103
207-899-0493

Cost Of
Work: \$ ~~1000.00~~
\$ 650.50
Fee: \$

Current Specific use: residential

Proposed Specific use: residential

Project description: Replace lower section of rotted corner post and small section of sill at that corner. ~~Remove~~ Replace effected studs, sheathing and siding

Contractor's name, address & telephone: none

Who should we contact when the permit is ready: Mara + Greg Love

Mailing address: as above

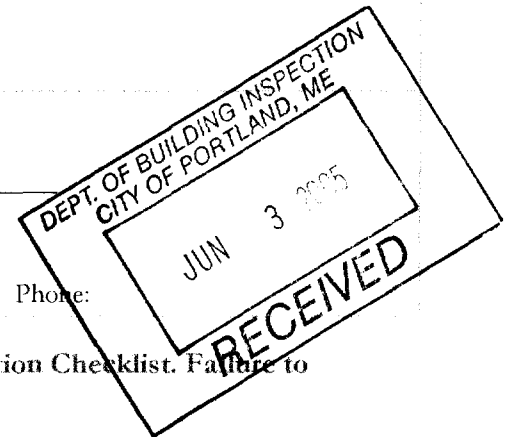

Phone:

Please submit all of the information outlined in the Residential Application Checklist. Failure to do so will result in the automatic denial of your permit.

At the discretion of the Planning and Development Department, additional information may be required prior to permit approval. For further information stop by the Building Inspections office, room 315 City Hall or call 874-8705

I hereby certify that I am the Owner of record of the named property, or that the owner of record authorizes the proposed work and that I have been authorized by the owner to make this application as his/her authorized agent. I agree to conform to all applicable laws of this jurisdiction. In addition, if a permit for work described in this application is issued, I certify that the Code Official's authorized representative shall have the authority to enter all areas covered by this permit at any reasonable hour to enforce the provisions of the codes applicable to this permit.

Signature of applicant: Mara Love

Date: 6/3/05

Permit Fee: \$30.00 for the first \$1000.00 Construction Cost, \$9.00 per additional \$1000.00 cost

This is not a Permit; you may not commence any work until the Permit is issued.

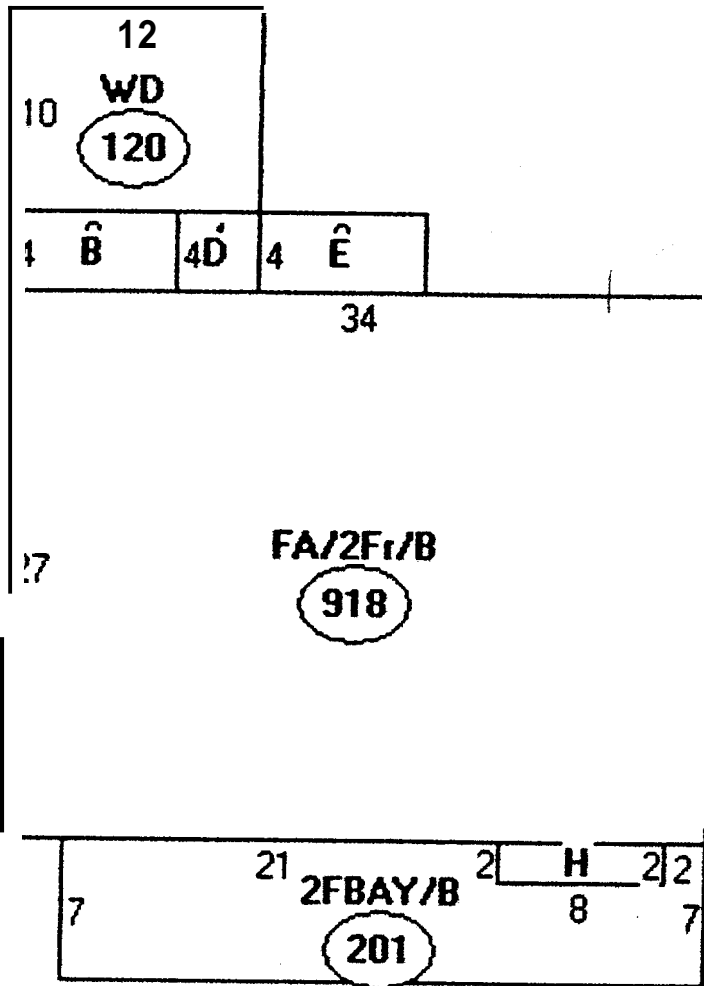

Descriptor/Area

- A: FA/2Fr/B
918 sqft
- B: OFP
32 sqft
- C: WD
120 sqft
- D: EP
16 sqft
- E: 2Fr/B
32 sqft
- F: FBAY
16 sqft
- G: 2FBAY/B
201 sqft
- H: OFP
16 sqft

DEPT. OF BUILDING INSPECTION
CITY OF PORTLAND, ME
JUN 3 2015
RECEIVED

No 131

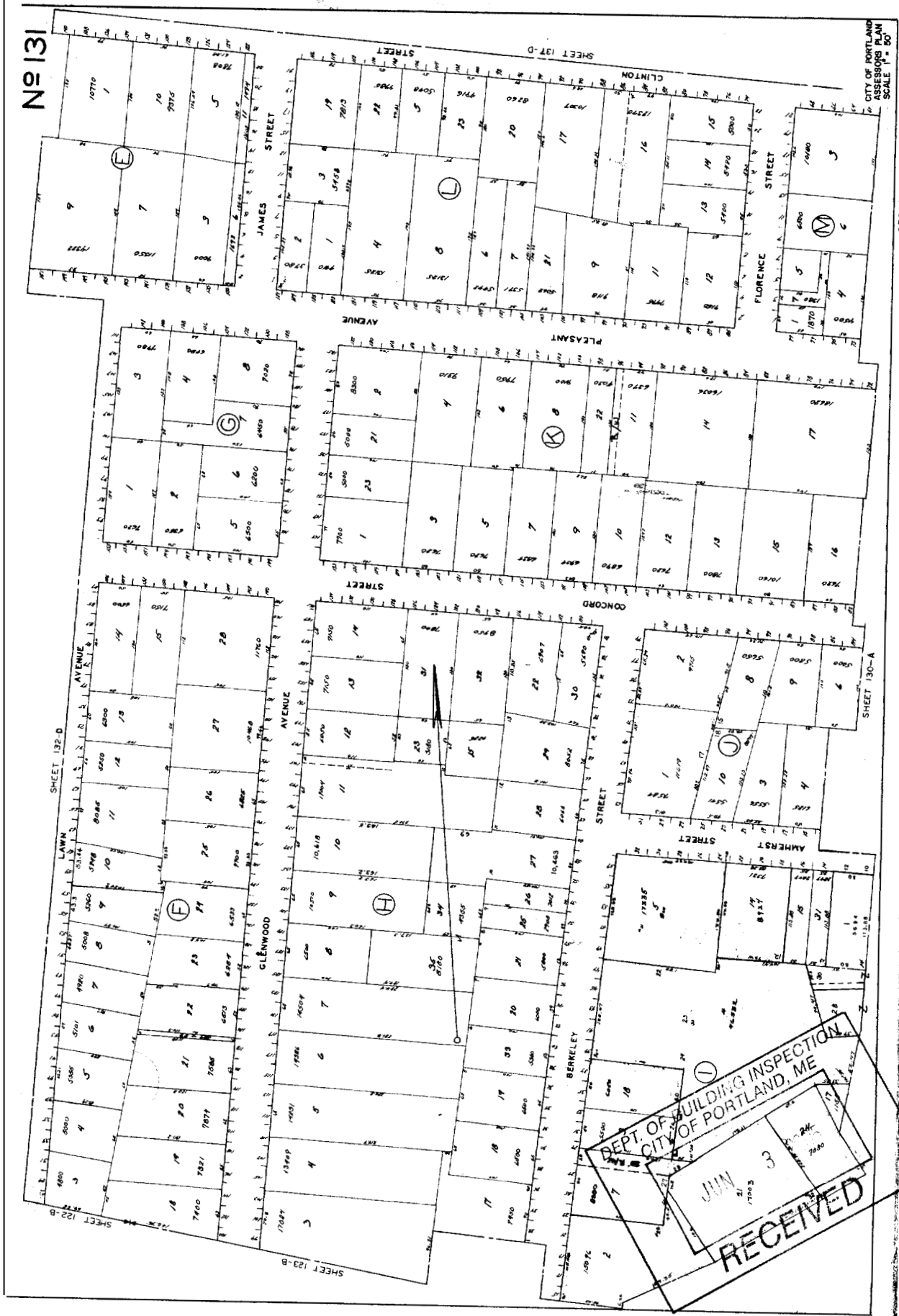

CITY OF PORTLAND
ASSESSORS PLAN
SCALE 1" = 50'

REDRAWN 10-10-66

RECEIVED
JUN 3 1903
DEPT. OF BUILDING INSPECTION
CITY OF PORTLAND, ME

City of Portland, Maine - Building or Use Permit

389 Congress Street, 04101 Tel: (207) 874-8703, Fax: (207) 874-8716

Permit No: 05-0691	Date Applied For: 06/03/2005	CBL: 131 F005001
------------------------------	--	----------------------------

Location of Construction: 39 Lawn Ave	Owner Name: Love Gregory F &	Owner Address: 39 Lawn Ave	Phone:
Business Name:	Contractor Name: no contractor / self	Contractor Address: Portland	Phone:
Lessee/Buyer's Name	Phone:	Permit Type: Alterations - Dwellings	

Proposed Use: single family - repair rot on corner of house	Proposed Project Description: repair rot on corner of house
---	---

Dept: Zoning Note:	Status: Approved	Reviewer: Tammy Munson	Approval Date: 06/03/2005 Ok to Issue: <input checked="" type="checkbox"/>
Dept: Building Note:	Status: Approved	Reviewer: Tammy Munson	Approval Date: 06/03/2005 Ok to Issue: <input type="checkbox"/>

Note:	Status:	Reviewer:	Approval Date: Ok to Issue: <input type="checkbox"/>
--------------	----------------	------------------	---

PRICE LIST

LUMBER

Qty	SIZE	ITEM		\$ Total
①	6' x 8' x 8'	Hemlock beam for sill	\$ 38.50	\$ 38.50
①	4' x 6' x 10'	PT post for corner	\$ 20.00	\$ 20.00
③	2' x 4' x 8'	PT for support	\$ 5.00 ea	\$ 15.00
②0	1" x 2" x 8'	Hemlock ceiling	\$ 3.30 ea	\$ 66.00
③0	1/2" x 6' x 8'	Red Cedar Siplap for (A)	\$ 6.00 / ft.	\$ 180.00
	1" x 6' x 10'	Pine corner board for	\$ 1.73 / ft.	\$ 18.00
	1" x 2' x 10'	Pine corner board for	\$ 2.00 / ft.	\$ 22.00
				<hr/>
				\$ 359.50

FASTENERS

③	1/2" x 10"	Larnage bolts	\$ 5.00 ea	\$ 10.00
②	1/4" x 4" x 4"	Porch knee brackets	\$ 5.00 ea	\$ 10.00
④	3/8" x 3 1/2"	bolts for PK ↑	\$ 3.00 ea	\$ 12.00
③	1/2" x 6"	bolts for sill cap	\$ 5.00 ea	\$ 30.00
②	5"	Joist hangers	\$ 5.00 ea	\$ 10.00
①	5# box 2"	Hot galv nails	\$ 8.00 ea	\$ 8.00
①	5# box 3 1/2"	Hot galv nails	\$ 10.00	\$ 10.00
				<hr/>
				\$ 90.00

OTHER

①	3' Roll	building paper	\$ 60.00	\$ 60.00
①	Quart	bora case	\$ 25.00	\$ 25.00
①	Gallon	seed linseed oil	\$ 10.00	\$ 10.00
③	3"	brushes (disposable)	\$ 3.00	\$ 6.00
				<hr/>
				101.00

Miscellaneous \$ 100.00

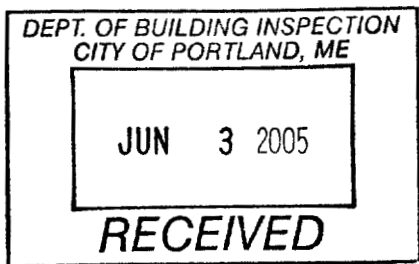

TOTAL JOB \$ 650.50

500 YARD

Side View of Steel Beam
BACK

2 6"x12" bolts
sharpened

2 6"x12" bolts (sharpened)

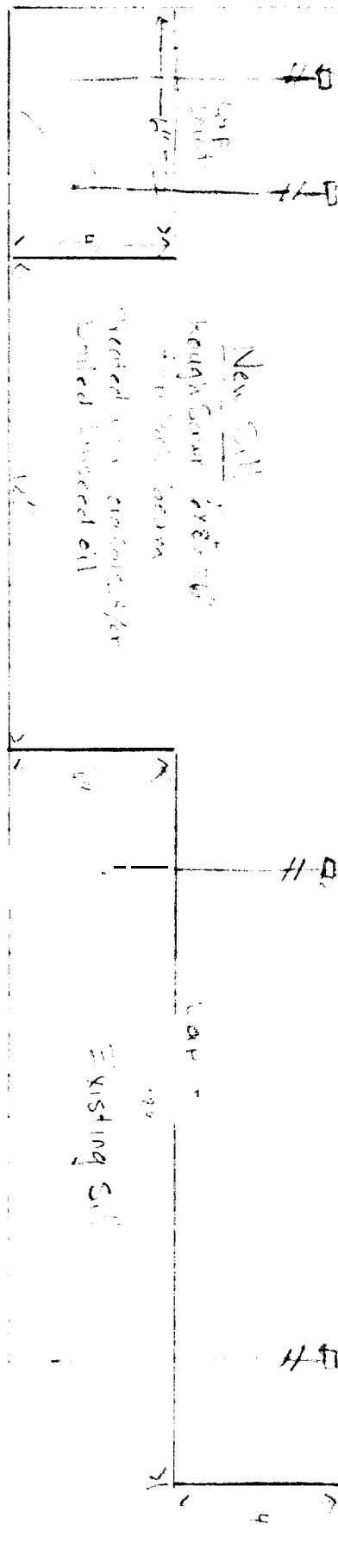

DEPT. OF BUILDING INSPECTION
CITY OF PORTLAND, ME

JUN 3 2005

RECEIVED

100 YARD

500 YARD

2 1/2" x 4" x 8"

3 1/2" x 4" x 8"

2 1/2" x 4" x 8"

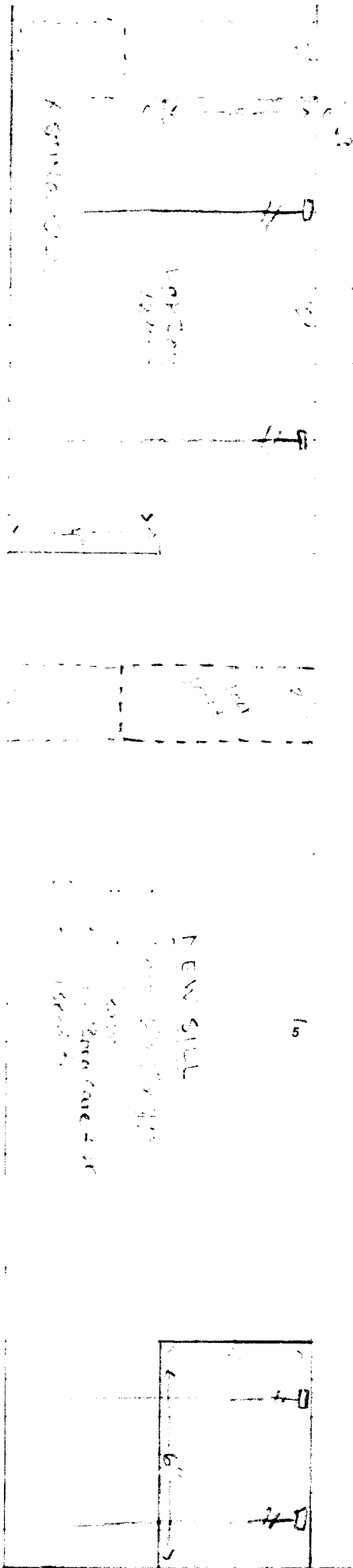

2 1/2" x 4" x 8"

SIDE VIEW OF SILL REPAIR
SIDE

DEPT. OF BUILDING INSPECTION
CITY OF PORTLAND, ME

JUN 3 2005

RECEIVED

BACK VIEWS

TOP VIEW

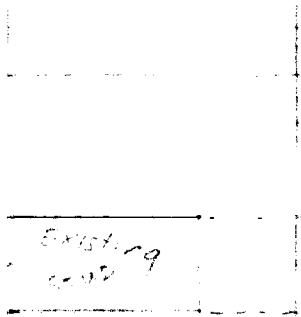

Existing

DEPT. OF BUILDING INSPECTION
 CITY OF PORTLAND, ME

JUN 3 2005

RECEIVED

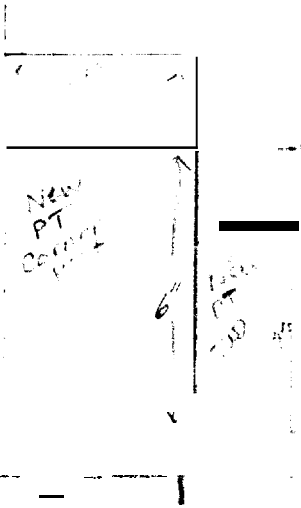

OLD TOWN
DOLLAR MOST REPAIR
FACIL

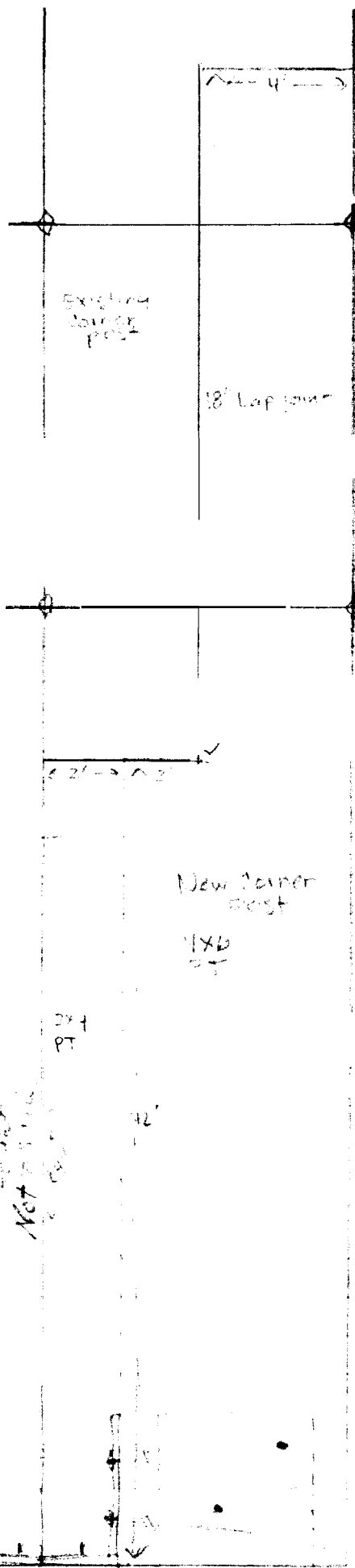

8 1/2" (102")
18x10" dimension for
corner post

↓
DO NOT
NOT TO
SCALE
↑

DEPT. OF BUILDING
CITY OF PORTLAND
JUN 3
RECEIVED

2 1/2" x 1/2" bolts
staggered
1/4" x 4" angle irons
steel brackets

← New Wall
BACKWARDS →

City of Portland, Maine - Building or Use Permit

389 Congress Street, 04101 Tel: (207) 874-8703, Fax: (207) 874-8716

Permit No: 05-0691	Date Applied For: 06/03/2005	CBL: 131 F005001
------------------------------	--	----------------------------

Location of Construction: 39 Lawn Ave	Owner Name: Love Gregory F &	Owner Address: 39 Lawn Ave	Phone:
Business Name:	Contractor Name: no contractor / self	Contractor Address: Portland	Phone:
Lessee/Buyer's Name	Phone:	Permit Type: Alterations - Dwellings	

Proposed Use: single family - repair rot on comer of house	Proposed Project Description: repair rot on comer of house
--	--

Dept: Zoning **Status:** Approved **Reviewer:** Tammy Munson **Approval Date:** 06/03/2005
Note: **Ok to Issue:**

Dept: Building **Status:** Approved **Reviewer:** Tammy Munson **Approval Date:** 06/03/2005
Note: **Ok to Issue:**

Dept: Fire **Status:** **Reviewer:** **Approval Date:** **Ok to Issue:**