

# DISPLAY THIS CARD ON PRINCIPAL FRONTAGE OF WORK CITY OF PORTLAND

## BUILDING INSPECTION

### PERMIT

Permit Number: 050525

Please Read Application And Notes, If Any, Attached

This is to certify that KLAIBER KRISTIN C & ROBERT A. PERJITS / Applicant  
has permission to add 10'x Deck  
AT 10 NINTH ST 10' x 14' 338 D005001

provided that the person or persons, firm or corporation accepting this permit shall comply with all of the provisions of the Statutes of Maine and of the ordinances of the City of Portland regulating the construction, maintenance and use of buildings and structures, and of the application on file in this department.

Apply to Public Works for street line and grade if nature of work requires such information.

Notification of inspection must be given and written permission procured before this building or part thereof is laid or closed-in. OTHER NOTICE IS REQUIRED.

A certificate of occupancy must be procured by owner before this building or part thereof is occupied.

**PERMIT ISSUED**  
OTHER REQUIRED APPROVALS  
**MAY 25 2005**  
**CITY OF PORTLAND**  
Department Name

Fire Dept. \_\_\_\_\_  
Health Dept. \_\_\_\_\_  
Appeal Board \_\_\_\_\_  
Other \_\_\_\_\_

*[Signature]*  
5/25/05  
Director - Building & Inspection Services

**PENALTY FOR REMOVING THIS CARD**

**City of Portland, Maine - Building or Use Permit Application**

389 Congress Street, 04101 Tel: (207) 874-8703, Fax: (207) 874-8716

**PERMIT ISSUED**

Permit No: 05-0325	Issue Date: <b>MAY 25 2005</b>	CBI: 338 D005001
-----------------------	-----------------------------------	---------------------

Location of Construction: 10 NINTH ST	Owner Name: KLAIBER KRISTIN C & ROBER	Owner Address: 10 NINTH ST	Phone:
Business Name:	Contractor Name: Applicant	Contractor Address: Portland	Phone:
Lessee/Buyer's Name	Phone:	Permit Type: Additions - Dwellings	Zone: <i>R-3</i>

Past Use: Single Family Home	Proposed Use: Single Family Homel add 10'x4'! <i>10'x14'</i>	Permit Fee: <b>\$30.00</b>	Cost of Work: <b>\$1,400.00</b>	CEO District: <b>5</b>
Proposed Project Description:		FIRE DEPT: <input type="checkbox"/> Approved <input checked="" type="checkbox"/> Denied <i>NA</i>	INSPECTION: Use Group. <i>R-3</i> Type. <i>SB</i> <i>IRC 2003</i>	

PEDESTRIAN ACTIVITIES DISTRICT (P.A.D.)		Signature:	Signature:
Action: <input type="checkbox"/> Approved <input type="checkbox"/> Approved w/Conditions <input checked="" type="checkbox"/> Denied	Date:		

Permit Taken By: Idobson	Date Applied For: 05/06/2005	<b>Zoning Approval</b>	
-----------------------------	---------------------------------	------------------------	--

<ol style="list-style-type: none"> <li>This permit application does not preclude the Applicant(s) from meeting applicable State and Federal Rules.</li> <li>Building permits do not include plumbing, septic or electrical work.</li> <li>Building permits are void if work is not started within six (6) months of the date of issuance. False information may invalidate a building permit and stop all work..</li> </ol>	<b>Special Zone or Reviews</b> <input type="checkbox"/> Shoreland <input type="checkbox"/> Wetland <input checked="" type="checkbox"/> Flood Zone <input type="checkbox"/> Subdivision <input type="checkbox"/> Site Plan Maj <input type="checkbox"/> Minor <input type="checkbox"/> MM <input type="checkbox"/> Date: <i>5/25/05</i>	<b>Zoning Appeal</b> <input type="checkbox"/> Variance <input type="checkbox"/> Miscellaneous <input type="checkbox"/> Conditional Use <input type="checkbox"/> Interpretation <input type="checkbox"/> Approved <input type="checkbox"/> Denied Date:	<b>Historic Preservation</b> <input checked="" type="checkbox"/> Not in District or Landmark <input type="checkbox"/> Does Not Require Review <input type="checkbox"/> Requires Review <input type="checkbox"/> Approved <input type="checkbox"/> Approved w/Conditions <input type="checkbox"/> Denied Date: <i>5/25/05</i>
---	---	---	---

**CERTIFICATION**

I hereby certify that I am the owner of record of the named property, or that the proposed work is authorized by the owner of record and that I have been authorized by the owner to make this application as his authorized agent and I agree to conform to all applicable laws of this jurisdiction. In addition, if a permit for **work** described in the application is issued, I certify that the code official's authorized representative shall have the authority to enter all areas covered by such permit at any reasonable hour to enforce the provision of the code(s) applicable to such permit.

SIGNATURE OF APPLICANT ADDRESS DATE PHONE

RESPONSIBLE PERSON IN CHARGE OF WORK, TITLE DATE PHONE

# BUILDING PERMIT INSPECTION PROCEDURES

Please call 874-8703 or 874-8693 to schedule your inspections as agreed upon

Permits expire in 6 months, if the project is not started or ceases for 6 months.

The Owner or their designee is required to notify the inspections office for the following inspections and provide adequate notice. Notice must be called in 48-72 hours in advance in order to schedule an inspection:

By initializing at each inspection time, you are agreeing that you understand the inspection procedure and additional fees from a "Stop Work Order" and "Stop Work Order Release" will be incurred if the procedure is not followed as stated below.

A Pre-construction Meeting will take place upon receipt of your building permit.

- Footing/Building Location Inspection: Prior to pouring concrete *Tube layout*
- Re-Bar Schedule Inspection: Prior to pouring concrete
- Foundation Inspection: Prior to placing ANY backfill
- Framing/Rough Plumbing/Electrical: Prior to any insulating or drywalling
- Final/Certificate of Occupancy: Prior to any occupancy of the structure or use. NOTE: There is a \$75.00 fee per inspection at this point.

Certificate of Occupancy is not required for certain projects. Your inspector can advise you if your project requires a Certificate of Occupancy. All projects DO require a final inspection

If any of the inspections do not occur, the project cannot go on to the next phase, REGARDLESS OF THE NOTICE OR CIRCUMSTANCES.

CERTIFICATE OF OCCUPANCIES MUST BE ISSUED AND PAID FOR, BEFORE THE SPACE MAY BE OCCUPIED

*x Robert J. [Signature]*  
Signature of Applicant/Designee  
Date: 5/25/05

*[Signature]*  
Signature of Inspections Official  
Date: 5/25/05

CBL: 388-105 Building Permit #: 05-0525

*2-3  
 25'-  
 28'-  
 side - 8'  
 DK*

Plot for 10 Ninth St. Portland, ME 04103

**Distances:**

Distance from South side of house to South border = 36 feet

Distance from North side of house to North border = 40 feet

Distance from West side of house to West border = 18 feet

Distance  East side of house to East border = 48 feet

**Distances from Proposed Deck:**

Distance from N. side of deck to North border = 24 feet  
 2.6

Distance  CT of  W/E side border = 18 feet

Distance from East side of deck to East border = 62 feet

Distance from S. side of deck to South border = 60 feet

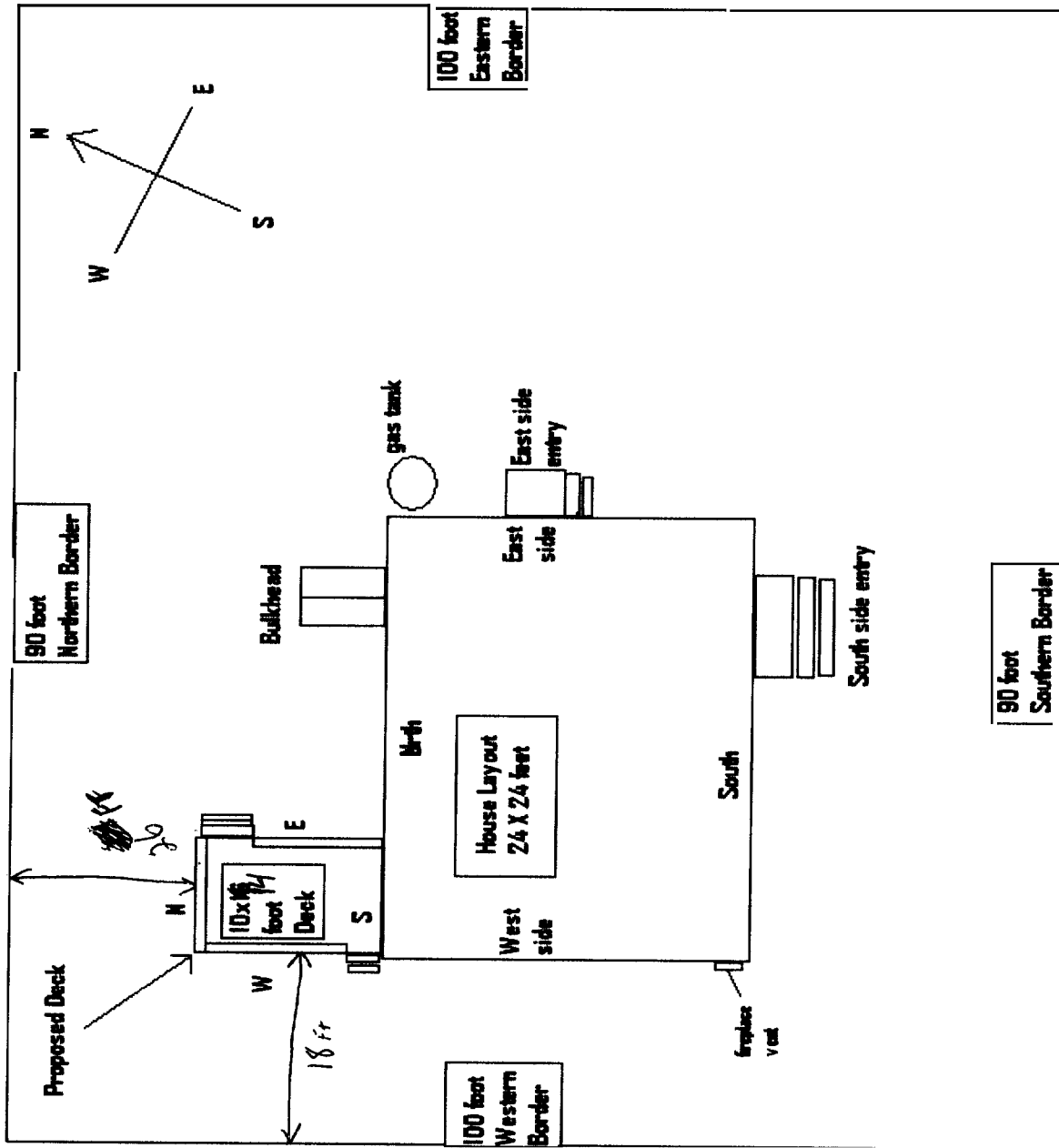

# All Purpose Building Permit Application

If you or the property owner owes real estate or personal property taxes or user charges on any property within the City, payment arrangements must be made before permits of any kind are accepted.

Location/Address of Construction: <u>10 Ninth St. Portland, ME 04103</u>		
Total Square Footage of Proposed Structure <u>160 sqft Wooden Deck</u>	Square Footage of Lot <u>5,000 Sq Ft</u>	
Tax Assessor's Chart, Block & Lot Chart# <u>338</u> Block# <u>D</u> Lot# <u>005</u>	Owner: <u>Robert + Kristin Klaimer</u>	Telephone: <u>207 797-2438</u>
Lessee/Buyer's Name (If Applicable)	Applicant name, address & telephone: <u>Robert Klaimer 10 Ninth St Portland, ME 04103</u>	cost Of Work: <u>\$ 1400.00</u> Fee: \$ <u>39.00</u>
Current use: <u>Residence</u>		
If the location is currently vacant, what was prior use: <u>N/A</u>		
Approximately how long has it been vacant: <u>N/A</u>		
Proposed use: <u>Recreational Deck</u>		
Project description: <u>10 x 16 Wooden Deck</u>		
Contractor's name, address & telephone: <u>Robert Klaimer, 10 Ninth St. Portland, ME 04103 797-2438</u>		
Who should we contact when the permit is ready: <u>bert Klaimer</u>		
Mailing address: <u>10 Ninth St. Portland, ME 04103</u>		
We will contact you by phone when the permit is ready, You must come in and pick up the permit and review the requirements before starting any work, with a Plan Reviewer. A stop work order will be issued and a \$100.00 fee if any work starts before the permit is picked up. PHONE: <u>797-2438</u>		

IF THE REQUIRED INFORMATION IS NOT INCLUDED IN THE SUBMISSIONS THE PERMIT WILL BE AUTOMATICALLY DENIED AT THE DISCRETION OF THE BUILDING/PLANNING DEPARTMENT, WE MAY REQUIRE ADDITIONAL INFORMATION IN ORDER TO APPROVE THIS PERMIT.

I hereby certify that I am the Owner of record of the named property, or that the owner of record authorizes the proposed work and that I have been authorized by the owner to make this application as his/her authorized agent. I agree to conform to all applicable laws of this jurisdiction. In addition, if a permit for work described in this application is issued, I certify that the Code Official's authorized representative shall have the authority to enter all areas covered by this permit at any reasonable hour to enforce the provisions of the codes applicable to this permit.

Signature of applicant: Robert Klaimer Date: 5 4 05

DEPT. OF BUILDING INSPECTION  
CITY OF PORTLAND, ME  
MAY - 4 2005  
**RECEIVED**

**This is NOT a permit, you may not commence ANY work until the permit is issued.**  
If you are in a Historic District you may be subject to additional permitting and fees with the Planning Department on the 4<sup>th</sup> floor of City Hall

# 335

The Home Depot # 2401  
245 RIVERSIDE STREET, PORTLAND, ME 04103  
(207) 761-0600  
Fri Mar 18 14:18:55 2005  
The materials for this project will cost \$1180.70

ROBERT KLAIBER  
10X16 ATTACHED DECK  
209183  
Deck Layout

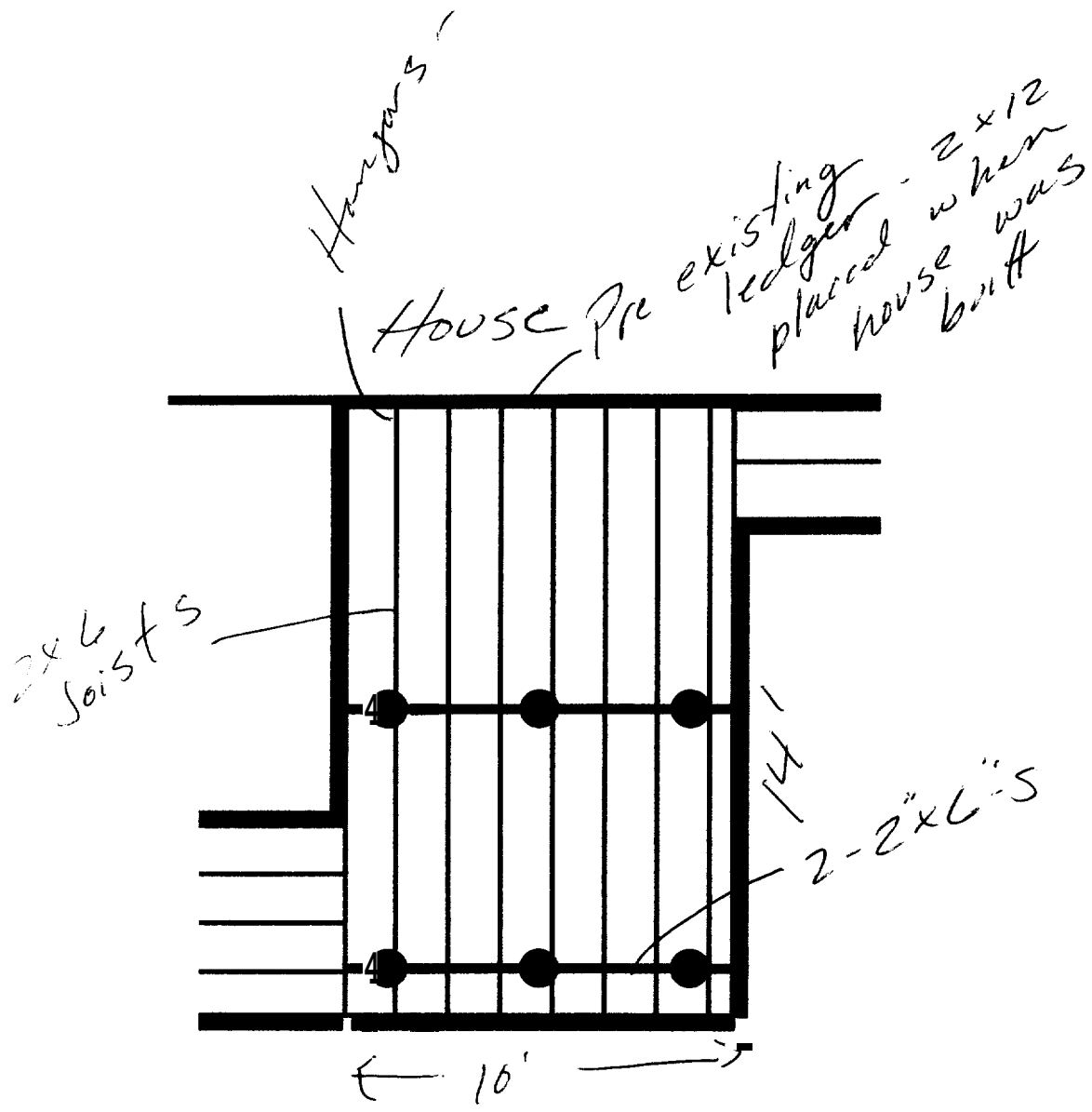

The Home Depot # 2401  
245 RIVERSIDE STREET, PORTLAND, ME 04103  
(207)761-0600  
Fri Mar 18 14:18:55 2005  
The materials for this project will cost \$1180.70

ROBERT KLAIBER  
10X16 ATTACHED DECK  
209183  
Post Layout for Deck 1

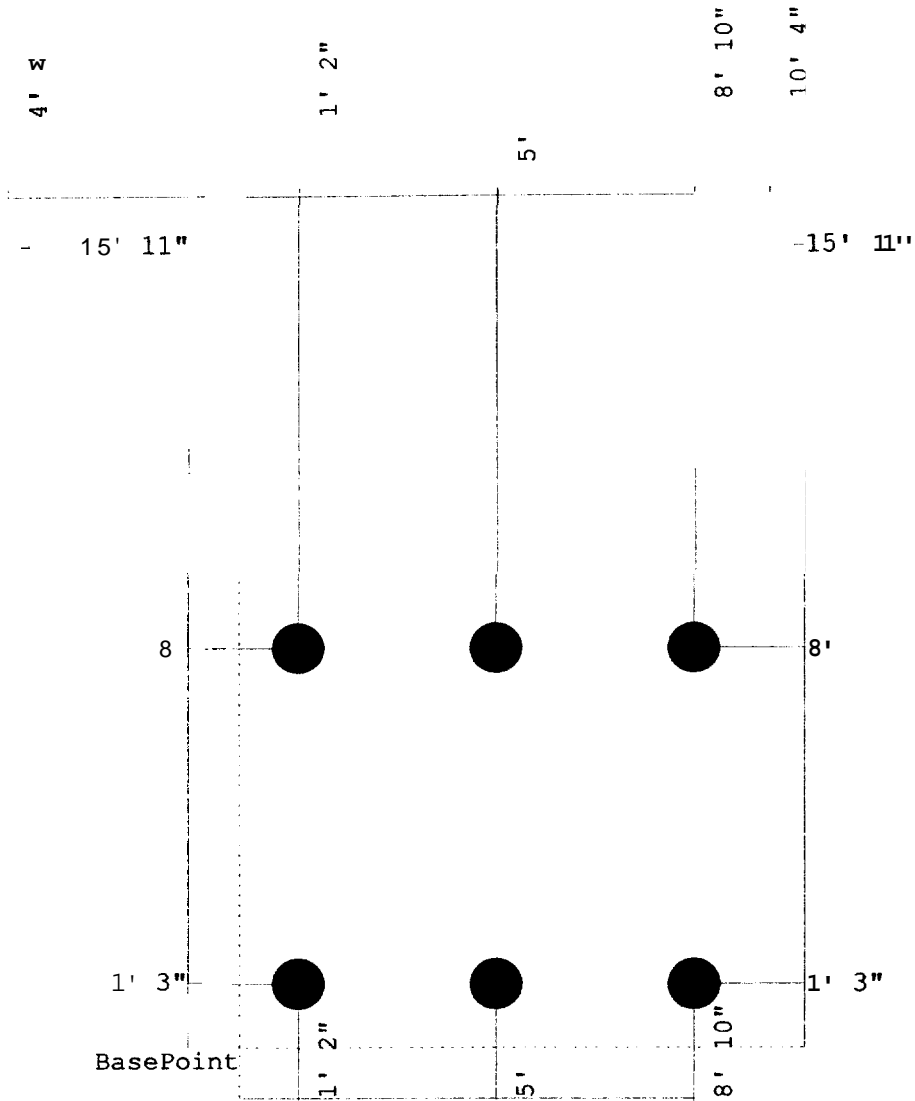

The Home Depot # 2401  
245 RIVERSIDE STREET, PORTLAND, ME 04103  
(207) 761-0600  
Fri Mar 18 14:18:55 2005  
The materials for this project will cost \$1 180.70

ROBERT KLAIBER  
10X16 ATTACHED DECK  
209183  
Deck Dimensions for Deck 1

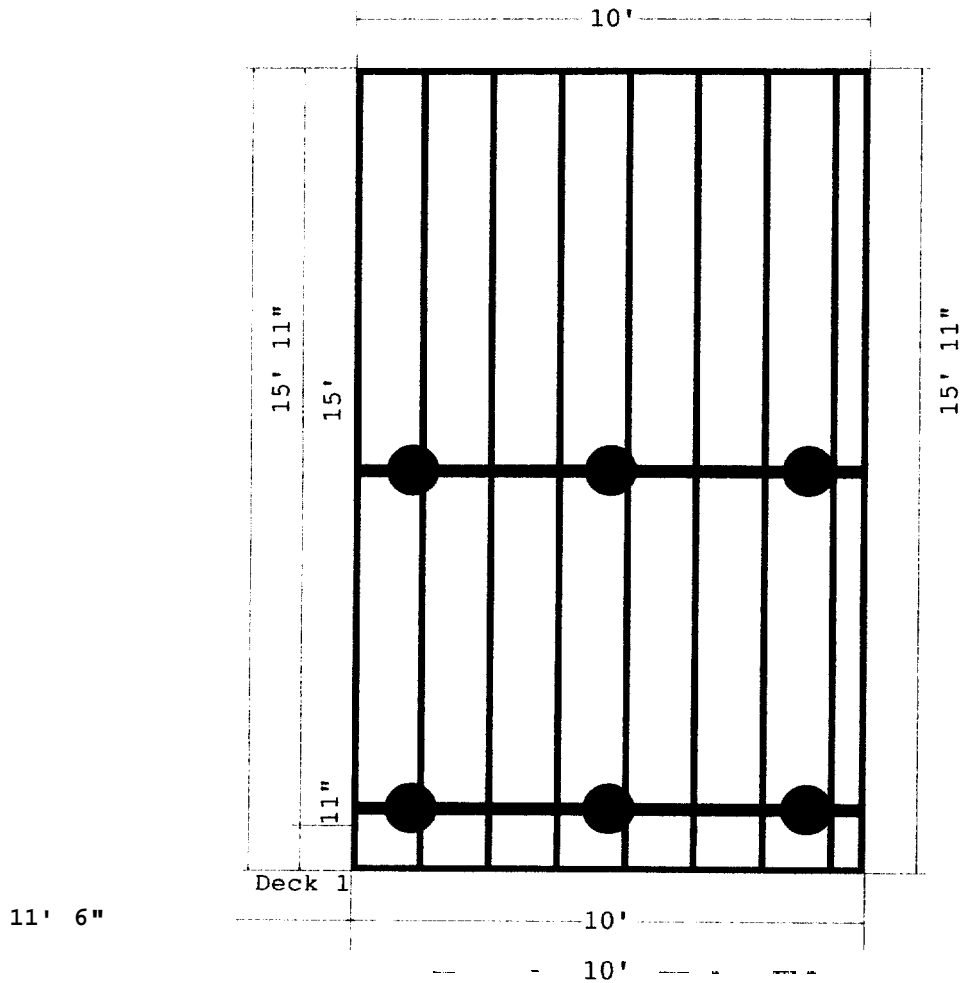

Joist Spacing = 16 in. o.c. ✓  
Baluster Spacing = 3 3/4" ✓  
Toe Spacing = 3 3/4" ✓  
Railing Height = 36" ✓



The Home Depot # 2401  
245 RIVERSIDE STREET, PORTLAND, ME 04103  
(207) 761-0600  
Fri Mar 18 14:19:21 2005  
ROBERT KLAIBER  
10X16 ATTACHED DECK  
209183

### Construction Specifications

#### deck 1:

Construction Method = Beam on Top of Post  
Footing Type = In-Ground  
Live Load = 80  
Dead Load = 10  
Decking Spacing = 0 1 / 8  
Joist Spacing = 16"  
Beam Spacing = 83 1/2"  
Post Spacing = 48"  
Decking = 5/4X6 ACQ Premium Southern Pine No. 2  
Beams = 2X6.25 ACQ Southern Pine No. 1  
Joists = 2X6 .25 ACQ Southern Pine No. 1  
Posts = 4X4 ACQ Southern Pine No. 2  
Deck Height = 24"  
Diagonal Bracing = No  
Deck Skirt = No  
Joist Overhang = 12"  
Beam Overhang = 12"  
Decking Deflection Factor = 360  
Joist Deflection Factor = 360  
Beam Deflection Factor = 360  
Pref Decking Size =  
Pref Joist Size = NONE  
Pref Beam Size = NONE  
Pref Post Size = NONE

#### Railing 1:

Railing Height = 3 6 ✓  
Baluster Spacing = 3 3/4" ✓  
Toe Space = 3 3/4" ✓

#### Stair 1:

Step Width = 3 6 ✓  
Step Height = 24" ✓  
Step Rise = 5 11/16" ✓  
Step Run = 11" ✓  
Stringers = 2X12 ACQ Southern Pine No. 2  
Risers = 5/4X6 ACQ Premium Southern Pine No. 2  
Treads = 5/4X6 ACQ Premium Southern Pine No. 2

#### Railing 3:

Railing Height = 36" ✓  
Baluster Spacing = 3 3/4" ✓  
Toe Space = 3 3/4" ✓

#### Railing 4:

Railing Height = 3 6 ✓  
Baluster Spacing = 3 3/4" ✓  
Toe Space = 3 3/4" ✓

#### Railing 2:

Railing Height = 36"  
Baluster Spacing = 3 3/4"

Toe Space =  $3 \frac{3}{4}$ "

Railing 5:

Railing Height = 36"

Baluster Spacing =  $3 \frac{3}{4}$ "

Toe Space =  $3 \frac{3}{4}$ "

Stair 3:

Step Width = 60"

Step Height = 24"

Step Rise =  $5 \frac{11}{16}$ "

Step Run = 11"

Stringers = 2X12 ACQ Southern Pine No. 2

Risers = 5/4X6 ACQ Premium Southern Pine No. 2

Treads = 5/4X6 ACQ Premium Southern Pine No. 2

Railing 9:

Railing Height = 36"

Baluster Spacing =  $3 \frac{3}{4}$ "

Toe Space =  $3 \frac{3}{4}$ "

Railing 8:

Railing Height = 36"

Baluster Spacing =  $3 \frac{3}{4}$ "

Toe Space =  $3 \frac{3}{4}$ "

Railing 7:

Railing Height = 36"

Baluster Spacing =  $3 \frac{3}{4}$ "

Toe Space =  $3 \frac{3}{4}$ "

Railing 6:

Railing Height = 36"

Baluster Spacing =  $3 \frac{3}{4}$ "

Toe Space =  $3 \frac{3}{4}$ "

The Home Depot # 2401  
245 RIVERSIDE STREET, PORTLAND, ME 04103  
(207) 761-0600  
Fri Mar 18 14:18:55 2005  
The materials for this project will cost \$1180.70

ROBERT KLAIBER  
10X16 ATTACHED DECK  
209183  
3D View

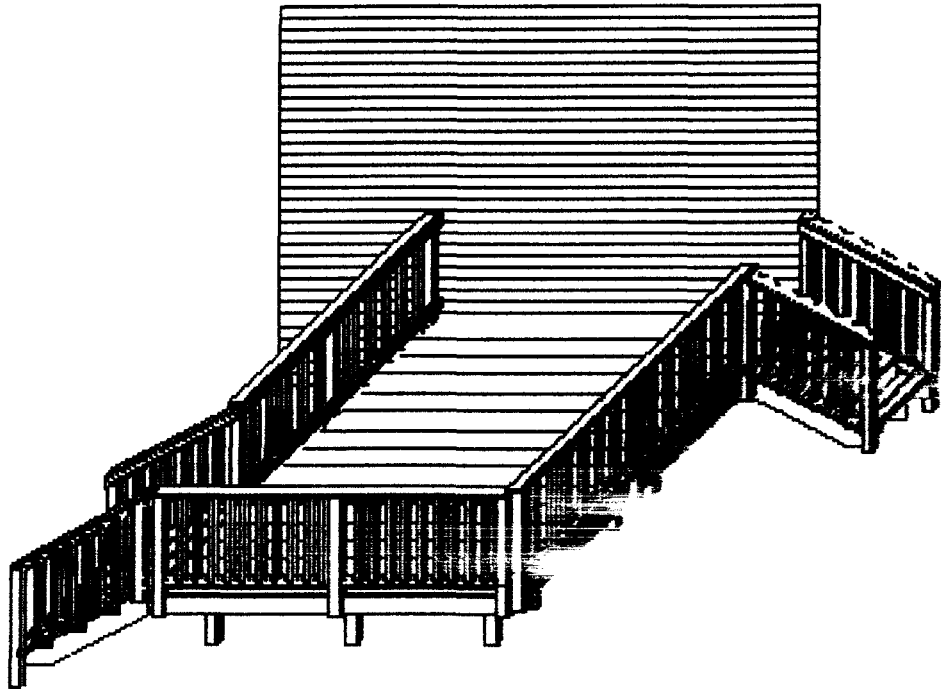

The Home Depot # 2401  
 245 RIVERSIDE STREET. PORTLAND, ME 04103  
 (207) 761-0600  
 3/18/2005  
 ROBERT KLAIBER  
 10X16 ATTACHED DECK  
 209183

Materials for Deck:

Qty	UOM	SKU	Use	Description
98	EA	430400	Baluster	2X2-42 B1E BALLUSTER PT
4	EA	255376	Beam	2x6-10 #1 SYP PT
34	EA	167894	Decking	5/4X6-10 THOMPSONIZED DECK PT
2	EA	254258	V Top Rail	2X4-8 #1 SYP PT
8	EA	168768	H Top Rail	5/4 X6-8FT THOMPSONIZED DECK PT
1	EA	255376	Joist	2X6-10 #1 SYP PT
9	EA	255457	Joist	2X6-16 #1 SYP PT
1	EA	255376	Ledger	2X6-10 #1 SYP PT
3	EA	257974	Post	4X4-10 #2 PT
9	EA	256276	Railing Post	4X4-8 #2 PT
4	EA	155959	Stair Stringer	2x12-12 #2 PT
1	EA	168768	Tread	5/4 X6-8FT THOMPSONIZED DECK PT
6	EA	167894	Tread	5/4X6-10 THOMPSONIZED DECK PT
8	EA	254258	V Bottom Rail	2X4-8 #1 SYP PT
8	EA	254258	V Top Rail	2X4-8 #1 SYP PT
8	EA	865827	2x6 Joist Hanger	ZMAX 2X6 JOIST HANGER
1	EA	735002	BalusterScrewGreen	GREEN 5LB 2 1/2IN DECKMATE DECK SCRW
12	EA	169765	Concln-GroundFoot	80LB. CONCRETE MIX
2	EA	735003	Deck Screws Green	GREEN 5LB 3 IN DECKMATE DECK SCRW
2	EA	439398	Flashing	DECK LEDGER FLASHING WHT GALV 8FT
1	EA	336963	Footing Tube 10"	10IN X 48IN TUBE FOR CONCRETE
1	PK	462810	Hanger Nails 2x6	10D JOIST HANGER NAILS
1	EA	192708	Joist Framing Nails	16D 3-12" HOT GALV COMMON 5 LB
8	EA	538981	Lag Bolt Washer	FLAT CUT WASHER GALV 1/2
8	EA	928607	Ledger-Bolt	LAG SCREW GALV 1/2 X 6
14	EA	544208	Rail Post-Bolt	CARRIAGE BOLT-GALV. 1/2 X 8
14	EA	538892	Rail Post-Nut	HEXNUT GALV 1/2
14	EA	538981	Rail Post-Washer	FLAT CUT WASHER GALV 1/2
1	EA	735002	Step Screw Green	GREEN 5LB 2 1/2IN DECKMATE DECK SCRW

The total cost of in stock materials is \$1180.70 plus tax.  
 This estimate was created on 3/18/2005 and is valid for 3 business days.

Parameters from UBC cod parameter file.  
 Parameters used for Deck 1: 80 psf live load, 48 inch footing depth.

**WARNING:**

**THIS IS NOT A FINAL DESIGN PLAN. VARIATIONS IN BUILDING CODES, SPECIFIC ARCHITECTURAL CONSIDERATIONS, OR SITE CONDITIONS MAY REQUIRE CHANGES TO THIS DESIGN. YOU ARE RESPONSIBLE FOR THE DESIGN, CONSTRUCTION, CODES, REGULATION, MATERIAL USAGE, AND STRUCTURAL SAFETY OF THIS DESIGN. BE SURE TO CHECK AND VERIFY THE DESIGN WITH YOUR LOCAL ARCHITECT AND BUILDING INSPECTOR.**

**THE COMPANY ASSUMES ABSOLUTELY NO RESPONSIBILITY FOR THE CORRECT USE OF THIS PROGRAM. THE USER SHOULD CONSULT A PROFESSIONAL TO DETERMINE IF THEY ARE REASONABLE AND ACCURATE.**