

BASEMENT PLAN
Scale: 1/4" = 1'-0"

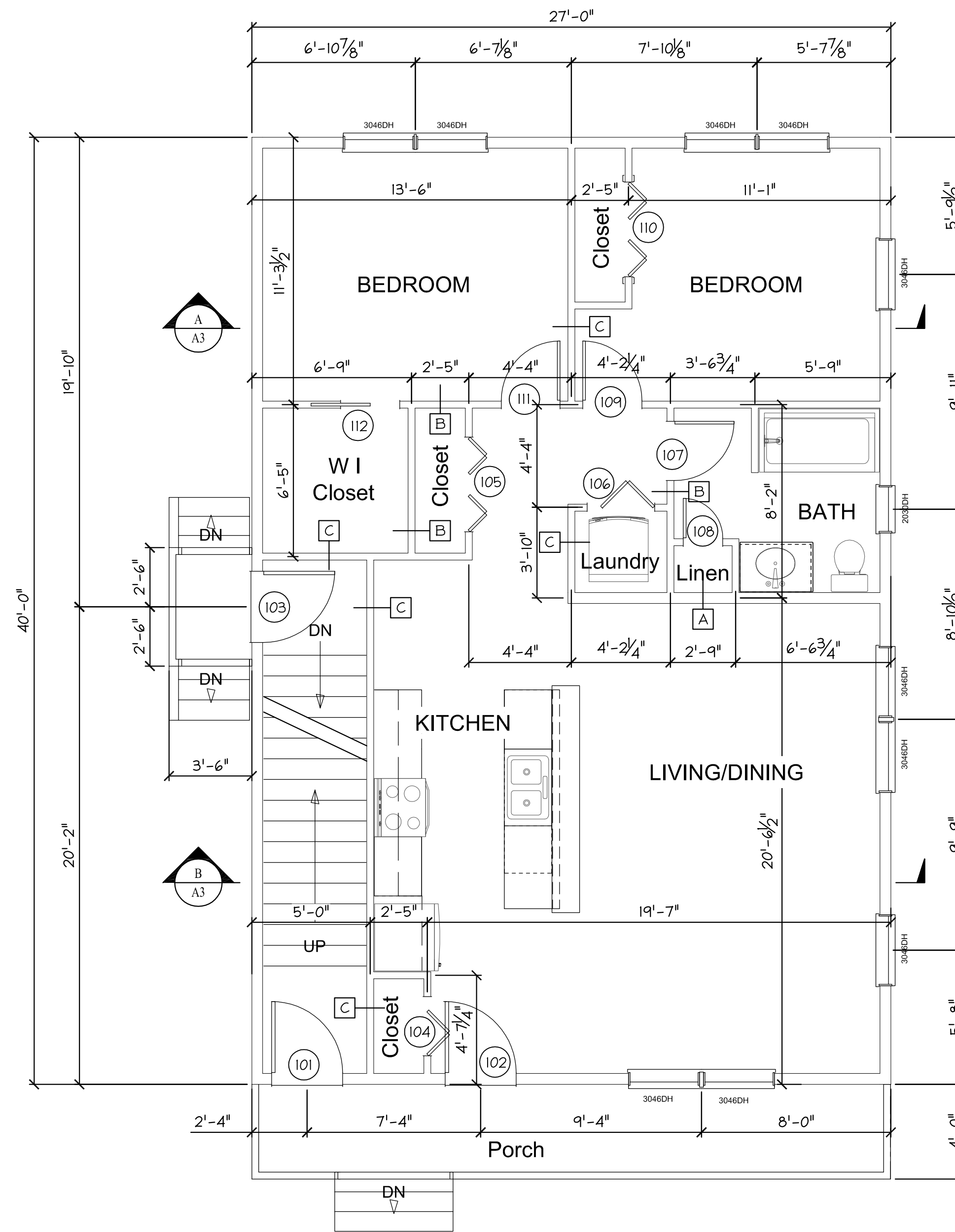

FIRST FLOOR PLAN
Scale: 1/4" = 1'-0"

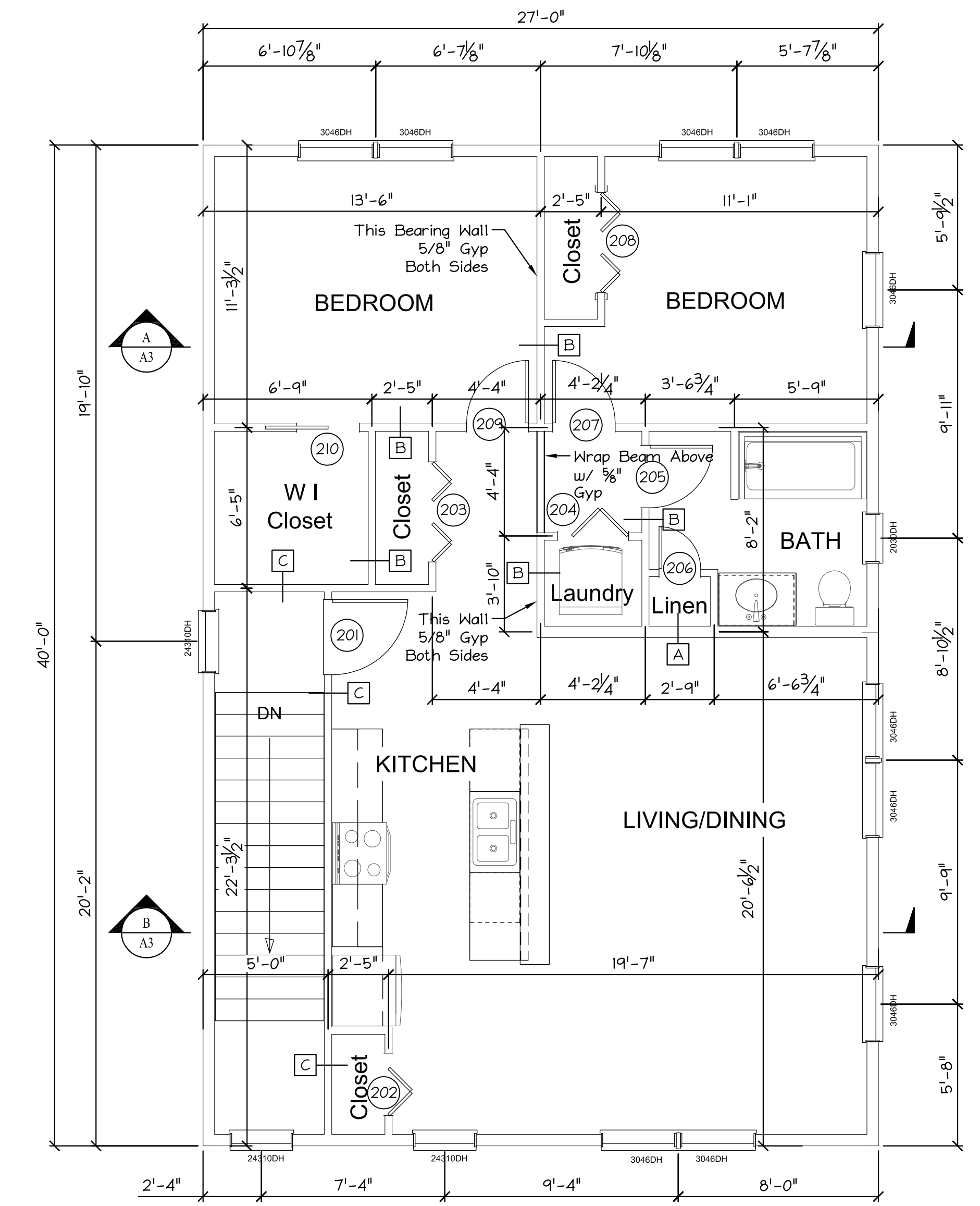

SECOND FLOOR PLAN
Scale: 1/4" = 1'-0"

DOOR SCHEDULE - 1st & 2nd Floors

DOOR NO.	SIZE	LABEL	LOCATION	TYPE	ELEV	REMARKS
001	3'-0"x6'-8"	1 HR	BASEMENT	INT./SOLID CORE	3	
101	3'-0"x6'-8"	---	ENTRY	EXT./INSULATED	2	
102	3'-0"x6'-8"	---	ENTRY UNIT 1	EXT./INSULATED	2	
103	3'-0"x6'-8"	---	BASEMENT ENTRY	EXT./INSULATED	1	
104	2'-6"x6'-8"	---	ENTRY CLOSET	INT./HOLLOW CORE	5	BIFOLD
105	4'-0"x6'-8"	---	HALL CLOSET	INT./HOLLOW CORE	5	BIFOLD
106	3'-0"x6'-8"	---	LAUNDRY	INT./HOLLOW CORE	5	BIFOLD
107	2'-6"x6'-8"	---	BATH	INT./HOLLOW CORE	4	
108	1'-8"x6'-8"	---	LINEN	INT./HOLLOW CORE	4	
109	2'-6"x6'-8"	---	BEDROOM 2	INT./HOLLOW CORE	4	
110	4'-0"x6'-8"	---	BEDROOM 2 CLOSET	INT./HOLLOW CORE	5	BIFOLD
111	2'-6"x6'-8"	---	BEDROOM 1	INT./HOLLOW CORE	4	
112	2'-6"x6'-8"	---	BEDROOM 1 CLOSET	INT./HOLLOW CORE	6	POCKET
201	3'-0"x6'-8"	1 HR	ENTRY UNIT 2	INT./SOLID CORE	3	
202	2'-6"x6'-8"	---	ENTRY CLOSET	INT./HOLLOW CORE	5	BIFOLD
203	4'-0"x6'-8"	---	HALL CLOSET	INT./HOLLOW CORE	5	BIFOLD
204	3'-0"x6'-8"	---	LAUNDRY	INT./HOLLOW CORE	5	BIFOLD
205	2'-6"x6'-8"	---	BATH	INT./HOLLOW CORE	4	
206	1'-8"x6'-8"	---	LINEN	INT./HOLLOW CORE	4	
207	2'-6"x6'-8"	---	BEDROOM 2	INT./HOLLOW CORE	4	
208	4'-0"x6'-8"	---	BEDROOM 2 CLOSET	INT./HOLLOW CORE	5	BIFOLD
209	2'-6"x6'-8"	---	BEDROOM 1	INT./HOLLOW CORE	4	
210	2'-6"x6'-8"	---	BEDROOM 1 CLOSET	INT./HOLLOW CORE	6	POCKET

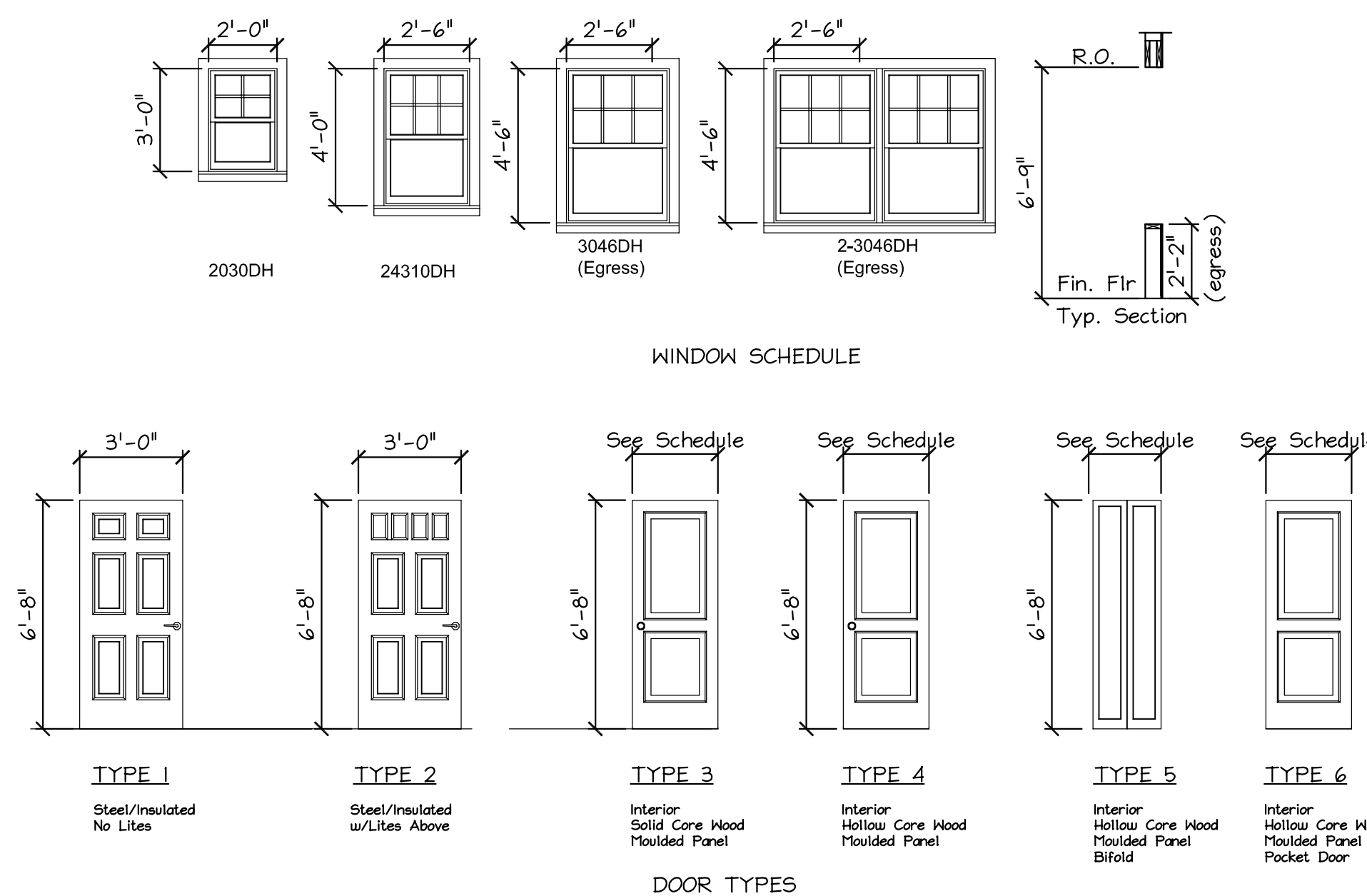

FOR PERMIT
ISSUED
2/20/17

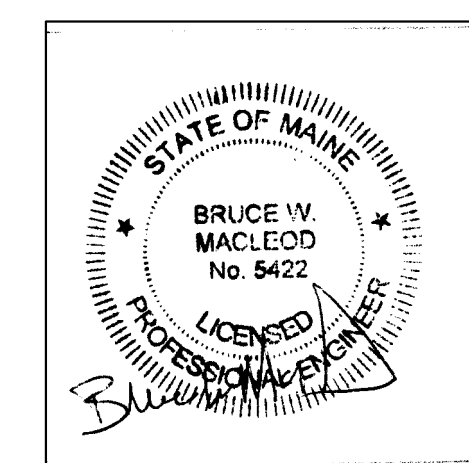

MacLeod
Structural Engineers, PA
90 Bridge Street Ste252 Westbrook, Maine 04038 207.839.0980
167-169 Woodford Street
Portland, Maine

TITLE: Floor Plans
DATE: 1/27/17 DRAWN BY: BIM DRAWING NUMBER: A-1.0
SCALE: as noted PROJ NO: 2017-010