

Rear breezeway deck and stairs to be framed with pressure treated 2x6 framing, with stringers made from 2x12 pt. The decking will be a composite material. The single railing will be mad from cedar. The fir balusters will be 4" o.c. spacing. There will be no skirting under the deck or stringers. All rails and fasteners will be galvanized or stainless steel. (2) 8" sonno tubes will be installed to support the deck as indicated and the stringers will be bedded into a compressed crushed stone base. The rise will be 7" and the run 11", with a 36" tall railing.

Front breezeway deck and stairs is to be framed from pressure treated 2x6 framing, with stringers made from 2x12 pt. The decking will be a composite material. The single railing will be made from cedar. The fir balusters will be 4" o.c. spacing. There will be no skirting under the deck or stringers. All nails and fasteners will be galvanized or stainless steel. (2) 8" sonno tubes will be installed to support the deck as indicated and the stringers will be bedded into a compressed crushed stone base. The rise will be 7" and the run will be 11" with a railing height of 36".

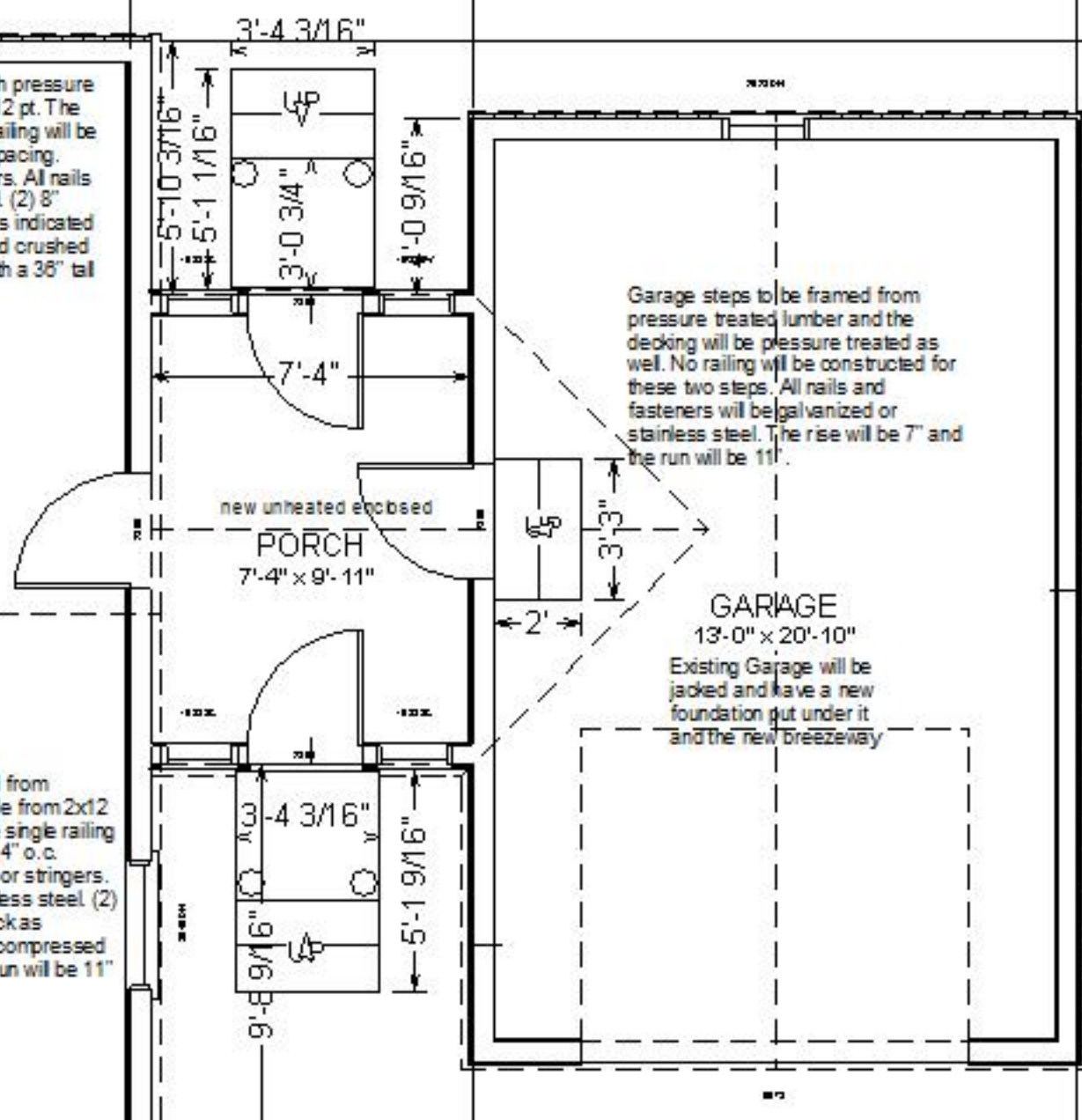

Garage steps to be framed from pressure treated lumber and the decking will be pressure treated as well. No railing will be constructed for these two steps. All rails and fasteners will be galvanized or stainless steel. The rise will be 7" and the run will be 11".

**GARAGE**  
13'-0" x 20'-10"  
Existing Garage will be jacked and have a new foundation put under it and the new breezeway