

BKSSL  
SOLID STATE LIGHTING



EL CAPITAN™

PROJECT:	
TYPE:	
CATALOG NUMBER:	
SOURCE:	
NOTES:	

### CATALOG NUMBER LOGIC

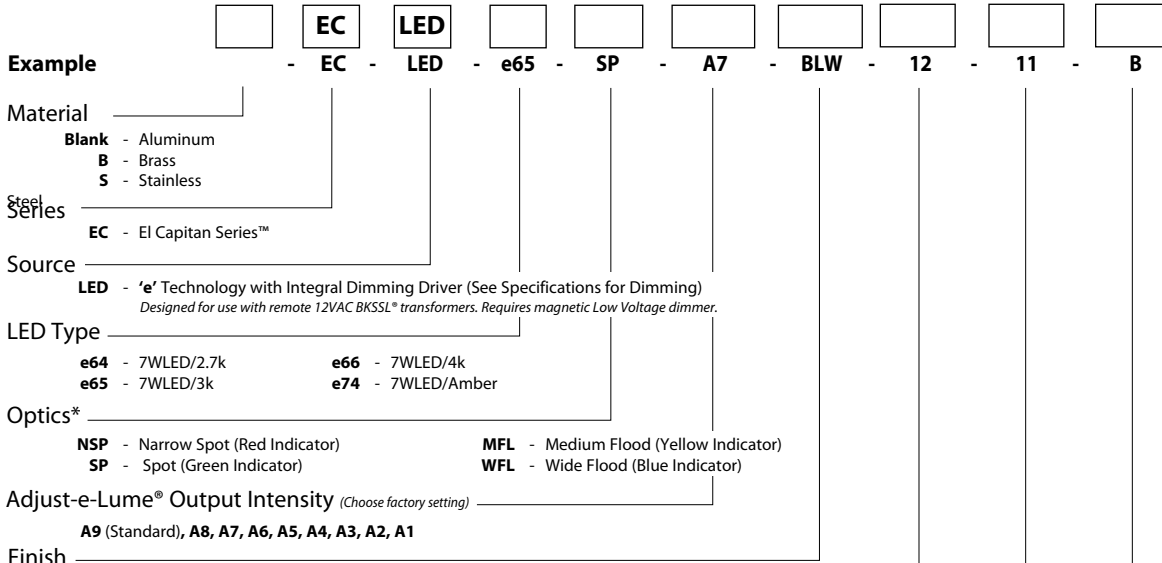

Aluminum Finish			Brass Finish		Premium Finish		
Powder Coat Color	Satin	Wrinkle	Machined	MAC	ABP	CMG	RMG
Bronze	<b>BZP</b>	<b>BZW</b>	Polished	<b>POL</b>	<b>AMG</b> Aleutian Mountain Granite	<b>CRI</b> Cracked Ice	<b>SDS</b> Sonoran Desert Sandstone
Black	<b>BLP</b>	<b>BLW</b>	Mitique™	<b>MIT</b>	<b>AQW</b> Antique White	<b>CRM</b> Cream	<b>SMG</b> Sierra Mountain Granite
White (Gloss)	<b>WHP</b>	<b>WHW</b>	Stainless Finish		<b>BCM</b> Black Chrome	<b>HUG</b> Hunter Green	<b>TXF</b> Textured Forest
Aluminum	<b>SAP</b>	—	Machined	<b>MAC</b>	<b>BGE</b> Beige	<b>MDS</b> Mojave Desert Sandstone	<b>WCP</b> Weathered Copper
Verde	—	<b>VER</b>	Polished	<b>POL</b>	<b>BPP</b> Brown Patina Powder	<b>NBP</b> Natural Brass Powder	<b>WIR</b> Weathered Iron
			Brushed	<b>BRU</b> <small>Interior use only.</small>	<b>CAP</b> Clear Anodized Powder	<b>OCP</b> Old Copper	<small>Also available in RAL Finishes See submittal SUB-1439-00</small>

Lens Type: **12** - Soft Focus Lens, **13** - Rectilinear Lens

Shielding: **11** - Honeycomb Baffle\*

Cap Style: **A** - 45°, **B** - 90°, **C** - Flush, **D** - 45° less Weep Hole (Interior Use Only), **E** - 90° less Weep Hole (Interior Use Only), **F** - 90° cutoff with Flush Lens

\*Accommodates up to 2 Lens/Shielding media

DRIVER DATA	Input Volts	InRush Current	Operating Current	Dimmable	Operation Ambient Temperature
	12VAC/DC 50/60Hz	250mA (non-dimmed)	700mA	Magnetic Low Voltage Dimmer	-10°F-130°F

### LM79 DATA

BK No.	CCT (Typ.)	Input Watts (Typ.)	CRI (Typ.)
e64	2700K	7.0	80
e65	3000K	7.0	80
e66	4000K	7.0	80
e74	Amber (590nm)	7.0	~

### L70 DATA

Minimum Rated Life (hrs.)
70% of initial lumens(L70)
50,000
50,000
50,000
50,000

### \* OPTICAL DATA

Beam Type	Angle	e66 CBCP	Visual Indicator
Narrow Spot	13°	6889	Red Dot
Spot	15°	5225	Green Dot
Medium Flood	23°	1984	Yellow Dot
Wide Flood	31°	1300	Blue Dot

<b>B-K LIGHTING</b>	40429 Brickyard Drive • Madera, CA 93636 • USA 559.438.5800 • FAX 559.438.5900 www.bklighting.com • info@bklighting.com	RELEASED 06-06-16	DRAWING NUMBER SUB000942
---------------------	---	----------------------	-----------------------------

THIS DOCUMENT CONTAINS PROPRIETARY INFORMATION OF B-K LIGHTING, INC. AND ITS RECEIPT OR POSSESSION DOES NOT CONVEY ANY RIGHTS TO REPRODUCE, DISCLOSE ITS CONTENTS, OR TO MANUFACTURE, USE OR SELL ANYTHING IT MAY DESCRIBE. REPRODUCTION, DISCLOSURE OR USE WITHOUT SPECIFIC WRITTEN AUTHORIZATION OF B-K LIGHTING, INC. IS STRICTLY FORBIDDEN.

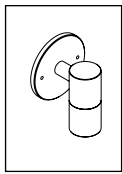

**BKSSL**  
SOLID STATE LIGHTING

the power of  
dimming with **adjust-e-lume**<sup>®</sup>  
TECHNOLOGY

# EL CAPITAN™

PROJECT:

TYPE:

**FRONT VIEW**

**"A/D" CAP**

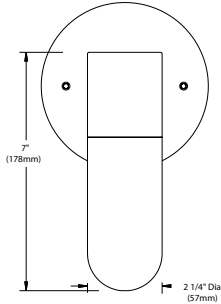

**"B/E/F" CAP**

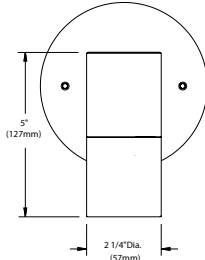

**"C" CAP**

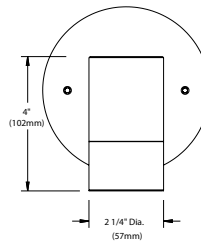

**CANOPY DETAIL**

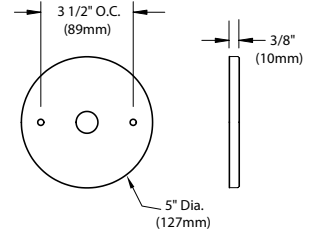

**UNIVERSAL RING**

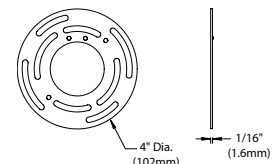

**SIDE VIEW**

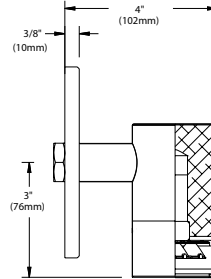
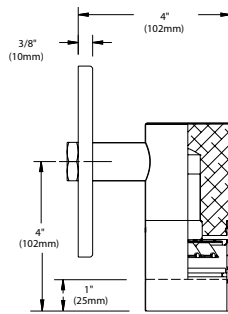
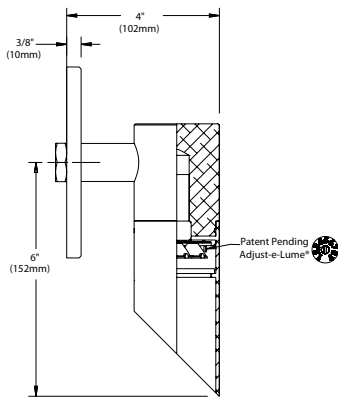

Accessories (Configure separately)

Remote options:



TR Series

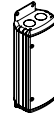

UPMRM™

All dimensions indicated on this submittal are nominal.  
Contact Technical Sales if you require more stringent specifications.

## SPECIFICATIONS

### GreenSource Initiative™

Metal and packaging components are made from recycled materials. Manufactured using renewable solar energy, produced on site. Returnable to manufacturer at end of life to ensure cradle-to-cradle handling. Packaging contains no chlorofluorocarbons (CFC's). Use of this product may qualify for GreenSource efficacy and recycling rebate(s). Consult [www.bklighting.com/greensource](http://www.bklighting.com/greensource) for program requirements.

### Materials

Furnished in Copper-Free Aluminum (Type 6061-T6), Brass (Type 360) or Stainless Steel (Type 316).

### Body

Fully machined from solid billet. Unibody design provides enclosed, water-proof wireway and integral heat sink for maximum component life. High temperature, silicone 'O' Ring provides water-tight seal.

### Cap

Fully machined. Accommodates [1] lens or louver media. Choose from 45° cutoff ('A' or 'D'), 1" deep bezel with 90° cutoff ('B' or 'E'), flush lens ('C') cap styles, or 1" deep cutoff with flush mounted lens ('F'). 'A' and 'B' caps include weephole for water and debris drainage. 'D' and 'E' caps exclude weep-hole and are for interior use only.

### Lens

Shock resistant, tempered, glass lens is factory adhered to fixture cap and provides hermetically sealed optical compartment. Specify soft focus (#12) or rectilinear (#13) lens.

### BKSSL®

Integrated solid state system with 'e' technology is scalable for field upgrade. Modular design with electrical quick disconnects permit field maintenance. High power, forward throw source complies with ANSI C78.377 binning requirements. Exceeds ENERGY STAR® lumen maintenance requirements. LM-80 certified components.

Integral, constant current driver. 12VAC/VDC input. 50/60Hz. Proprietary input control scheme achieves power factor correction and eliminates inrush current. Output, over-voltage, open-circuit, and short circuit protected. Inrush current limited to <1A (non-dimmed). Conforms to Safety Std. C22.2 No. 250.13-12.

### Dimming

Line voltage dimmable via magnetic low voltage dimmer. For use with low voltage dimmer with dedicated neutral conductor. For purposes of dimming: Remote magnetic transformer with BKSSL® Power of 'e' technology loads should be loaded to 25% of the transformer VA (watts) rated value.

### Optics

Interchangeable OPTIKIT™ modules permit field changes to optical distribution. Color-coded for easy reference: Narrow Spot (NSP) = Red. Spot (SP) = Green. Medium Flood (MFL) = Yellow. Wide Flood (WFL) = Blue.

### Adjust-e-Lume® (Pat. Pending)

Integral electronics allows dynamic lumen response at the individual fixture. Indexed (100% to 25% nom.) lumen output. Maintains output at desired level or may be changed as conditions require. Specify factory preset output intensity.

### Installation

5" dia., machined canopy with stainless steel universal mounting ring permits mounting to 4" octagonal junction box (by others). Suitable for uplight or downlight installation.

### Remote Transformer

For use with 12VAC BKSSL® remote transformer or magnetic transformers only. B-K Lighting cannot guarantee performance with third party manufacturers' transformers.

### Wiring

Teflon® coated, 18AWG, 600V, 250° C rated and certified to UL 1659 standard.

### Hardware

Tamper-resistant, stainless steel hardware. Canopy mounting screws are additionally black oxide treated for additional corrosion resistance.

### Finish

StarGuard®, our exclusive RoHs compliant, 15 stage chromate-free process cleans and conversion coats aluminum components prior to application of Class 'A' TGIC polyester powder coating. Brass components are available in powder coat or handcrafted metal finish. Stainless steel components are available in handcrafted metal finish. (Brushed finish for interior use only).

### Warranty

5 year limited warranty.

### Certification and Listing

ITL tested to IESNA LM-79. UL Listed. Certified to CAN/CSA/ANSI Standards. Suitable for indoor or outdoor use. Suitable for use in wet locations. RoHs compliant. Made in USA.



\*Teflon is a registered trademark of DuPont Corporation.

\*Energy Star is a registered trademark of the United States Environmental Protection Agency.





# B-K LIGHTING

40429 Brickyard Drive • Madera, CA 93636 • USA  
559.438.5800 • FAX 559.438.5900  
[www.bklighting.com](http://www.bklighting.com) • [info@bklighting.com](mailto:info@bklighting.com)

RELEASED  
06-06-16

DRAWING NUMBER  
SUB000942

Select OptiKit™ for desired distribution

- RED**  **Narrow Spot (NSP)**
- GREEN**  **Spot (SP)**
- YELLOW**  **Medium Flood (MFL)**
- BLUE**  **Wide Flood (WFL)**

Set adjust-e-lume<sup>®</sup> Dial to desired output

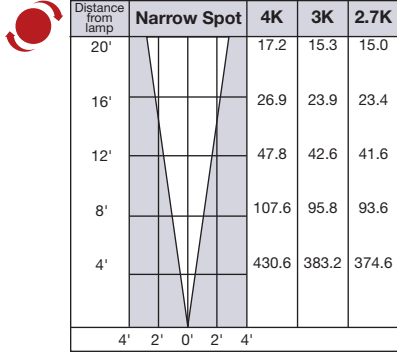

Note: If using No. 11 honeycomb baffle multiply footcandle values by .80

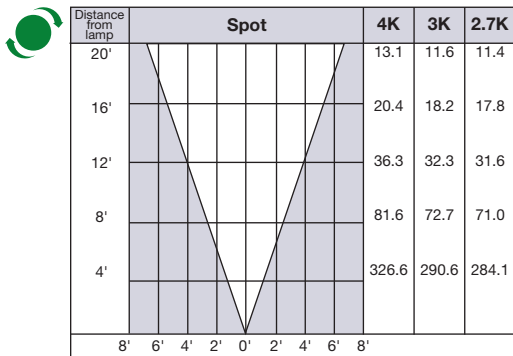

Note: If using No. 11 honeycomb baffle multiply footcandle values by .80

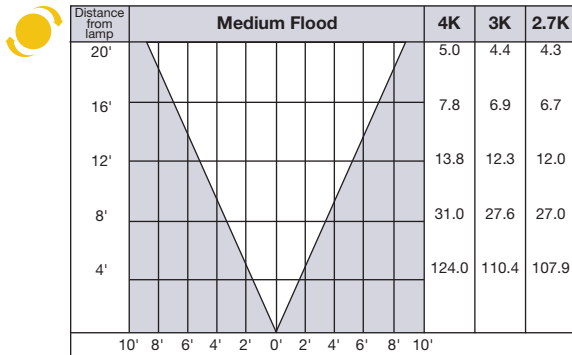

Note: If using No. 11 honeycomb baffle multiply footcandle values by .80

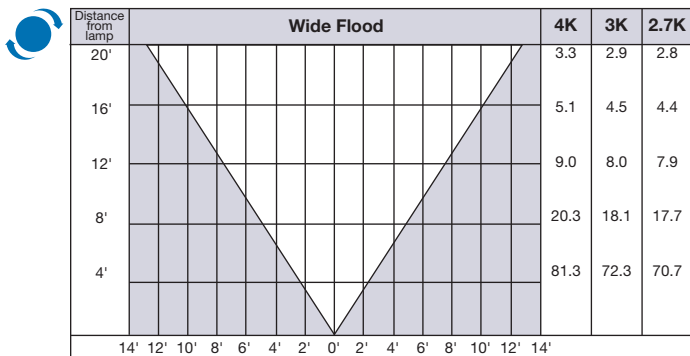

Note: If using No. 11 honeycomb baffle multiply footcandle values by .80