

3 CABLE TRENCH SECTION
NOT TO SCALE

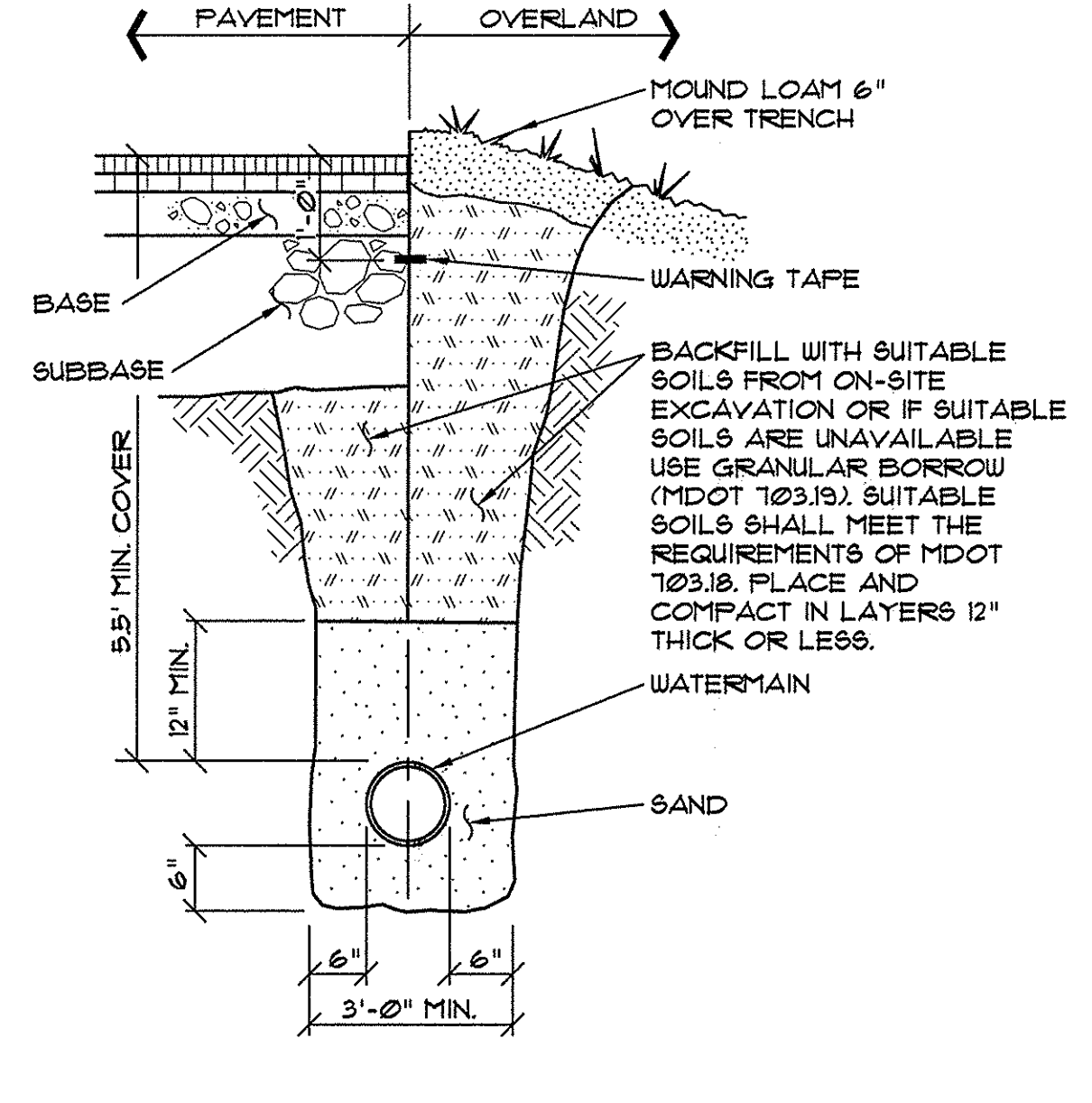

2 TYPICAL WATER MAIN SECTION
NOT TO SCALE

NOTES:
DEPTH OF BITUMINOUS PAVEMENT AND AGGREGATE COURSES SHALL BE DETERMINED BY STREET CLASSIFICATION.
ANY ALTERNATE TRENCHING OR PAYMENT METHODS SHALL BE APPROVED IN ADVANCE BY THE CITY OF PORTLAND, DEPARTMENT OF PUBLIC SERVICES.

NOTES:
1. ALTERNATIVE CONSTRUCTION METHODS OR PAYMENT METHODS SHALL BE APPROVED IN ADVANCE BY THE CITY.
2. IN PAVED AREAS, DEPTHS OF GRAVEL AND HOT MIX ASPHALT SHALL MATCH THE GREATER OF EXISTING CONDITIONS OR THE REQUIREMENTS FOR THE CORRESPONDING STREET CLASSIFICATION.
3. DIMENSION B SHALL BE SUFFICIENT TO ALLOW CRUSHED STONE BEDDING TO BE PLACED AND COMPACTED UNDER THE HAUNCHES OF THE PIPE; BUT IN ALL CASES DIMENSION B SHALL BE AT LEAST 9\"/>

PIPE DIAMETER, D (INCHES)	MAX. TRENCH WIDTH, A (FEET)
4	4.0
6	4.0
8	4.0
10	4.0
12	5.0
15	5.0
18	5.0
21	6.0
24	6.0
27	6.0
30	6.0
36	6.0
42	1.0

USE FOR STORM DRAIN AND SEWER FOREMAN UNO.

1 TYPICAL PIPE TRENCH INSTALLATION & NOTES (11-14)
NOT TO SCALE

LIMIT OF ROCK PAYMENT

PRECAST CONCRETE STRUCTURES:
12\"/>

TRENCHES:
6\"/>

POST & POLE BASE:
LIMIT OF CONCRETE BASE

PAVED SURFACES & BALL FIELD:
BOTTOM OF SUBBASE RELATIVE TO FINISH SURFACE

UNDERGROUND UTILITIES WARNING TAPE

IDENTIFICATION TAPE TO BE INSTALLED ABOVE ALL NEW UNDERGROUND UTILITIES AND ABOVE ANY EXISTING UTILITIES THAT MAY BE EXPOSED BY THIS CONSTRUCTION.

DETECTABLE UNDERGROUND MARKING TAPE TO BE PERMANENT, BRIGHT COLORED, CONTINUOUS-PRINTED PLASTICIZED ALUMINUM TAPE, INTENDED FOR DIRECT-BURIAL SERVICE NOT LESS THAN 3\"/>

APWA UNIFORM COLOR CODE:

PROPOSED EXCAVATION	PROPOSED EXCAVATION
WHITE	PROPOSED EXCAVATION
PINK	TEMPORARY SURVEY MARKINGS
RED	ELECTRIC POWER LINES, CABLES, CONDUIT AND LIGHTING CABLES
YELLOW	GAS, OIL, STEAM, PETROLEUM OR GASEOUS MATERIALS
ORANGE	COMMUNICATION, ALARM OR SIGNAL LINES, CABLES OR CONDUIT
BLUE	POTABLE WATER
PURPLE	RECLAIMED WATER, IRRIGATION AND SLURRY LINES
GREEN	SEWERS AND DRAIN LINES

PINKHAM & GREER CIVIL ENGINEERS

THOMAS GREER
No. 4286
LICENSED PROFESSIONAL ENGINEER
STATE OF MAINE

3-15-18

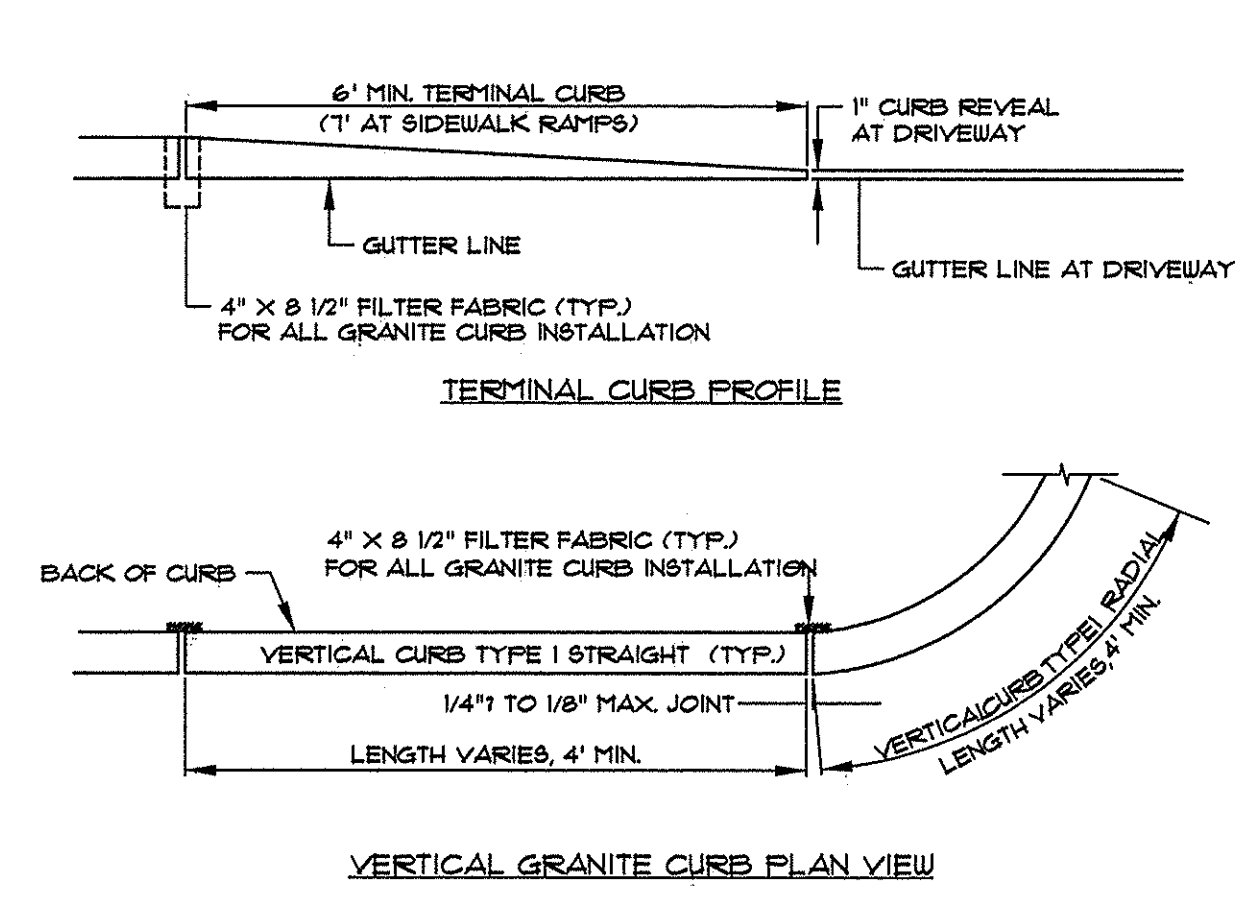

6 PAVEMENT CUTTING & MATCHING SECTION
NOT TO SCALE

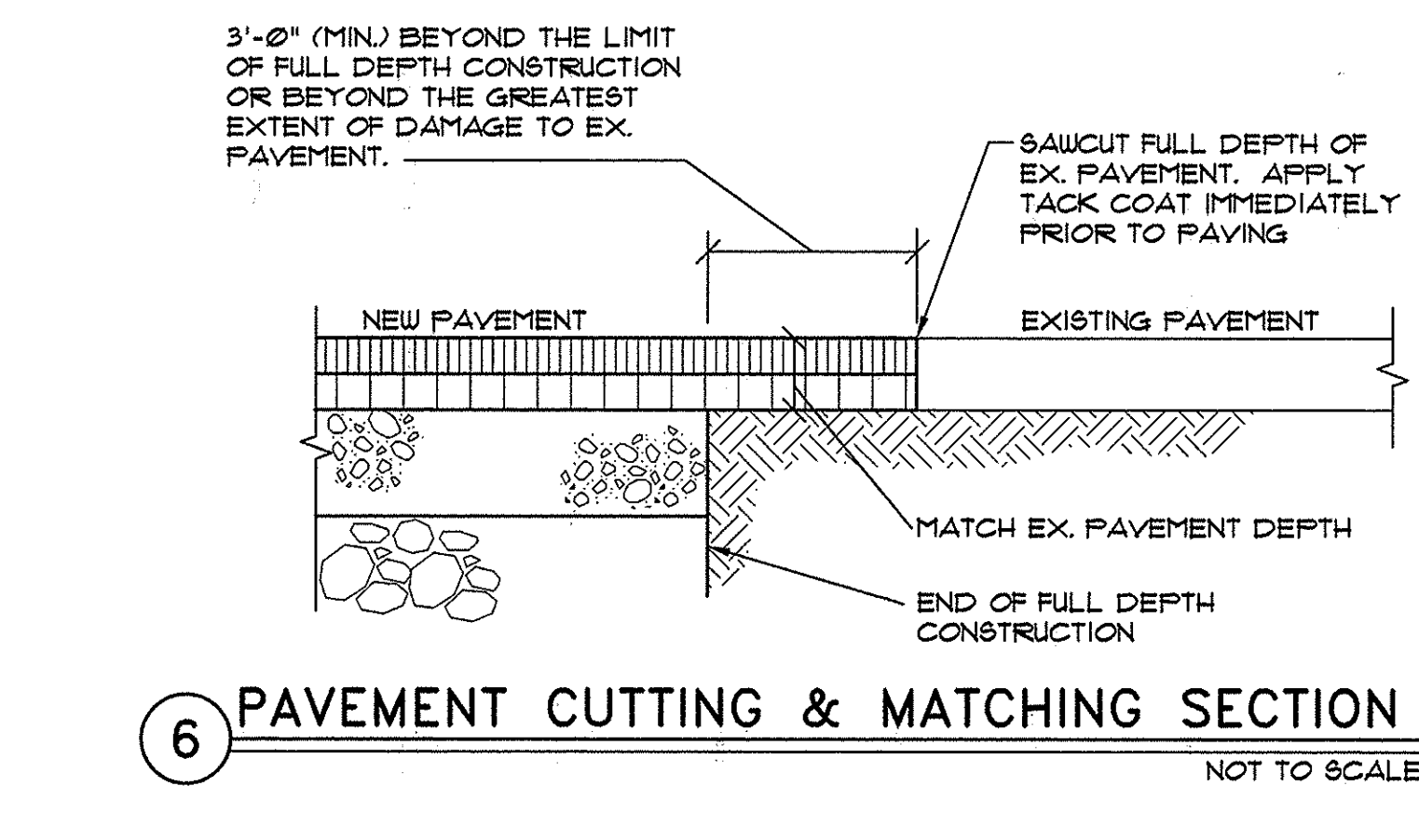

4 CONCRETE SIDEWALK SECTION (1-14)
NOT TO SCALE

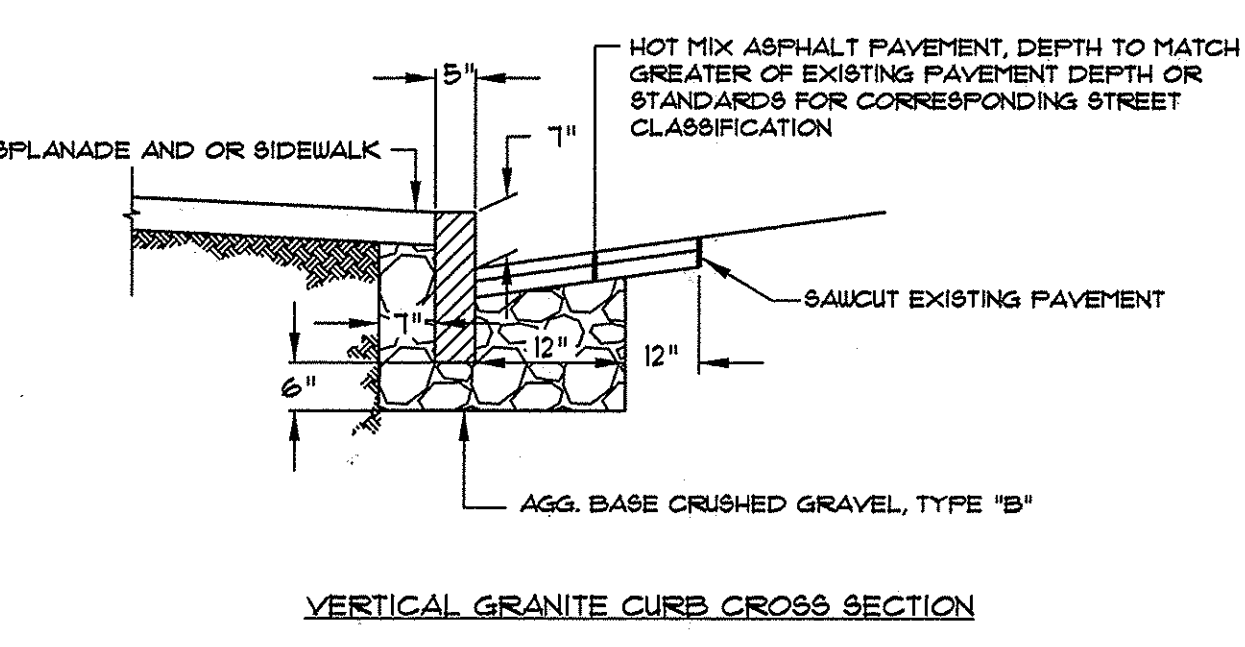

8 VERTICAL GRANITE CURB INSTALLATION IN EXISTING STREETS (1-17)
NOT TO SCALE

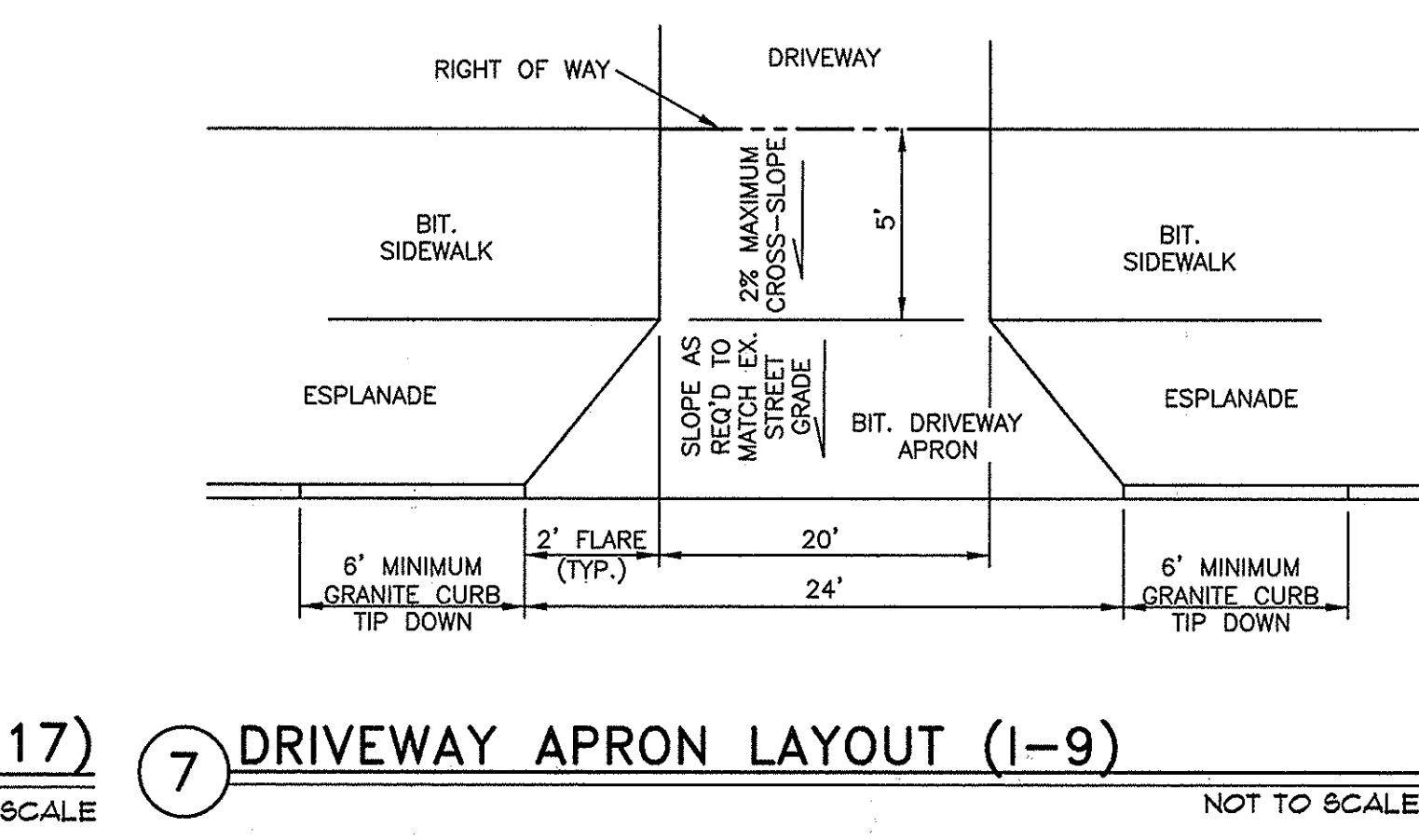

7 DRIVEWAY APRON LAYOUT (1-9)
NOT TO SCALE

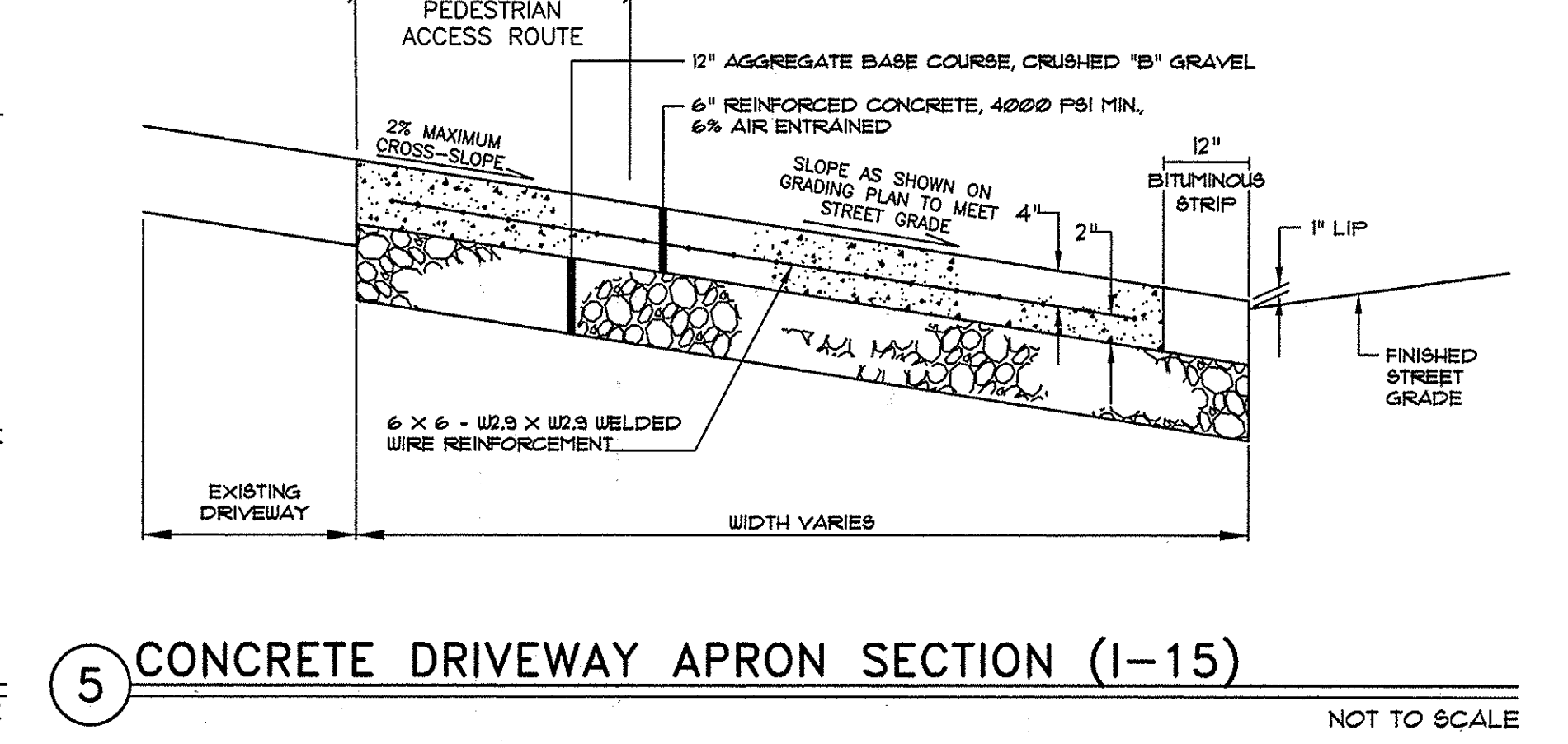

5 CONCRETE DRIVEWAY APRON SECTION (1-15)
NOT TO SCALE

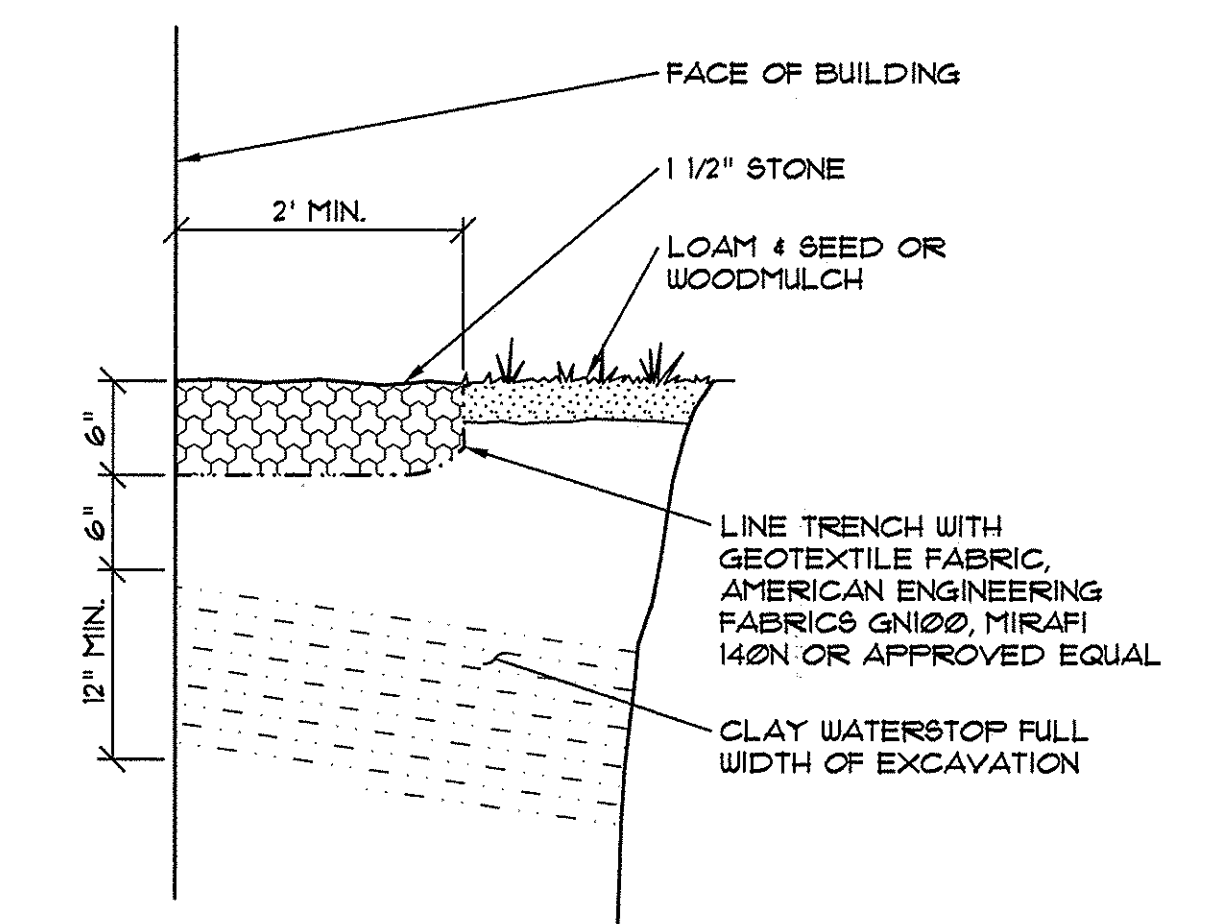

10 STONE DRIPSTRIP SECTION
NOT TO SCALE

CONCRETE BIKE & EQUIPMENT PADS

8\"/>

BITUMINOUS PARKING LOT

1 1/4\"/>

PAVERS WALK & PATIO

EXTEND BASE 4\"/>

CITY PAVEMENT SIDEWALK & DRIVEWAY

SEE DETAILS 4 & 5

NOTES:
1. HMA = HOT MIX ASPHALT.
MDOT = MAINE DEPARTMENT OF TRANSPORTATION.
2. ALL COURSE THICKNESS AFTER FINAL COMPACTION.

9 SCHEDULE OF SURFACE FINISHES
NOT TO SCALE

VANNAH WHITE, INC.
28 VANNAH AVENUE, PORTLAND, ME

THE 28, a condominium
28 VANNAH AVENUE, PORTLAND, MAINE

SCALE: AS SHOWN
DATE: MARCH 5, 2018
PROJECT: 17185

DRN BY: JDC
DESG BY: TSG
CHK BY:

DESCRIPTION
DATE
REV.

C3.1

MAPLOT 129 / F / 9 & 11

SITE DETAILS