

EROSION CONTROL NOTES

GENERAL:

- DURING CONSTRUCTION THE CONTRACTOR IS REQUIRED TO HAVE A MAINTENANCE AND INSPECTION PLAN FOR STORMWATER CONTROL AND EROSION CONTROL DEVICES. INSPECT THE DISTURBED AREAS ONCE PER WEEK AND BEFORE AND AFTER RAIN STORMS. REPAIR OR CORRECT ANY AREAS THAT ARE DEFICIENT WITHIN 7 CALENDAR DAYS. KEEP A LOG OF THE INSPECTIONS AND NOTE ANY CORRECTIVE ACTION TAKEN. THE LOG MUST BE AVAILABLE FOR REVIEW BY THE TOWN AND DEP. KEEP RECORDS FOR 3 YEARS.
- THE DRAWINGS DEPICT THE REQUIRED SOIL EROSION CONTROL MEASURES. THE CONTRACTOR IS RESPONSIBLE FOR MAINTAINING THE CONSTRUCTION SITE IN SUCH A MANNER THAT:
 - SOIL EROSION IS KEPT TO A MINIMUM.
 - NO SEDIMENT LEAVES THE CONSTRUCTION SITE PROPER.
 - ALL POSSIBLE MEASURES ARE EMPLOYED TO PREVENT SEDIMENT FROM ENTERING DRAINAGE COURSES AND WETLANDS EVEN BEYOND THE DETAILS SHOWN ON THIS PLAN IF NECESSARY.
- ALL EROSION CONTROL MEASURES SHALL BE CONSTRUCTED AND MAINTAINED IN ACCORDANCE WITH THE MAINE EROSION AND SEDIMENT CONTROL BMPs PUBLISHED BY THE BUREAU OF LAND AND WATER QUALITY, MAINE DEPARTMENT OF ENVIRONMENTAL PROTECTION, MARCH 2016.
- THE CONTRACTOR IS RESPONSIBLE FOR ALL FINES RESULTING FROM EROSION OR SEDIMENTATION FROM THE SITE TO SURROUNDING PROPERTIES, WATERBODIES, OR WETLAND AS A RESULT OF THIS PROJECT.
- LOAM AND SEED ALL DISTURBED AREAS AS SOON AS POSSIBLE AFTER DISTURBANCE, BUT NO LONGER THAN 1 DAYS. LOAM AND SEED ANY DISTURBED AREA WITHIN 75' OF WETLANDS OR WATERBODIES WITHIN 48 HOURS OR PRIOR TO AND STORM EVENT. USE WINTER SEED RATES AND SPECIFICATIONS IF APPROPRIATE.
- INSPECT SOIL EROSION MEASURES WEEKLY AND AFTER SIGNIFICANT STORM EVENTS. MAKE ALL NECESSARY REPAIRS TO FACILITIES AS SOON AS POSSIBLE, BUT NO LONGER THAN 2 DAYS. CLEAN AND RESET SILT FENCES AND STONE CHECK DAMS WHICH ACCUMULATE SEDIMENT AND DEBRIS.
- PROTECT AND STABILIZE ALL AREAS NOT SCHEDULED FOR EROSION PREVENTION OR STABILIZATION BUT THAT SHOW SIGNS OF EROSION. NOTIFY OWNER OF ANY SIGNIFICANT EROSION PROBLEM.
- APPLY MULCH TO BARE SOILS WITHIN 7 DAYS OF INITIAL DISTURBANCE OF SOILS, WITHIN 48 HOURS IF WITHIN 75' OF WETLAND OR WATERBODY, PRIOR TO ANY RAIN EVENT, OR PRIOR TO ANY WORK SHUTDOWN LASTING MORE THAN ONE DAY.
- TEMPORARILY SEED WITHIN 7 DAYS ANY AREA WHICH WILL BE LEFT DISTURBED AND UNWORKED FOR MORE THAN 14 DAYS WITH THE TEMPORARY SEED MIX LISTED BELOW. IF AREA IS WITHIN 75' OF A WETLAND OR WATERBODY, SEED WITHIN 48 HOURS. PERMANENTLY SEED ANY AREA WHICH CAN BE LOAMED AS SOON AS POSSIBLE WITH THE PERMANENT SEED MIX LISTED BELOW. DO NOT USE PERMANENT SEED MIX AFTER SEPTEMBER 15.
- MULCH ALL AREAS SEED SO THAT SOIL IS NOT VISIBLE THROUGH THE MULCH REGARDLESS OF THE APPLICATION RATE. DURING THE GROWING SEASON (APRIL 15 - SEPT. 30) USE EROSION CONTROL MESH (OR MULCH AND NETTING) ON:
 - THE BASE OF GRASSSED WATERWAYS
 - SLOPES STEEPER THAN 15%
 - WITHIN 100 FT. OF STREAMS AND WETLANDS
 BETWEEN OCT. 1 AND APRIL 14 USE EROSION CONTROL MESH (OR MULCH AND NETTING) ON:
 - SIDE SLOPES OF GRASSSED WATERWAYS
 - SLOPES STEEPER THAN 8%
- INSTALL EROSION CONTROL MESH IN ACCORDANCE WITH MANUFACTURERS RECOMMENDATIONS. MESH TO BE EQUAL TO NORTH AMERICAN GREEN PRODUCT C125EN.
- FOLLOW SILT FENCE MANUFACTURER'S SPECIFICATIONS AND RECOMMENDATIONS FOR INSTALLATION OF SILT FENCE. SECURE ENTIRE BOTTOM OF FENCE EITHER BY BURYING BOTTOM OF FENCE IN A TRENCH OR BERMING WITH SOIL OR CHIPPED GRUBBINGS. REFER TO SILT FENCE DETAILS.
- PLACE AND GRADE LOAM IN A REASONABLY UNIFORM MANNER. WORK LIME AND FERTILIZER INTO THE SOIL TO A DEPTH OF 4 INCHES WITH A DISC, SPRING TOOTH HARROW OR OTHER SUITABLE EQUIPMENT. CONTINUE TILLAGE UNTIL A REASONABLY UNIFORM SEED BED IS PREPARED. REMOVE FROM SURFACE ALL STONES LARGER THAN 2" AND ALL OTHER UNSUITABLE MATERIAL. LIME AND FERTILIZER SHOULD BE MIXED INTO SOIL PRIOR TO ROLLING EXCEPT IF INCLUDED IN HYDROSEED MIXTURE. PERMANENT STABILIZATION OF REVEGETATED AREAS IS CONSIDERED AS 95% CATCH.
- ALL CATCH BASINS, NEW OR EXISTING, THAT MAY RECEIVE RUNOFF FROM DISTURBED AREAS MUST BE PROTECTED BY INSTALLING AND MAINTAINING SILT BAGS DURING CONSTRUCTION.
- WATER FROM CONSTRUCTION TRENCH DEWATERING OR TEMPORARY STREAM DIVERSION WILL PASS FIRST THROUGH A FILTER BAG OR SECONDARY CONTAINMENT STRUCTURE (E.G. HAY BALE OR EROSION CONTROL MIX LINED POOL) PRIOR TO DISCHARGE. THE DISCHARGE SITE SHALL BE SELECTED TO AVOID FLOODING, ICING, AND SEDIMENT DISCHARGES TO A PROTECTED RESOURCE. IN NO CASE SHALL THE FILTER BAG OR CONTAINMENT STRUCTURE BE LOCATED WITHIN 100 FEET OF A PROTECTED NATURAL RESOURCE.

TOPSOIL:

- SUITABLE TOPSOIL SALVAGED FROM SITE OR SCREENED, LOOSE AND FRIABLE SANDY LOAM OR LOAM AS DEFINED BY THE USDA SOIL CONSERVATION SERVICE CLASSIFICATION SYSTEM, FREE FROM ADMIXTURE OF SUBSOIL, REFUSE, LARGE STONES, CLODS, ROOTS, WEEDS, RHIZOMES OR OTHER UNDESIRABLE FOREIGN MATTER AS DETERMINED BY THE INSPECTING AUTHORITY. CONTRACTOR SHALL SUBMIT REPORTS OF LOAM TEST RESULTS PERFORMED BY AN INDEPENDENT TESTING LABORATORY FOR TOPSOIL FROM DIFFERENT SOURCES PRIOR TO PLACING. THE COST OF TESTING SHALL BE INCIDENTAL TO THE COST OF TOPSOIL. TOPSOIL SHALL MEET THE FOLLOWING SPECIFICATIONS:
 - MATERIAL
 - SAND - 0.002 IN. TO 0.0025 IN. DIAMETER (% BY VOLUME) 45 - 75
 - SILT - 0.0025 IN. TO 0.0075 IN. DIAMETER (% BY VOLUME) 20 - 40
 - CLAY - LESS THAN 0.0075 IN. DIAMETER (% BY VOLUME) 5 - 15
 - ORGANICS (SHALL MEET THE REQUIREMENTS OF MDOT STANDARD SPECIFICATION 711.03 FEAT. HUMUS) (% BY VOLUME) 10 - 20
 - NUTRIENTS:
 - CALCIUM (CA) (% SATURATION) 60 - 80
 - MAGNESIUM (MG) (% SATURATION) 10 - 25
 - POTASSIUM (K) (% SATURATION) 21 - 30
 - PHOSPHORUS (P) (POUNDS/ACRE) 10 - 40
 - PH 6.0 - 6.5
 - PERMEABILITY (INCHES PER HOUR) 3 - 10
 - MAXIMUM STONE SIZE (INCHES) 3/4
- SEEDING:
 - USE PERMANENT SEED MIXES AND RATES BETWEEN 5/15 AND 9/30.
 - USE TEMPORARY SEED MIXES FOR PERIODS LESS THAN 12 MONTHS. IF USING TEMPORARY SEED MIXES AND RATES BETWEEN 10/1 AND 5/14, RE-SEED WITH PERMANENT SEED MIX AFTER 5/15.
- PERMANENT SEED:
 - MDOT 711.03(a) METHOD NUMBER 3
- TEMPORARY SEED:

OATS	80.00 LBS/ACRE	4/01 - 5/14
ANNUAL RYEGRASS	40.00 LBS/ACRE	
SUDANGRASS	40.00 LBS/ACRE	5/15 - 8/14
ANNUAL RYEGRASS	80.00 LBS/ACRE	5/15 - 9/14
WINTER RYE	112.00 LBS/ACRE	9/15 - 9/30
WINTER RYE (W/ MULCH COVER)	112.00 LBS/ACRE	10/01 - 3/31
- LIME AND FERTILIZER:
 - APPLY GROUND LIMESTONE (EQUIVALENT TO 50% CALCIUM PLUS MAGNESIUM OXIDE) AT A RATE OF 3 TONS PER ACRE (135 POUNDS PER 1000 SQUARE FEET). APPLY FERTILIZER (10-20-20) AT A RATE OF 800 POUNDS PER ACRE (18.4 POUNDS PER 1000 SQUARE FEET).
- MULCH:

STRAW OR HAY (ANCHORED)	10 - 30 LBS	PROTECTED AREAS
STRAW OR HAY (ANCHORED)	185 - 215 LBS	WINDY AREAS
SHREDDED OR CHOPPED	185 - 215 LBS	
JUTE MESH	AS REQUIRED	MODERATE TO HIGH VELOCITY AREAS & STEEP SLOPES
- EXCELSIOR MAT AS REQUIRED
- MULCH ANCHORING
 - PEG AND TWINE LIQUID ASPHALT
 - MULCH NETTING WOOD CELLULOSE FIBER
 - ASPHALT EMULSION CHEMICAL TACK

HOUSEKEEPING NOTES

- THE DEVELOPER IS RESPONSIBLE FOR NOTIFYING THE CONTRACTOR AND OWNER OF THE HOUSEKEEPING STANDARDS.
- SPILL PREVENTION: THE CONTRACTOR AND OWNERS NEED TO TAKE CARE WITH CONSTRUCTION AND WASTE MATERIALS SUCH THAT CONTAMINATES DO NOT ENTER THE STORMWATER. THE STORAGE OF MATERIALS SUCH AS PAINT, PETROLEUM PRODUCTS, CLEANING AGENTS AND THE LIKE ARE TO BE STORED IN WATERTIGHT CONTAINERS. THE USE OF THE PRODUCTS SHOULD BE IN ACCORDANCE WITH MANUFACTURER RECOMMENDATIONS. WHEN FUELING EQUIPMENT, INCLUDING SNOWBLOWERS AND LAWNMOWERS, HAVE OIL ABSORBENT PADS AVAILABLE BELOW THE FUELING.
 - STAGING AREAS ARE NOTED ON THE CONSTRUCTION MANAGEMENT PLAN FOR THE CONTRACTOR'S USE. REFUELING OF SMALL ENGINES BY THE OWNER SHOULD OCCUR ON A PAVED SURFACE.
 - ANY SPILL OR RELEASE OF TOXIC OR HAZARDOUS SUBSTANCES MUST BE REPORTED TO THE DEPARTMENT. FOR OIL SPILLS, CALL 1-800-452-0111 WHICH IS AVAILABLE 24 HOURS A DAY. FOR SPILLS OF TOXIC OR HAZARDOUS MATERIAL, CALL 1-800-452-4664 WHICH IS AVAILABLE 24 HOURS A DAY. FOR MORE INFORMATION, VISIT THE DEPARTMENT'S WEBSITE AT: [HTTP://WWW.MAINE.GOV/DEP/SPILLS/EMERGSPILLS/](http://www.maine.gov/dep/spills/emergspills.asp/)
 - GROUNDWATER PROTECTION: PROTECTION OF THE GROUNDWATER IS REQUIRED BY THE CONTRACTOR AND OWNER. PETROLEUM PRODUCTS SHOULD BE STORED IN MANUFACTURED CANS DESIGNED FOR THE PURPOSE. SPILL PREVENTION PROCEDURES SHOULD BE FOLLOWED.
 - FUGITIVE SEDIMENT AND DUST: THE CONTRACTOR IS REQUIRED TO MINIMIZE DUST FROM THE CONSTRUCTION OPERATION. THE ROAD SHOULD BE SWEPT REGULARLY (WEEKLY) AND PRIOR TO ANY RAIN EVENT. THE GRAVEL AREAS ARE TO BE WATERED REGULARLY TO MINIMIZE DUST. ANY MUD THAT IS TRACKED OFF SITE SHOULD BE CLEANED UP PRIOR TO IT DRYING AND BECOMING A DUST ISSUE. DO NOT USE OIL TO CONTROL DUST.
 - DEBRIS AND OTHER MATERIALS: CONSTRUCTION MATERIALS AND CONSTRUCTION DEBRIS SHOULD BE COVERED TO PREVENT RAINWATER FROM WASHING CONTAMINANTS OFF THE SITE. ANY FERTILIZERS, CLEANING PRODUCTS, HERBICIDES SHOULD BE PROTECTED FROM THE WEATHER AND USED IN ACCORDANCE WITH MANUFACTURERS RECOMMENDATIONS.
- NOTE ANY CONTAMINANTS THAT ARE WASHED OFF THE SITE BY RAINWATER IS A VIOLATION OF THE CLEAN WATERS ACT.
- STORAGE HANDLING AND DISPOSAL OF SOLID WASTE ITEMS MUST COMPLY WITH MAINE'S SOLID WASTE MANAGEMENT RULES. LACK OF APPROPRIATE POLLUTANT CONTROL MAY RESULT IN VIOLATIONS OF THE GROUNDWATER QUALITY STANDARDS.
- THIS PROJECT HAS A WRITTEN EROSION CONTROL PLAN AND STORMWATER MAINTENANCE PLAN. MODIFICATIONS TO THE PLAN MUST BE APPROVED BY THE CITY.
- MAINTENANCE OF THE SITE MUST OCCUR REGULARLY. THE STORMWATER MAINTENANCE REPORT PROVIDES INSPECTION DETAILS AND TIME LINES FOR DOING THE INSPECTIONS AND REPORTING TO THE CITY.

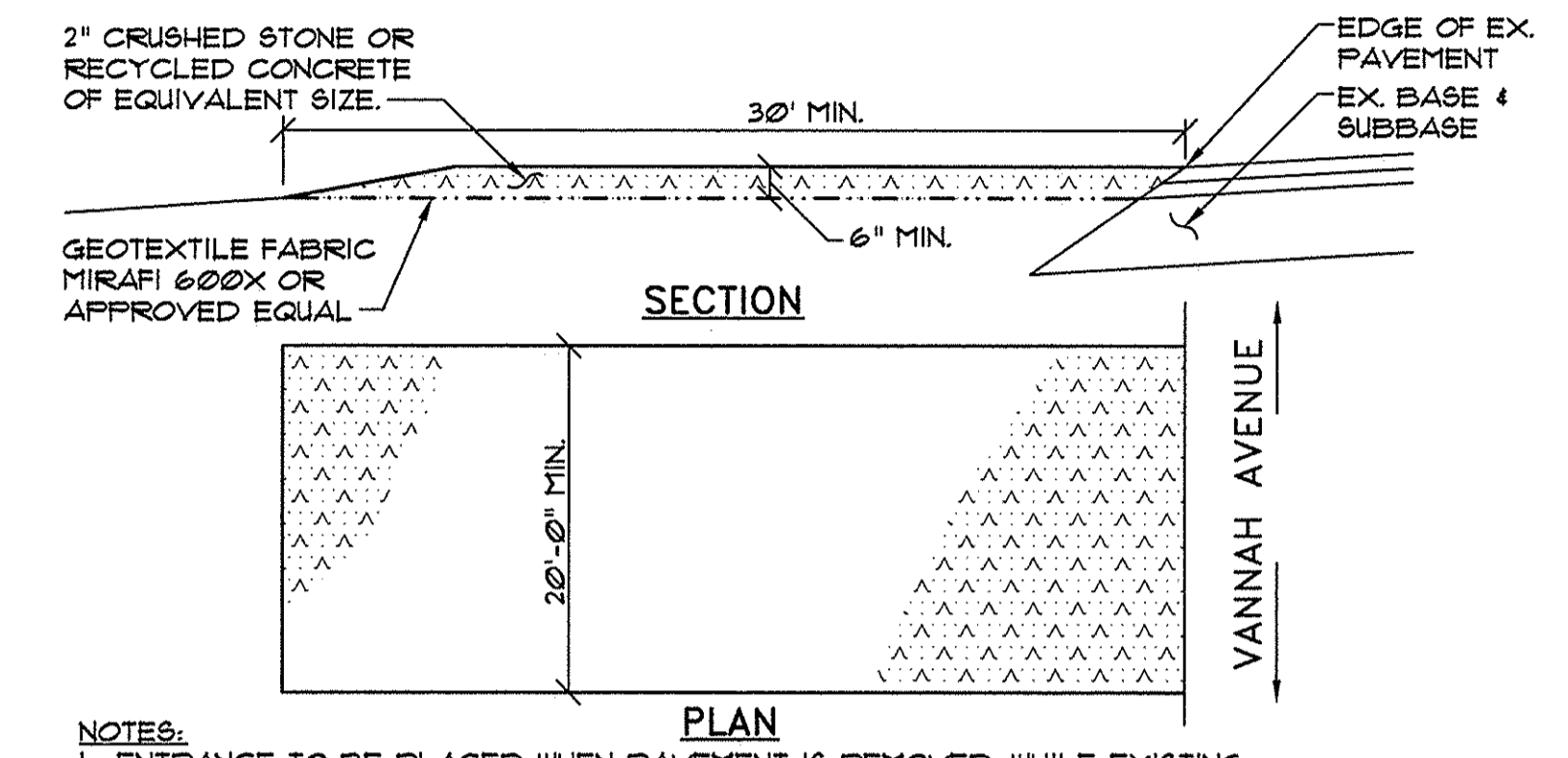

- NOTES:**
- ENTRANCE TO BE PLACED WHEN PAVEMENT IS REMOVED. WHILE EXISTING PAVEMENT REMAINS THE ENTRANCE IS NOT REQUIRED.
 - MAINTAIN ENTRANCE IN A CONDITION THAT WILL PREVENT TRACKING OF SEDIMENT ONTO PUBLIC RIGHT-OF-WAY. IF WASHING IS REQUIRED PREVENT SEDIMENT FROM ENTERING WATERWAYS, DITCHES OR STORM DRAINS.
 - REMOVE STABILIZED CONSTRUCTION ENTRANCE AFTER EXCAVATION IS COMPLETE.

1 STABILIZED CONSTRUCTION ENTRANCE DETAIL
NOT TO SCALE

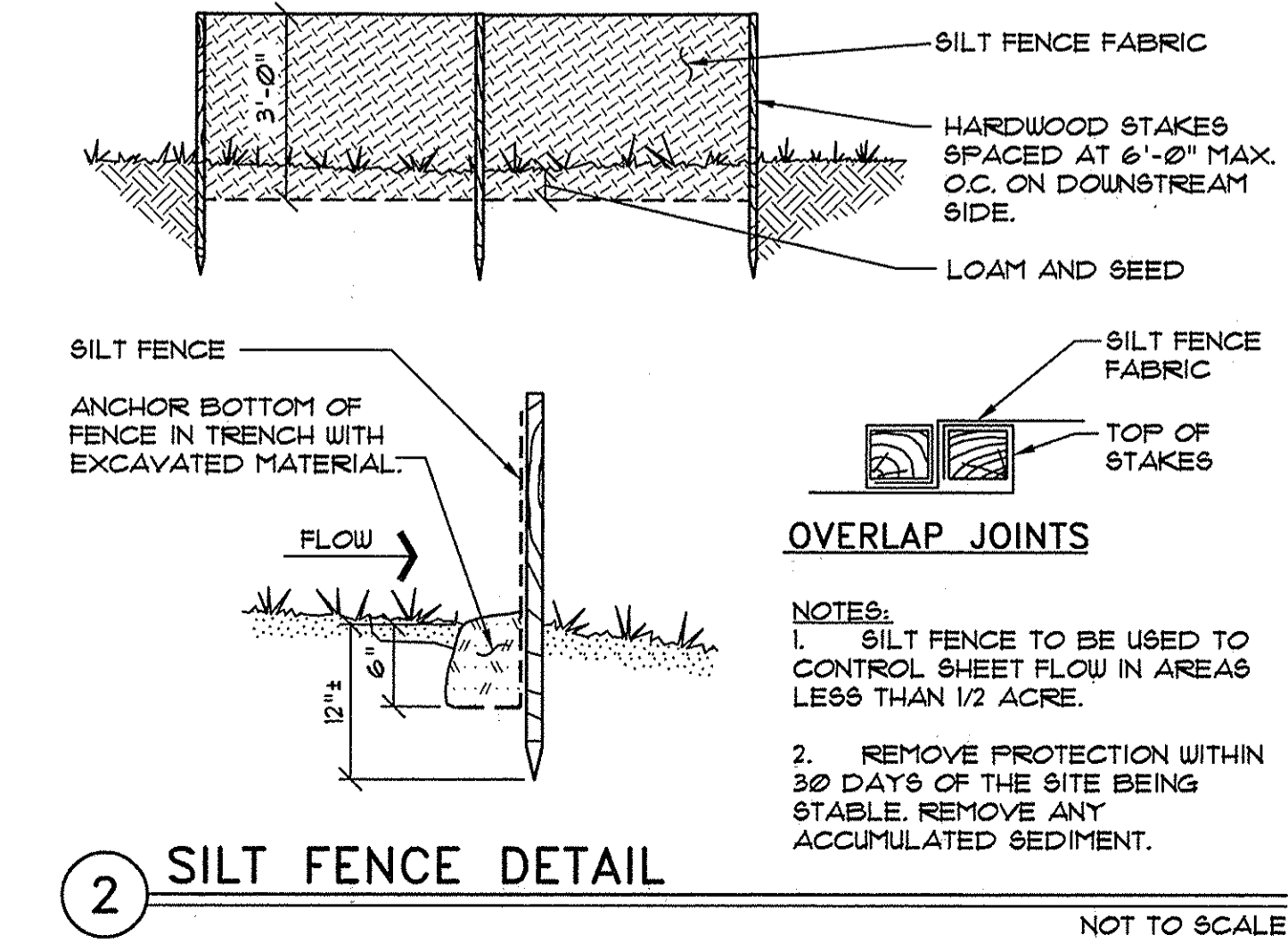

2 SILT FENCE DETAIL
NOT TO SCALE

EROSION CONTROL LEGEND

- SILT FENCE
 - STABILIZED CONSTRUCTION ENTRANCE
- FOR PLAN LEGEND SEE SHEET C2.3

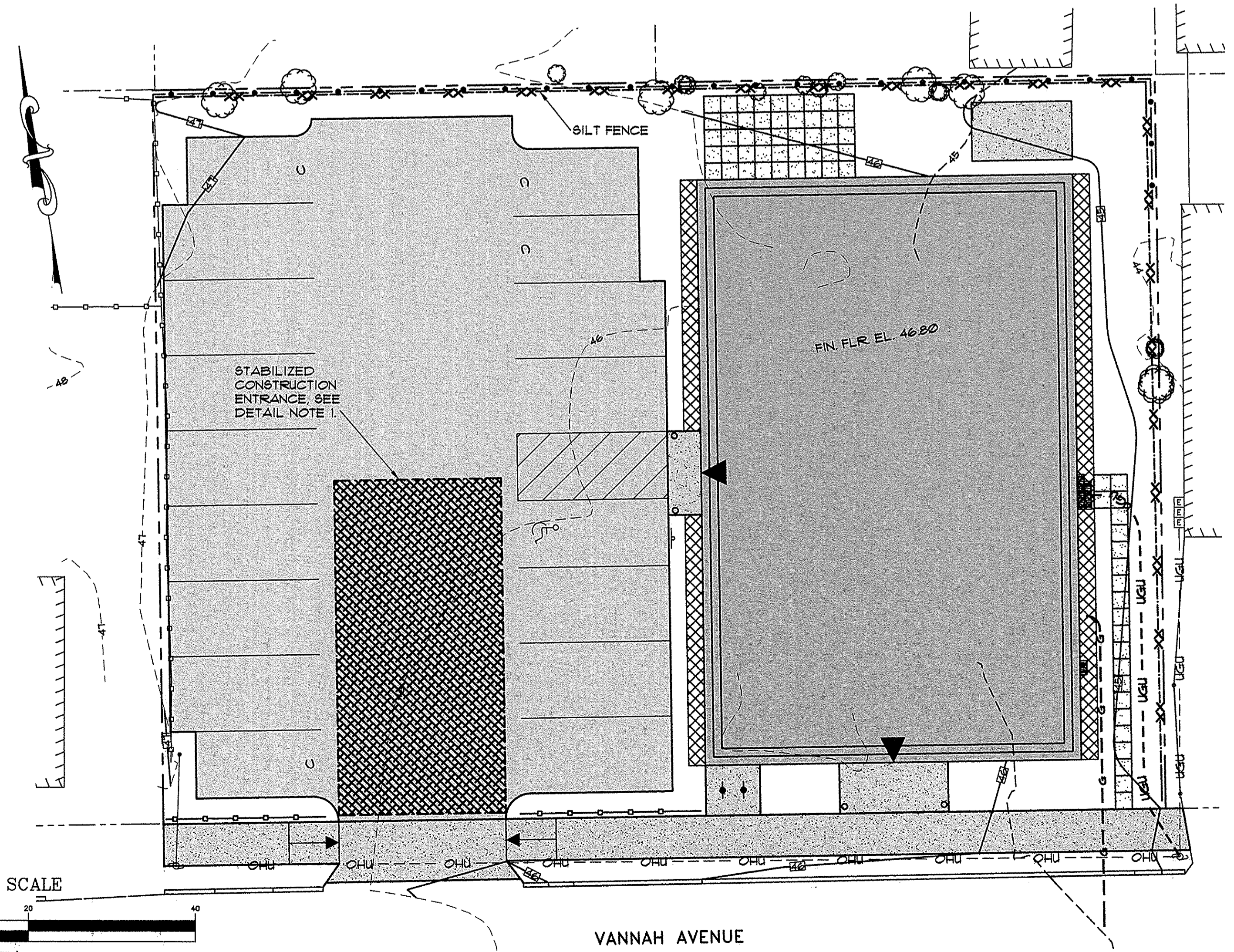
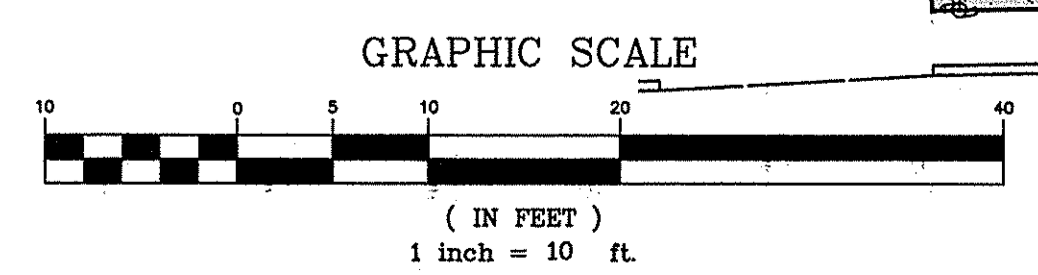

PINKHAM & GREER
CIVIL ENGINEERS
28 VANUAH AVE. PORTLAND, ME. 04103
TEL: 207.761.5242 FAX: 207.761.6245

REV.	DATE	DESCRIPTION

VANUAH WHITE, INC.
28 VANUAH AVENUE, PORTLAND, ME

SCALE: AS SHOWN
DATE: MARCH 5, 2018
PROJECT: 17768

THE 28, a condominium
28 VANUAH AVENUE
PORTLAND, MAINE

DRN BY: JDC
DESIGN BY: TSG
CHK BY:

EROSION CONTROL PLAN, NOTES & DETAILS

C2.4

MAPLOT 129/F19 & 11