

# FOR MORTGAGE LENDER USE ONLY

**GENERAL NOTES:** (1) DISTANCES SHOWN ARE TAKEN FROM PROVIDED TITLE REFERENCES SHOWN BELOW. (2) THE PURPOSE OF THIS INSPECTION IS TO RENDER AN OPINION AS FOLLOWS: A) DWELLING AND ACCESSORY STRUCTURE'S COMPLIANCE WITH RESPECT TO MUNICIPAL ZONING SETBACKS, AND B) FLOOD ZONE DETERMINATION BY HORIZONTAL SCALING ON BELOW REFERENCED FEMA MAP. (3) THIS INSPECTION EXCEPTS OUT ALL TECHNICAL STANDARDS CURRENTLY SET FORTH BY STATE OF MAINE BOARD OF LICENSURE FOR PROFESSIONAL LAND SURVEYORS. (4) THIS INSPECTION IS TO BE USED ONLY BY THE BELOW LISTED LENDER AND IS NOT TO BE USED BY ANOTHER PARTY FOR BOUNDARY LINE LOCATIONS OR LAND TITLE OPINIONS. (5) TITLE OR OWNERSHIP NOT DETERMINED. (6) A BOUNDARY SURVEY SHOULD BE PERFORMED TO RENDER A PROFESSIONAL OPINION PERTAINING TO BOUNDARY LINE LOCATIONS, EASEMENTS, RIGHTS OF WAY, ENCUMBRANCES, ENCROACHMENTS, AND/OR CONFLICTS WITH ADJUTTER'S DEEDS. (7) LOCATION/EXISTENCE OF WETLANDS NOT DETERMINED UNLESS SHOWN ON A RECORDED SUBDIVISION PLAN.

REV. 09/22/2009

**THIS SKETCH IS NOT TO BE USED FOR CONSTRUCTION PURPOSES, IMPROVEMENTS SHOWN ARE APPROXIMATE.**

ADDRESS: 75 Bay View Drive  
Portland, Maine

INSP. DATE: 4/12/2013  
SCALE: 1" = 30'

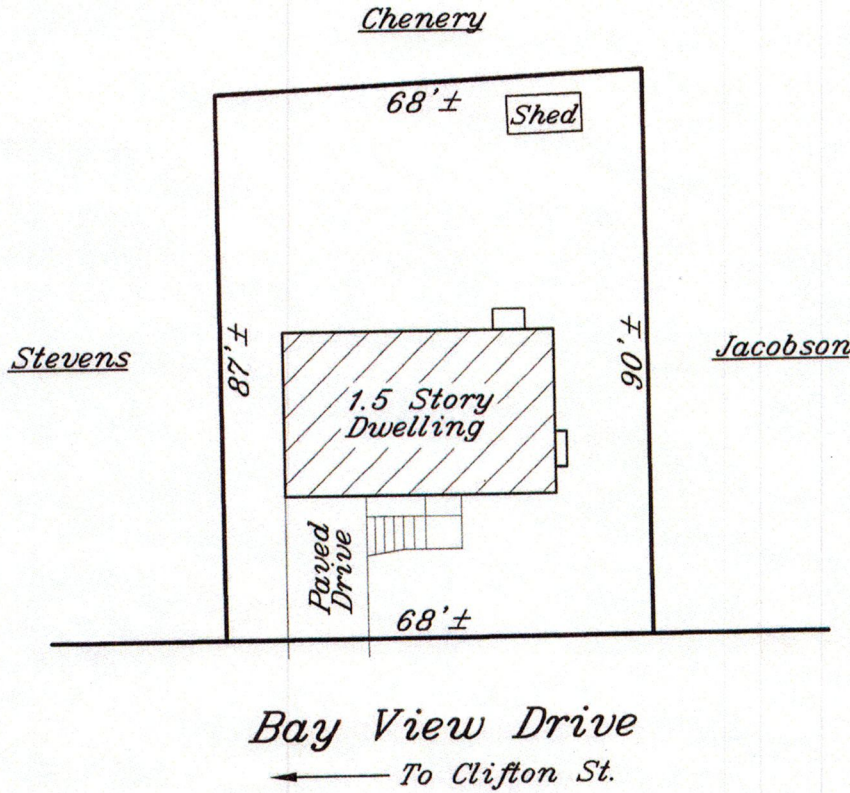

MLC

SEE PROVIDED TITLE REFERENCES FOR APPURTENANCES, IF ANY.

APPLICANT: Kamilewicz & Plager FILE#: 21325618  
OWNER: Betty G. Rathbun CLIENT#: \_\_\_\_\_  
LENDER: Bangor Savings Bank  
REQ. PARTY: Atlantic Coast Title Company, LLC

TITLE REFERENCES: \_\_\_\_\_ COUNTY: Cumberland  
DEED BOOK: 22818 PAGE: 289  
PLAN BOOK: \_\_\_\_\_ PAGE: \_\_\_\_\_ LOT: \_\_\_\_\_

MUNICIPAL REFERENCE:  
MAP: 128 BLOCK: G LOT: 17+18

THE DWELLING DOES NOT FALL WITHIN A SPECIAL FLOOD HAZARD AREA PER FEMA COMMUNITY MAP No. 230051 PANEL: 0007C  
ZONE: C DATE: 12/8/1998

THE DWELLING WAS ██████ IN COMPLIANCE WITH MUNICIPAL ZONING SETBACK REQUIREMENTS AT THE TIME OF CONSTRUCTION.

**Nadeau Land Surveys**

Professional Land Surveyors  
Certified Floodplain Managers

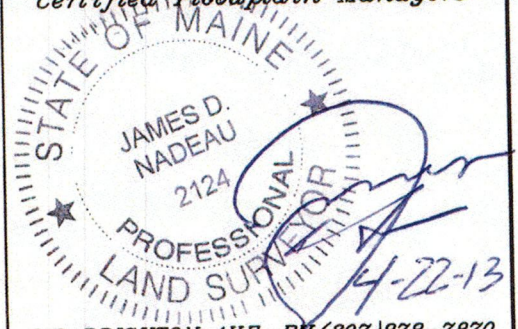

918 BRIGHTON AVE. PH. (207) 878-7870  
PORTLAND, ME. 04102 F. (207) 878-7871

THIS INSPECTION IS VALID ONLY WITH A SURVEYOR'S SEAL AND IS NULL & VOID 90 DAYS AFTER INSPECTION DATE.

**THIS IS NOT A BOUNDARY SURVEY - NOT FOR RECORDING**