

- NOTES:**
- UPON COMPLETION OF UTILITY WORK, WOODFORD STREET SHALL RECEIVE FULL DEPTH RECONSTRUCTION. THE TOTAL WIDTH OF THE RECONSTRUCTED ROADWAY WILL VARY TO MATCH THE EXISTING CURB LINE. RECONSTRUCTION OF ROADWAY SHALL INCLUDE REMOVAL OF PAVEMENT AND EXCAVATION, PLACEMENT OF 15 INCHES OF SUBBASE (TYPE D) GRAVELS AND 3 INCHES OF BASE (TYPE A) GRAVELS AND PAVING. PAVING SHALL INCLUDE 2 INCHES OF 19.0 MM BINDER AND 1.5 INCHES OF 12.5 MM SURFACE TO BE PAID UNDER BID ITEMS 403.207 AND 403.208. MAINTAIN ACCESS TO DRIVEWAYS DURING CONSTRUCTION. TEMPORARY CLOSURES MAY BE ALLOWED WITH APPROVAL OF THE ENGINEER.
  - IMPROVEMENT WORK WITHIN WOODFORD STREET INVOLVES COORDINATION WITH MULTIPLE UTILITIES AND WORK WITHIN CLOSE PROXIMITY TO UTILITIES. CONTRACTOR SHALL COORDINATE ALL WORK WITH UTILITY AGENCIES, COMPLY WITH UTILITY AGENCY REQUIREMENTS AND SHALL SUPPORT AND PROTECT EXISTING UTILITIES THROUGHOUT CONSTRUCTION. WORK SHALL BE CONSIDERED INCIDENTAL TO THE RELATED PAY ITEMS.
  - CATCH BASIN OFFSETS WITHIN ROADWAY ARE TO THE EDGE OF CURB AND CATCH BASIN OFFSETS OUTSIDE ROADWAY ARE TO CENTER OF GRADE. DRAIN AND SEWER MANHOLE OFFSETS ARE TO CENTER OF COVER.

STRUCTURE NAME:	DETAILS:	PIPES IN:	PIPES OUT
CB-4.2	48" RIM = 23.26 SUMP = 16.9 INV OUT = 18.91		SD-4.2, 12" HDPE INV OUT = 18.91
CB-3.1	48" RIM = 21.69 SUMP = 15.8 INV OUT = 17.75		SD-3.1, 12" HDPE INV OUT = 17.75
CB-4.1	48" RIM = 22.52 SUMP = 16.8 INV OUT = 18.82		SD-4.1, 12" HDPE INV OUT = 18.82

NAME	SIZE	LENGTH	SLOPE	MATERIAL
SD-2A	36"	6.07'	1.98%	HDPE
SD-2	36"	276.74'	1.95%	HDPE
SD-4	24"	27.46'	3.82%	HDPE
SD-3	36"	28.65'	4.47%	HDPE
SD-5	24"	141.86'	3.43%	HDPE
SD-3.1	12"	15.69'	0.96%	HDPE
SD-4.2	12"	21.53'	0.74%	HDPE
SD-1	36"	109.38'	0.44%	HDPE
SD-4.1	12"	10.10'	0.74%	HDPE

**PLAN**  
SCALE: 1"=20'

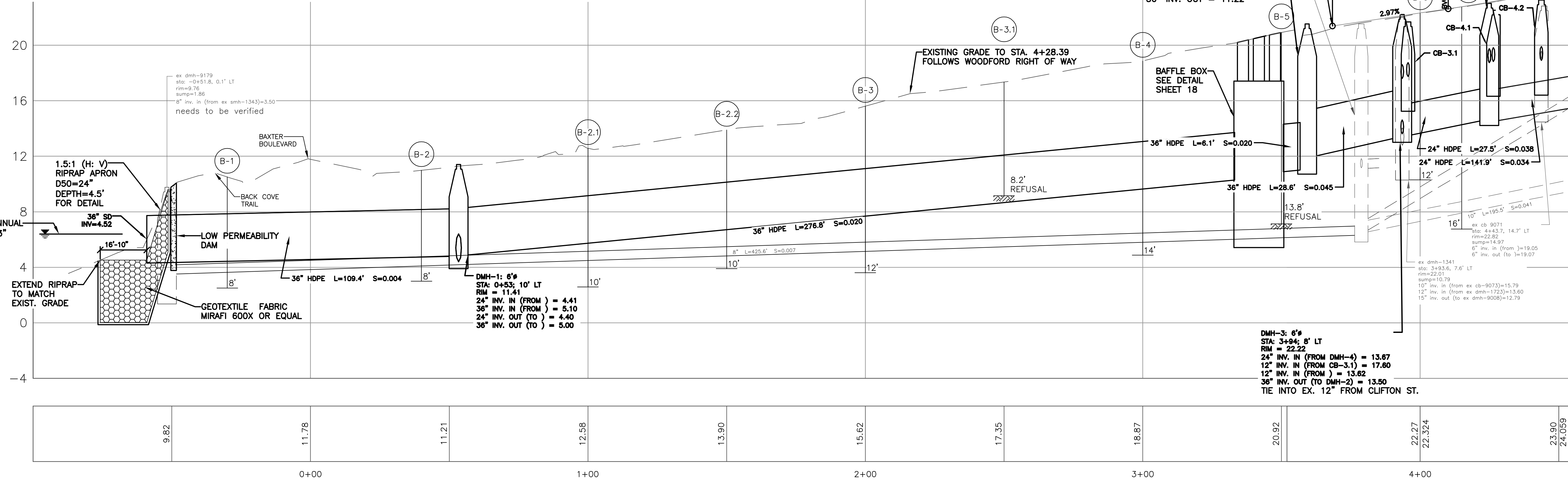

**PROFILE**  
SCALE: HORZ. 1"=20'  
VERT 1"=4'

CIVIL 3D 2013 Drawing Name: 16067 woodford pp.dwg, TAB:STA. -1+00 TO STA. 4+50  
 SURVEY CREW: SPP, DRAWN BY: BRF, CHECKED BY: DLR, SCALE: 1"=20', DATE: DEC 5, 2016  
 REFERENCES: WOODFORD STREET CSO SEPARATION PROJECT PLAN & PROFILE - WOODFORD STREET STA. -1+00 TO STA. 4+50  
 CITY OF PORTLAND, MAINE PUBLIC WORKS DEPARTMENT WATER RESOURCE DIVISION  
 CITY PROPERTY PLAN BOOK SHEETS: 1 & 1 SHEETS: III-9, III-1  
 PRELIMINARY NOT FOR CONSTRUCTION  
 DECEMBER 5, 2016  
 SHEET # 12 OF 32  
 PLAN NUMBER