

FIRST FLOOR DEMO PLAN

1/4"=1'-0"

----- INDICATES WALL OR FIXTURE TO BE REMOVED - SEE PROPOSED PLAN FOR RENOVATIONS

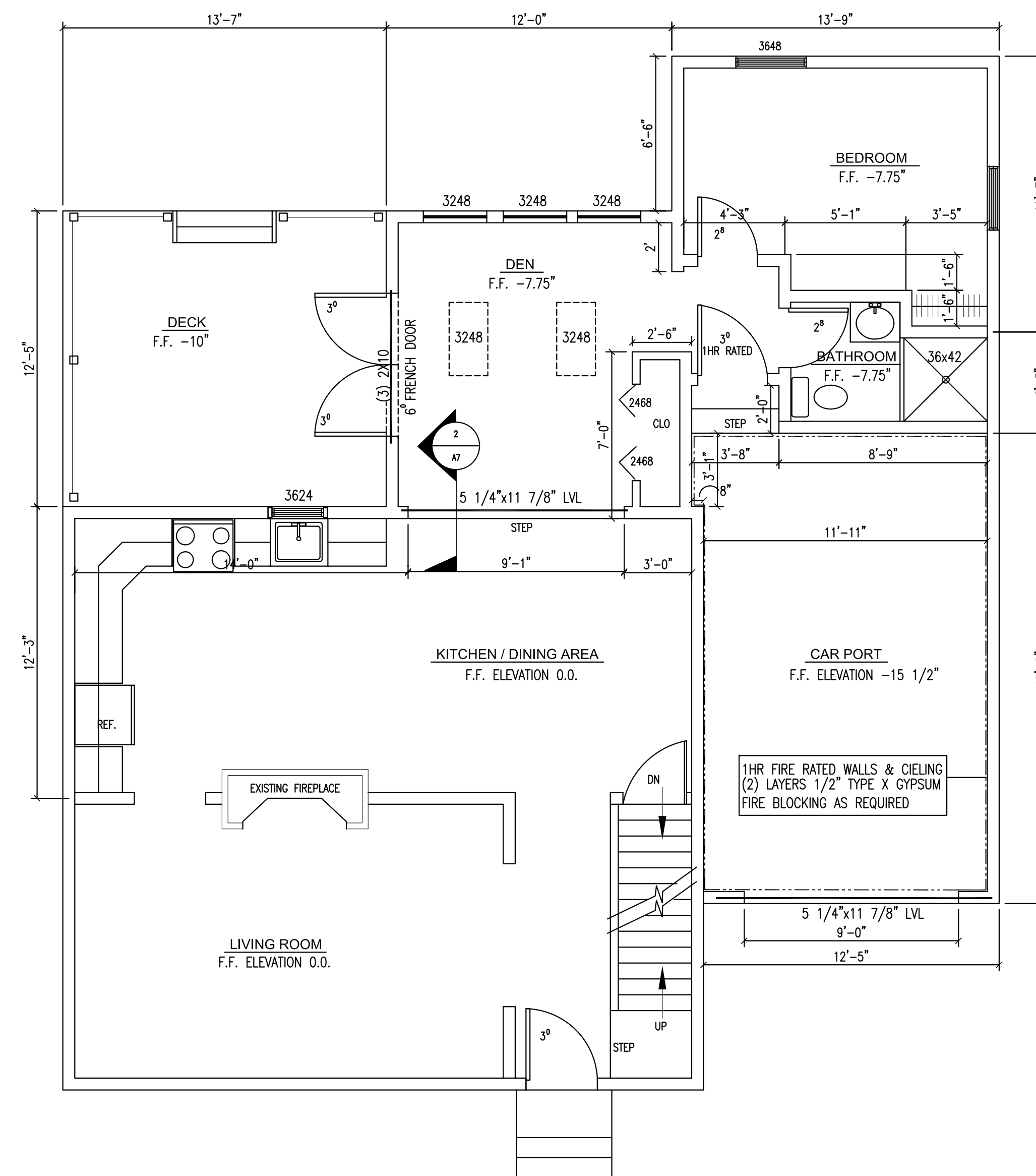

FIRST FLOOR PROPOSED FLOOR PLAN

1/4"=1'-0"

PROPERTY OF

Stephen S. Andrews
23 Panther Pond Pines Rd.
Raymond, Maine 04071
207-415-5065

DRAFTSMEN

SUSAN & BRYAN RENCH HOME PLAN
78 HERSEY ST.
PORTLAND, MAINE

| |
|-------------------------------|
| 2. |
| 1. |
| REVS: |
| CODE: |
| TOWN: PORTLAND |
| DATE: 05-25-2016 |
| SCALE: AS NOTED |
| DESIGNED: SSA |
| DRAWN: SSA |
| TITLE: |
| FIRST FLOOR PLAN & DETAILS |
| FILE: |
| SHEET: A-5 |