

SUSAN & BRYAN RENCH RESIDENCE

78 HERSEY ST, PORTLAND MAINE

Drawing List

A1	Cover Sheet/General Notes
A2	Building Elevations
A3	Building Elevation
A4	Building Foundation Plan
A5	1st Floor Demo & Proposed Plan
A6	2nd Floor Demo & Proposed Plan
A7	Cross Sections and & Typical Details

Building Information

Basement	664	sq ft
Garage	230	sq ft
First Floor	986	sq ft
Second Floor	1000	sq ft
Building Height 23'-6"		

Code Requirements

R101.2 Scope

Single Family Residence

R301.2.3 Snow Loads

The ground and roof snow load for this region is 60#/sf&42#/sf.

R301.2.4 floodplain Construction

The site of this building is not located in a floodplain

R301.5 Live Load

The building has been designed to support the live loads from table 301.5

R301.6 Roof Load

This building has been designed to support the snow loads of 42#/sf

R310 Emergency Escape and Rescue Openings

Every living room and sleeping room in this residence has been designed with an emergency escape window or door as required.

R311 Means of Egress

The means of egress for this residence have been designed to meet the requirements of this section

R311.2.2 Under Stair Protection

The accessible space beneath the stairs will be sheathed with min 1/2" GWB.

R311.3 Hallways

Hallways area a min. 36" wide

R311.5 Stairways

Stairways are a min. 36" wide
Headroom is a min. 6'-8"
Riser heights are a max. 7-3/4"
Treads are a min. 10" wide
The landing width is at least as wide as the stairway and is a min. 36" wide in the direction of travel.

R311.3.6 Handrails

Handrails will be installed on a least one wall of each stairway and shall be 34" to 38" high as measured above the nosing.

R312 Guards

Guards at porches, open sides of stairs and balconies shall be 42" high and no opening in the rail are more than 4"

R502 Wood Floor and Roof Trusses

By: Aroostook trusses or Similar

R602 Wood Fastening

Refer to table R602.3 for wood fastener requirements

R313 Smoke Alarms

Smoke alarms shall be installed:
in each sleeping room
outside each sleeping area
On each additional story, including the basement
Carbon Monoxide monitors shall be installed in ea. area giving access to bedrooms.
Alarms shall be installed per NFPA 72

R315 Flame Spread and Smoke Density

Finishes shall have a flame spread classification of no greater than 200 and a smoke-developed index of no greater than 450.

Chapter 11 Energy Efficiency

Roofs shall have a min. rating of R-38 (R60 ACTUAL)
Exterior walls shall have a min. rating of R-21(R-34)
Floors above garage spaces shall have a min. rating of R-21(R-54)
Floors above basement spaces shall have a min. rating of R-21
Windows shall have a U-factor of 0.35 (0.21)



PROPOSED FRONT ELEVATION

N.T.S.

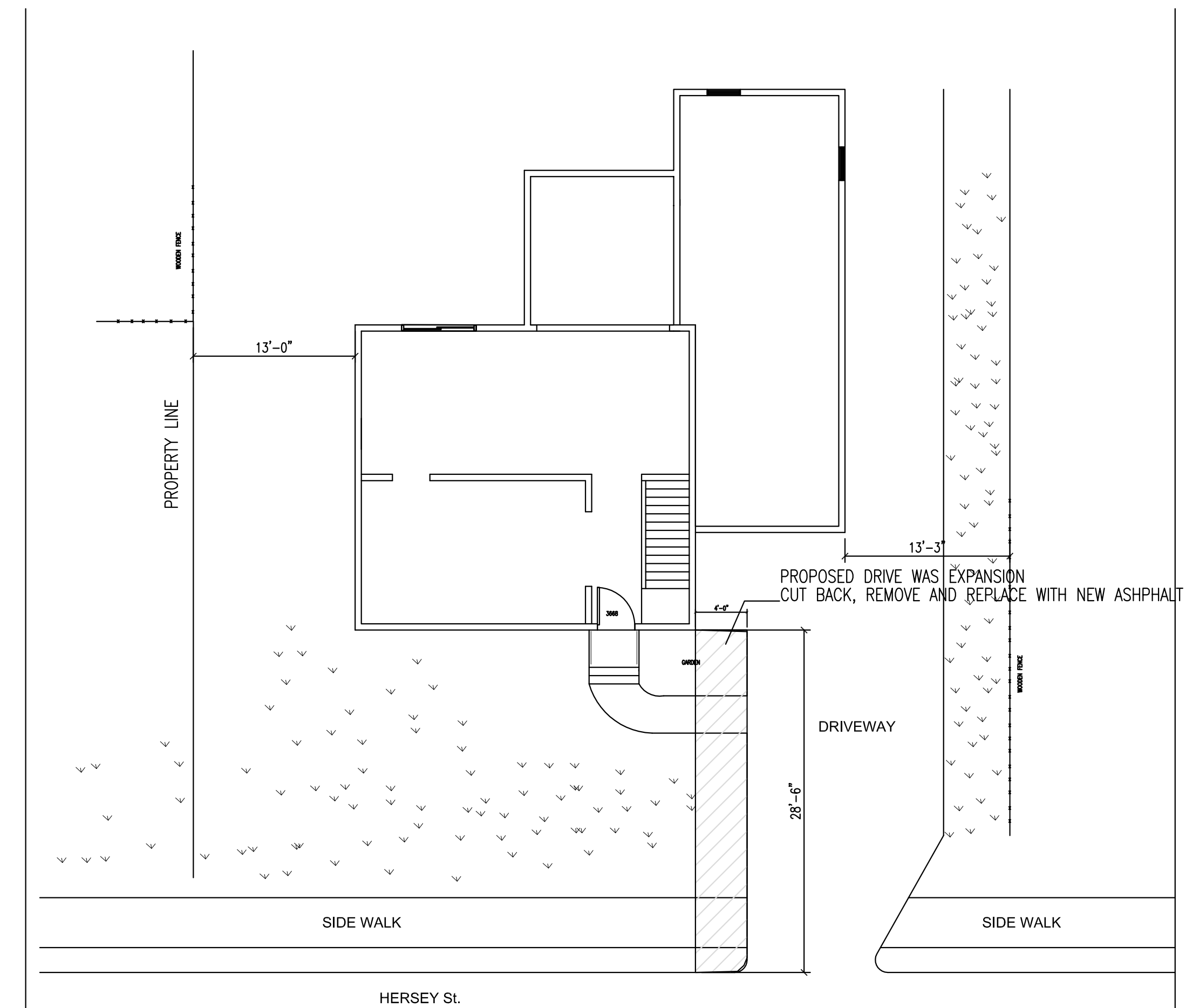

SITE PLAN

N.T.S.

PROPERTY OF

DRAFTSMEN:
Stephen S. Andrews
23 Panter Pond Pines Rd.
Raymond, Maine 04071
207-415-5065

SUSAN & BRYAN RENCH HOME PLAN
78 HERSEY ST.
PORTLAND, MAINE

2.

1.

REVS:

CODE:

TOWN: PORTLAND

DATE: 05-25-2016

SCALE: AS NOTED

DESIGNED: SSA

DRAWN: SSA

TITLE:

GENERAL NOTES:
COVER PAGE

FILE:

SHEET: A1