

20 DEMOLITION PLAN  
3/16" = 1'-0"

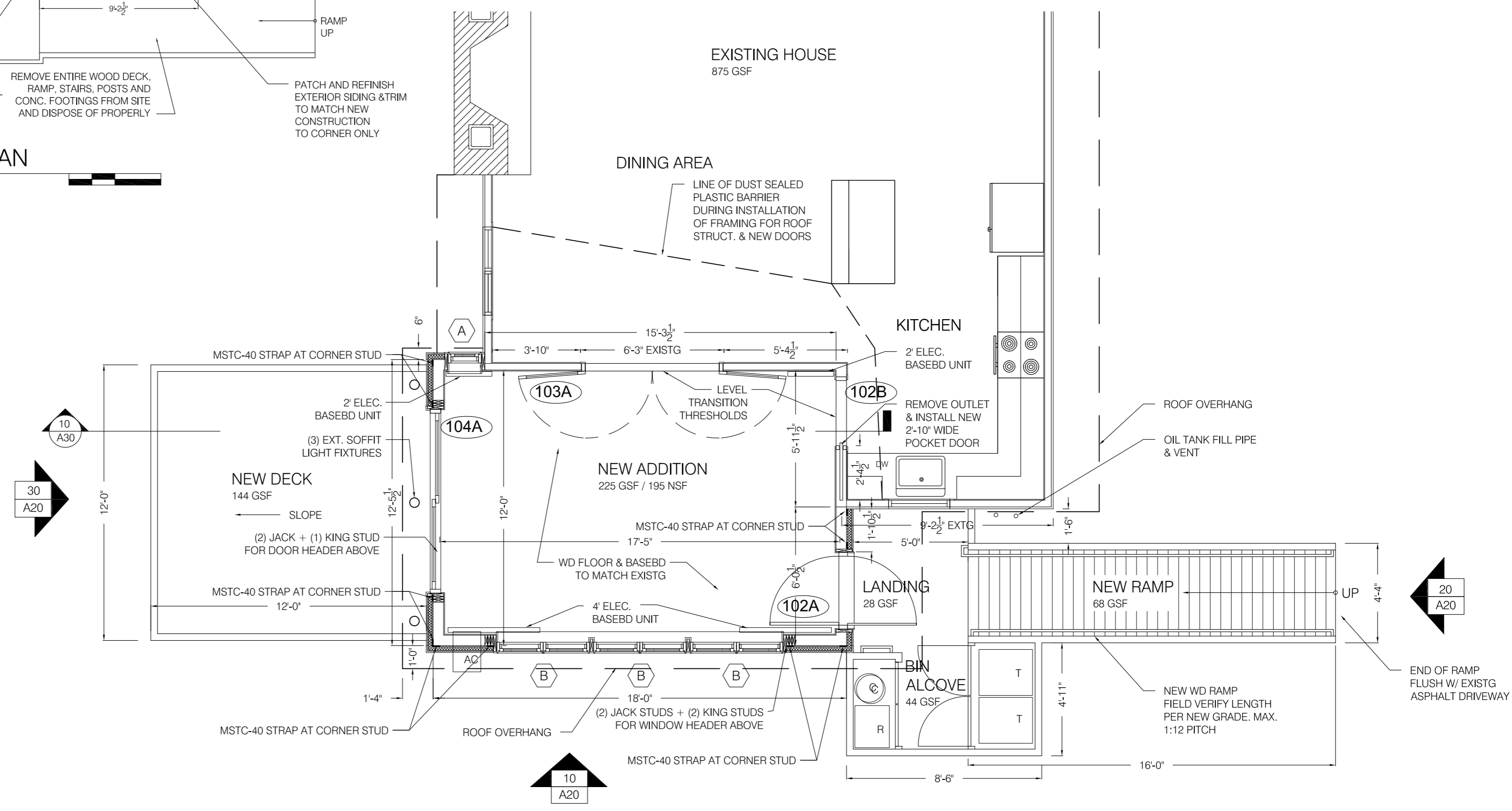

10 FIRST LEVEL PLAN  
1/4" = 1'-0"

**GENERAL NOTES:**

1. CONTRACTOR TO FIELD VERIFY ALL DIMENSIONS. NOTIFY ARCHITECT OF POTENTIAL ADJUSTMENTS TO DRAWINGS.
2. ARCHITECT TO PROVIDE BUILDING PERMIT. CONTRACTOR TO COORDINATE AND PROCURE INSPECTION PERMITS & APPROVAL INCLUDING USE & OCCUPANCY.
3. ONTRACTOR RESPONSIBLE FOR ALL SUB-CONTRACTORS INCLUDING BUT NOT LIMITED TO CONCRETE WORK AND ELECTRICAL EQUIPMENT & SYSTEMS INSTALLATIONS INCLUDING PROPER ELEC. OUTLET QUANTITY & LOCATIONS.SYSTEMS INSTALLATION TO FOLLOW MANUFACTURERS INSTRUCTION.
4. INSTALL HANDRAILS @ 2'-10" ON BOTH SIDES OF RAMP. 1-1/2" DIA. CONTINUOUS GRIPABLE SURFACE.
5. CONTRACTOR TO MAINTAIN POSITIVE GRADE DRAINAGE AWAY FROM FOUNDATION WALLS.

<b>ARCADIA</b> designworks LLC 199 prospect street, suite A portland, maine 04103 tele: 207.347.5252 207.749.9306 ideate@arcadiadesignworks.com	ENGINEER: ANDREW JACKSON, P.E. JACKSON ENGINEERING 11 LUTHER STREET PEAKS ISLAND, MAINE 04108 207-899-1960 JXNENGINEERING.COM	PROJECT: <h1 style="margin:0;">MICHAELSON RESIDENCE</h1> <p>59 CODMAN STREET, PORTLAND, MAINE</p>	TITLE: <h1 style="margin:0;">FIRST LEVEL &amp; DEMO PLANS</h1>
		PHASE: PRICING	PRINTED: FEBRUARY 2014