

Rachel Conly
Architectural Design

26 Sterling Street
Peaks Island, Maine 04108
207.766.5625

**Proposed
Second Floor
Power
Plan**

PROJECT

**Cunningham
Residence
46 Codman St.
Portland, ME**

DATE
03.16.15

REVISED

SCALE
1/4" = 1'-0"

DRAWN BY
**Rachel &
Harvey**

NOTES

| | | | |
|---|---|-----|--|
| ⊕ | duplex | ○-○ | undercounter |
| ⊕ | ground-fault circuit interrupter | ⊗ | ceiling fan w/ integral light |
| ⊕ | 220 volt | ⊗ | ceiling fan |
| ⊕ | switch | Δ | phone jack |
| ⊕ | 3-way switch | Δ | DSL |
| ⊕ | dimmer switch | Δ | CABLE |
| ⊕ | smoke detector | ⊕ | CAT 5 |
| ⊕ | carbon monoxide detector | ⊕ | central vacuum |
| ⊕ | minimum 50 cfm vent fan | ⊕ | compact fluorescent recessed can |
| ⊕ | ceiling mount light fixture | | |
| ⊕ | pendant light fixture | | |
| ⊕ | recessed can light fixture | | |
| ⊕ | wall sconce light fixture | | |
| ⊕ | wet location wall sconce light fixture | | |
| ⊕ | trunk lighting | | |
| ⊕ | fluorescent, locally switched | | |

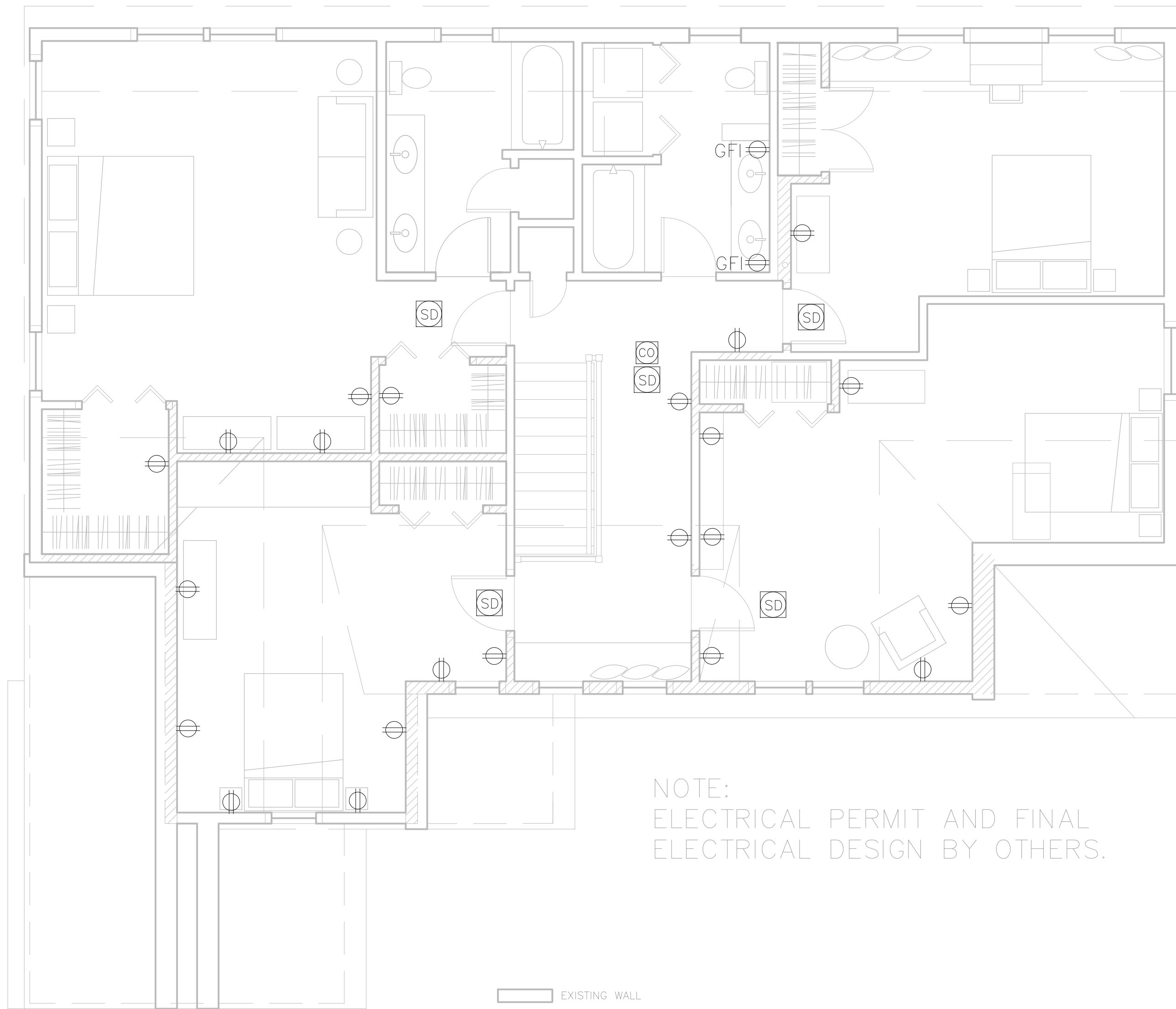

A Proposed Second Floor Power Plan
1/4" = 1'-0"