

FIRST LEVEL REFLECTED CEILING PLAN

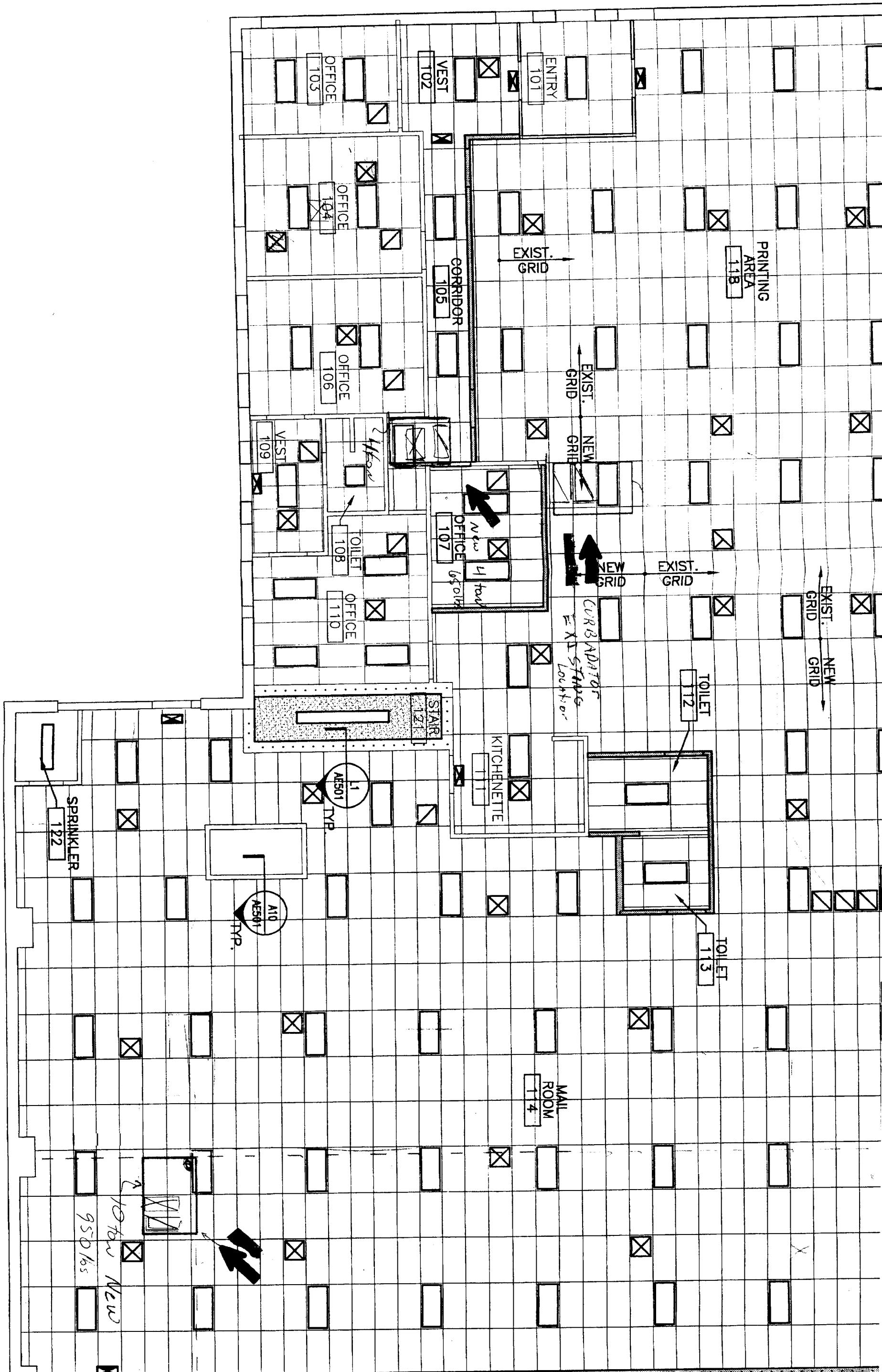

New  
950 lbs

CURB ADAPTOR  
EXIST. STAIR  
Location

New  
4 head

SPRINKLER  
122

A10  
AESS01  
TYP.

A11  
AESS01  
TYP.

MAIL  
ROOM  
114

TOILET  
113

TOILET  
112

OFFICE  
110

TOILET  
108

OFFICE  
107

OFFICE  
106

OFFICE  
104

OFFICE  
103

VEST  
102

ENTRY  
101

PRINTING  
AREA  
118

CORRIDOR  
105

STAIR  
121

KITCHENETTE  
111

EXIST.  
GRID  
NEW  
GRID

EXIST.  
GRID

EXIST.  
GRID  
NEW  
GRID

EXIST.  
GRID

X

GENERAL NOTES:







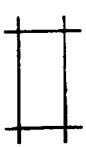

1. SEE G1001 FOR PROJECT GENERAL NOTES.

-EXIST. SKYLIGHT,  
CONTRACTOR TO  
VERIFY LOCATION

REFLECTED CEILING NOTES

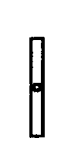
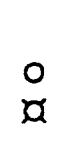
1. FIRE SPRINKLERS SHALL BE LOCATED IN ALIGNMENT WITH OTHER CEILING ITEMS, TYPICALLY.
2. FIRE SPRINKLERS SHALL BE CENTERED IN CEILING TILE.
3. FIRE SPRINKLERS SHALL BE PLACED TO COORDINATE WITH LIGHT FIXTURE POSITIONS INDICATED.
4. ALIGN CEILING ITEMS AS SHOWN, WITH COMMON CENTERLINES, TYPICALLY. CENTER ITEMS IN CEILINGS, OR IN AREAS UNLESS INDICATED OTHERWISE.
5. REFER TO ROOM FINISH SCHEDULE FOR CEILING HEIGHTS AND CEILING FINISHES TO BE PROVIDED.
6. EXCEPT WHERE INDICATED, CENTER CEILING GRIDS IN ROOMS. USE HALF TILES OR GREATER @ PERIMETERS AS POSSIBLE.

SYMBOL LEGEND

- |   |  |
|---|--|
|  | 2x4 SUSPENDED CEILING PANEL AND GRID ASSEMBLY. |
|  | OEILINO  |
|  | 2x2 VY-IN LIGHT FIXTURE.                       |
|  | 2x4 LAY-IN LIGHT FIXTURE.                      |
|  | 1x4 LIGHT FIXTURE.                             |
|  | FLOURESCENT STRIP FIXTURE.                     |
|  | DOWN LIGHT.                                    |
|  | CEILING MOUNTED EXIT LIQHT.                    |
|  | RETURN AIR GRILLE.                             |
|  | SUPPLY AIR GRILLE.                             |
|   | EXHAUST AIR GRILLE.                            |



**ARCHITECTURE ENGINEERING PLANNING**  
 SMRT  
 144 Fore Street/P.O. Box618  
 Portland, Maine 04104  
 tel. (207)772-3846

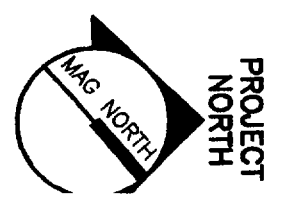
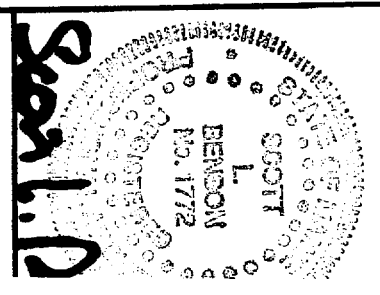

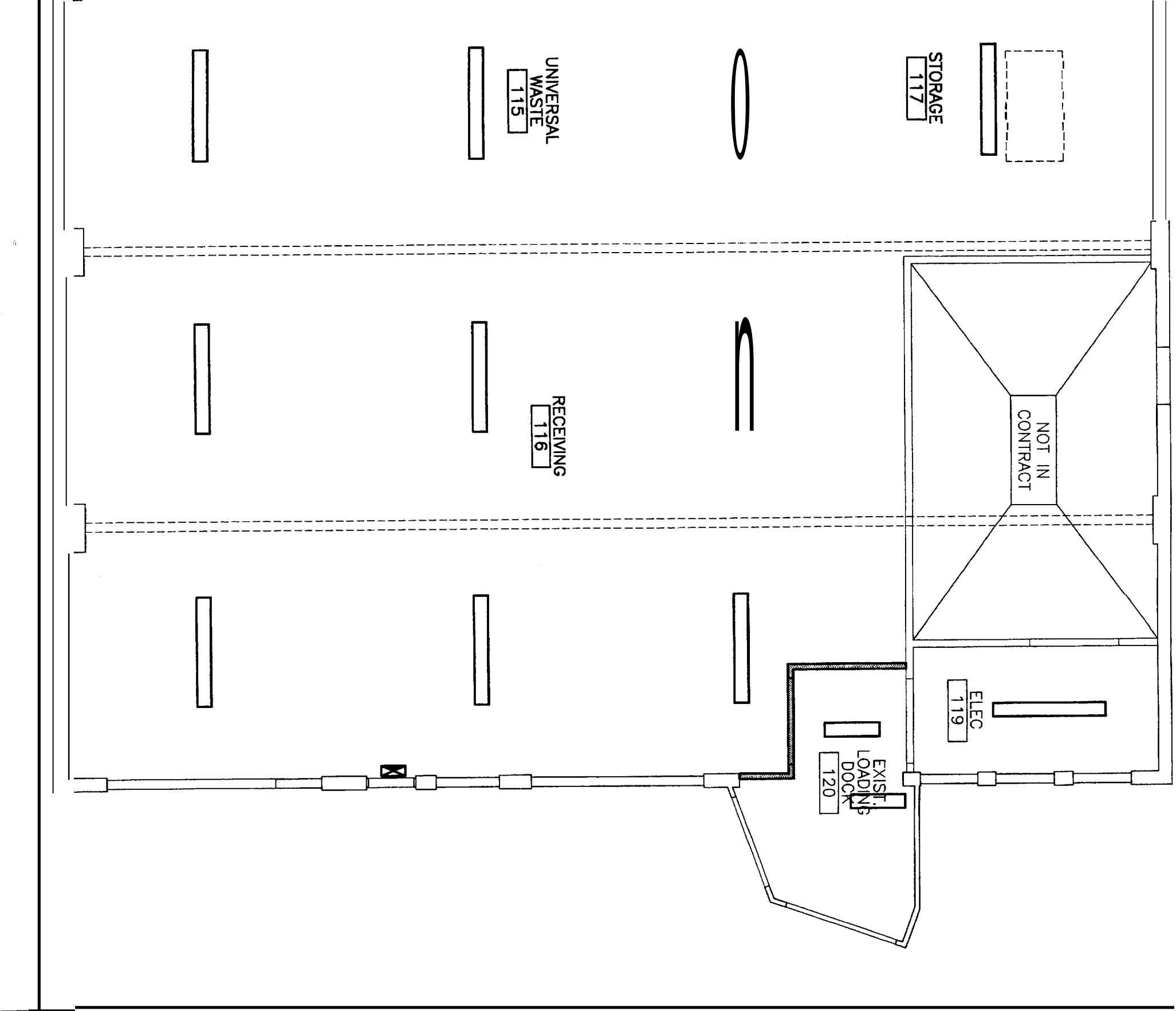

PROJECT TITLE:  
**UNIVERSITY OF SOUTHERN I**  
**501 FOREST AVENUE FIT-**  
 PORTLAND, MAINE

CURRENT ISSUE STATUS:

GRAPHIC SCALE:  
 0"

SCALE: AS  
 PROJECT MANAGER:  
 JC/DRAWN BY:  
 A/E OF RECORD:  
 CAD FILE: AET  
 PROJECT NO:  
 DATE:  
 SHEET TITLE:

REFLECTE  
 CEILING PI  
 AND ROOF