

DISPLAY THIS CARD ON PRINCIPAL FRONTAGE OF WORK

CITY OF PORTLAND

CONSTRUCTION

PERMIT

PERMIT ISSUED

Permit Number: 051664 2005

CITY OF PORTLAND

Please Read Application And Notes, If Any, Attached

This is to certify that 49 DARTMOUTH LLC / Bally Sign Company Inc.

has permission to install 25' sq ft of new sign

AT 45 DARTMOUTH ST

127 A004001

provided that the person or persons who apply for or accept this permit shall comply with all of the provisions of the Statutes of the State and of the Ordinances of the City of Portland regulating the construction, maintenance and use of buildings and structures, and of the application on file in this department.

Apply to Public Works for street line and grade if nature of work requires such information.

Notification of inspection must be given and when permission procedure before this building or part thereof is altered or enclosed-in-4 HOUR NOTICE IS REQUIRED.

A certificate of occupancy must be procured by owner before this building or part thereof is occupied.

OTHER REQUIRED APPROVALS

Fire Dept.

Health Dept.

Appeal Board

Other

DepartmentName

Jeannie Bouke 11/21/05

Director - Building & Inspection Services

PENALTY FOR REMOVING THIS CARD



CITY OF PORTLAND, MAINE
Department of Building Inspection

Certificate of Occupancy

LOCATION 45 Dartmouth St

CBL 127 A004001

Issued to 49 Dartmouth Llc/Applicant

Date of Issue 06/20/2002

This is to certify that the building, premises, or part thereof, at the above location, built — altered — changed as to use under Building Permit No. 02-0556, has had final inspection, has been found to conform substantially to requirements of Zoning Ordinance and Building Code of the City, and is hereby approved for occupancy or use, limited or otherwise, as indicated below.

PORTION OF BUILDING OR PREMISES

Entire (1st floor middle section, front)

APPROVED OCCUPANCY

Ethestic School
Use Group B
BOCA 1999

Limiting conditions:

This certificate supersedes
certificate issued

Approved: 6/20/02
(Date) Thomas M. Mully
Inspector

[Signature]
Inspector of Buildings

Notice: This certificate identifies legal use of building or premises, and ought to be transferred from owner to owner when property changes hands. Copy will be furnished to owner or lessee for one dollar.

overflow from Premier's School of Beauty & Cosmetology

close out 02-0556

City of Portland, Maine - Building or Use Permit Application

389 Congress Street, 04101 Tel: (207) 874-8703, Fax: (207) 874-8716

Permit No: 05-1664	Issued Date: NOV 29 2005	PERMIT ISSUED: 127 A004001
Owner Address: 715 BOYLSTON ST	Phone:	
Contractor Address: 9 Thomas Drive Westbrook	Phone:	2843
Permit Type: Signs - Permanent		Zone: S2b

Location of Construction: 45 DARTMOUTH ST	Owner Name: 49 DARTMOUTH LLC
Business Name:	Contractor Name: Bailey Sign Company Inc.
Lessee/Buyer's Name	Phone:

Past Use:	Proposed Use: Commercial/ install 25' sq ft of new signage
-----------	---

Permit Fee: \$80.00	Cost of Work: \$80.00	CEO District: 3
------------------------	--------------------------	--------------------

FIRE DEPT: <input type="checkbox"/> Approved <input type="checkbox"/> Denied	INSPECTION: Use Group: B Type: Sign IBC-2003 Signature: AMB 11/1/05
--	---

Proposed Project Description: t 25' sq ft of new signage

JEDESTRIAN ACTIVITIES DISTRICT (P.A.D.)		
Action: <input type="checkbox"/> Approved	<input type="checkbox"/> Approved w/Conditions	<input type="checkbox"/> Denied
Signature:	Date:	

Permit Taken By: Idobson	Date Applied For: 11/14/2005	Zoning Approval		
-----------------------------	---------------------------------	------------------------	--	--

- This permit application does not preclude the Applicant(s) from meeting applicable State and Federal Rules.
- Building permits do not include plumbing, septic or electrical work.
- Building permits are void if work is not started within six (6) months of the date of issuance. False information may invalidate a building permit and stop all work..

Special Zone or Reviews
<input type="checkbox"/> Shoreland
<input type="checkbox"/> Wetland
<input type="checkbox"/> Flood Zone
<input type="checkbox"/> Subdivision
<input type="checkbox"/> Site Plan
Maj <input type="checkbox"/> Minor <input type="checkbox"/> MM <input type="checkbox"/>
Date: 11/15/05 AM

Zoning Appeal
<input type="checkbox"/> Variance
<input type="checkbox"/> Miscellaneous
<input type="checkbox"/> Conditional Use
<input type="checkbox"/> Interpretation
<input type="checkbox"/> Approved
<input type="checkbox"/> Denied
Date:

Historic Preservation
<input checked="" type="checkbox"/> Not in District or Landmark
<input type="checkbox"/> Does Not Require Review
<input type="checkbox"/> Requires Review
<input type="checkbox"/> Approved
<input type="checkbox"/> Approved w/Conditions
<input type="checkbox"/> Denied
Date: AM

CERTIFICATION

I hereby certify that I am the owner of record of the named property, or that the proposed work is authorized by the owner of record and that I have been authorized by the owner to make this application as his authorized agent and I agree to conform to all applicable laws of this jurisdiction. In addition, if a permit for work described in the application is issued, I certify that the code official's authorized representative shall have the authority to enter all areas covered by such permit at any reasonable hour to enforce the provision of the code(s) applicable to such permit.

SIGNATURE OF APPLICANT	ADDRESS	DATE	PHONE
RESPONSIBLE PERSON IN CHARGE OF WORK, TITLE		DATE	PHONE

City of Portland, Maine - Building or Use Permit

389 Congress Street, 04101 Tel: (207) 874-8703, Fax: (207) 874-8716

Permit No: 05-1664	Date Applied For: 1111412005	CBL: 127 A004001
------------------------------	--	----------------------------

Location of Construction: 45 DARTMOUTH ST	Owner Name: 49 DARTMOUTH LLC	Owner Address: 715 BOYLSTON ST	Phone:
---	--	--	---------------

Business Name:	Contractor Name: Bailey Sign Company Inc.	Contractor Address: 9 Thomas Drive Westbrook	Phone: (207) 774-2843
-----------------------	---	--	---------------------------------

Lessee/Buyer's Name	Phone:	Permit Type: Signs - Permanent
----------------------------	---------------	--

Proposed Use: Commercial/ install 25' sq ft of new signage	Proposed Project Description: install 25' sq ft of new signage
--	--

Dept: Building Status: Approved with Conditions Reviewer: Jeanine Bourke Approval Date: 11/21/2005

Note: OktoIssue:

- 1) Signage Installation to comply with Chapter 31 of the IBC 2003 building code.
- 2) Separate permits are required for any electrical installations.



Signage/Awning Pre-Application Questionnaire

Please complete all of the following information.

Address: 49 DARTMOUTH ST. Zone: B-2
CBL _____

Single Tenant Lot? Yes ___ No ___ Multi Tenant Lot? Yes No ___

Tenant/allocated building space frontage (feet): Length: 30' Height: _____

Information on proposed sign(s):

Freestanding (e.g., pole) sign? Yes No ___ Dimensions proposed _____
Bldg. wall sign? (attached to bldg) Yes No ___ Dimensions proposed 2'6" x 10'6"

Information on already existing and permitted sign(s):

Freestanding (e.g., pole) sign? Yes ___ No Dimensions proposed _____
Bldg. wall sign? (attached to bldg) Yes No ___ Dimensions proposed: 2'6" x 10"
Awning? Yes ___ No Dimensions: _____
Lot frontage (feet): _____

Portland
Pickets

Is this on tenant's frontage?

Awning? Yes ___ No Is awning backlit? Yes ___ No ___
Height of awning: _____ Length of awning: _____ Depth: _____
Is there any communication, message, trademark or symbol on it? Yes ___ No ___
If yes, total s.f. of panels w/communications, message, trademark or symbol _____ s.f.

A site sketch and building sketch showing exactly where existing and new signage is located must be provided. Sketches and/or pictures of proposed signage are also required.

Signature of applicant: Deanna Emery / Bailey Sign INC. Date: 11/10/05

~For office use only~

B2b mult-tenant
max 15 ft
30 x 15 =
15 ft per linear foot = 45 ft
1 per business

45 ft

~~30 ft x 10 ft = 300 ft² = 144 = 2.0~~
2.5' x 10' = 25 ft²

U.L.

490808



Signage/Awning Permit Application

If you or the property owner owes real estate or personal property taxes or user charges on any property within the City, payment arrangements must be made before permits **of any kind are accepted.**

Portland				
Total Square Footage of Proposed Structure <i>25,700</i>	Square Footage of Lot <i>20,700</i>			
Chart# <i>127</i>	Block# <i>A</i>	Lot# <i>4</i>	<i>Gould Associates</i>	<i>617-266-4040</i>
Lessee/Buyer's Name (If Applicable) <i>Bikram Yoga Mike & Angela Seymour</i>	Applicant name, address & telephone: <i>Bailey Sign, Inc. 9 Thomas Dr. Westbrook, ME 04092</i>		Total s.f. of signage x \$2.00 Per s.f. plus \$30.00/\$65.00 For H.D. signage= Total Fee: <u><i>20.00</i></u> Awning Fee= cost of work Total Fee: \$ _____	
Current Specific use: <u><i>Office complex</i></u> If vacant, what was prior use: <u><i>N/A</i></u> How long has it been vacant? <u><i>N/A</i></u> Proposed Use: <u><i>Office complex</i></u> Project Description: <i>Install tenant sign "Bikram Yoga"</i>				
Contractor's name, address & telephone: <i>Bailey Sign, Inc.</i> Who should we contact when the permit is ready: <u><i>Rodney Benn</i></u> Mailing address: <i>9 Thomas Dr. Westbrook, ME 04092</i> Phone: <u><i>774-2843 ext. 102</i></u>				

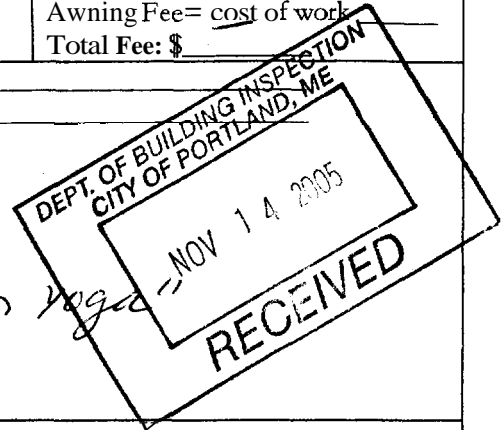

Please submit all of the information outlined in the Sign/Awning Application Checklist. Failure to do so will result in the automatic denial of your permit.

In order to be sure the City fully understands the full scope of the project, the Planning and Development Department may request additional information prior to the issuance of a permit. For further information visit us **on-line** at www.portlandmaine.gov, stop by the Building Inspections office, room 315 City Hall or call 874-8703.

I hereby certify that I am the Owner of record of the named property, or that the owner of record authorizes the proposed work and that I have been authorized by the owner to make this application as his/her authorized agent. I agree to conform to all applicable laws of this jurisdiction. In addition, if a permit for work described in this application is issued, I certify that the Code Official's authorized representative shall have the authority to enter all areas covered by this permit at any reasonable hour to enforce the provisions of the codes applicable to this permit.

Signature of applicant: <i>Deanna Emeru / Bailey Sign Inc.</i>	Date: <i>11/10/05</i>
--	-----------------------

This is not a permit; you may not commence ANY work until the permit is issued.

Please call 874-8703 or 874-8693 to schedule your inspections as agreed upon

Permits expire in 6 months, if the project is not started or ceases for 6 months.

The Owner or their designee is required to notify the inspections office for the following inspections and provide adequate notice. Notice must be called in 48-72 hours in advance in order to schedule an inspection:

By initialzing at each inspection time, you are agreeing that you understand the inspection procedure and additional fees from a "Stop Work Order" and "Stop Work Order Release" will be incurred if the procedure is not followed as stated below.

A Pre-construction Meeting will take place upon receipt of your building permit.

- Footing/Building Location Inspection: Prior to pouring concrete
- Re-Bar Schedule Inspection: Prior to pouring concrete
- Foundation Inspection: Prior to placing ANY backfill
- Framing/Rough Plumbing/Electrical: Prior to any insulating or drywalling
- ~~Final/Certificate of Occupancy~~: Prior to any occupancy of the structure or use. NOTE: There is a \$75.00 fee per inspection at this point.

Certificate of Occupancy is not required for certain projects. Your inspector can advise you if your project requires a Certificate of Occupancy. All projects DO require a final inspection

If any of the inspections do not occur, the project cannot go on to the next phase, REGARDLESS OF THE NOTICE OR CIRCUMSTANCES.

WA CERIFICATE OF OCCUPANICES MUST BE ISSUED AND PAID FOR, BEFORE THE SPACE MAY BE OCCUPIED

<u>X Jeanne Emery</u>	<u>12-5-05</u>
Signature of Applicant/Designee	Date
<u>Donna Martin Admin</u>	<u>12 5 05</u>
Signature of Inspections Official	Date

CBL 127 A004 Building Permit #: 051664

PRODUCER
GSB/TBI Referral
One India Street

THIS CERTIFICATE IS ISSUED AS A MATTER OF INFORMATION ONLY AND CONFERS NO RIGHTS UPON THE CERTIFICATE HOLDER. THIS CERTIFICATE DOES NOT AMEND, EXTEND OR ALTER THE COVERAGE AFFORDED BY THE POLICIES BELOW.

Bailey Sign Inc.
Bruce Bailey President
9 Thomas Drive
Westbrook ME 34092

INSURER B.
INSURER C.
INSURER D.
INSURER E.

COVERAGES

THE POLICIES OF INSURANCE LISTED BELOW HAVE BEEN ISSUED TO THE INSURED NAMED ABOVE FOR THE POLICY PERIOD INDICATED. NOTWITHSTANDING ANY REQUIREMENT, TERM OR CONDITION OF ANY CONTRACT OR OTHER DOCUMENT WITH RESPECT TO WHICH THIS CERTIFICATE MAY BE ISSUED OR MAY PERTAIN, THE INSURANCE AFFORDED BY THE POLICIES DESCRIBED HEREIN IS SUBJECT TO ALL THE TERMS, EXCLUSIONS AND CONDITIONS OF SUCH POLICIES. AGGREGATE LIMITS SHOWN MAY HAVE BEEN REDUCED BY PAID CLAIMS.

INSR ADD'L LTR INSRD	TYPE OF INSURANCE	POLICY NUMBER	POLICY EFFECTIVE DATE (MM/DD/YY)	POLICY EXPIRATION DATE (MM/DD/YY)	LIMITS
A	GENERAL LIABILITY <input checked="" type="checkbox"/> COMMERCIAL GENERAL LIABILITY <input type="checkbox"/> CLAIMS MADE <input checked="" type="checkbox"/> OCCUR	CCP9717153	04/01/05	04/01/06	EACH OCCURRENCE \$ 1000000 DAMAGE TO RENTED PREMISES (Ea occurrence) \$ 100000 MED EXP (Any one person) \$ 5000 PERSONAL & ADV INJURY \$ 1000000 GENERAL AGGREGATE \$ 2000000 PRODUCTS - COMMODITY \$ 2000000
	AUTOMOBILE LIABILITY <input type="checkbox"/> ANY AUTO <input type="checkbox"/> ALL OWNED AUTOS <input type="checkbox"/> SCHEDULED AUTOS <input type="checkbox"/> HIRED AUTOS <input type="checkbox"/> NON-OWNED AUTOS				COMBINED SINGLE LIMIT MEDICAL EXP PROPERTY DAMAGE (Per accident)
	GARAGE LIABILITY <input type="checkbox"/> ANY AUTO				AUTO ONLY - EA ACCIDENT \$ OTHER THAN AUTO ONLY - EA ACC \$ AGG \$
	EXCESS/UMBRELLA LIABILITY <input type="checkbox"/> OCCUR <input type="checkbox"/> CLAIMS MADE <input type="checkbox"/> DEDUCTIBLE <input type="checkbox"/> RETENTION \$				EACH OCCURRENCE \$ AGGREGATE \$ \$ \$
	WORKERS COMPENSATION AND EMPLOYERS' LIABILITY ANY PROPRIETOR/PARTNER/EXECUTIVE OFFICER/MEMBER EXCLUDED? Yes, describe under SPECIAL PROVISIONS below.				WORKERS COMP. OTH POLICY LIMITS (Ea) \$ E.L. EACH ACCIDENT \$ E.L. DISEASE - EA EMPLOYEE \$ E.L. DISEASE - POLICY LIMIT \$
	OTHER				

The certificate holder is named as an additional insured as respects general liability.

CITY/OFF

City of Portland
City Hall
389 Congress Street
Portland ME 04101

SHOULD ANY OF THE ABOVE DESCRIBED POLICIES BE CANCELLED BEFORE THE EXPIRATION DATE THEREOF THE ISSUING INSURER WILL ENDEAVOR TO MAIL 10 DAYS WRITTEN NOTICE TO THE CERTIFICATE HOLDER NAMED TO THE LEFT BUT FAILURE TO DO SO SHALL IMPOSE NO OBLIGATION OR LIABILITY OF ANY KIND UPON THE INSURER ITS AGENTS OR REPRESENTATIVES.

AUTHORIZED REPRESENTATIVE: *DAILEY*

IMPORTANT

If the certificate holder is an ADDITIONAL INSURED, the policy(ies) must be endorsed. A statement on this certificate does *not* confer rights to the certificate holder in lieu of such endorsement(s).

If SUBROGATION IS WAIVED, subject to the terms and conditions of the policy, certain policies may require an endorsement. A statement on this certificate **does** not confer rights to the *certificate* holder in lieu of such endorsement(s).

DISCLAIMER

The Certificate of Insurance on the reverse side of this form does not constitute a contract between the issuing insurer(s) authorized representative or producer and the certificate holder nor does it affirmatively or negatively amend, extend or alter the coverage afforded by the policies listed thereon.

WRITTEN CONSENT AND AGREEMENT RELATING TO A CERTAIN SIGN PROPOSED TO BE
ERECTED ON A BUILDING AT 49 Dartmouth St.

IN PORTLAND, MAINE Gould Associates being the owner of the premises
at 449 Forest Ave. in Portland, Maine hereby gives consent to the
erection of a certain sign owned by Berley Sign, Inc over the
public sidewalk or on the building from said premises as described in
application to the Division of Inspection Services of Portland, Maine for a
permit to cover erection of said sign:

And in consideration of the issuance of said permit Gould Associates
owner of said premises, in event said sign shall cease to serve the purpose
for which it was erected or shall become dangerous and in event the owner of
said sign shall fail to remove said sign or make it permanently safe in case
the sign still serves the purpose for which it was erected, hereby agrees
for himself or itself, for his heirs, its successors, and his or its
assigns, to completely remove said sign within ten days of notice from said
Inspector of Buildings that said sign is in such condition and of order from
him to remove it.

In witness whereof, the owner of said premises has signed this consent and
agreement this 2nd day of Nov. 2005

03/20/05

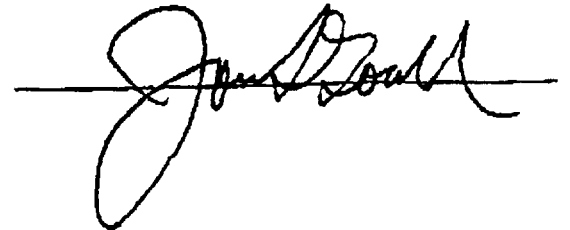

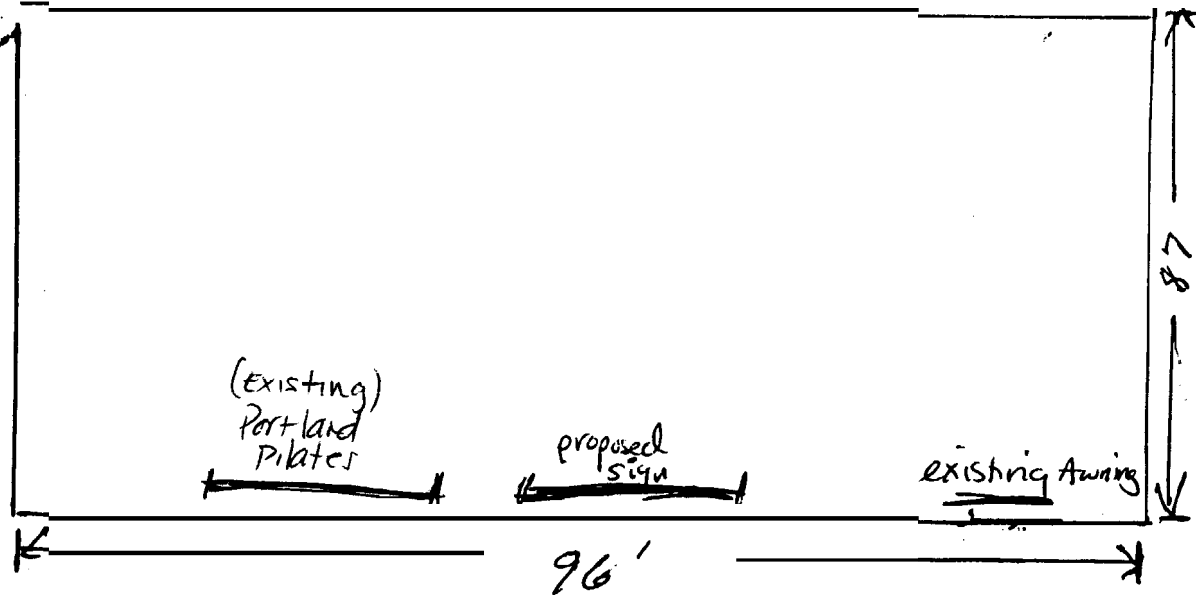

Lot size $207' \times 100' = 20,700 \text{ sq ft}$
tenant frontage 30'

Dartmouth St.

Forest Ave.

Forest ave side view of building

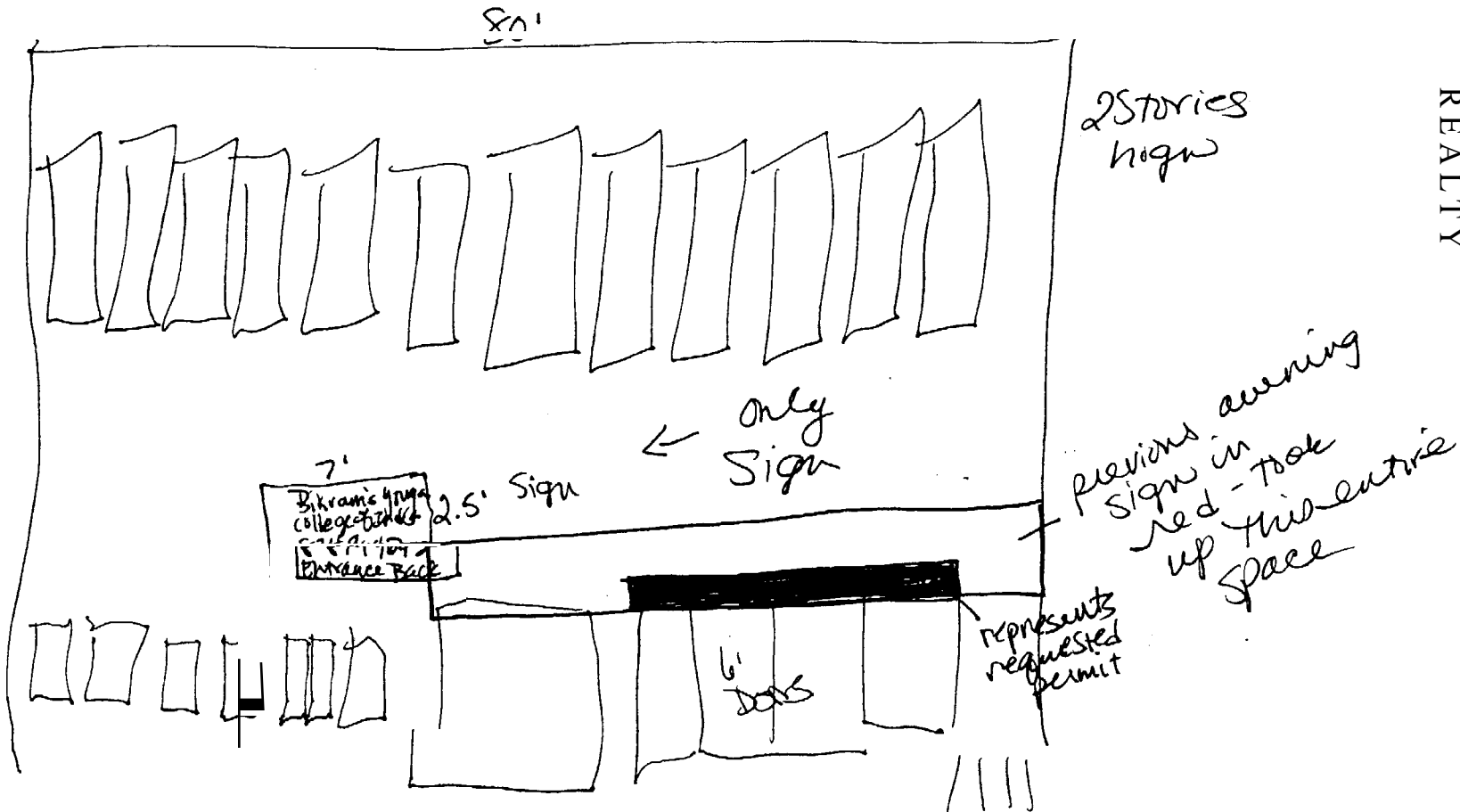

**KELLER
WILLIAMS**
REALTY

Permit
Permit # 03-0203
for Keller Williams.

UL Listing GR 490808



MODIFIED LOGO 25.62" X 29.88"

6" B

4 3/8" U.C

2 1/4" L.C.

(1) S.F. 2'-6" X 10'-1" X ___" INTERNALLY ILLUMINATED SIGN

CABINET & 1 1/2" RETAINER: MATTE BLACK

B/G GERBER TRANS. ROYAL BLUE VINYL
ALL COPY WHITE

CENTER POSITION OF LENGTH OF SIGN RAIL

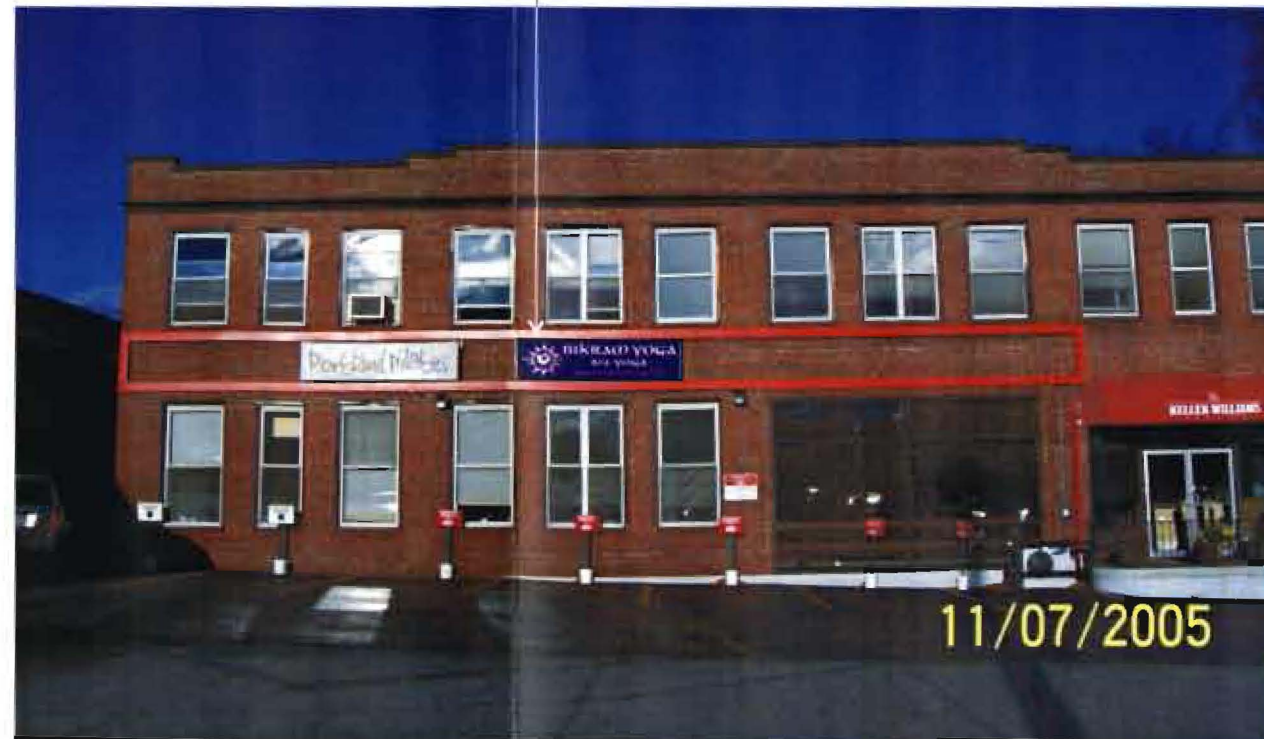

NOTES:

APPROVED MANUFACTURING DATE

VOLTAGE:

10/26/05 OMNIA FONT
11/8/05 ADD PHOTO PLOT

REVISIONS:

Bailey Sign INCORPORATED
www.baileysign.com
9 Thomas Drive
Col. Westbrook Executive Park
Westbrook, ME 04092
207-774-2843 / 1-800-539-SIGN
Fax: 774-1193
E-Mail: newsign@baileysign.com
© COPYP/CHT 2003

PLEASE NOTE:

THIS IS A PROGRESS PRINT - FIELD MEASUREMENTS MAY OR MAY NOT NEED TO BE VERIFIED.

THIS DESIGN IS THE EXCLUSIVE PROPERTY OF BAILEY SIGN INCORPORATED AND ALL RIGHTS TO ITS USE OR REPRODUCTION ARE RESERVED.

THE ACCURACY OF THIS COLOR RENDERING IS LIMITED BY MEDIA AND OUTPUT DEVICES AND IS INTENDED FOR REPRESENTATIONAL USE ONLY. ACTUAL MANUFACTURING GRAPHIC COLORS ALSO VARY DEPENDING ON PROCESSES & MATERIALS USED. 100% COLOR MATCHES OF SUBMITTED SPECIFICATIONS CAN NOT BE GUARANTEED.

IF AN ELECTRIC SIGN, THEN INSTALLATION MUST BE ACCOMPLISHED IN TOTAL COMPLIANCE WITH THE NATIONAL ELECTRIC CODE, THE REQUIREMENTS OF UNDERWRITERS LABORATORY, CANADIAN STANDARDS ASSOCIATION, AND APPLICABLE LOCAL CODES.

ALL ELECTRICAL SIGNS REQUIRE ROUTINE MAINTENANCE.

CLIENT:

ACCEPTANCE SIGNATURE DATE

CUSTOMER:

BIKRAM YOGA

LOCATION:

49 DARTMOUTH STREET
PORTLAND, MAINE

SALESPERSON R.B. DRAWN BY L.W.M.

PS # D-695

WO #

SCALE 3/4" = 1'

DATE 10/6/05

DRAWING NO: 05498 R2
SHEET 1





CROSS SECTION
TYPICAL CONSTRUCTION & MOUNTING
OF SELF CONTAINED CHANNEL NEON LETTER

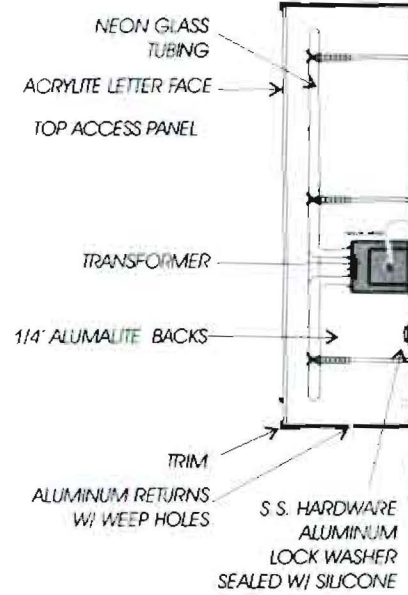

N.T.S.

WALL MATERIAL VARIES ANY WALL PENETRATION TO BE SEALED WITH SILICONE

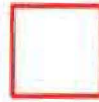

REVERSE CLIP MOUNTING DETAIL

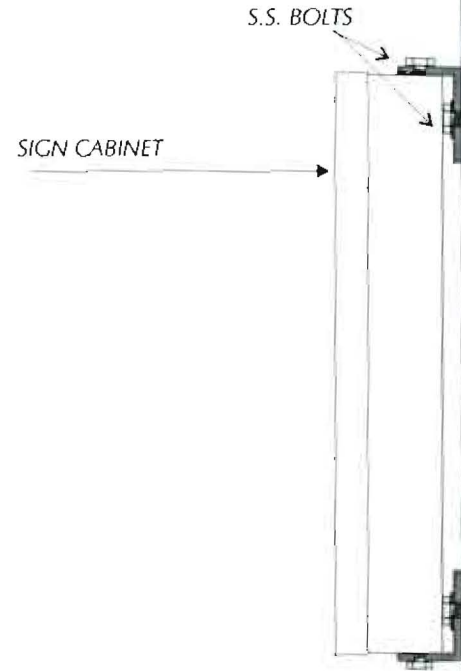

N.T.S.

WALL MATERIAL VARIES ANY WALL PENETRATION TO BE SEALED WITH SILICONE



Attached to front
of brick building

LAG BOLT & SHIELD
INTO BRICK BLOCK BUILDING FASCIA

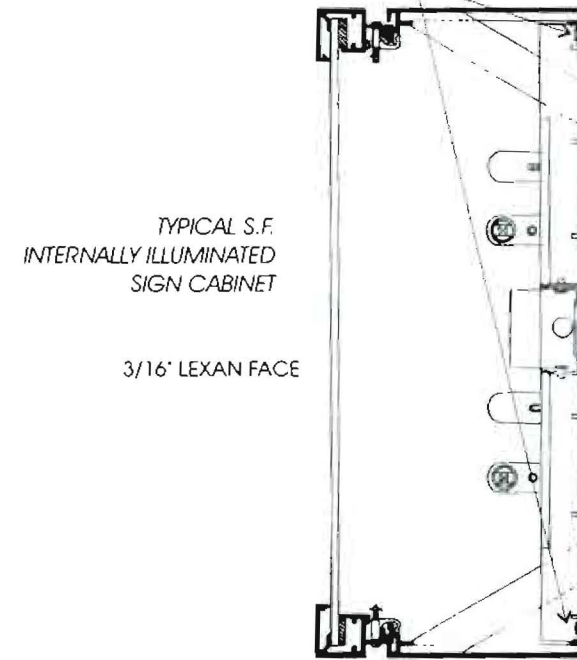

N.T.S.

WALL MATERIAL VARIES ANY WALL PENETRATION TO BE SEALED WITH SILICONE

NOTES:

APPROVED MANUFACTURING DATE

VOLTAGE:

REVISIONS

Bailey Sign
www.baileysign.com
9 Thomas Drive
Col. Westbrook Executive Park
Westbrook, ME 04092
207-774-2843 / 1-800-539-SIGN
Fax: 774-1193
E-Mail: newsign@baileysign.com
© COPYRIGHT 2005

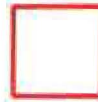

CROSS SECTION
TYPICAL MOUNTING
OF CHANNEL NEON LETTER ON RACEWAY

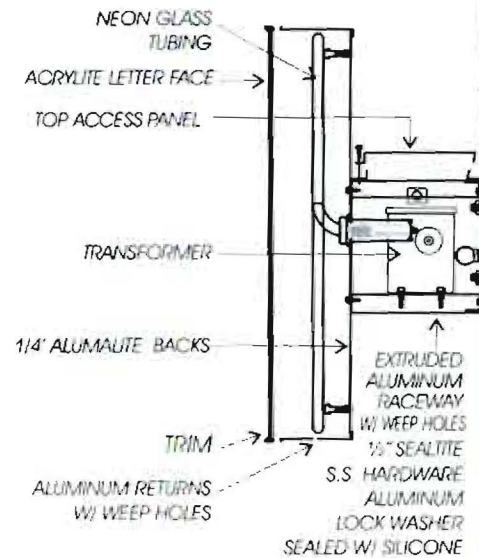

N.T.S.

WALL MATERIAL VARIES ANY WALL PENETRATION TO BE SEALED WITH SILICONE



N.T.S.

WALL MATERIAL VARIES ANY WALL PENETRATION TO BE SEALED WITH SILICONE

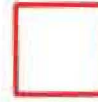

N.T.S.

WALL MATERIAL VARIES ANY WALL PENETRATION TO BE SEALED WITH SILICONE

PLEASE NOTE:

THIS IS A PROGRESS PRINT - FIELD MEASUREMENTS MAY OR MAY NOT NEED TO BE VERIFIED.

THIS DESIGN IS THE EXCLUSIVE PROPERTY OF BAILEY SIGN INCORPORATED AND ALL RIGHTS TO ITS USE OR REPRODUCTION ARE RESERVED.

THE ACCURACY OF THIS COLOR RENDERING IS LIMITED BY MEDIA AND OUTPUT DEVICES AND IS INTENDED FOR REPRESENTATIONAL USE ONLY. ACTUAL MANUFACTURING GRAPHIC COLORS ALSO VARY DEPENDING ON PROCESSES & MATERIALS USED. 100% COLOR MATCHES OF SUBMITTED SPECIFICATIONS CAN NOT BE GUARANTEED.

IF AN ELECTRIC SIGN, THEN INSTALLATION MUST BE ACCOMPLISHED IN TOTAL COMPLIANCE WITH ARTICLE 600 OF THE NATIONAL ELECTRIC CODE, THE REQUIREMENTS OF UNDERWRITERS LABORATORY, CANADIAN STANDARDS ASSOCIATION, AND/OR ANY APPLICABLE LOCAL CODES. THIS INCLUDES PROPER GROUNDING AND BONDING OF THE SIGN.

ALL ELECTRICAL SIGNS REQUIRE ROUTINE MAINTENANCE.

CLIENT
ACCEPTANCE SIGNATURE _____ DATE _____

CUSTOMER
LOCATION:

SALESPERSON _____ DRAWN BY: L.W.M.

PS # _____ W/O # _____

SCALE: N.T.S. DATE _____

DRAWING NO. TYPICAL MOUNTING SHEET _____ DRAWING





CITY OF PORTLAND, MAINE

Department of Building Inspections

_____ 11-14 20 05 _____

Received from Party Sign

Location of Work 49 Dartmouth St.

Cost of Construction \$ _____

Permit Fee \$ 800.00

Building (IL) _____ Plumbing (I5) _____ Electrical (I2) _____ Site Plan (U2) _____

Other Sign

CBL: 127 A-1

Check #: 85321

Total Collected \$ 800.00

THIS IS NOT A PERMIT

No work is to be started until PERMIT CARD is actually posted upon the premises. Acceptance of fee is no guarantee that permit will be granted. PRESERVE THIS RECEIPT. In case permit cannot be granted the amount of the fee will be refunded upon return of the receipt less \$10.00 or 10% whichever is greater.

WHITE - Applicant's Copy
YELLOW - Office Copy
PINK - Permit Copy