

**IBC AND LIFE SAFETY CODES REVIEW**  
 IBC 2009:  
 Use and Occupancy Classification: Section 503 all A, E, B & M occupancies of type I or II construction can be 3+ stories with 13 sprinkler.  
 Section 508.3 Non-separated Chapter 9 Applies per most restrictive use throughout building  
 NFPA 13 Sprinkler system and Fire Alarm System.

NFPA 101 (2009):  
 Classification of Occupancy: Chapter 12 "New Assembly Occupancies"  
 Section 6.1.2, "Assembly" < 300 occupants  
 Section 6.1.14.3, "Mixed Occupancies"  
 Type of Construction: Table 8.2.1.2, Type I (442) or (332) or Type II (222)  
 Construction Type Limitations: Table 12.1.6, permitted up to 5 stories in height for assembly limited to an occupant load of 300 or less.  
 Section 12.2.5.1.3, 20' dead-end corridors shall not exceed 20 ft.  
 Travel Distance to Exits: Section 12.2.6.2 (1) The travel distance shall not exceed 250 ft in assembly occupancies protected throughout by an approved supervised automatic sprinkler system in accordance with Section 9.7

EXISTING BUILDING INCLUDES:  
 NFPA 13 sprinkler system w/ automatic notification  
 NFPA 72 monitored fire alarm system  
 (See current inspection report by owner)

TOTAL SQUARE FOOTAGE OF FLOOR AREA: 5,340 SF  
 TOTAL SQUARE FOOTAGE OF ASSEMBLY AREA: 1,933 SF  
 TOTAL SQUARE FOOTAGE OF CLASSROOMS AREA: 510 SF  
 TOTAL SQUARE FOOTAGE OF OFFICE AREA: 203 SF

- SYMBOL LEGEND:**
- X'-XX" EXIT ACCESS TRAVEL DISTANCE
  - 1 HOUR FIRE RATED
  - 2 HOUR FIRE RATED
  - 2 HOUR FIRE WALL
  - NEW WALL

- EXIT SIGN, EXISTING - ARROW DENOTES EXIT SIGN TO BE PROVIDED WITH DIRECTIONAL ARROW
- BATTERY OPERATED EMERGENCY LIGHT, EXISTING
- FIRE EXTINGUISHER, EXISTING
- SMOKE DETECTOR, EXISTING
- STROBE DEVICE, EXISTING
- HORN/STROBE DEVICE, EXISTING
- PULL STATION, EXISTING
- EXISTING FIRE ALARM CONTROL PANEL
- EXIT SIGN, NEW - ARROW DENOTES EXIT SIGN TO BE PROVIDED WITH DIRECTIONAL ARROW

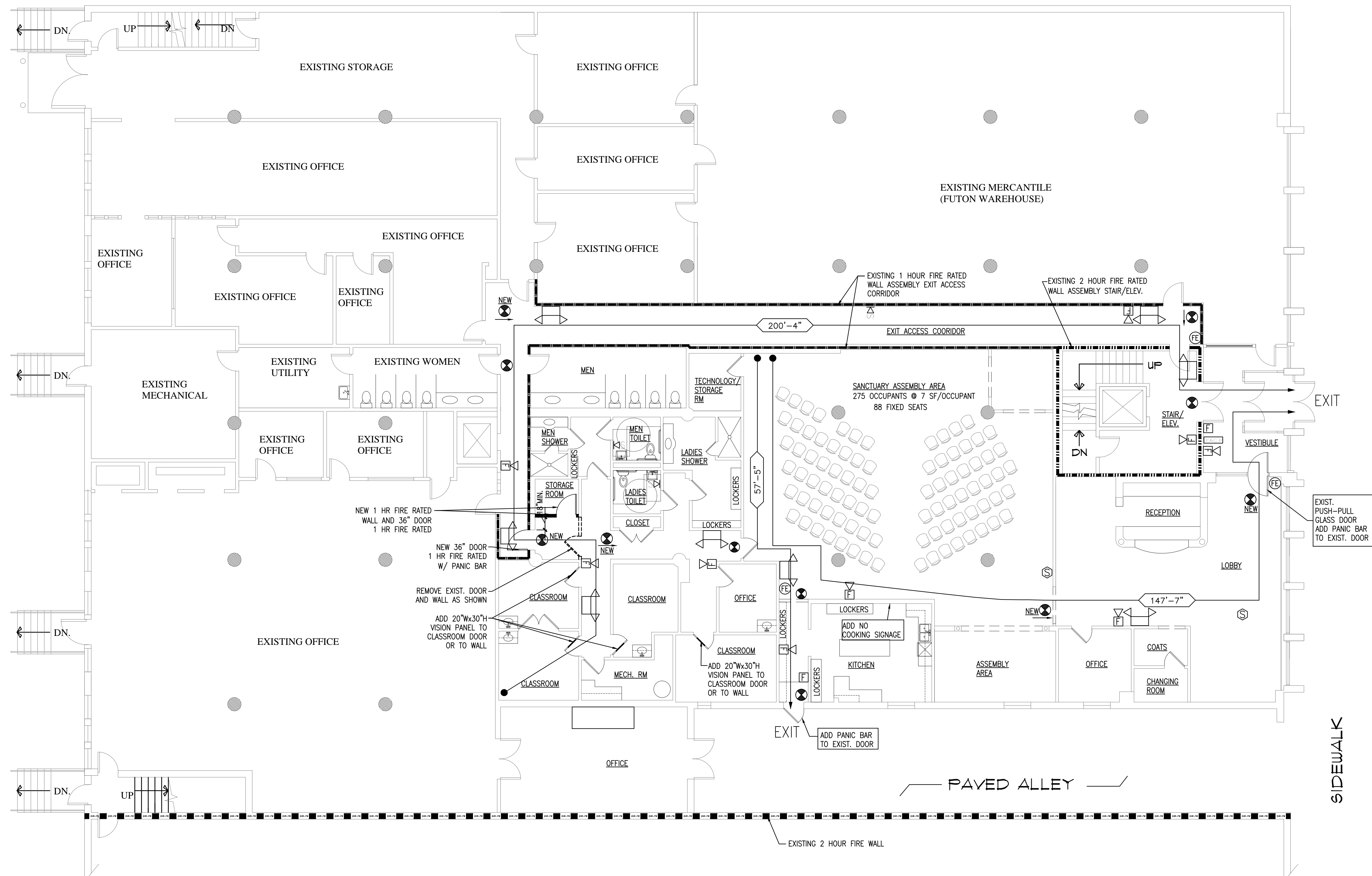
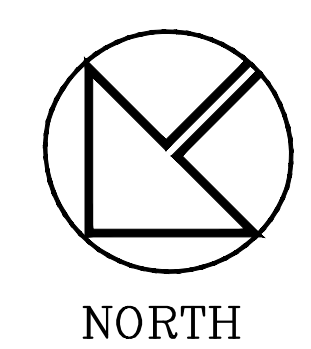
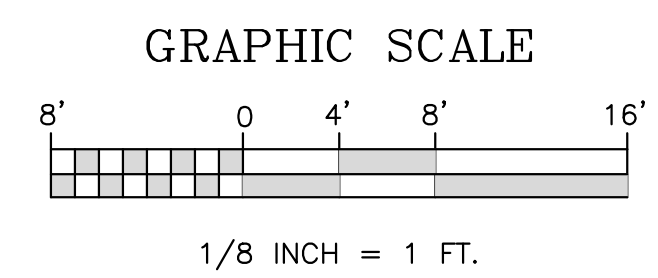

FOREST AVENUE

SIDEWALK

OWNER / DEVELOPER

PROJECT TITLE

DRAWING TITLE

DATE

REVISION DESCRIPTION

DRAWING NUMBER

**A1.10**

SCALE: 1/8" = 1'-0"  
 DATE: 6/20/2013