

1 BASEMENT / FOUNDATION PLAN
S100 SCALE: 1/4"=1'-0"

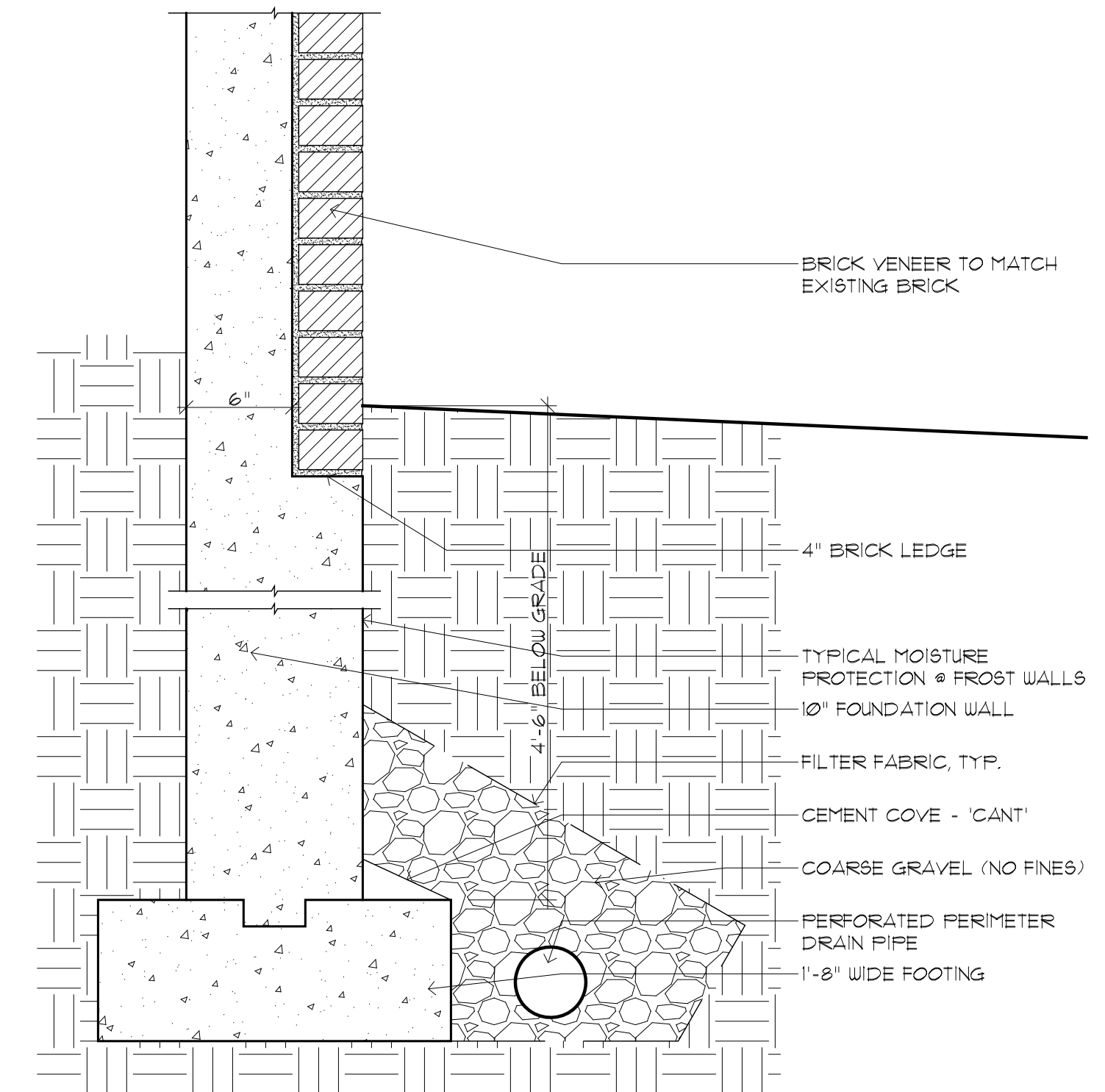

2 FOUNDATION DETAIL @ BRICK VENEER
S100 SCALE: 1 1/2"=1'-0"

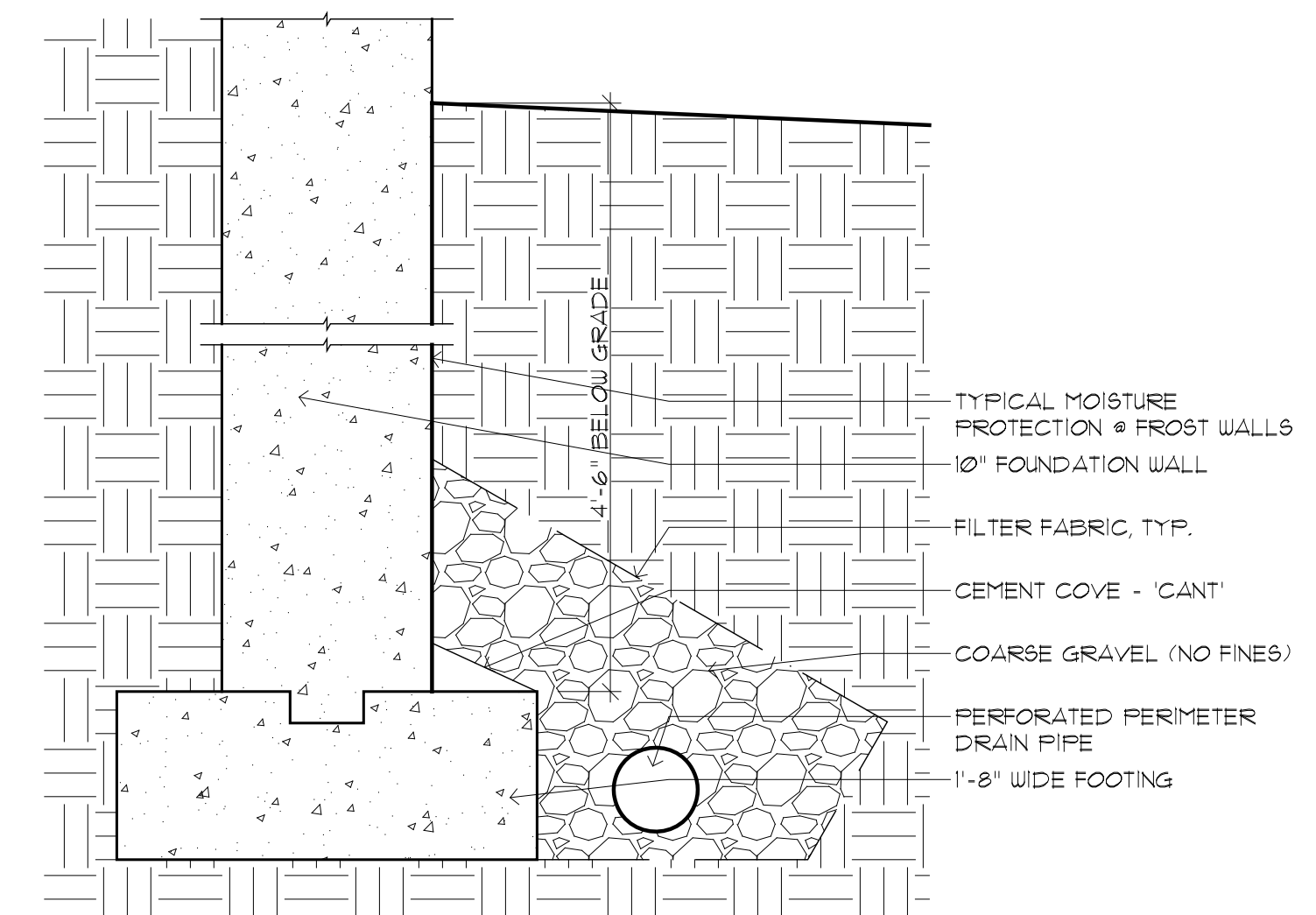

3 FOUNDATION DETAIL @ GARAGE
S100 SCALE: 1 1/2"=1'-0"

Civil Engineer
Landscape Architect

Structural Engineer
CASCO BAY ENGINEERING
424 FORE STREET
PORTLAND, ME 04101
Mechanical Engineers

Electrical Engineer
SELLERS-KEFFER
85 COYLE STREET
PORTLAND, ME 04101
Client

- ISSUED FOR REVISIONS
- 03.12.2015_SD PROGRESS
 - 03.20.2015_SD PROGRESS
 - 04.01.2015_DD PROGRESS
 - 04.23.2015_FOR PERMIT

SELLERS-KEFFER
RESIDENCE
KITCHEN & GARAGE RENOVATIONS
PORTLAND, ME

TITLE
BASEMENT / FOUNDATION PLAN

DATE
04 / 23 / 2015

DRAWING #
S100