

GENERAL CONTRACTOR

STRUCTURAL ENGINEER

MEP ENGINEER

CLIENT

Endodontic Associates, P.A.
 276 Conco Road
 Portland, ME 04103

PROJECT

New Office Renovation

563 Forest Avenue
 Portland, ME 04101



ISSUED FOR PERMIT

INFORMATION

Path: M:/boulos/endodontics

Issue Date: 12/31/13

Drawn By: dijg

Checked By:

Revision:

- 02.26.14 - RELOCATED EGRESS, NEW GLAZING REQUIREMENT AT ALLEY
-
-
-

TITLE

FINISH PLAN

SCALE

1/4"=1'-0"

© 2014 Graham Architects. All rights reserved. Information, material, and designs in this document are proprietary to and owned by Endodontic Associates, and may not be disclosed to any third party, reproduced, posted on a global computer information network, or distributed in any way without the written consent from Graham Architects.

A-5

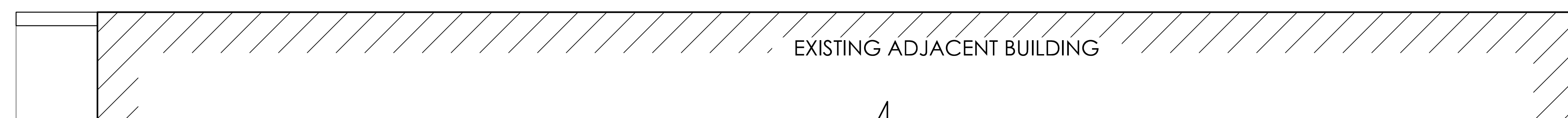
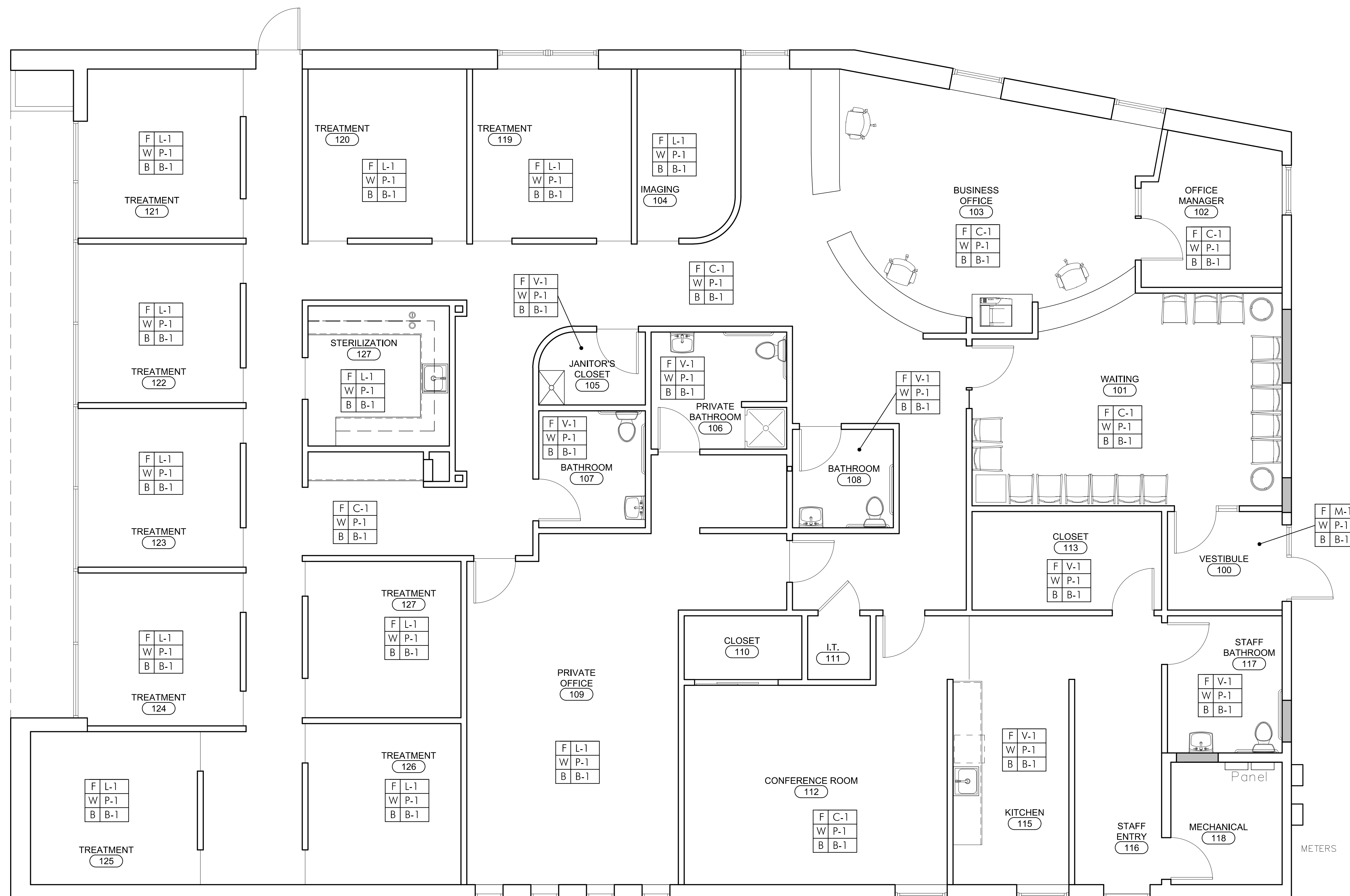

EXISTING ADJACENT BUILDING

METERS