

City of Portland, Maine - Building or Use Permit Application

389 Congress Street, 04101 Tel: (207) 874-8703, Fax: (207) 874-8716

Permit No: 06-1683	Issue Date:	CBL: 125 N024001
-----------------------	-------------	---------------------

Location of Construction: 15 ARLINGTON ST	Owner Name: CHAREST KATHRYN L	Owner Address: 15 ARLINGTON ST	Phone:
Business Name:	Contractor Name: Down East Energy	Contractor Address: 172 Main Street South Portland	Phone: 2077995585
Lessee/Buyer's Name	Phone:	Permit Type: HVAC	Zone: R-3

Past Use: Duplex	Proposed Use: Duplex- install a 57 Gallon propane Tank	Permit Fee: \$30.00	Cost of Work: \$30.00	CEO District: 3
Proposed Project Description: install a 57 Gallon propane Tank <i>legal use: 2 residential family D.U.</i>		FIRE DEPT: <input type="checkbox"/> Approved <input type="checkbox"/> Denied		INSPECTION: Use Group: R3 Type: SB <i>IRC 2003</i> Signature: <i>Jim 11/21/06</i>
		PEDESTRIAN ACTIVITIES DISTRICT (P.A.D.) Action: <input type="checkbox"/> Approved <input type="checkbox"/> Approved w/Conditions <input type="checkbox"/> Denied Signature: _____ Date: _____		

Permit Taken By: Idobson	Date Applied For: 11/17/2006	Zoning Approval
-----------------------------	---------------------------------	------------------------

1. This permit application does not preclude the Applicant(s) from meeting applicable State and Federal Rules. 2. Building permits do not include plumbing, septic or electrical work. 3. Building permits are void if work is not started within six (6) months of the date of issuance. False information may invalidate a building permit and stop all work..	Special Zone or Reviews <input type="checkbox"/> Shoreland <input type="checkbox"/> Wetland <input type="checkbox"/> Flood Zone <input type="checkbox"/> Subdivision <input checked="" type="checkbox"/> Site Plan Maj <input type="checkbox"/> Minor <input type="checkbox"/> MM <input type="checkbox"/> <i>ok with conditions</i> Date: <i>11/20/06</i>	Zoning Appeal <input type="checkbox"/> Variance <input type="checkbox"/> Miscellaneous <input type="checkbox"/> Conditional Use <input type="checkbox"/> Interpretation <input type="checkbox"/> Approved <input type="checkbox"/> Denied Date: _____	Historic Preservation <input checked="" type="checkbox"/> Not in District or Landmark <input type="checkbox"/> Does Not Require Review <input type="checkbox"/> Requires Review <input type="checkbox"/> Approved <input type="checkbox"/> Approved w/Conditions <input type="checkbox"/> Denied Date: <i>S</i>
--	--	--	--

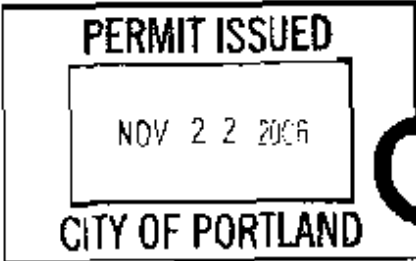

Scanned

CERTIFICATION

I hereby certify that I am the owner of record of the named property, or that the proposed work is authorized by the owner of record and that I have been authorized by the owner to make this application as his authorized agent and I agree to conform to all applicable laws of this jurisdiction. In addition, if a permit for work described in the application is issued, I certify that the code official's authorized representative shall have the authority to enter all areas covered by such permit at any reasonable hour to enforce the provision of the code(s) applicable to such permit.

SIGNATURE OF APPLICANT	ADDRESS	DATE	PHONE
------------------------	---------	------	-------

201105

City of Portland, Maine - Building or Use Permit

389 Congress Street, 04101 Tel: (207) 874-8703, Fax: (207) 874-8716

Permit No: 06-1683	Date Applied For: 11/17/2006	CBL: 125 N024001
-----------------------	---------------------------------	---------------------

Location of Construction: 15 ARLINGTON ST	Owner Name: CHAREST KATHRYN L	Owner Address: 15 ARLINGTON ST	Phone:
Business Name:	Contractor Name: Down East Energy	Contractor Address: 172 Main Street South Portland	Phone: (207) 799-5585
Lessee/Buyer's Name	Phone:	Permit Type: Tanks - Dwellings	

Proposed Use: Duplex- install a 57 Gallon propane Tank	Proposed Project Description: install a 57 Gallon propane Tank
---	---

Dept: Zoning **Status:** Approved with Conditions **Reviewer:** Marge Schmuckal **Approval Date:** 11/20/2006
Note: **Ok to Issue:**

- 1) This is NOT an approval for an additional dwelling unit. You SHALL NOT add any additional kitchen equipment including, but not limited to items such as stoves, microwaves, refrigerators, or kitchen sinks, etc. Without special approvals.
- 2) This property shall remain a two family dwelling. Any change of use shall require a separate permit application for review and approval.

Dept: Building **Status:** Approved with Conditions **Reviewer:** Tom Markley **Approval Date:** 11/21/2006
Note: **Ok to Issue:**

- 1) The installation must comply with the State of Maine Gas Regulations.
- 2) Application approval based upon information provided by applicant. Any deviation from approved plans requires separate review and approval prior to work.

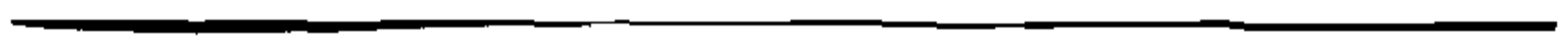



Fill in and Sign with Ink

APPLICATION FOR PERMIT HEATING OR POWER EQUIPMENT



To the INSPECTOR OF BUILDINGS, PORTLAND, ME.

The undersigned hereby applies for a permit to install the following heating, cooking or power equipment in accordance with the Laws of Maine, the Building Code of the City of Portland, and the following specifications:

Location / CBL 125 W 24 Use of Building Private Date 11/17/66
 Name and address of owner of appliance Thomas Herson 15 Arlingtons Ave
Portland
 Installer's name and address Days East Energy Co 101 Main St
South Portland Telephone 795-5585

Location of appliance:
 Basement Floor
 Attic Roof

Type of Fuel:
 Gas Oil Solid

Appliance Name: _____
 U.L. Approved Yes No

Will appliance be installed in accordance with the manufacturer's installation instructions? Yes No

IF NO Explain: _____

The Type of License of Installer:
 Master Plumber # _____
 Solid Fuel # _____
 Oil # _____
 Gas # PVT 1495
 Other _____

Type of Chimney:
 Masonry Lined
 Factory built _____
 Metal
 Factory Built U.L. Listing # _____
 Direct Vent
 Type _____ U.L.# _____

Type of Fuel Tank
 Oil
 Gas

Size of Tank 57 gallon

Number of Tanks 1

Distance from Tank to Center of Flame _____ feet.

Cost of Work: \$ _____
 Permit Fee: \$ 30.00

Approved

Approved with Conditions

Fire: _____
 Ele.: _____
 Bldg.: Thomas Herson

See attached letter or requirement

 Inspector's Signature Date Approved

Signature of Installer Steve [Signature]

[REDACTED]

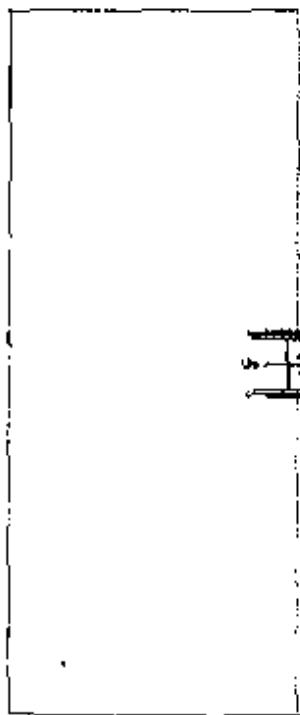
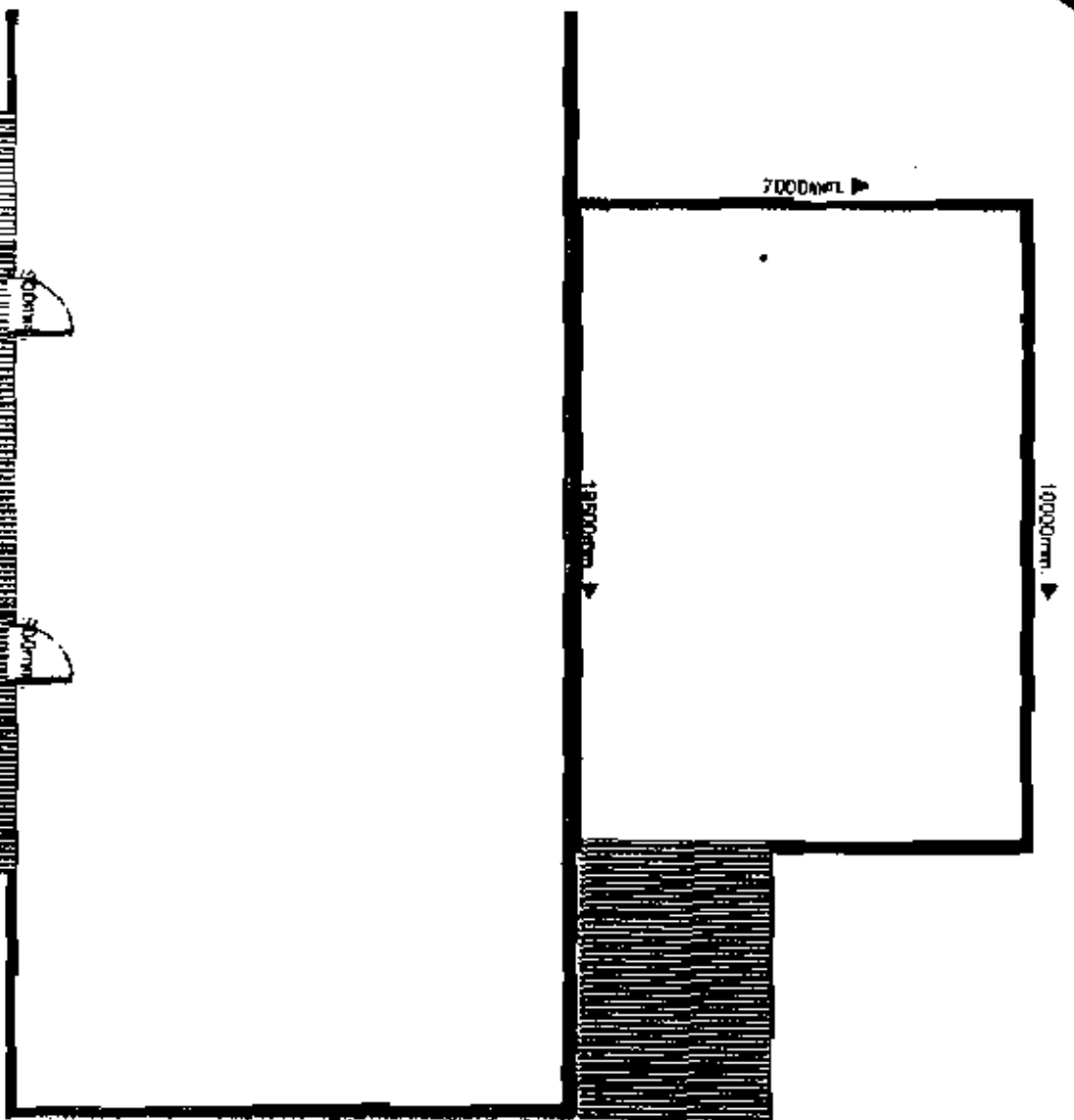
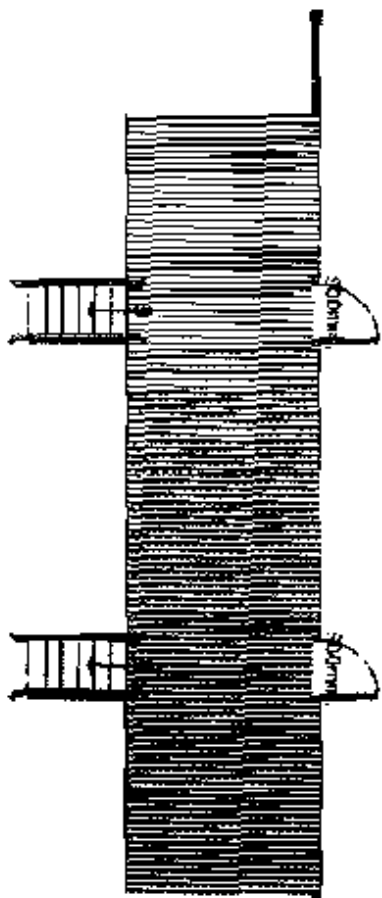

11720mm



Original Spot for Tenth Installation

57 batten EP

