

BUILDING CODE ANALYSIS

APPLICABLE CODES	
BUILDING:	INTERNATIONAL BUILDING CODE - 2009
PLUMBING:	INTERNATIONAL PLUMBING CODE - 248 CMR
MECHANICAL:	INTERNATIONAL MECHANICAL CODE - 2009
ELECTRICAL:	NATIONAL ELECTRICAL CODE - 2008
ENERGY:	INTERNATIONAL ENERGY CONSERVATION CODE - 2009
FUEL GAS:	INTERNATIONAL FUEL GAS CODE - 2009
FIRE:	INTERNATIONAL FIRE CODE - 2009
ACCESSIBILITY:	ICC/ANSI A117.1 - 2003
CONSTRUCTION TYPE:	TYPE II B
SPRINKLED:	NO
OCCUPANCY:	BUSINESS OCCUPANCY - GROUP B
GROSS TENANT AREA:	1,500 SQ. FT.
NET TENANT AREA:	1,500 SQ. FT.
OCCUPANT LOAD:	15 OCCUPANTS
EGRESS WIDTH PER OCCUPANT SERVED:	0.2 INCH PER OCCUPANT
TOTAL EXIT WIDTH FOR DOORS:	0.2 x 15 OCCUPANTS = 3" (64" PROVIDED)

H&R BLOCK

621 FOREST AVENUE
PORTLAND, ME 04101

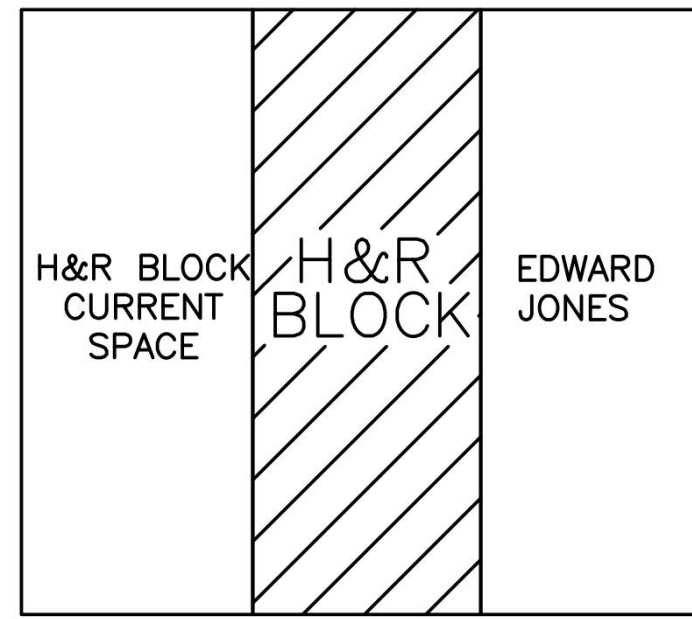

1 KEY PLAN
CS1.0 NOT TO SCALE

SYMBOLS

L	ANGLE
@	AT (THE RATE OF)
C	CENTER LINE
E	CHANNEL
P	PLATE
Ø	ROUND/DIAMETER
W	WITH
W/O	WITHOUT
X	BY (AS 6' X 8')

OFFICE TO KEEP THE FOLLOWING EXISTING ITEMS:

1. Coffee Cart
2. Back Office Items
3. Professional Services Board
4. Back Wall Logo
5. Window Block Light Box

NEW PERMANENT WALL ART

GRAPHICS: BI-LINGUAL



WALLART1
QTY: 1



WALLART13
QTY: 1



WALLART5
QTY: 1



WALLART7
QTY: 1



WALLART11
QTY: 1



WALLART3
QTY: 1



PSB
QTY: 0

LETTERING FOR CSP DESK

WELCOME ON SIDE OF CSP FACING FRONT DOOR OF OFFICE

H&R BLOCK ON SIDE OF CSP FACING WAITING AREA OF OFFICE

A&E	A&E NATIONAL, INC.	FIN	FINISH	NIC	NOT IN CONTRACT INSTALLED BY CONTRACTOR
ADJ	ADJUSTABLE	FLUOR	FLUORESCENT	NTS	NOT TO SCALE
AFF	ABOVE FINISHED FLOOR	FO	FACE OF	OC	ON CENTER
AHU	AIR HANDLER UNIT	FR	FIRE RATED	OD	OUTSIDE DIAMETER
ANSI	AMERICAN NATIONAL STANDARDS INSTITUTE	GA	GAUGE, GAGE	OPP	OPPOSITE
ARCH	ARCHITECTURAL	GALV	GALVANIZED	OPNG	OPENING
AWI	ARCHITECTURAL WOODWORK INSTITUTE	GC	GENERAL CONTRACTOR	OSCI	OWNER SUPPLIED CONTRACTOR INSTALLED
BLDG	BUILDING	GL	GLASS, GLAZING	PLAM	PLASTIC LAMINATE
BOT	BOTTOM	GLB	GYPSON WALL BOARD	PLBG	PLUMBING
BSM	BASEMENT	GYP	GYPSON	PLYWD	PLYWOOD
BTU(H)	BRITISH THERMAL UNIT (PER HOUR)	HC	HANDICAP (ED)	PNL	PANEL
C	COUNTERTOP	HD	HEAVY DUTY	PNT	PAINT
CAB	CABINET	HDWD	HARD WOOD	PROJ	PROJECT
CATV	CABLE TELEVISION	HL	HOLD	PT	POINT
CLG	CEILING	HORZ	HORIZONTAL	QTR	QUARTER
CLR	CLEAR	HT	HEIGHT	RCPT	RECEPTACLE
CONC	CONCRETE	HVAC	HEATING/VENTILATING/AIR CONDITIONING	RD	ROD
CONST	CONSTRUCTION	ID	INSIDE DIAMETER	REC	RECESSED
CONTR	CONTRACTOR	IN	INCH	REF	REFRIGERATOR
CPT	CARPET	IND	INDICATES	REQ	REQUIRED (REQUIREMENTS)
CPU	CENTRAL PROCESSING UNIT	INSUL	INSULATION	RM	ROOM
CT	CERAMIC TILE	INT	INTERIOR	RO	ROUGH OPENING
DED	DEDICATED	L	LOWER CABINET	S	SHELVING
DEG	DEGREES	LAV	LAVATORY	TYP	TYPICAL
DF	DRINKING FOUNTAIN	LIN	LINOLEUM	U	UPPER CABINET
DIA	DIAMETER	LKR	LOCKER (S)	VAC	VACUUM
DIM	DIMENSION	LOC	LOCATION (S)	VER	VERIFY
DISP	DISPENSARY	MAX	MAXIMUM	VERT	VERTICAL
EDF	EXISTING DRINKING FOUNTAIN	MIN	MINIMUM	VTR	VENT THROUGH ROOF
EP	EXISTING ELECTRICAL PANEL	MTD	MOUNTED	WD	WOOD
EPP	EXISTING ELECTRICAL PANEL	MTL	METAL	WNW	WINDOW
FD	FLOOR DRAIN	NIC	NOT IN CONTRACT		

GENERAL PROJECT NOTES

1. CONTRACTOR TO FIELD VERIFY ALL EXISTING CONDITIONS; IF THERE ARE ANY CHANGES, REVISIONS OR DISCREPANCIES PLEASE CALL: MACY JEAN: 314-817-2187
EXISTING & NEW PARTITION DIMENSION TOLERANCE IS 2" TO 6" UNLESS NOTED AS HOLD.
2. LANDLORD / CONTRACTOR TO PROVIDE SEPARATE HVAC CONTROLS FOR HRB SPACE.
3. CONTRACTOR TO PROVIDE NEW ELECTRICAL DEVICES AS INDICATED ON PLAN. IF SCHEDULED TO REMAIN, VERIFY EXISTING DEVICES ARE IN GOOD WORKING CONDITION. (REMOVE & PATCH DEVICES THAT ARE EXISTING IN REMAINING WALLS OVER 24" A.F.F.)
4. 3-WAY SWITCH SHALL BE INSTALLED AT EACH MEANS OF EGRESS FROM DEMISED SPACE IF NOT EXISTING.
5. CONTRACTOR TO FURNISH & INSTALL 4' x 4' FIRE-TREATED PLYWOOD PHONE BOARD AS SHOWN WITH DEDICATED QUAD OUTLET 30" A.F.F. PAINTED TO MATCH WALL COLOR WITH FIRE-RATING LEFT VISIBLE.
6. *NOT USED* - POWER POLE TO BE PROVIDED BY CONTRACTOR WITH CEILING UP TO 10'-0" - WIREMOLD ALTP - 2S. IF CEILING HEIGHT IS MORE THAN 10'-0" USE WIREMOLD ALTP-412.
7. CONTRACTOR TO PROVIDE BOX & PULLSTRING AT EACH VOICE / DATA LOCATION AND COORDINATE WITH IDENTIFIED LOW VOLTAGE VENDOR FOR CABLE INSTALLATION.
8. MECHANICAL, ELECTRICAL & PLUMBING ARE ALL DESIGN-BUILD; MEP CONTRACTORS REQUIRED TO OBTAIN NECESSARY DRAWINGS, PERMITS, ETC.
9. RELOCATE / ADD SUPPLY / RETURN GRILLES AS REQUIRED PER NEW PARTITIONS FOR COMPLETE & BALANCED WORKING SYSTEM.
10. RELOCATE / ADD LIGHTING AS REQUIRED PER NEW PARTITIONS FOR CONSISTENT LIGHT THROUGHOUT.
11. EXISTING DUPLEX RECEPTACLES CAN BE USED TO MEET REQUIREMENTS IF WITHIN 6" OF DESIRED LOCATION.

SIGNAGE: GENERAL CONTRACTOR TO VERIFY EXISTENCE & FUNCTIONALITY OF SIGN CIRCUIT ALONG SIGN BAND SERVING SUBJECT SPACE. EXISTING CIRCUIT MUST BE LOCATED IN / ON THE SIGN BAND ABOVE THE SUBJECT SPACE & WITHIN SIX FEET OF THE CENTERLINE OF THE SPACE. THE CIRCUIT SHOULD BE DIRECT FEED FROM THE ELECTRICAL PANEL WITHIN THE TENANT SPACE & BE FED THROUGH A TIME CLOCK OR PHOTOCELL. SHOULD THE CIRCUIT NOT EXIST AND / OR BE DEEMED NON-FUNCTIONAL, GC TO PROVIDE INSTALLATION OF NEW DEDICATED SIGN CIRCUIT, PHOTOCELL & JUNCTION BOX TO BE MOUNTED WITHIN THE SIGN BAND NO MORE THAN SIX FEET FROM THE CENTERLINE OF THE SUBJECT SPACE. COST FOR INSTALLATION OF THE CIRCUIT, J-BOX & PHOTOCELL TO BE INCLUDED IN THE BASE ELECTRICAL BID FOR THE PROJECT.

LIST OF ABBREVIATIONS

PROJECT TEAM
ARCHITECT:
A & E NATIONAL, INC.
1812 NORTH 203rd STREET
ELKHORN, NE 68022
TEL: 402-614-4434
FAX: 402-614-4431

INDEX OF DRAWINGS

CS1.0	COVER SHEET/INDEX OF DRAWINGS
A1.1	CONSTRUCTION / FINISH PLAN
A1.2	ELECTRICAL / REFLECTED CEILING PLAN

2 FURNITURE/EQUIP. PLAN
CS1.0 NOT TO SCALE

©2013 A&E NATIONAL, INC.
THESE PLANS ARE COPY RIGHTED AND ARE SPECIFICALLY PROVIDED FOR USE OF THE OWNER AND DESIGNED FOR CONSTRUCTION BY A & E NATIONAL, INC. AND ARE INTENDED FOR NO OTHER PURPOSE. PERMISSION FOR USE OF THIS DOCUMENT IN PART OR WHOLE WITHOUT WRITTEN CONSENT OF A & E NATIONAL, INC. IS PROHIBITED.

A & E NATIONAL, INC.
A & E NATIONAL, INC.
1812 NORTH 203rd STREET
ELKHORN, NE 68022
PH: 402-614-4434
FAX: 402-614-4431

A & E NATIONAL, INC. CONTACTS
ROBERT FECHTMEISTER
PRESIDENT
1-888-614-4434 EXT. 100
KEITH BECKER
LEAD PROJECT COORDINATOR
1-888-614-4434 EXT. 103

DRAWN BY
KEITH BECKER

H&R BLOCK
621 FOREST AVENUE
PORTLAND, ME 04101

PROJECT
H&R BLOCK
621 FOREST AVENUE
PORTLAND, ME 04101

RELEASE DATE
5/22/13

SHEET NO.
CS1.0