

City of Portland, Maine – Building or Use Permit Application 389 Congress Street, 04101, Tel: (207) 874-8703, FAX: 874-8716

Location of Construction: 630 Forest Ave		Owner: Church Corp		Phone:		Permit No:
Owner Address:		Lessee/Buyer's Name: Church Office Equipment		BusinessName:		
Contractor Name: Black Bear Signworks		Address: 80 Second St So. Ptld, ME 04106		Phone: 741-2849		Permit Issued: PERMIT DENIED
Past Use: Office		Proposed Use: Same		COST OF WORK: \$		
				PERMIT FEE: \$ 46.60-Precut		
Proposed Project Description: Erect Signage (104 Sq Ft)		PEDESTRIAN ACTIVITIES DISTRICT (P.A.D.)		INSPECTION: Use Group: Type:		Zone: B-2 CBL: 125-L-008 Zoning Approval:
		Action: Approved <input type="checkbox"/> Approved with Conditions: <input type="checkbox"/> Denied <input type="checkbox"/>		Signature: Date:		
Permit Taken By: Mary Gresik		Date Applied For: 15 September 1997				Special Zone or Reviews: <input type="checkbox"/> Shoreland <input type="checkbox"/> Wetland <input type="checkbox"/> Flood Zone <input type="checkbox"/> Subdivision <input type="checkbox"/> Site Plan maj <input type="checkbox"/> minor <input type="checkbox"/> mm <input type="checkbox"/>

1. This permit application does not preclude the Applicant(s) from meeting applicable State and Federal rules.
2. Building permits do not include plumbing, septic or electrical work.
3. Building permits are void if work is not started within six (6) months of the date of issuance. False information may invalidate a building permit and stop all work..

Zoning Appeal

Variance
 Miscellaneous
 Conditional Use
 Interpretation
 Approved
 Denied

Historic Preservation

Not in District or Landmark
 Does Not Require Review
 Requires Review

Action:

Approved
 Approved with Conditions
 Denied

Date: 9/16/97

Application Expired

Never Issued - over Allowable Square footage - Contractor notified 9/23/97 - never revised plan

CERTIFICATION

I hereby certify that I am the owner of record of the named property, or that the proposed work is authorized by the owner of record and that I have been authorized by the owner to make this application as his authorized agent and I agree to conform to all applicable laws of this jurisdiction. In addition, if a permit for work described in the application is issued, I certify that the code official's authorized representative shall have the authority to enter all areas covered by such permit at any reasonable hour to enforce the provisions of the code(s) applicable to such permit

Craig M Hebert
 SIGNATURE OF APPLICANT **Craig Hebert** ADDRESS: DATE: **15 September 1997** PHONE:

RESPONSIBLE PERSON IN CHARGE OF WORK, TITLE PHONE:

White-Permit Desk Green-Assessor's Canary-D.P.W. Pink-Public File Ivory Card-Inspector

CEO DISTRICT 6
M. LEARY

SIGNAGE

PLEASE ANSWER ALL QUESTIONS

PERMIT DENIED

Address: 630 FOREST AVE, PORTLAND, ME, Zone: B2

Owner: ~~REDACTED~~ CHURCH CORP. Assessors #: MAP 125 28

Applicant: CHURCH OFFICE EQUIPMENT

Single Tenant Lot?: Yes No

Multi Tenant Lot?: Yes No

Freestanding (Ext pole sign)? Yes No Dimensions _____

More than (1) one sign?: Yes No Dimensions 3'x20' AND 2'x24'

Bldg Wall Sign (att to bldg)? Yes No Dimensions _____

List all existing signage and their dimensions:

Lot Frontage(feet): 161' Tenant Frontage(feet): 61' x 1.5 = 91.5'

AWNINGS

Awning?: Yes No Is Awning Backlit?: Yes No

Is there any communication, message, trademark or symbol on awning? _____

Height of Awning?: _____

PLEASE NOTE: Approvals for signs on the Public Sidewalk and temporary signs come under different requirements and regulations.

ALSO: See reverse side for additional information, requirements and materials needed for signage application submittal.

PERMIT DENIED

*1/2 Allowed
at max
extreme
max 15.75
48
60
1084*

LOCATION OF
3' x 20' SIGN
NOT TO SCALE
607

PERMIT
DENIED

LOCATION OF
2' x 24' SIGN

PERMIT
DENIED

EXHIBIT
A

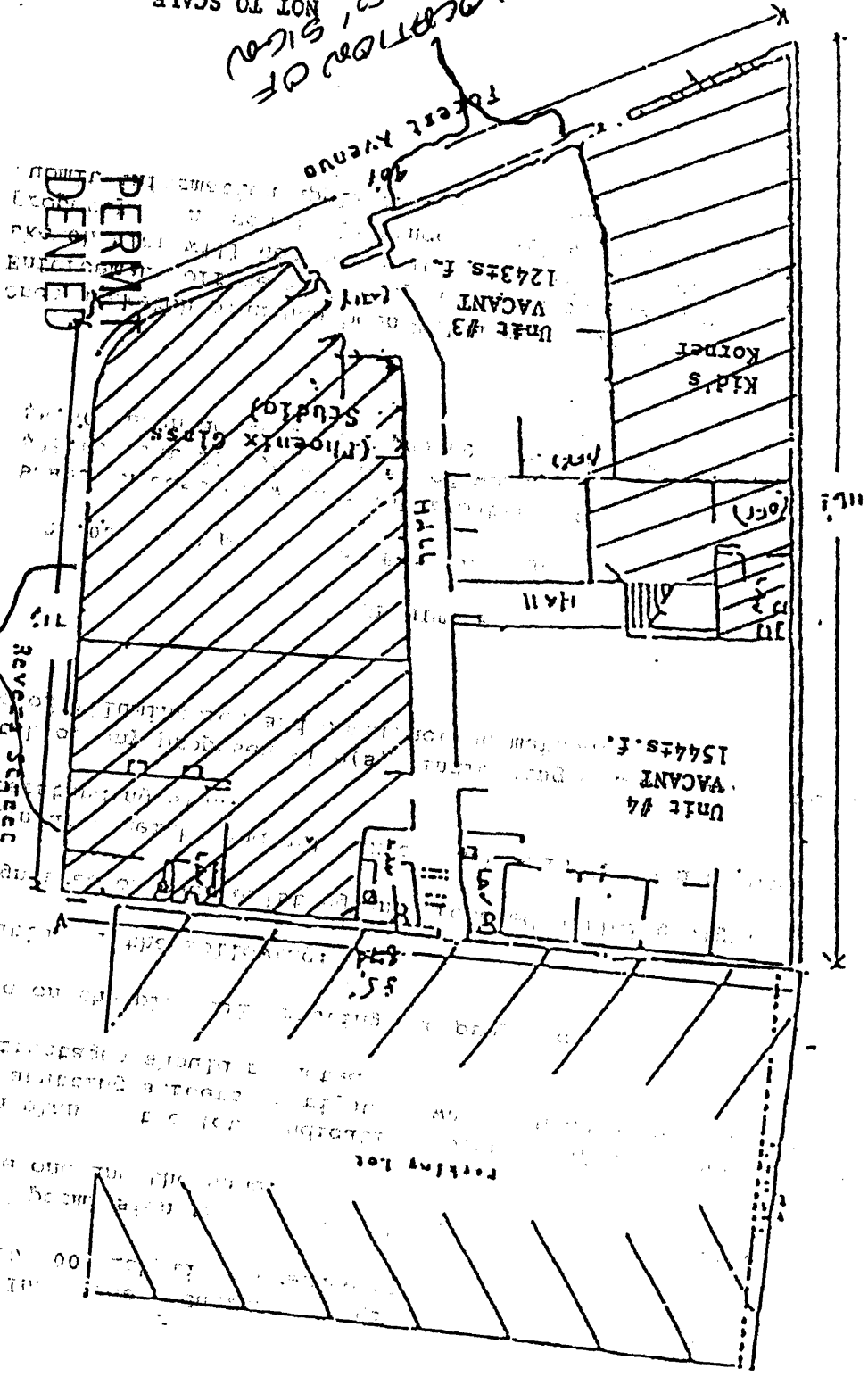

PERMIT
DENIED

PERMIT
DENIED

1

20'

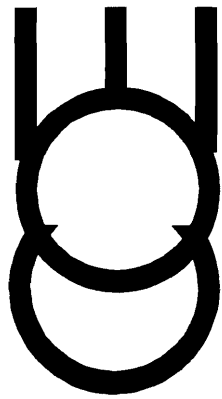

Church Office Equipment

3'

FOR FOREST AVE. FRONT
ALL APPROXIMATE CONSTRUCTION

2

2' x 24' SIGN IS SIMILAR IN APPEARANCE.
CONSTRUCTION IS PLANNED IN A METAL FRAME, MOUNTED ON REVERSE ST. SIDE
BOTH MOUNT FLAT AGAINST THE BUILDING.

PERMIT DENIED

BOZICK FACE
FOREST AVE SIDE

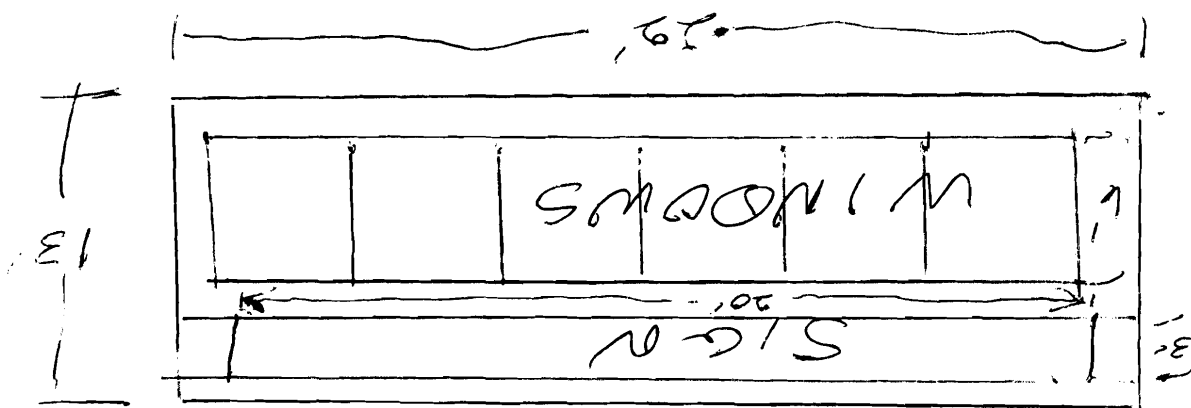

REVERSE ST. SIDE

BOZICK FACE

