

DRAWINGS/SPECIFICATIONS BY:  
 WALGREENS'  
 LANDLORD'S CONSULTANT

ALL CONSTRUCTION WORK, UNLESS NOTED OTHERWISE, BY:  
 WALGREENS' CONTRACTOR  
 LANDLORD'S CONTRACTOR (TURNKEY CONSTRUCTION)

STORE	BUILDING
NEW . . . . . <input checked="" type="checkbox"/>	NEW . . . . . <input type="checkbox"/>
REMODELING . . . . . <input type="checkbox"/>	EXISTING . . . . . <input checked="" type="checkbox"/>
RELOCATION . . . . . <input type="checkbox"/>	NEW SHELL ONLY . . . . . <input type="checkbox"/>
OTHERS . . . . . <input type="checkbox"/>	

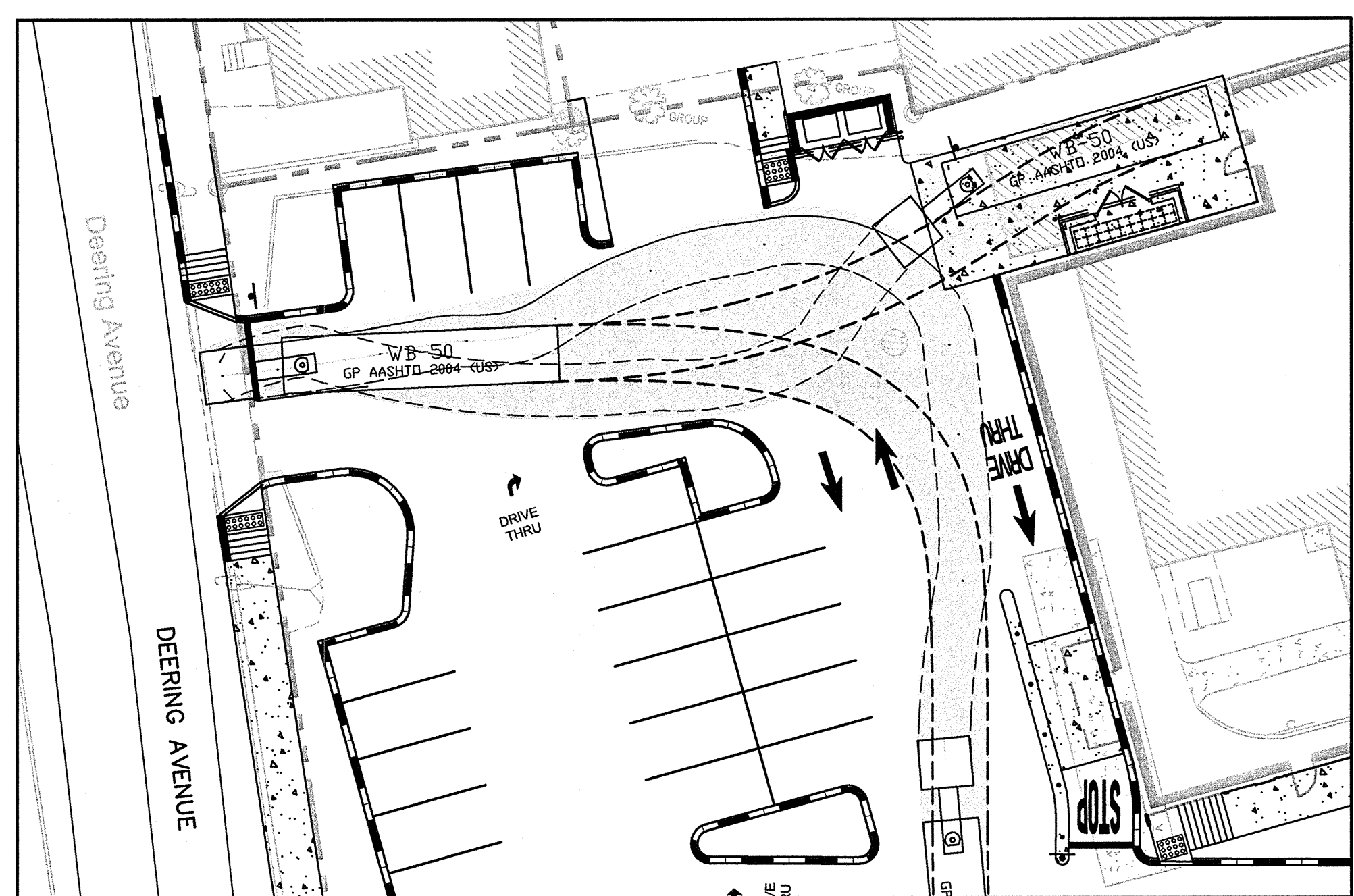

**RECEIVING PLAN DETAIL**  
**WB-50 TRUCK TURNING PATH**  
SCALE: 1" = 20'

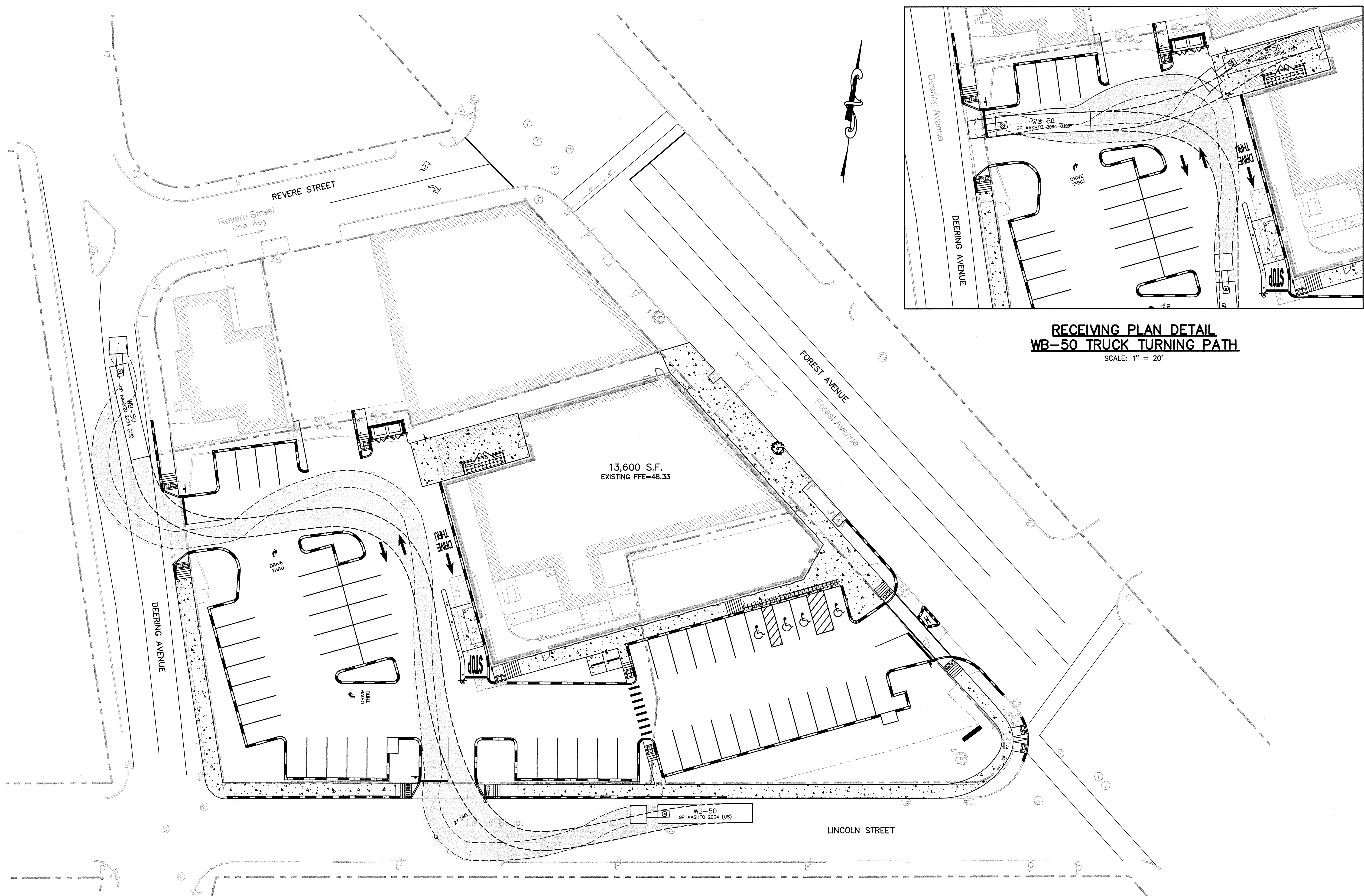

**ACCESS EGRESS PLAN DETAIL**  
**WB-50 TRUCK TURNING PATH**  
SCALE: 1" = 20'

NO.	DATE	BY	DESCRIPTION	CONST
A	12/11/08	MPM	ISSUED FOR CONSTRUCTION	
2	04/16/08	MPM	RESPONSE TO CITY COMMENTS	
1	03/21/08	MPM	RESPONSE TO COMMENTS	

**REVISIONS**  
CERTIFICATION AND SEAL

I HEREBY CERTIFY THAT THIS PLAN AND SPECIFICATION WAS PREPARED BY ME OR UNDER MY DIRECT SUPERVISION AND THAT I AM A DULY REGISTERED ARCHITECT OR ENGINEER UNDER THE LAWS OF THE STATE OF MAINE AS SIGNIFIED BY MY HAND AND SEAL.

STORE NUMBER 12325  
PROJECT NAME  
**WALGREENS - STORE #12325**  
(SWC) FOREST & REVERE  
PORTLAND, MAINE

DRAWING TITLE  
WB-50 TRUCK TURNING PATH

CADD PLOT:	SCALE:	DRAWING NO.:
VOID PLOT:	DRAWN BY: JBC	<b>C4.6</b>
SUPERSEDES PLAN DATED:	DATE: 12/07	OF DWGS.
REVIEWED BY: MPM		



**GP** Gorrill-Palmer Consulting Engineers, Inc.  
PO Box 1237 Transportation and Civil Engineering Services 207-657-6910  
15 Shaker Road FAX: 207-657-6912  
Gray, ME 04039 E-Mail: mailbox@gorrillpalmer.com