

STORE	BUILDING
NEW <input checked="" type="checkbox"/>	NEW <input type="checkbox"/>
REMODELING <input type="checkbox"/>	EXISTING <input checked="" type="checkbox"/>
RELOCATION <input type="checkbox"/>	NEW SHELL ONLY <input type="checkbox"/>
OTHERS <input type="checkbox"/>	

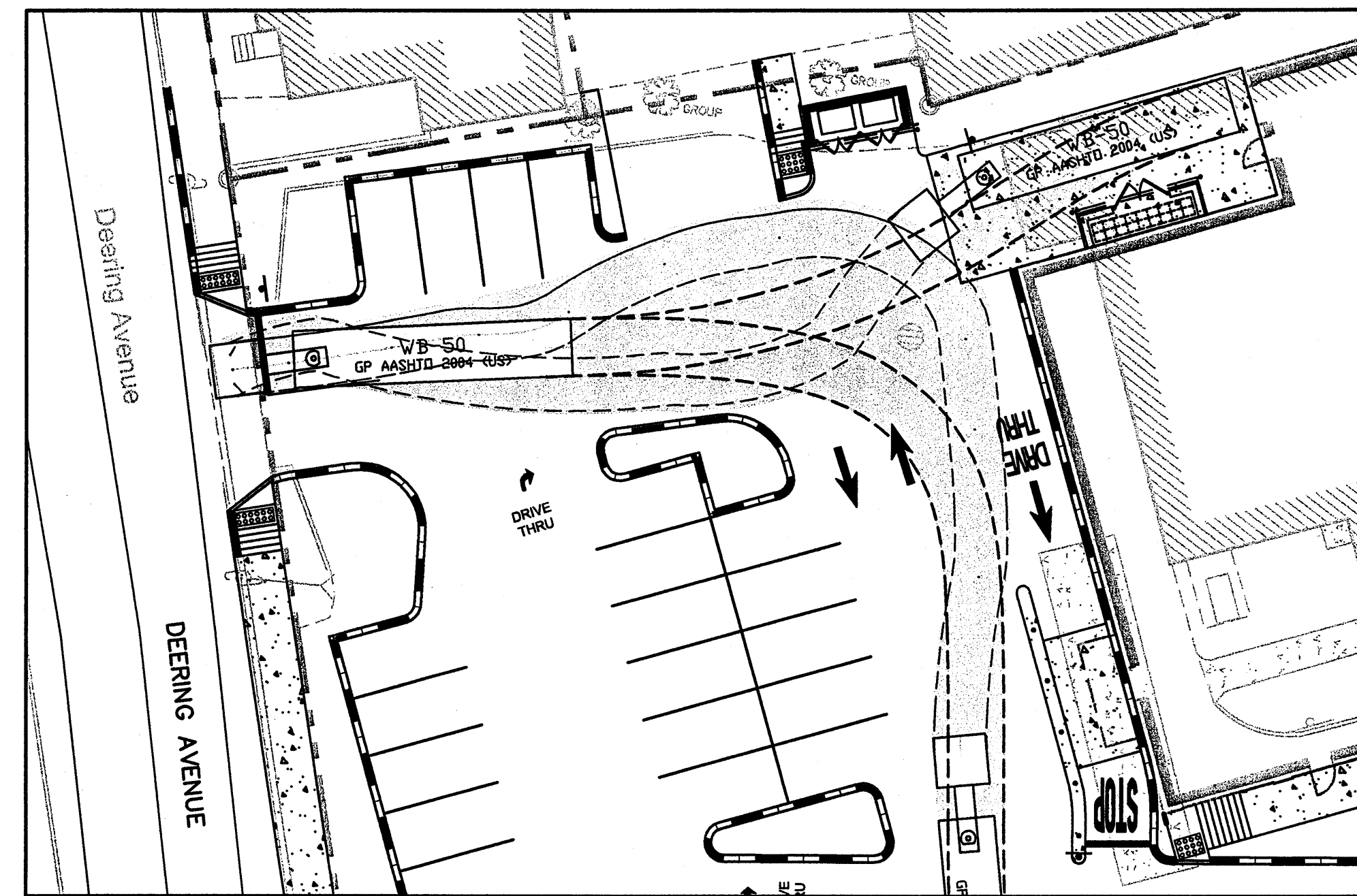

RECEIVING PLAN DETAIL
WB-50 TRUCK TURNING PATH
SCALE: 1" = 20'

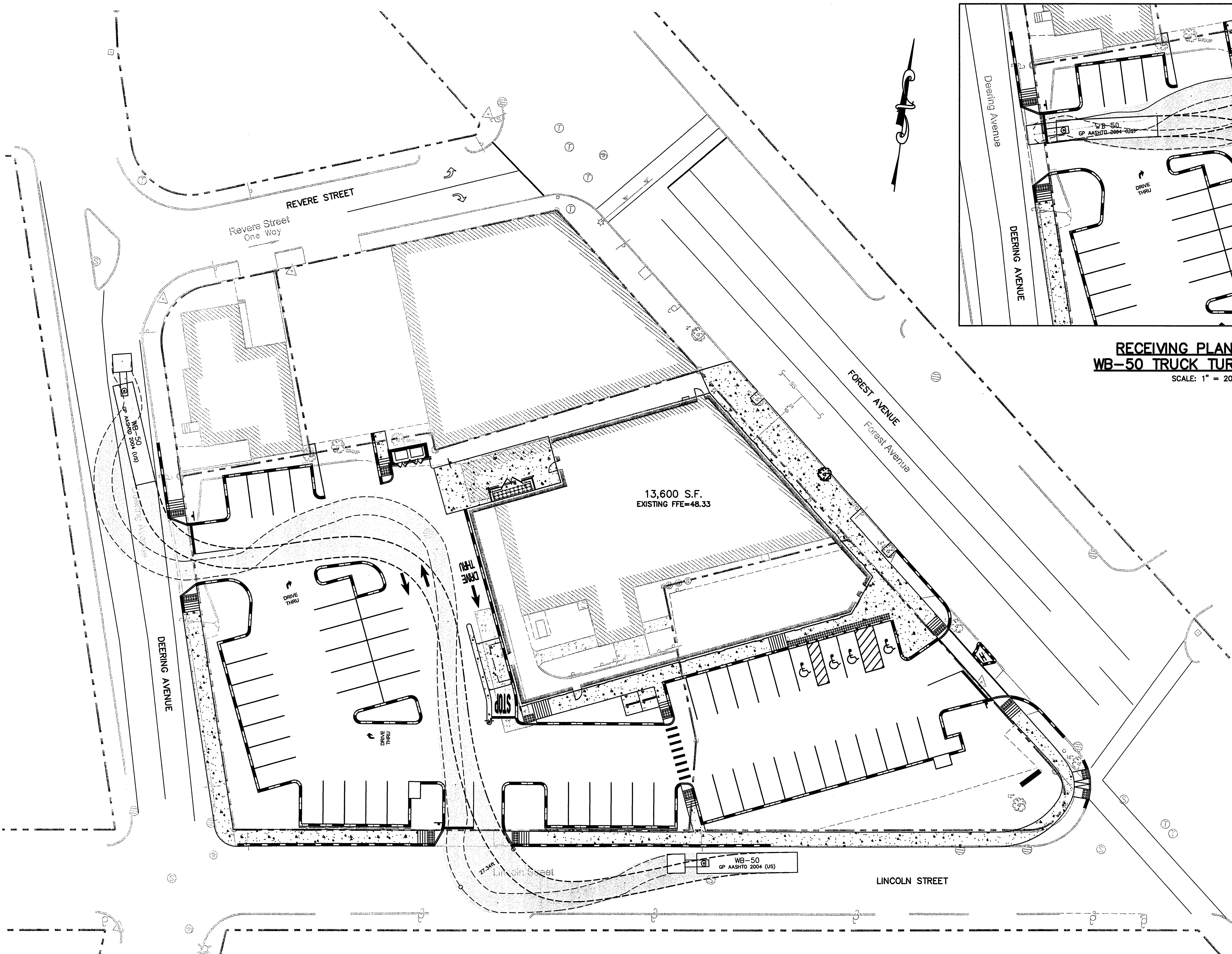

ACCESS EGRESS PLAN DETAIL
WB-50 TRUCK TURNING PATH
SCALE: 1" = 20'

NO.	DATE	BY	DESCRIPTION	CONST
A	12/11/08	MPM	ISSUED FOR CONSTRUCTION	
2	04/16/08	MPM	RESPONSE TO CITY COMMENTS	
1	03/21/08	MPM	RESPONSE TO COMMENTS	

REVISIONS
CERTIFICATION AND SEAL

I HEREBY CERTIFY THAT THIS PLAN AND SPECIFICATION WAS PREPARED BY ME OR UNDER MY DIRECT SUPERVISION AND THAT I AM A DULY REGISTERED ARCHITECT OR ENGINEER UNDER THE LAWS OF THE STATE OF MAINE AS SIGNIFIED BY MY HAND AND SEAL.

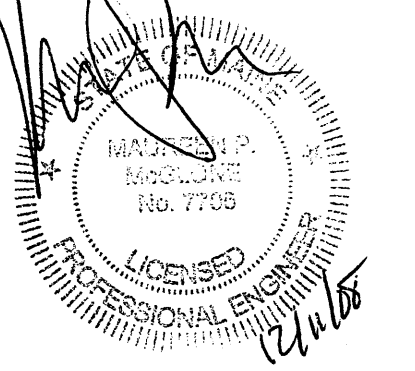

STORE NUMBER 12325
PROJECT NAME
WALGREENS - STORE #12325
(SWC) FOREST & REVERE
PORTLAND, MAINE

DRAWING TITLE
WB-50 TRUCK TURNING PATH

CADD PLOT:	SCALE:	DRAWING NO.:
VOID PLOT:	DRAWN BY: JBC	C4.6
SUPERSEDES PLAN DATED:	DATE: 12/07	
	REVIEWED BY: MPM	OF DWGS.



GP Gorrill-Palmer Consulting Engineers, Inc.
 PO Box 1237 Transportation and Civil Engineering Services 207-657-6910
 15 Shaker Road FAX: 207-657-6912
 Gray, ME 04039 E-Mail: mailbox@gorrillpalmer.com