

Descriptor/Area

A: 1200 sqft

B: WD 150 sqft



150'

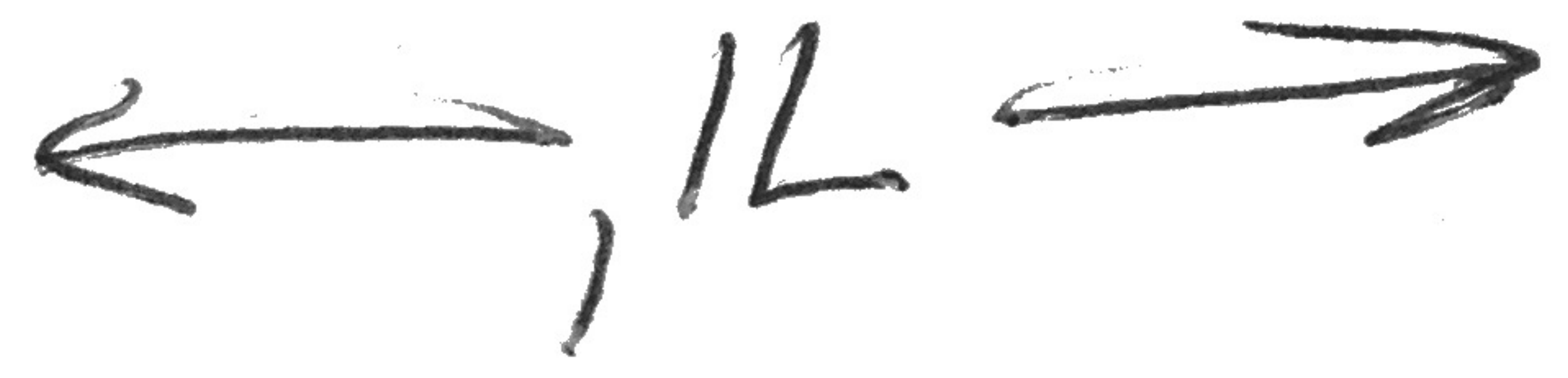
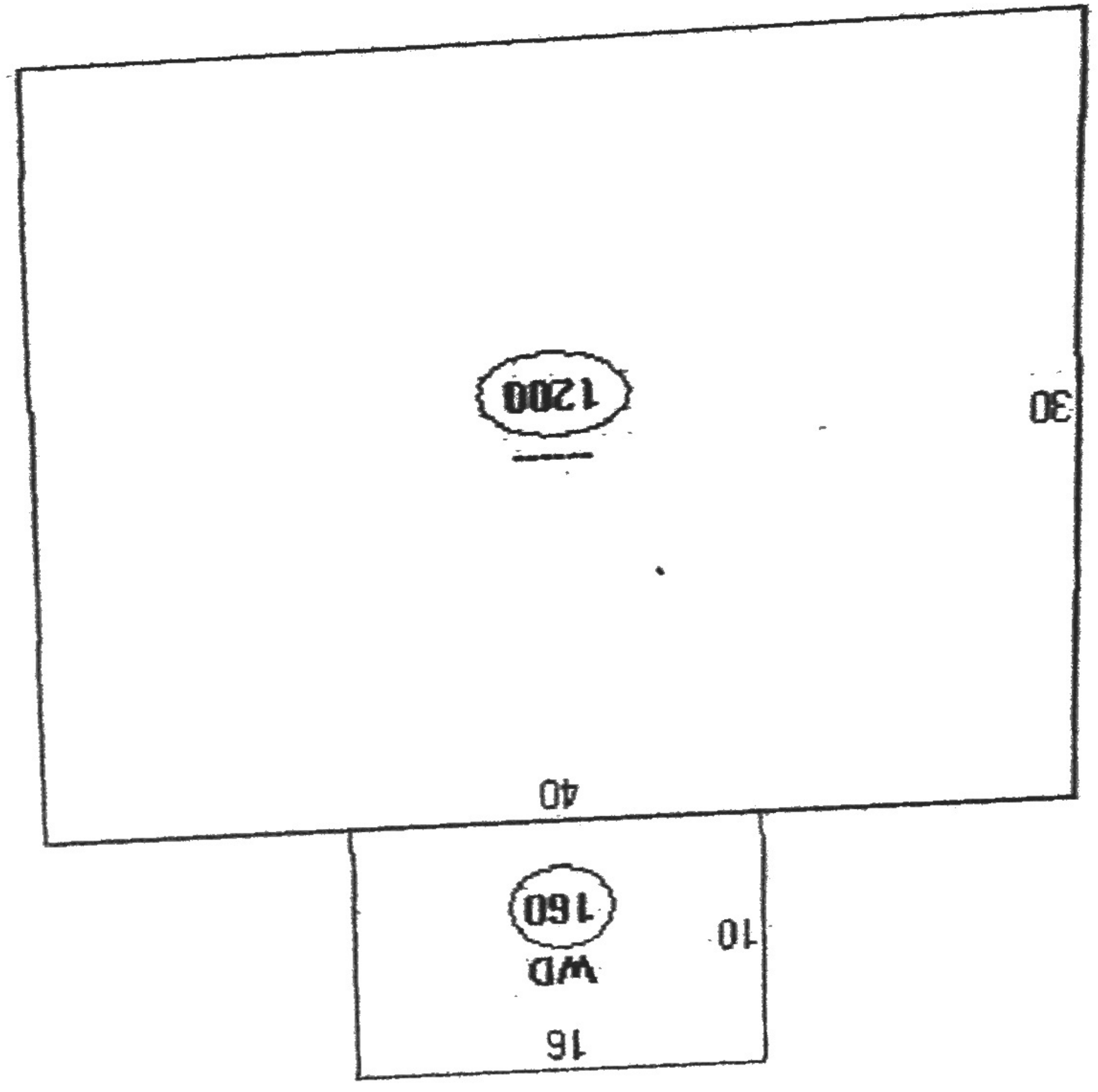

This page contains a detailed description of the Parcel ID you selected. Press the **New Search** button at the bottom of the screen to submit a new query.

Current Owner Information:

CBL 124 G012001
Land Use Type TWO FAMILY
 Verify legal use with Inspections Division
Property Location 131 ASHMONT ST
Owner Information BEVERAGE ANN G & PARKER J BEVERAGE JTS
 131 ASHMONT ST
 PORTLAND ME 04103
Book and Page 31358/284
Legal Description 124-G-12
 ASHMONT ST 127-131
 7911 SF
Acres 0.1816

Current Assessed Valuation:

TAX ACCT NO.	17684	OWNER OF RECORD AS OF APRIL 2013
LAND VALUE	\$89,700.00	LEARY THOMAS D
BUILDING VALUE	\$111,100.00	149 TANDBERG TRAIL
NET TAXABLE - REAL ESTATE	\$200,800.00	WINDHAM ME 04062
TAX AMOUNT	\$3,897.54	

Any information concerning tax payments should be directed to the Treasury office at 874-8490 or e-mailed.

Building Information:

Building 1

Year Built 1898
Style/Structure Type DUPLEX
Stories 2
Units 2
Bedrooms 4
Full Baths 2
Total Rooms 10
Attic NONE
Basement FULL
Square Feet 2400



[View Sketch](#) [View Map](#) [View Picture](#)

Sales Information: