

City of Portland, Maine – Building or Use Permit Application 389 Congress Street, 04101, Tel: (207) 874-8703, FAX: 874-8716

Location of Construction: 191 Ashmont St		Owner: Diggs, Jo		Phone:		Permit No: 961064 PERMIT ISSUED Permit Issued: OCT 24 1996 CITY OF PORTLAND Zone: R3 CBL: 123-I-002 Zoning Approval: <i>to remain 1 family</i> Special Zone or Reviews: <input type="checkbox"/> Shoreland <i>del 9</i> <input type="checkbox"/> Wetland <i>10/23/96</i> <input type="checkbox"/> Flood Zone <input type="checkbox"/> Subdivision <input type="checkbox"/> Site Plan maj <input type="checkbox"/> minor <input type="checkbox"/> mm <input type="checkbox"/>		
Owner Address:		Leasee/Buyer's Name:		Phone:			Business Name:	
Contractor Name: C.A. Monsell & Co.		Address: 23 Glenwood Ave Ptld, ME 04103		Phone: 774-2125			COST OF WORK: \$ 13,000.00 PERMIT FEE: \$ 85.00	
Past Use: 1-fam		Proposed Use: Same		FIRE DEPT. <input type="checkbox"/> Approved <input type="checkbox"/> Denied INSPECTION: Use Group: R3 Type: 50 Signature: <i>[Signature]</i> Signature: <i>[Signature]</i>			PEDESTRIAN ACTIVITIES DISTRICT (P.A.D.) Action: <input type="checkbox"/> Approved <input type="checkbox"/> Approved with Conditions <input type="checkbox"/> Denied Signature: _____ Date: _____	
Proposed Project Description: Rebuild/extend roof				Signature: _____ Date: _____				
Permit Taken By: Mary Greisk		Date Applied For: 18 October 1996				Zoning Appeal <input type="checkbox"/> Variance <input type="checkbox"/> Miscellaneous <input type="checkbox"/> Conditional Use <input type="checkbox"/> Interpretation <input type="checkbox"/> Approved <input type="checkbox"/> Denied		

1. This permit application doesn't preclude the Applicant(s) from meeting applicable State and Federal rules.
2. Building permits do not include plumbing, septic or electrical work.
3. Building permits are void if work is not started within six (6) months of the date of issuance. False information may invalidate a building permit and stop all work..

P/U for debris

CERTIFICATION

I hereby certify that I am the owner of record of the named property, or that the proposed work is authorized by the owner of record and that I have been authorized by the owner to make this application as his authorized agent and I agree to conform to all applicable laws of this jurisdiction. In addition, if a permit for work described in the application issued, I certify that the code official's authorized representative shall have the authority to enter all areas covered by such permit at any reasonable hour to enforce the provisions of the code(s) applicable to such permit

Carey Monsell
 SIGNATURE OF APPLICANT Carey Monsell ADDRESS: _____ DATE: 18 October 1996 PHONE: _____

RESPONSIBLE PERSON IN CHARGE OF WORK, TITLE PHONE: _____

White-Permit Desk Green-Assessor's Canary-D.P.W. Pink-Public File Ivory Card-Inspector

CEO DISTRICT **6**
M. Carey

City of Portland, Maine – Building or Use Permit Application 389 Congress Street, 04101, Tel: (207) 874-8703, FAX: 874-8716

961064

Location of Construction: 191 Ashmont St		Owner: Diaga, Jo		Phone:		Permit No:	
Owner Address:		Leasee/Buyer's Name:		Phone:		BusinessName:	
Contractor Name: C.A. Monnell & Co.		Address: 23 Glenwood Ave, Portland, ME 04103		Phone: 774-2125		Permit Issued: OCT 24 1996	
Past Use: 1-100		Proposed Use: Same		COST OF WORK: \$ 13,000.00		PERMIT FEE: \$ 85.00	
Proposed Project Description: Rebuild/extend roof		FIRE DEPT. <input type="checkbox"/> Approved <input type="checkbox"/> Denied		INSPECTION: Use Group: Type:		Zoning Approval: Zone: CBL: 123-1-002	
		Signature:		Signature:		Special Zone or Reviews: <input type="checkbox"/> Shoreland <input type="checkbox"/> Wetland <input type="checkbox"/> Flood Zone <input type="checkbox"/> Subdivision <input type="checkbox"/> Site Plan maj <input type="checkbox"/> minor <input type="checkbox"/> mm <input type="checkbox"/>	
Permit Taken By: Mary Greisk		Date Applied For: 18 October 1996		PEDESTRIAN ACTIVITIES DISTRICT (P.U.D.) Action: Approved <input type="checkbox"/> Approved with Conditions: <input type="checkbox"/> Denied <input type="checkbox"/>		Zoning Appeal: <input type="checkbox"/> Variance <input type="checkbox"/> Miscellaneous <input type="checkbox"/> Conditional Use <input type="checkbox"/> Interpretation <input type="checkbox"/> Approved <input type="checkbox"/> Denied	
				Signature: Date:		Historic Preservation: <input type="checkbox"/> Not in District or Landmark <input type="checkbox"/> Does Not Require Review <input type="checkbox"/> Requires Review	

1. This permit application doesn't preclude the Applicant(s) from meeting applicable State and Federal rules.
2. Building permits do not include plumbing, septic or electrical work.
3. Building permits are void if work is not started within six (6) months of the date of issuance. False information may invalidate a building permit and stop all work..

P/U for debris

CERTIFICATION

I hereby certify that I am the owner of record of the named property, or that the proposed work is authorized by the owner of record and that I have been authorized by the owner to make this application as his authorized agent and I agree to conform to all applicable laws of this jurisdiction. In addition, if a permit for work described in the application issued, I certify that the code official's authorized representative shall have the authority to enter all areas covered by such permit at any reasonable hour to enforce the provisions of the code(s) applicable to such permit

SIGNATURE OF APPLICANT: *Carey Monnell* ADDRESS: DATE: 18 October 1996 PHONE:

RESPONSIBLE PERSON IN CHARGE OF WORK, TITLE PHONE:

White-Permit Desk Green-Assessor's Canary-D.P.W. Pink-Public File Ivory Card-Inspector

CEO DISTRICT

COMMENTS

11-31-94 - No way yet
1-27-97 - Work is all complete. Must call for
a framing inspector

Inspection Record

Type	Date
Foundation: _____	_____
Framing: _____	_____
Plumbing: _____	_____
Final: _____	_____
Other: _____	_____

1) DILGES - 191 ASHMONT ST.

PROPOSED NEW ATTIC STORAGE SPACE

- 1). REMOVE EXISTING SHED ROOF & ADJOINING GABLE ROOF
- 2). FRAME NEW GABLE ROOF FROM OUTSIDE WALL TO OUTSIDE WALL
- 3). PROVIDE DOOR TO NEW STORAGE SPACE

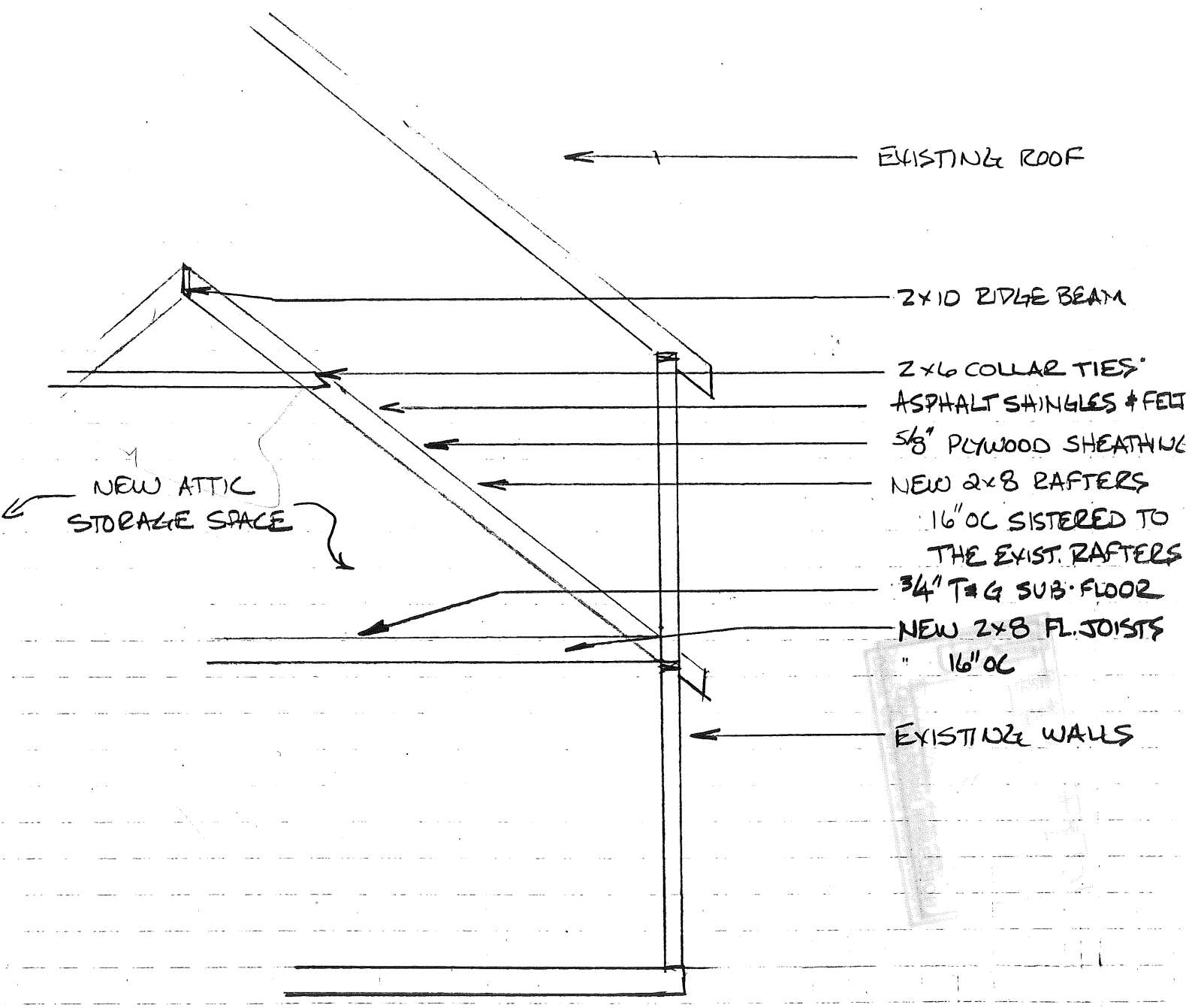

SCALE: 1/4" = 1'-0"

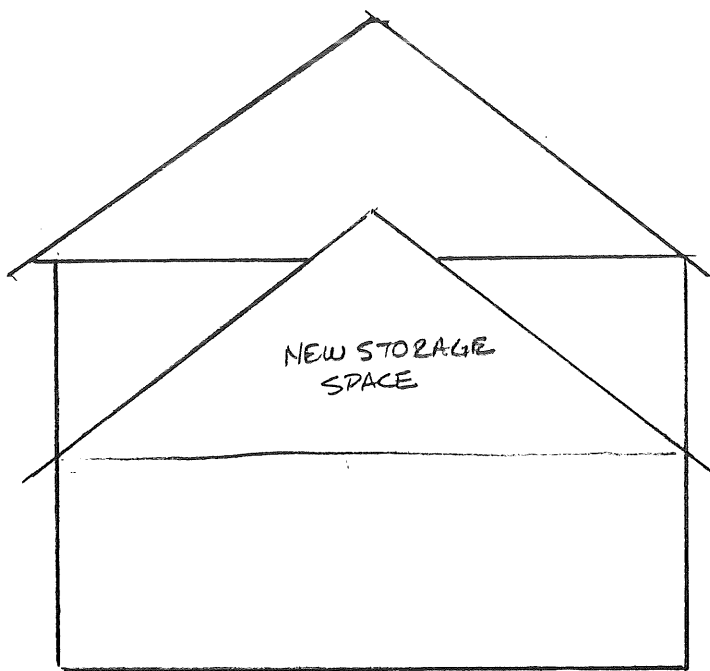

PROPOSED
STRUCTURE

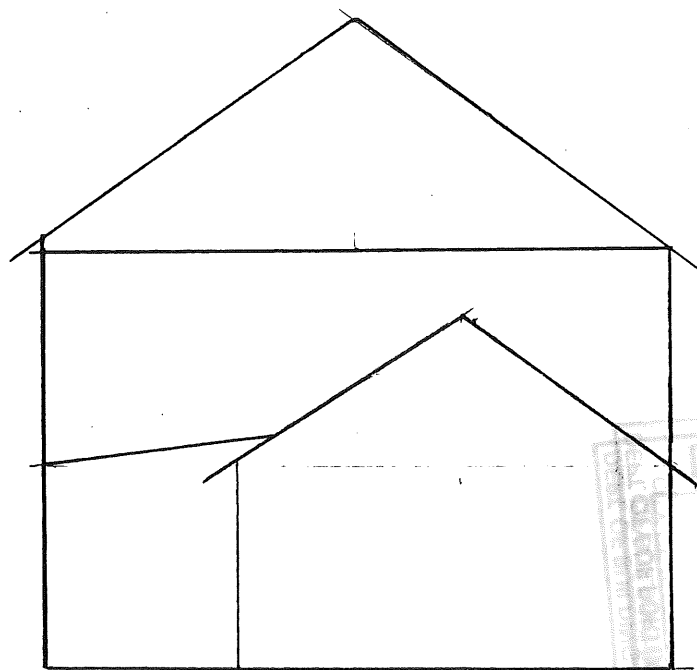

EXISTING
STRUCTURE

SCALE:
 $\frac{1}{8}'' = 1'-0''$