

DISPLAY THIS CARD ON PRINCIPAL FRONTAGE OF WORK CITY OF PORTLAND

Please Read Application And Notes, If Any, Attached

BUILDING PERMIT

PERMIT ISSUED
Permit Number: 100532
JUN - 2 2010
CITY OF PORTLAND

This is to certify that PEIRCE LINCOLN C & JESSICA B GARDNER / Nate Schick

has permission to Interior renovations, remove of window & replace with different

AT 41 RACKLEFF ST City of Portland 123 F001001

provided that the person or persons, firm or corporation accepting this permit shall comply with all of the provisions of the Statutes of Maine and of the Ordinances of the City of Portland regulating the construction, maintenance and use of buildings and structures, and of the application on file in this department.

Apply to Public Works for street line and grade if nature of work requires such information.

Notification of inspection must be given and written permission procured before this building or part thereof is lath or other used-in. 2 HOUSING NOTICE IS REQUIRED.

A certificate of occupancy must be procured by owner before this building or part thereof is occupied.

OTHER REQUIRED APPROVALS

Fire Dept. _____
Health Dept. _____
Appeal Board _____
Other _____
Department Name

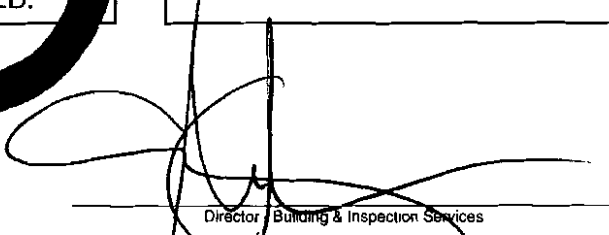
Director, Building & Inspection Services

SCANNED



CITY OF PORTLAND, MAINE
 Department of Building Inspections

Original Receipt

_____ 5-18 20 10 _____

Received from _____ Lincoln Pierce _____

Location of Work _____ 41 Rock Hill St _____

Cost of Construction \$ _____ Building Fee: _____

Permit Fee \$ _____ Site Fee: _____

Certificate of Occupancy Fee: _____

Total: _____

Building (12) _____ Plumbing (15) _____ Electrical (12) _____ Site Plan (12) _____

Other _____

CBL: _____ 123-E-1 _____

Check #: _____ 1478 _____ Total Collected \$ _____ 50 _____

**No work is to be started until permit issued.
 Please keep original receipt for your records.**

Taken by: _____ [Signature] _____

WHITE - Applicant's Copy
 YELLOW - Office Copy
 PINK - Permit Copy

City of Portland, Maine - Building or Use Permit Application

389 Congress Street, 04101 Tel: (207) 874-8703, Fax: (207) 874-8716

Permit No: 10-0532	Issue Date:	CBL: 123 F001001
-----------------------	-------------	---------------------

Location of Construction: 41 RACKLEFF ST	Owner Name: PEIRCE LINCOLN C & JESSICA	Owner Address: 41 RACLIFF ST	Phone:
Business Name:	Contractor Name: Nate Schrock	Contractor Address: 94 Wall Street Portland	Phone: 2077978845
Lessee/Buyer's Name	Phone:	Permit Type: Alterations - Dwellings	Zone: R-5

Past Use: Single Family Home	Proposed Use: Single Family Home - Interior renovations, remove old window & replace w/ different size	Permit Fee: \$50.00	Cost of Work: \$3,000.00	CEO District: 3
Proposed Project Description: Interior renovations, remove old window & replace w/ different size		FIRE DEPT: <input type="checkbox"/> Approved <input type="checkbox"/> Denied <i>NA</i>	INSPECTION: Use Group: <i>R-3</i> Type: <i>SB</i> <i>IRG 2003</i>	

Signature: <i>[Signature]</i>		Signature: <i>[Signature]</i>	
PEDESTRIAN ACTIVITIES DISTRICT (P.A.D.)			
Action: <input type="checkbox"/> Approved <input type="checkbox"/> Approved w/Conditions <input type="checkbox"/> Denied			
Signature:		Date:	

Permit Taken By: ldobson	Date Applied For: 05/19/2010	Zoning Approval	
-----------------------------	---------------------------------	------------------------	--

<p>1. This permit application does not preclude the Applicant(s) from meeting applicable State and Federal Rules.</p> <p>2. Building permits do not include plumbing, septic or electrical work.</p> <p>3. Building permits are void if work is not started within six (6) months of the date of issuance. False information may invalidate a building permit and stop all work..</p>	<p>Special Zone or Reviews</p> <p><input type="checkbox"/> Shoreland</p> <p><input type="checkbox"/> Wetland</p> <p><input type="checkbox"/> Flood Zone</p> <p><input type="checkbox"/> Subdivision</p> <p><input type="checkbox"/> Site Plan</p> <p>Maj <input type="checkbox"/> Minor <input type="checkbox"/> MM <input type="checkbox"/></p> <p>Date: <i>[Signature]</i></p>	<p>Zoning Appeal</p> <p><input type="checkbox"/> Variance</p> <p><input type="checkbox"/> Miscellaneous</p> <p><input type="checkbox"/> Conditional Use</p> <p><input type="checkbox"/> Interpretation</p> <p><input type="checkbox"/> Approved</p> <p><input type="checkbox"/> Denied</p> <p>Date: <i>[Signature]</i></p>	<p>Historic Preservation</p> <p><input checked="" type="checkbox"/> Not in District or Landmark</p> <p><input type="checkbox"/> Does Not Require Review</p> <p><input type="checkbox"/> Requires Review</p> <p><input type="checkbox"/> Approved</p> <p><input type="checkbox"/> Approved w/Conditions</p> <p><input type="checkbox"/> Denied</p> <p>Date: <i>[Signature]</i></p>
---	---	---	--

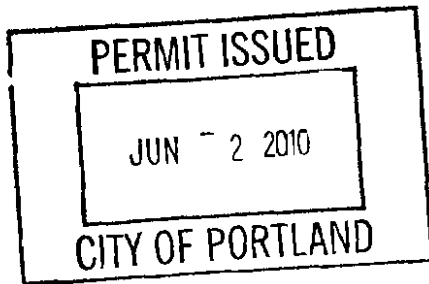

CERTIFICATION

I hereby certify that I am the owner of record of the named property, or that the proposed work is authorized by the owner of record and that I have been authorized by the owner to make this application as his authorized agent and I agree to conform to all applicable laws of this jurisdiction. In addition, if a permit for work described in the application is issued, I certify that the code official's authorized representative shall have the authority to enter all areas covered by such permit at any reasonable hour to enforce the provision of the code(s) applicable to such permit.

SIGNATURE OF APPLICANT

ADDRESS

DATE

PHONE

City of Portland, Maine - Building or Use Permit

389 Congress Street, 04101 Tel: (207) 874-8703, Fax: (207) 874-8716

Permit No: 10-0532	Date Applied For: 05/18/2010	CBL: 123 F001001
------------------------------	--	----------------------------

Location of Construction: 41 RACKLEFF ST	Owner Name: PEIRCE LINCOLN C & JESSICA	Owner Address: 41 RACLIFF ST	Phone:
Business Name:	Contractor Name: Nate Schrock	Contractor Address: 94 Wall Street Portland	Phone: (207) 797-8845
Lessee/Buyer's Name	Phone:	Permit Type: Alterations - Dwellings	

Proposed Use: Single Family Home - Interior renovations, remove old window & replace w/ different size	Proposed Project Description: Interior renovations, remove old window & replace w/ different size
--	---

Dept: Zoning	Status: Approved with Conditions	Reviewer: Marge Schmuckal	Approval Date: 05/19/2010
Note:			Ok to Issue: ✓
<ol style="list-style-type: none"> 1) Separate permits shall be required for future decks, sheds, pools, and/or garages. 2) This is NOT an approval for an additional dwelling unit. You SHALL NOT add any additional kitchen equipment including, but not limited to items such as stoves, microwaves, refrigerators, or kitchen sinks, etc. Without special approvals. 3) This property shall remain a single family dwelling. Any change of use shall require a separate permit application for review and approval. 4) This permit is being approved on the basis of plans submitted. Any deviations shall require a separate approval before starting that work. 			
Dept: Building	Status: Approved with Conditions	Reviewer: Tammy Munson	Approval Date: 05/27/2010
Note:			Ok to Issue: ✓
<ol style="list-style-type: none"> 1) Separate permits are required for any electrical, plumbing, sprinkler, fire alarm HVAC systems, heating appliances, commercial hood exhaust systems and fuel tanks. Separate plans may need to be submitted for approval as a part of this process. 2) Application approval based upon information provided by applicant. Any deviation from approved plans requires separate review and approval prior to work. 			

BUILDING PERMIT INSPECTION PROCEDURES

**Please call 874-8703 or 874-8693 (ONLY)
or email: buildinginspections@portlandmaine.gov**

With the issuance of this permit, the owner, builder or their designee is required to provide adequate notice to the City of Portland Inspection Services for the following inspections. Appointments must be requested 48 to 72 hours in advance of the required inspection. The inspection date will need to be confirmed by this office.

- **Please read the conditions of approval that is attached to this permit!! Contact this office if you have any questions.**
- **Permits expire in 6 months, if the project is not started or ceases for 6 months.**
- **If the inspection requirements are not followed as stated below additional fees may be incurred due to the issuance of a “Stop Work Order” and subsequent release to continue with construction.**

 X **Framing/Rough Plumbing/Electrical: Prior to Any Insulating or drywalling**

 X **Final inspection required at completion of work.**

The project cannot move to the next phase prior to the required inspection and approval to continue, REGARDLESS OF THE NOTICE OR CIRCUMSTANCES.

IF THE PERMIT REQUIRES A CERTIFICATE OF OCCUPANCY, IT MUST BE PAID FOR AND ISSUED TO THE OWNER OR DESIGNEE BEFORE THE SPACE MAY BE OCCUPIED.



General Building Permit Application

If you or the property owner owes real estate or personal property taxes or user charges on any property within the City, payment arrangements must be made before permits of any kind are accepted.

Location/Address of Construction: <u>41 Rackleff St. Portland</u>		
Total Square Footage of Proposed Structure/Area <u>270</u>	Square Footage of Lot <u>9242</u>	Number of Stories <u>2</u>
Tax Assessor's Chart, Block & Lot Chart# <u>123</u> Block# <u>F</u> Lot# <u>1</u>	Applicant * <u>must be owner, Lessee or Buyer</u> * Name <u>Lincoln C. Peirce</u> Address <u>41 Rackleff St.</u> City, State & Zip <u>Portland ME 04103</u>	Telephone: <u>874.4755</u>
Lessee/DBA (If Applicable)	Owner (if different from Applicant) Name Address City, State & Zip	Cost Of Work: \$ <u>3,000</u> C of O Fee: \$ Total Fee: \$ <u>50</u>
Current legal use (i.e. single family) <u>single family</u> Number of Residential Units _____ If vacant, what was the previous use? _____ Proposed Specific use: _____ Is property part of a subdivision? <u>NO</u> If yes, please name _____ Project description: <u>kitchen renovation: complete tear-out, new sheetrock, windows, flooring, electrical. New cabinets & appliances</u>		
Contractor's name: <u>NATE SCHROCK</u> Address: <u>40 ALLEN DRIVE</u> City, State & Zip <u>WINDHAM ME 04062</u> Telephone: <u>415.7283</u> Who should we contact when the permit is ready: <u>Lincoln Peirce</u> Telephone: <u>874.4755</u> Mailing address: <u>41 Rackleff St. Portland ME 04103</u>		

Please submit all of the information outlined on the applicable Checklist. Failure to do so will result in the automatic denial of your permit.

In order to be sure the City fully understands the full scope of the project, the Planning and Development Department may request additional information prior to the issuance of a permit. For further information or to download copies of this form and other applications visit the Inspections Division on-line at www.portlandmaine.gov, or stop by the Inspections Division office, room 315 City Hall or call 874-8703.

I hereby certify that I am the Owner of record of the named property, or that the owner of record authorizes the proposed work and that I have been authorized by the owner to make this application as his/her authorized agent. I agree to conform to all applicable laws of this jurisdiction. In addition, if a permit for work described in this application is issued, I accept that the Code Official's authorized representative shall have the authority to enter all areas covered by this permit at any reasonable hour to enforce the provisions of the codes applicable to this permit.

Signature: [Signature] Date: 5.18.10

This is not a permit; you may not commence ANY work until the permit is issued

RECEIVED
MAY 18 2010
Dept. of Building Inspections
City of Portland, Maine

① of 2

Pearce residence 41 Rockliff St.

Kitchen Renovation

- 4 new windows.
- upgrade of cabinets, appliances, flooring, insulation, drywall, electrical & plumbing.
- removing existing non-supporting partition, enlarging entranceway from mud-room into kitchen.
- & venting hood.



Builder:

Schreck Construction (Mate Schreck)

40 Allen Dr, Windsor, Me. 04062
415-7283 (Schreckinstall@yahoo.com)

Sheldon's Plumbing
50. Portland. 232-3132

Dave Collins
Electrician

671-5286

Electrical: - Apprx. 10 new GFI protected outlets, DW, vent hood, refrigerator (dedicated) c., & Range.
- Apprx 60 - recessed lights in ceiling.

Peirre residence
41 Radcliff

Maite Schroed
Builder
415-7223

(Location at Kitchen sink)
2 new window locations.
(Gable end of house)

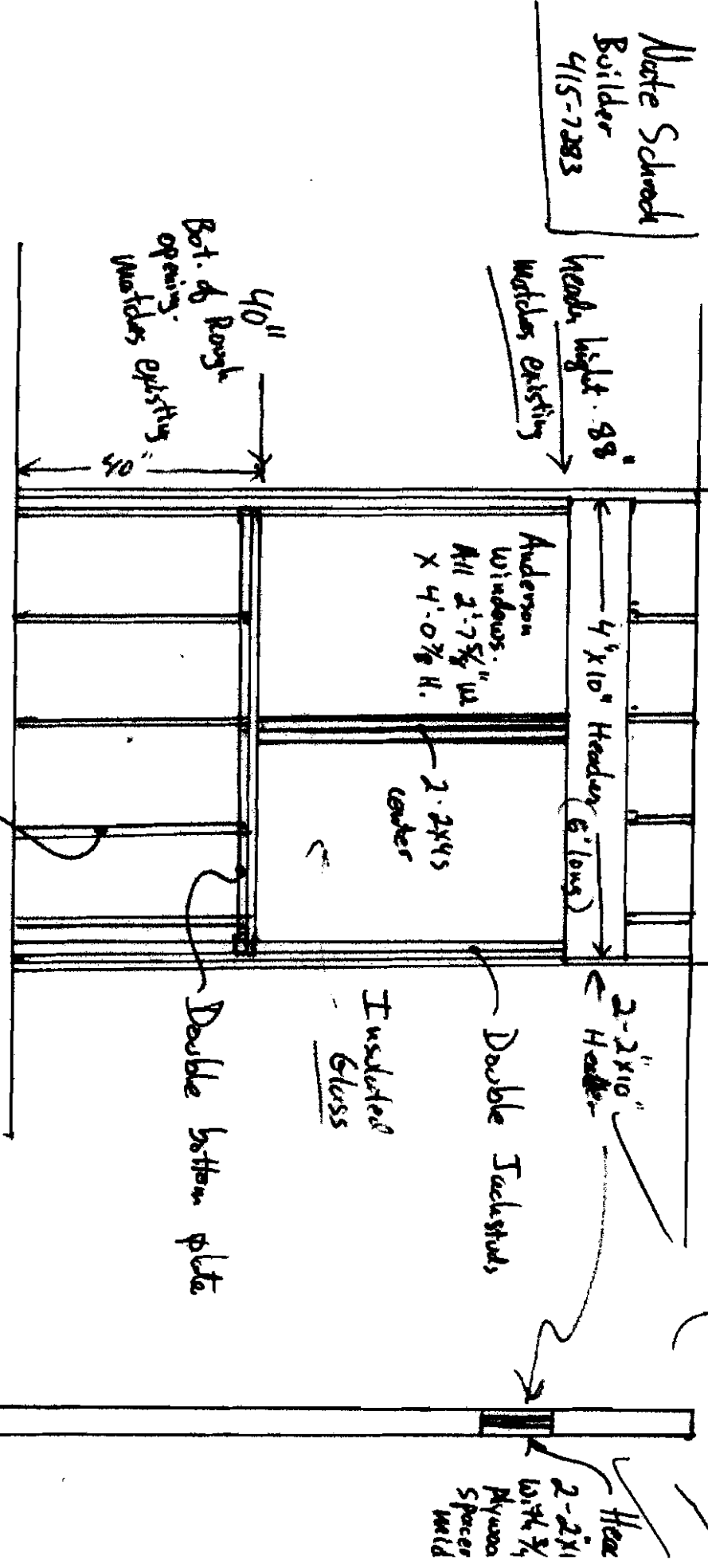

Note. 2 other windows; straight. replaced into existing rough openings.

16" O.C., 2x4" construction to match

RECEIVED

MAY 18 2010

Dept. of Building Inspections
City of Portland Maine

Windows replaced (same loc.s)

2014

Remainder Partition
Remainder Partition

Existing Partition
(non-scp partition)
Remainder Partition

New Window
locations
(see denotation)

SINK

Police residence 41 Rockliff

82 82

