

DISPLAY THIS CARD ON PRINCIPAL FRONTAGE OF WORK CITY OF PORTLAND

Please Read
Application And
Notes, If Any,
Attached

BUILDING INSPECTION

PERMIT

Permit Number: 070694

PERMIT ISSUED

JUN 14 2007

122 G002001

This is to certify that MILLARD JAMES A & KRISTINE S MILLARD/Owner

has permission to Remodel existing stairs

AT 365 STEVENS AVE

provided that the person or persons, firm or corporation accepting this permit shall comply with the provisions of the Statutes of the State and of the Ordinances of the City of Portland regulating the construction, maintenance and use of buildings and structures, and of the application on file with this department.

Apply to Public Works for street line and grade if nature of work requires such information.

Notification of inspection must be given and when permission procured before this building or part thereof is started or closed-in. 24 HOUR NOTICE IS REQUIRED.

A certificate of occupancy must be procured by owner before this building or part thereof is occupied.

OTHER REQUIRED APPROVALS

Fire Dept. _____

Health Dept. _____

Appeal Board _____

Other _____
Department Name

6/14/07 *Cheryl L. [Signature]*
Director - Building & Inspection Services

PENALTY FOR REMOVING THIS CARD

City of Portland, Maine - Building or Use Permit Application

389 Congress Street, 04101 Tel: (207) 874-8703, Fax: (207) 874-8716

Permit No: 07-0694	Issue Date: 06/14/2007	CBL: 122 G002001
-----------------------	---------------------------	---------------------

Location of Construction: 365 STEVENS AVE	Owner Name: MILLARD JAMES A & KRISTINE	Owner Address: 365 STEVENS AVE	Phone: 871 1382
Business Name:	Contractor Name: Owner	Contractor Address: Portland	Phone:
Lessee/Buyer's Name	Phone:	Permit Type: Alterations - Dwellings	Zone: R-5

Past Use: Single Family	Proposed Use: Single Family	Permit Fee: \$50.00	Cost of Work: \$2,500.00	CEO District: 5
		FIRE DEPT: <input type="checkbox"/> Approved <input type="checkbox"/> Denied	INSPECTION: Use Group: R-3 Type: 5B IRC-2003	

Proposed Project Description:
Remodel existing stairs

Signature: _____ Signature: 6/14/07 [Signature]
PEDESTRIAN ACTIVITIES DISTRICT (P.A.D.)
 Action: Approved Approved w/Conditions Denied
 Signature: _____ Date: _____

Permit Taken By: csh	Date Applied For: 06/14/2007	Zoning Approval	
-------------------------	---------------------------------	------------------------	--

1. This permit application does not preclude the Applicant(s) from meeting applicable State and Federal Rules. 2. Building permits do not include plumbing, septic or electrical work. 3. Building permits are void if work is not started within six (6) months of the date of issuance. False information may invalidate a building permit and stop all work..	Special Zone or Reviews <input type="checkbox"/> Shoreland <input type="checkbox"/> Wetland <input type="checkbox"/> Flood Zone <input type="checkbox"/> Subdivision <input type="checkbox"/> Site Plan O.K. Maj <input type="checkbox"/> Minor <input type="checkbox"/> MM <input type="checkbox"/> Date: 6/14/07 [Signature]	Zoning Appeal <input type="checkbox"/> Variance <input type="checkbox"/> Miscellaneous <input type="checkbox"/> Conditional Use <input type="checkbox"/> Interpretation <input type="checkbox"/> Approved <input type="checkbox"/> Denied Date: _____	Historic Preservation <input type="checkbox"/> Not in District or Landmark <input checked="" type="checkbox"/> Does Not Require Review <input type="checkbox"/> Requires Review <input type="checkbox"/> Approved <input type="checkbox"/> Approved w/Conditions <input type="checkbox"/> Denied Date: 6/14/07 [Signature]
--	--	---	--

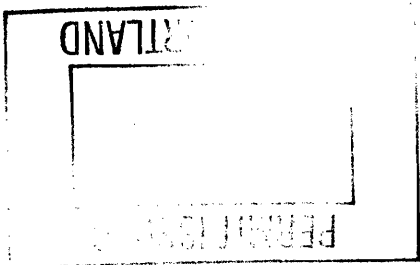

CERTIFICATION

I hereby certify that I am the owner of record of the named property, or that the proposed work is authorized by the owner of record and that I have been authorized by the owner to make this application as his authorized agent and I agree to conform to all applicable laws of this jurisdiction. In addition, if a permit for work described in the application is issued, I certify that the code official's authorized representative shall have the authority to enter all areas covered by such permit at any reasonable hour to enforce the provision of the code(s) applicable to such permit.

SIGNATURE OF APPLICANT _____ ADDRESS _____ DATE _____ PHONE _____

RESPONSIBLE PERSON IN CHARGE OF WORK, TITLE _____ DATE _____ PHONE _____

City of Portland, Maine - Building or Use Permit

389 Congress Street, 04101 Tel: (207) 874-8703, Fax: (207) 874-8716

Permit No: 07-0694	Date Applied For: 06/14/2007	CBL: 122 G002001
------------------------------	--	----------------------------

Location of Construction: 365 STEVENS AVE	Owner Name: MILLARD JAMES A & KRISTINE	Owner Address: 365 STEVENS AVE	Phone: 871 1382
Business Name:	Contractor Name: Owner	Contractor Address: Portland	Phone:
Lessee/Buyer's Name	Phone:	Permit Type: Alterations - Dwellings	

Proposed Use: Single Family	Proposed Project Description: Remodel existing stairs
---------------------------------------	---

Dept: Zoning **Status:** Approved **Reviewer:** Chris Hanson **Approval Date:** 06/14/2007
Note: **Ok to Issue:**

Dept: Building **Status:** Approved with Conditions **Reviewer:** Chris Hanson **Approval Date:** 06/14/2007
Note: **Ok to Issue:**

- 1) Fastener schedule per the IRC 2003
- 2) Application approval based upon information provided by applicant. Any deviation from approved plans requires separate review and approval prior to work.

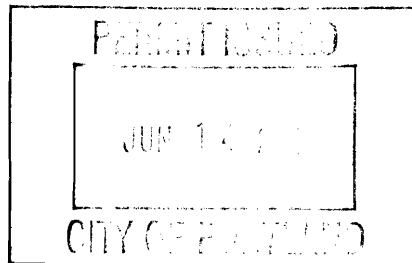

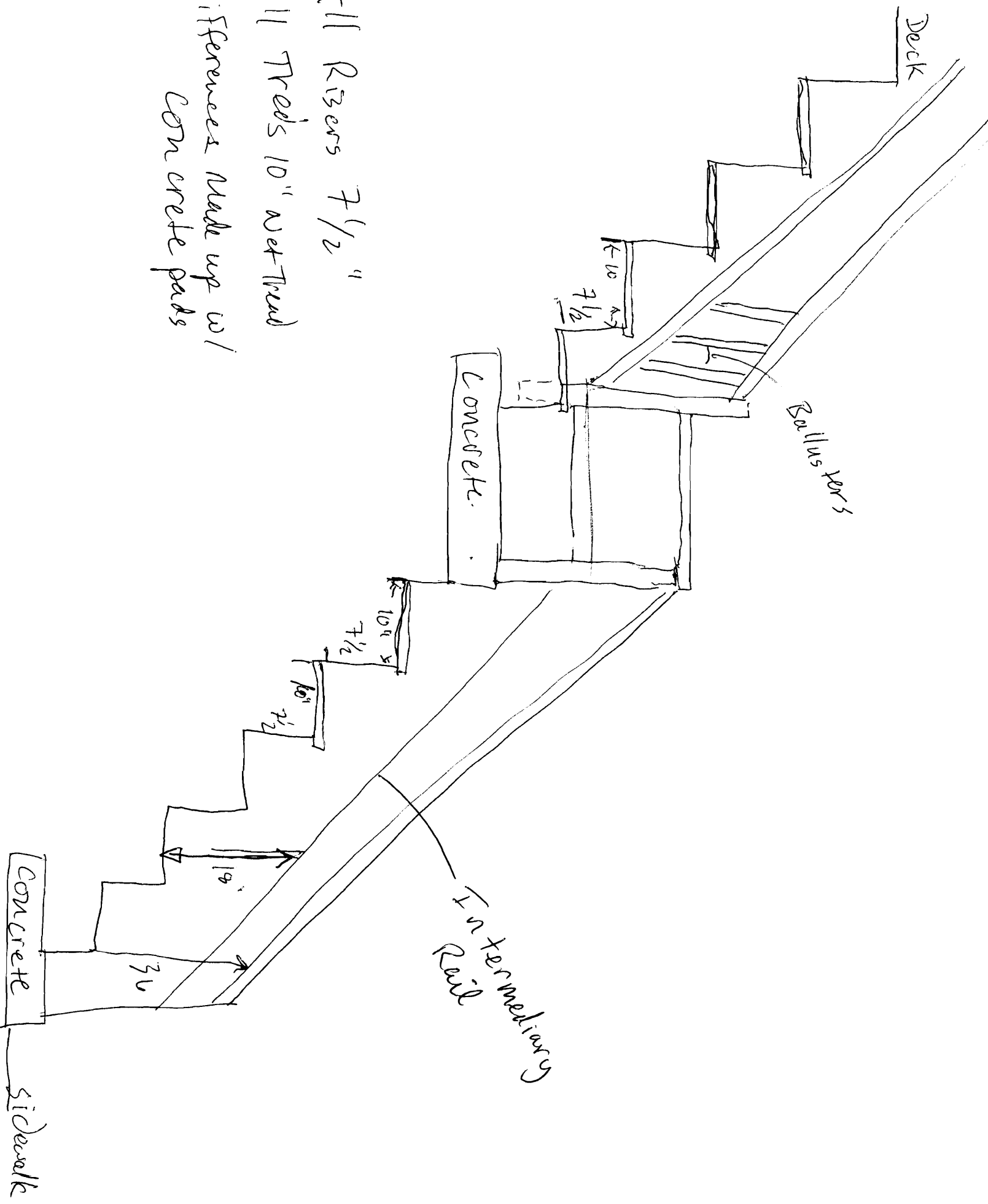

All Risers $7\frac{1}{2}$ "
 All Treads 10 " Net-Tread
 Differences Made up w/
 concrete pads

Please call 874-8703 or 874-8693 to schedule your inspections as agreed upon

Permits expire in 6 months, if the project is not started or ceases for 6 months.

The Owner or their designee is required to notify the inspections office for the following inspections and provide adequate notice. Notice must be called in 48-72 hours in advance in order to schedule an inspection:

By initializing at each inspection time, you are agreeing that you understand the inspection procedure and additional fees from a "Stop Work Order" and "Stop Work Order Release" will be incurred if the procedure is not followed as stated below.

A Pre-construction Meeting will take place upon receipt of your building permit.

- Footing/Building Location Inspection: Prior to pouring concrete
- Re-Bar Schedule Inspection: Prior to pouring concrete
- Foundation Inspection: Prior to placing ANY backfill
- Framing/Rough Plumbing/Electrical: Prior to any insulating or drywalling
- Final/Certificate of Occupancy: Prior to any occupancy of the structure or use. NOTE: There is a \$75.00 fee per inspection at this point.

Certificate of Occupancy is not required for certain projects. Your inspector can advise you if your project requires a Certificate of Occupancy. All projects DO require a final inspection

If any of the inspections do not occur, the project cannot go on to the next phase, REGARDLESS OF THE NOTICE OR CIRCUMSTANCES.

CERTIFICATE OF OCCUPANCIES MUST BE ISSUED AND PAID FOR, BEFORE THE SPACE MAY BE OCCUPIED

James W. Sullivan
Signature of Applicant/Designee

6/14/07
Date

Charles R. [Signature]
Signature of Inspections Official

6/14/07
Date

CBL: 122-G-002

Building Permit #: 07-0694

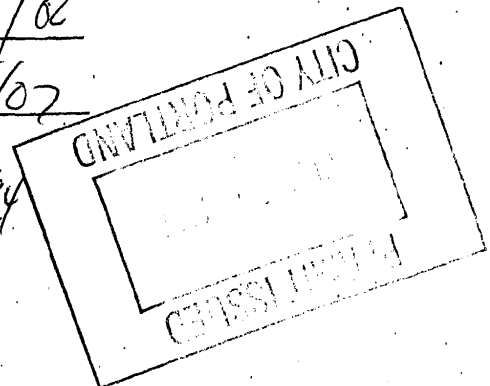



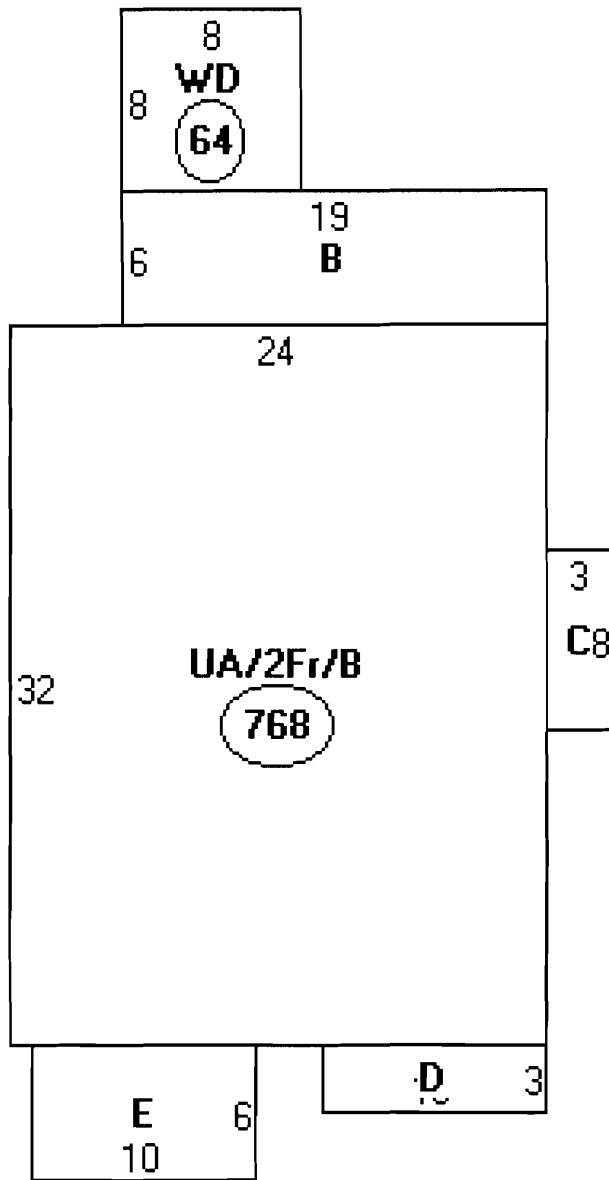

Descriptor/Area

- A: UA/2Fr/B
768 sqft
- B: 1Fr
114 sqft
- C: FBAY/B
24 sqft
- D: 2FBAY/B
30 sqft
- E: OFF
60 sqft
- F: WD
64 sqft



General Building Permit Application

If you or the property owner owes real estate or personal property taxes or user charges on any property within the City, payment arrangements must be made before permits of any kind are accepted.

Location/Address of Construction: <u>365 Stevens Ave Portland</u>		
Total Square Footage of Proposed Structure <u>? Set of stairs to replace existing</u>	Square Footage of Lot <u>50 X 100 5000^{sq}</u>	
Tax Assessor's Chart, Block & Lot Chart# Block# Lot#	Owner: <u>James and Kristine Millard</u>	Telephone: <u>871-1382</u>
Lessee/Buyer's Name (If Applicable)	Applicant name, address & telephone: <u>James M. Millard</u>	Cost Of Work: \$ <u>2,500.00</u> Fee: \$ _____ C of O Fee: \$ _____
Current legal use (i.e. single family) <u>Single family</u> If vacant, what was the previous use? <u>N/A</u> Proposed Specific use: <u>Same</u> Is property part of a subdivision? <u>NO</u> If yes, please name _____ Project description: <u>Replace existing stairs (wood + concrete) w/ new stairs of same dimensions to meet current codes (Samefoot Print)</u>		
Contractor's name, address & telephone: Who should we contact when the permit is ready: <u>James M. Millard</u> Mailing address: <u>365 Stevens Ave Portland 04103</u> Home Phone: <u>871-1382</u> Cell: <u>712-0784</u>		

Please submit all of the information outlined in the Commercial Application Checklist. Failure to do so will result in the automatic denial of your permit.

In order to be sure the City fully understands the full scope of the project, the Planning and Development Department may request additional information prior to the issuance of a permit. For further information visit us on-line at www.portlandmaine.gov, stop by the Building Inspections office, room 315 City Hall or call 874-8703.

I hereby certify that I am the Owner of record of the named property, or that the owner of record authorizes the proposed work and that I have been authorized by the owner to make this application as his/her authorized agent. I agree to conform to all applicable laws of this jurisdiction. In addition, if a permit for work described in this application is issued, I certify that the Code Official's authorized representative shall have the authority to enter all areas covered by this permit at any reasonable hour to enforce the provisions of the codes applicable to this permit.

Signature of applicant: <u>James M. Millard</u>	Date: <u>6/14/07</u>
---	----------------------

This is not a permit; you may not commence ANY work until the permit is issued.

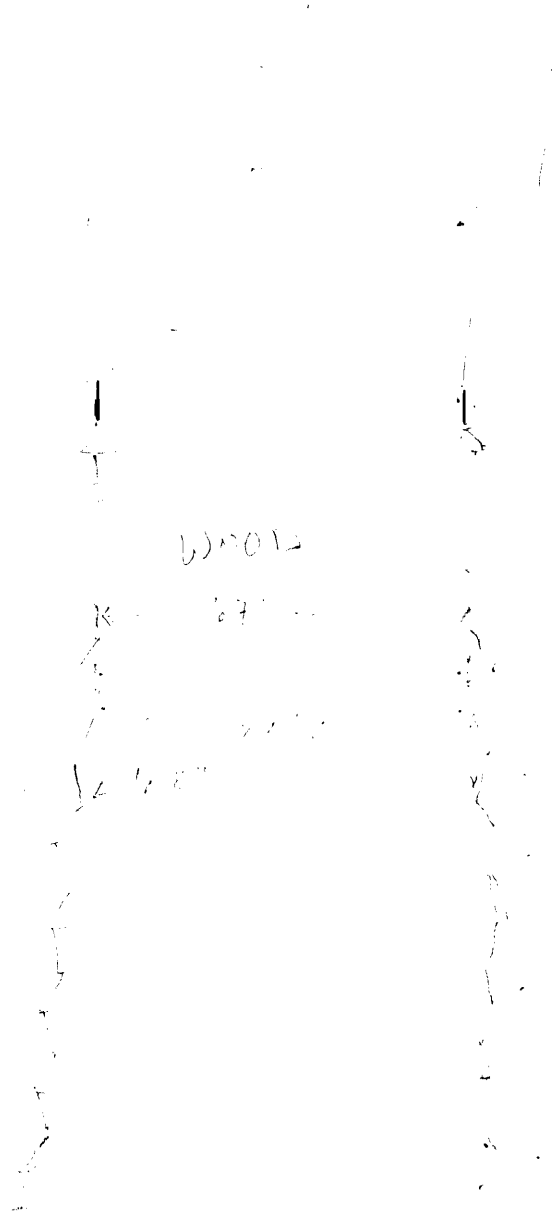

WOOD

67"
 24"
 24"
 24"

(4) 2"

Sigsby K

11 steps including deck
 wood steps are 67" wide - concrete 24"
 Replace all steps w/ one flight of wood
 w/ concrete base + one landing at grade
 Rail on both sides from landing up.