

1. ALL EXIT SIGNS SHALL BE CONNECTED TO AN UNSWITCHED EXISTING LIFE SAFETY LIGHTING CIRCUIT SERVING THE AREA.
2. ALL EMERGENCY LIGHTING FIXTURES SHALL BE CONNECTED TO EXISTING LIFE SAFETY LIGHTING CIRCUIT(S) SERVING THE AREA.

C9 DRAWING NOTES

- NO SCALE
- 1 RELOCATED EXIT SIGN. EXTEND WIRING AND RECONNECT TO EXISTING LIFE SAFETY CIRCUIT.
 - 2 EXTEND (2) #12, (1) #12G IN 3/4" C TO EXISTING NORMAL 277V LIGHTING CIRCUIT SERVING THE AREA. CIRCUIT NUMBERS SHOWN ARE FOR IDENTIFICATION PURPOSES ONLY.
 - 3 PROVIDE NEW SWITCHES TO CONTROL EXISTING LIGHTING.

B9 KEYED NOTES

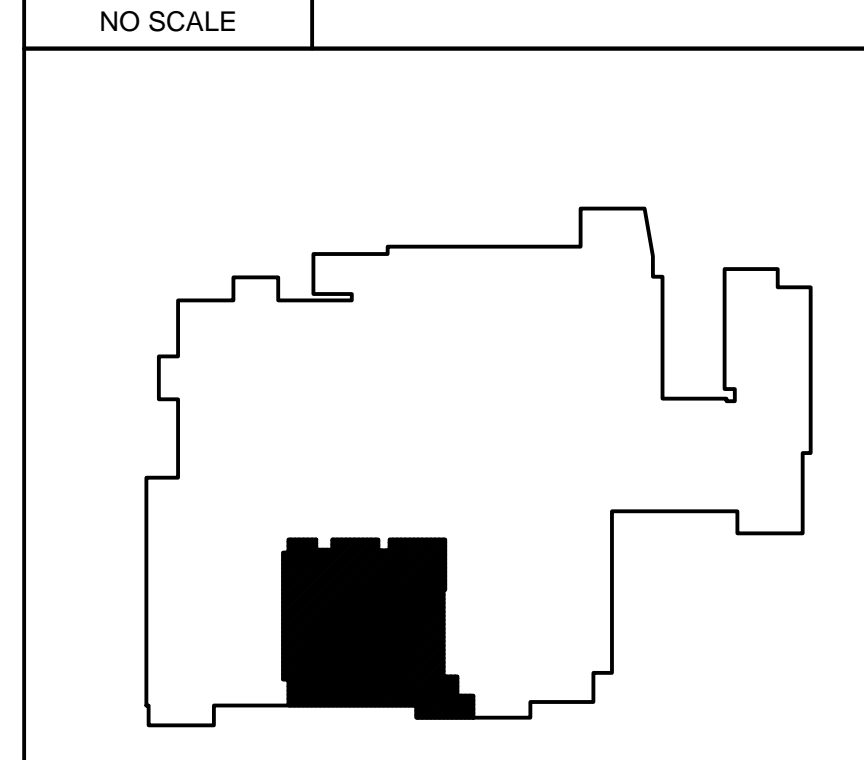

A9 KEY PLAN

NO SCALE



166 Veranda Street
Portland, Maine 04103
Allied Engineering
Structural Mechanical Electrical Commissioning
ES 201.231.2266
www.allied-eng.com

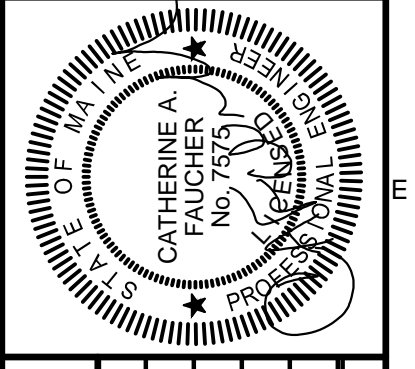

REVISIONS	
NUMBER	DESCRIPTION

Date: SEPTEMBER 25, 2015
Drawn By: GMC
Checked By: KN
Project Mgr: IAM
Project No: 13101
Cad File: 13101_E.dwg
Graphic Scale: 0 1'

ELECTRICAL LIGHTING PLAN
MAINE MEDICAL CENTER
PREP NORDX RENOVATIONS
PORTLAND, MAINE
© copyright 2015 allied engineering, inc.

EL-100

N:\Projects\2013\13101 - MMC Nordx Renovations\00 Drawing Files\13101_E.dwg Sep 24, 2015 - 10:20am