

H14 DEMOLITION PLAN  
1/4" = 1'-0"

SEE SHEET G1001 FOR GENERAL NOTES.

DEMOLITION LEGEND:

- 1 REMOVE EXISTING CEILING AND LIGHT FIXTURES.
- 2 REMOVE EXISTING DOOR, FRAME AND HARDWARE.
- 3 REMOVE EXISTING PARTITION.
- 4 REMOVE PORTION OF EXISTING PARTITION FOR NEW DOOR/ WINDOW/ ALCOVE OPENING
- 5 REMOVE EXISTING CASEWORK
- 6 FLOORING AND MASTIC TO BE REMOVED BY ABATEMENT CONTRACTOR UNDER SEPARATE CONTRACT.
- 7 REMOVE EXISTING PARTITION TO 1" FROM EXISTING CEILING LEAVING TOP PORTION AS A 1" CROSS CORRIDOR SOFFIT.
- 8 REMOVE EXISTING CHAIR RAIL COMPLETE.
- 9 RELOCATE EXISTING FIRE EXTINGUISHER TO WITHIN LAB AS REQUIRED PER OWNER.
- 10 REMOVE AND RELOCATE FIRE EXTINGUISHER CABINET AS INDICATED.

DEMOLITION NOTES:

1. ALL BUILDING STRUCTURAL ELEMENTS SHALL REMAIN.
2. PROTECT ALL EXISTING MATERIALS AND FINISHES. ANY MATERIALS OR FINISHES DISTURBED OR DAMAGED DURING DEMOLITION AND NEW WORK SHALL BE REPAIRED OR REPLACED AND FINISHED TO MATCH ADJACENT CONSTRUCTION CONTINUOUSLY TO NEAREST CORNER.
3. DURING DEMOLITION AND NEW WORK, WHERE EXISTING CONDITIONS ARE FOUND TO BE DEFECTIVE, NOTIFY OWNER AND ARCHITECT AND PROVIDE CHANGE PROPOSAL FOR CORRECTION OF THESE CONDITIONS.
4. SEE MECHANICAL AND PLUMBING DRAWINGS FOR ADDITIONAL REQUIRED BASEMENT DEMOLITION AND PATCHING RELATED TO THOSE TRADES' WORK.

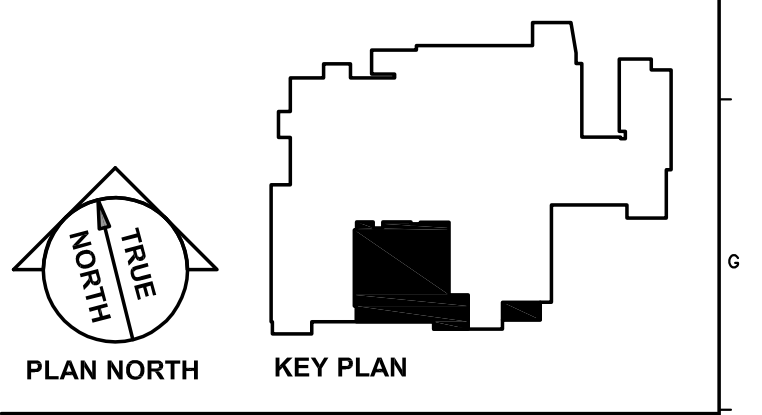

**Allied Engineering**  
Structural Mechanical Electrical Consulting  
160 Veranda Street  
Portland, Maine 04103  
T: 207.251.2268  
F: 207.251.2266  
Web: www.allied-eng.com

REV.	DESCRIPTION	DATE

ISSUED FOR CONSTRUCTION  
09 / 25 / 15  
CURRENT ISSUE STATUS:

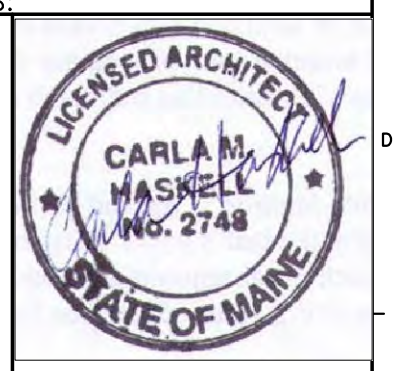

**DESIGN GROUP COLLABORATIVE**  
ARCHITECTURE  
DESIGN + PLANNING  
40 CHURCH STREET  
ELLSWORTH, MAINE  
(207) 664-0560  
22 FREE STREET  
PORTLAND, MAINE  
(207) 659-3300

MAINE MEDICAL CENTER  
PREP NORDX RENOVATIONS  
PORTLAND, MAINE

**REMOVALS PLAN**

SHEET TITLE: A1 DEMOLITION PLAN  
DATE: 9/25/15 GRAPHIC SCALE: AS NOTED  
PROJECT NO. 122033 SHEET No. AD-101  
DRAWN BY: LMC  
A/E OF RECORD: CMH

A1 DEMOLITION PLAN  
1/4" = 1'-0"