

GENERAL LINE TYPES

Table listing various plumbing line types such as Sanitary, Vent, Indirect Waste, Pumped Discharge, Cold Water, Hot Water, Hot Water Return, Tempered Hot Water, Tempered Hot Water Return, 140° Hot Water, 180° Hot Water, Rain Water, Natural Gas, Deionized Water, Oxygen, Medical Air, Medical Vacuum, Waste Anesthetic Gas, Nitrogen, Nitrous Oxide, Carbon Dioxide, and Compressed Air.

ABBREVIATIONS

Table listing plumbing abbreviations such as AAV (Air Admittance Valve), ABV (Above), AFF (Above Finished Floor), BLDG (Building), BOP (Bottom of Pipe), CA (Compressed Air), CFH (Cubic Feet Per Hour), CO (Ceiling), COND (Condensate), CONN (Connection), CONT (Continues), CO2 (Carbon Dioxide), CU FT (Cubic Foot), CW (Cold Water), DIA (Diameter), DN (Down), DWG (Drawing), E (Existing to Remain), ELEV (Elevator or Elevation), ET (Expansion Tank), FCO (Floor Clean Out), FD (Floor Drain), FP (Fire Protection), G (Natural Gas), GAL (Gallon), GPH (Gallons Per Hour), GPM (Gallons Per Minute), HB (Hose Bibb), HD (Hydrogen), HE (Helium), HP (Horsepower), HW (Hot Water), HWR (Hot Water Return), INV EL (Invert Elevation), IW (Indirect Waste), KW (Kilowatt), LAB (Laboratory), LAV (Lavatory), LB (Pound), MA (Medical Air), MAX (Maximum), MBH (Million BTU's Per Hour), MECH (Mechanical), MIN (Minimum), MS (Mop Sink), MV (Medical Vacuum), N (Nitrogen), NIC (Not in Contract), N2O (Nitrous Oxide), NTS (Not to Scale), O2 (Oxygen), ORD (Overflow Rain Water), OS&Y (Outside Screw & Yoke), PH (Phase), PRV (Pressure Reducing Valve), PSI (Pounds Per Square Inch), R (Remove), RAC (Run Above Ceiling), RBF (Run Below Floor), RD (Roof Drain), REC (Recirculating), RPM (Revolutions Per Minute), RWC (Rainwater Conductor), SA (Shock Absorber), SAN (Sanitary), SCH (Schedule), SPEC (Specification), SQ (Square), SQ FT (Square Foot), SS (Stainless Steel), STD (Standard), TEMP (Temperature), TOP (Top of Pipe), T&P (Temperature and Pressure), TPV (Trap Primer Valve), TW (Tempered Hot Water), TWR (Tempered Hot Water Return), TYP (Typical), UR (Urinal), V (Vent or Volts), VAC (Vacuum), VTR (Vent Through Roof), W (Waste), W/ (With), W/O (With Out), WAGD (Waste Anesthetic Gas Disposal), WC (Water Closet), WH (Wall Hydrant), ZV (Medical Zone Valve Box).

GENERAL SYMBOLS

Table listing general plumbing symbols including Point of Connection between New and Existing Work, Point of Demolition between Existing and to be Removed Work, Waste/Vent Stack, Rainwater Conductor, Domestic Water Stack, Detail Number, and Detail Drawing Number.

VALVES

Table listing various valve symbols such as Ball Valve, Check Valve, Gate Valve, Gas Plug Cock, Circuit Setter Balancing Valve, Outside Screw & Yoke, Double Check Valve Assembly, Dual Check Valve Backflow Preventer, Air Admittance Valve, Pressure Reducing Valve (Self-Contained), and Solenoid Actuator.

EQUIPMENT DESIGNATION

Table listing equipment designation symbols including Air Handling Unit, Boiler, Booster Pump, Expansion Tank, Grease Interceptor, Grease Recovery Unit, Hot Water Heater, Mixing Valve, Sump Pump, Vacuum Pump, and Water Softener.

PIPING SYMBOLS

Table listing various piping symbols such as Union, Pipe Cap, Concentric Reducer, Eccentric Reducer, Direction of Flow, Pipe Drop/Pipe Rise, Bottom Outlet Tee, Top Outlet Tee, Strainer, Hose Bibb, Wall Hydrant, Clean Out, Pump, Guide, Pipe Sleeve, Expansion Loop, Flexible Connector, Flow Switch, Aquastat, Pressure Gauge, Thermometer, Shock Absorber, Trap Primer, Vent Thru Roof, Direction of Downward Slope, and Access Door in Ceiling/Wall.

DRAWING LOG

Table containing applicable codes (National Standard Plumbing Code, Main State International Plumbing Code, Uniform Plumbing Code, Philadelphia Plumbing Code, International Fuel Gas Code) and a drawing log table listing sheets P-0 through P-7 (Plumbing Cover Sheet, Demolition Plan, Drainage and Vent Plan, Water and Medical Piping Plan, Details, Schedules, Riser Diagrams, Specifications) with review dates and status.

GENERAL DEMOLITION NOTES

- List of 12 general demolition notes detailing requirements for existing work to be demolished, removal of equipment and piping, coordination with other trades, and safety and legal considerations.

GENERAL NOTES

- List of 19 general notes detailing plumbing system requirements, coordination with other trades, permitting, inspections, and specific installation instructions for various piping and equipment.

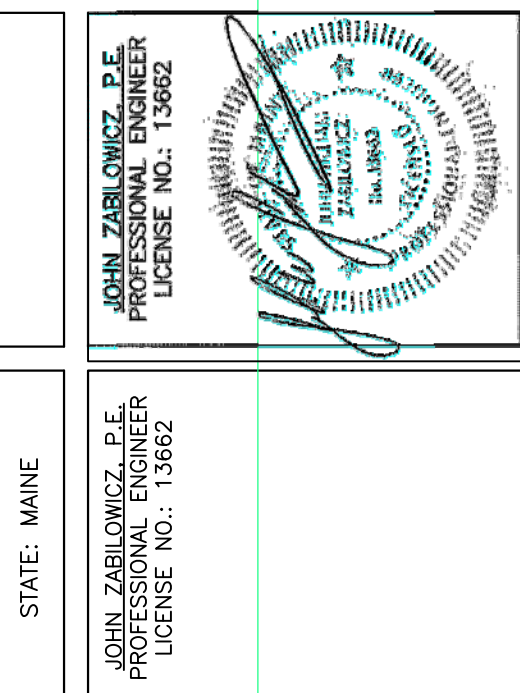
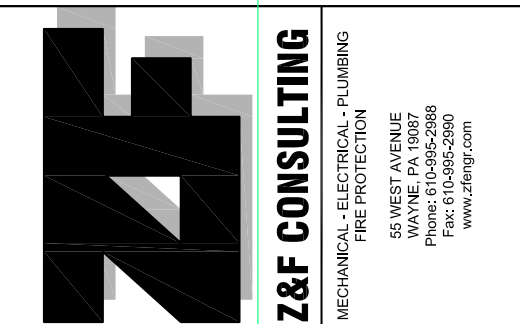

PROJECT: MAINE MEDICAL CENTER BRIGHTON CAMPUS WOUND CARE AND HYPERBARIC MEDICINE 333 BRIGHTON AVENUE PORTLAND, ME 04103

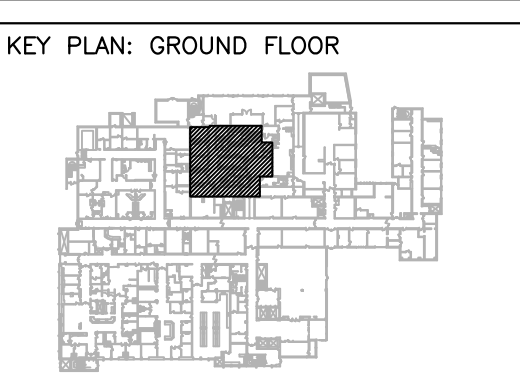

Table of ISSUE DATES: JANUARY 26, 2015 STATE APPROVALS; MARCH 20, 2015 BLDG. DEPT. REVIEW.

Table with project metadata: DRAWN BY: ECH; CHECKED BY: BF; SCALE: AS NOTED; PROJECT NO.: P14110.

SHEET TITLE: PLUMBING COVER SHEET

DRAWING NO.: P-0