

**LEGEND**

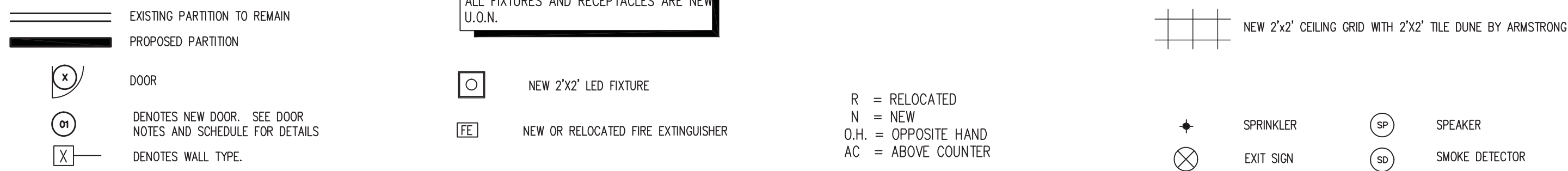

**CONSTRUCTION GENERAL NOTES**

- NOTIFY ARCHITECT IMMEDIATELY OF ANY DISCREPANCIES BETWEEN FIELD CONDITIONS AND CONSTRUCTION DOCUMENTS.
- ALL DIMENSIONS ARE FROM FINISH SURFACE UNLESS OTHERWISE NOTED.
- ANY DOORS, EQUIPMENT, FURNITURE, FIXTURES E.T.C. NOT INTENDED FOR REUSE SHALL BE STORED OR DISPOSED OF AS PER BUILDING OWNER'S DIRECTIONS.
- ALL EXISTING TO REMAIN AND RELOCATED DOORS SHALL BE REFURBISHED TO "AS NEW" STATE.
- ALL EXPOSED PARTICLE BOARD, WOOD, MDF, ETC. SHALL HAVE A SEALED SURFACE.
- NFPA-99 (2005 EDITION)-20-2.1.1.8 THE SUPPORTING FOUNDATION FOR ANY CHAMBER SHALL BE DESIGNED TO SUPPORT THE CHAMBER. CONSIDERATION SHALL BE GIVEN TO ANY ADDED FLOOR STRESSES THAT WILL BE CREATED DURING ANY ON-SITE HYDROSTATIC TESTING.
- NFPA-99(2005 EDITION)-20-2.9.2 EXHAUST FROM ALL CLASSES OF CHAMBERS SHALL BE PIPED OUTSIDE OF THE BUILDING. 20.2.9.2.1 THE POINT OF EXHAUST SHALL NOT CREATE A HAZARD. 20.2.9.2.2 THE POINT OF EXHAUST SHALL NOT ALLOW REENTRY OF GASES INTO THE BUILDING. 20.2.9.2.3 THE POINT OF EXHAUST SHALL BE PROTECTED BY THE PROVISION OF A MINIMUM OF 0.3 CM MESH SCREEN AND SITUATED TO PREVENT THE INTRUSION OF RAIN, SNOW OR AIRBORN DEBRIS.
- NFPA-99 (2005 EDITION)-20-2.1.1.6 WHEN USED FOR HYPERBARIC PROCEDURES, THE ROOM OR ROOMS HOUSING THE CLASS A AND CLASS B CHAMBERS SHALL BE FOR THE EXCLUSIVE USE OF THE HYPERBARIC OPERATION. 20.2.1.1.7 SERVICE EQUIPMENT (E.G., COMPRESSORS) SHALL BE PERMITTED TO BE LOCATED IN MULTI-USE SPACES MEETING THE REQUIREMENTS OF 20-2.1.1.
- NFPA-99 (2005 EDITION)-20-2.1.3 THE ROOM OR ROOMS HOUSING CLASS B AND C CHAMBERS SHALL BE AFFORDED SPRINKLER PROTECTION IN ACCORDANCE WITH 20-2.1.2.
- ICC/ANSI 117.1 COMPLIANT LAVATORIES TO BE INSULATED WITH TURBO INSULATION KIT. PROVIDE AT ALL LAVATORIES WHICH CAN BE ACCESSED BY WHEELCHAIR.
- PROVIDE CONERGUARDS THROUGHOUT SPACE: IN PRO CORPORATION - MONTEREY 0110

**CONSTRUCTION KEY NOTES**

- |  |  |  |
|--|--|--|
| CA 3 5/8" MTL STUDS AND GYP. BOARD OVER NEW OXYGEN LINES FOR HYPERBARIC CHAMBERS. OXYGEN PIPING BY OTHERS. | CG NOT USED  | CL SEE SIM SECTION DETAIL 5/A4.                                      |
| CB FOR BENCH DETAILS SEE 6/A-4 & 7/A-4.  | CH NEW HANDWASH STATION. SEE PLUMBING DRAWINGS FOR SPECIFICATIONS.   | CM RELOCATED FIXTURES AND EQUIPMENT FROM DEMOLISHED EVS.             |
| CC NEW EYEWASH STATION. SEE PLUMBING DRAWINGS FOR SPECIFICATIONS.  | CI LOCKERS PROVIDED BY RESTORIX.   | CN NEW 4'-0" WIDE DOOR AND GLASS ASSEMBLY TO MATCH BUILDING STANDARD |
| CD WASTE AND SOILED RECEPTACLES PROVIDED BY HOSPITAL.  | CJ P.L.M. COUNTER AT 30" AFF. FINISH SHALL BE PL-2.  |  |
| CE LOCATION OF NEW ZONE VALVE BOX PROVIDED AND INSTALLED BY OTHERS.  | CK MIRROR IN CHANGING ROOM: BOBRICK-24"x48" MIRROR W/ STAINLESS STEEL ANGLE FRAME: B-290 2448 ROBE HOOK IN CHANGING ROOM: BOBRICK B-2116 |  |
| CF LOCATION OF NEW OXYGEN ALARM PROVIDED AND INSTALLED BY OTHERS.  |  |  |

**CEILING GENERAL NOTES**

- NO DIRECT FLUORESCENT LIGHTING OVER PATIENT'S HEAD AREA.
- ALL NEW CEILING HEIGHTS TO MATCH EXISTING. VIF ANY INTERFERENCE WITH WINDOW HEADERS, SPRINKLER PIPES, HVAC DUCTWORK, ETC.
- ALL STROBE LIGHT ALARMS SHALL BE INSTALLED PER CABO/ANSI &/OR ADA REQUIREMENTS FOR INSTALLATION HEIGHTS & SPACING.
- G.C. TO SUPPLY AND INSTALL ALL NECESSARY SMOKE DETECTORS, FIRE SAFETY DEVICES IN ACCORDANCE TO THE LOCAL BUILDING CODES.

FOR FIRE SAFETY REFER TO ATTACHED ENGINEERING DWGS (SM DETECT., EXIT SIGNS ETC.)

**CEILING KEY NOTES**

- R1 PROVIDE AND INSTALL CURTAIN AND CURTAIN TRACK, COORDINATE WITH HOSPITAL FOR STANDARD. IF HOSPITAL STANDARD IS NOT AVAILABLE PLEASE USE INTERSPEC FLORET IN COLOR SAGE.
- R2 PROVIDE AND INSTALL NEW 2'-0" X 2'-0" 1/8" CEILING GRID WITH DUNE TEGULAR TILE.

**RECOMENDATIONS FOR ROOMS HOUSING HYPERBARIC CHAMBERS**

- THE ROOM SHOULD BE POSTED AS A "NO SMOKING AREA".
- STRICT FIRE PRECAUTIONS MUST BE TAKEN.
- THE HYPERBARIC CHAMBER MUST NOT BE INSTALLED CLOSE TO ANY HEAT SOURCE.
- FIRE EXTINGUISHERS MUST BE INSTALLED.
- ALL ELECTRICAL EQUIPMENT IN THE TREATMENT FACILITY MUST BE PROPERLY GROUNDED AND IN OPTIMUM WORKING CONDITION.
- TEMPERATURE: THE FACILITY SHOULD BE HEATED AND AIR CONDITIONED TO A PATIENT COMFORT LEVEL. 68-74 DEGREES FAHRENHEIT (20-23 DEGREES CELSIUS) IS RECOMMENDED.
- FLOORING: THE FLOOR SHOULD BE TILE OR HARD SURFACE. CARPETING IS UNACCEPTABLE AS IT MAY GENERATE STATIC ELECTRICITY.
- WINDOW TREATMENT: WINDOWS SHOULD BE COVERED WITH DRAPES OR BLINDS TO SHIELD THE HYPERBARIC CHAMBER ACRYLIC CYLINDERS FROM DIRECT SUNLIGHT.

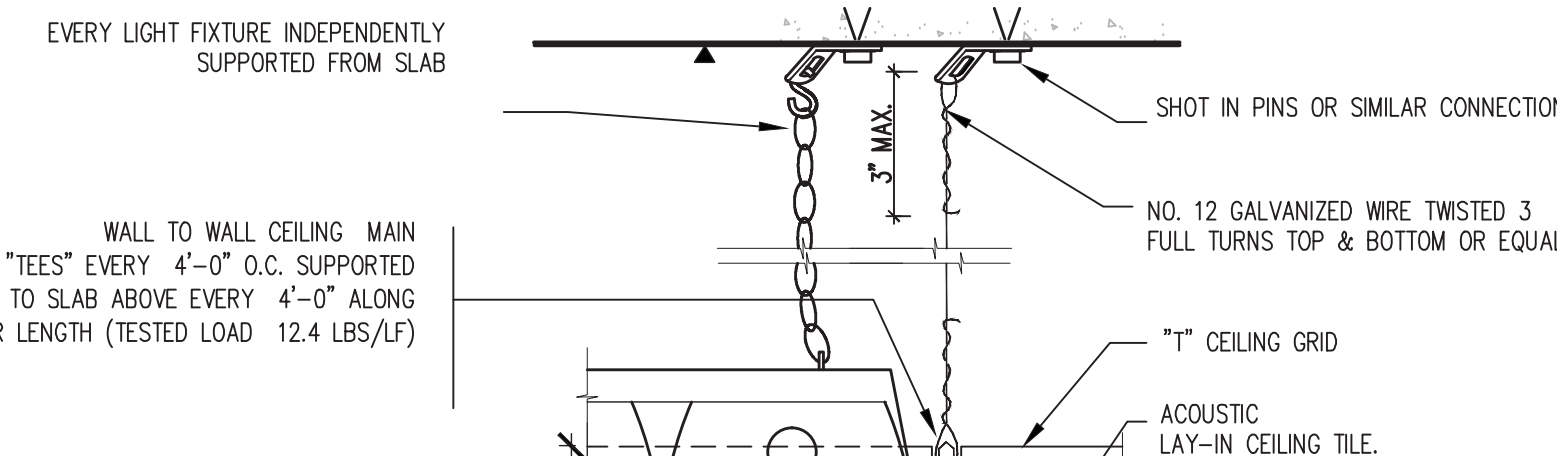

**3 Ceiling Grid Installation Detail**  
Scale 3" = 1'-0"

**PARTITION TYPES**

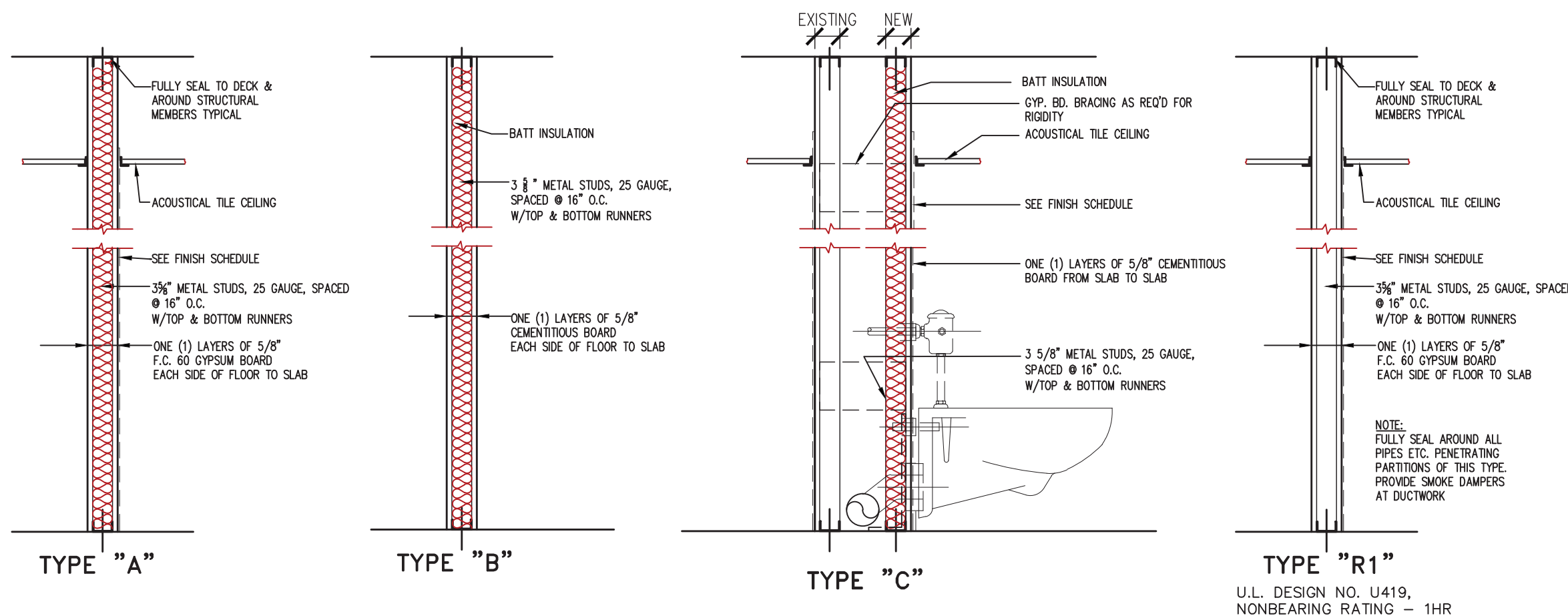

REVIEW SET ONLY-NOT FOR CONSTRUCTION

**2 Construction Ceiling Plan**  
EXISTING GRID THROUGHOUT TO REMAIN U.O.N.  
Scale 1/8" = 1'-0"

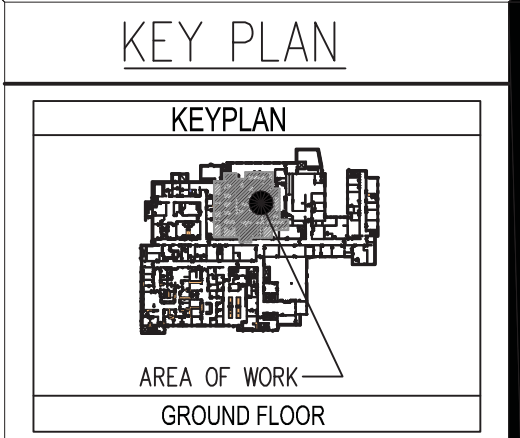

Portland, ME  
Floor: GROUND FLOOR  
Area of Work: 4,333 SQFT

Rev No.	Date	Issued for	Author	Checker	Reviewer	Comments
	12/26/14					
	01/07/15					
	02/23/15					
	03/20/15					

**RestorixHealth**  
Experience in Wound Care

**Maine MC**  
Class "B" Chamber Hyperbaric Suite  
335 BRINGTON AVENUE, PORTLAND ME

**DENNIS NOSKIN ARCHITECTS**  
100 WHITE PLAINS ROAD, FARMINGTON, VT 05091  
DNARCHITECT.com 1-914-631-2345 F. 631-8776

LICENSED ARCHITECT  
DIPLOMA SCOTTISH  
No. 4176  
STATE OF MAINE  
3/20/15

Drawing Name  
CONSTRUCTION AND REFLECTED CEILING PLANS  
SCALE: AS NOTED

Drawing Number  
**A-1**

Project Number  
14091

© 2014 DENNIS NOSKIN ARCHITECT, P.C.