

**Generator MV Gear Replacement**

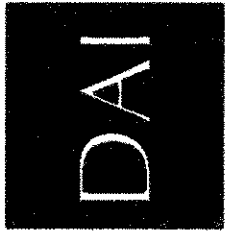

**DIGIORGIO ASSOCIATES INC.**

ARCHITECTURE  
PLANNING  
INTERIOR DESIGN  
ENGINEERING

■ **BOSTON**  
100 HIGHLAND STREET  
BOSTON, MA 02114  
TEL: 617.723.7100  
FAX: 617.723.9113

■ **MAINE**  
484 MAINE AVE., SUITE 2B  
PORTLAND, ME 04108  
TEL: 207.582.2400  
FAX: 207.582.8320

■ **MID-ATLANTIC REGION**  
4616 WESTLAKE DR., SUITE 320  
FARMINGDALE, VA 23169  
TEL: 503.421.8800  
FAX: 703.421.5689

CONSULTANT:

**SYMBOLS & ABBREVIATIONS**

- EXISTING PIPING TO REMAIN
- - - EXISTING PIPING TO BE REMOVED
- LOW PRESSURE CONDENSATE
- HIGH PRESSURE CONDENSATE
- STEAM PIPING
- HOT WATER SUPPLY
- HOT WATER RETURN
- CHILLED WATER SUPPLY
- CHILLED WATER RETURN
- FUEL OIL RETURN
- FUEL OIL SUPPLY
- SPRING OFFSET UP
- SPRING OFFSET DOWN
- BRANCH TAKEOFF FROM PIPING MAIN
- BALL VALVE
- PIPE UNION
- VOLUME DAMPER
- PRESSURE GAUGE
- PRESSURE GAUGE WITH GAUGE COCK
- STEAM TRAP
- DIRECTION OF FLOW
- FLEXIBLE LINK VALVE
- FLEXIBLE CONNECTOR
- DRAIN VALVE
- AIR VENT
- HALL-MOUNTED THERMOSTAT
- EXISTING DUCTWORK TO BE REMOVED
- EXISTING DUCTWORK TO REMAIN
- NEW DUCTWORK
- DUCT OFFSET DOWN
- FIRE DRAIN
- FLEXIBLE DUCTWORK
- VOLUME DAMPER
- MOTOR OPERATED DAMPER
- HALL SUPPLY GRILLE
- HALL RETURN GRILLE
- HALL TRANSFER DUCT
- HALL TRANSFER DUCT
- HALL TRANSFER DUCT
- HALL TRANSFER DUCT
- HALL TRANSFER DUCT
- TYPICAL
- 3/4" DIA.
- 1/2" DIA.
- 1/4" DIA.
- 3/8" DIA.
- 1/2" DIA.
- 3/4" DIA.
- 1" DIA.
- 1 1/2" DIA.
- 2" DIA.
- 3" DIA.
- 4" DIA.
- 6" DIA.
- 8" DIA.
- 10" DIA.
- 12" DIA.
- 14" DIA.
- 16" DIA.
- 18" DIA.
- 20" DIA.
- 24" DIA.
- 30" DIA.
- 36" DIA.
- 42" DIA.
- 48" DIA.
- 60" DIA.
- 72" DIA.
- 84" DIA.
- 96" DIA.
- 108" DIA.
- 120" DIA.
- 144" DIA.
- 168" DIA.
- 192" DIA.
- 216" DIA.
- 240" DIA.
- 264" DIA.
- 288" DIA.
- 312" DIA.
- 336" DIA.
- 360" DIA.
- 384" DIA.
- 408" DIA.
- 432" DIA.
- 456" DIA.
- 480" DIA.
- 504" DIA.
- 528" DIA.
- 552" DIA.
- 576" DIA.
- 600" DIA.

**NUMBERED NOTES**

- 1 NOT USED
- 2 RELOCATED EXISTING ELECTRICAL HEATER TO NEW LOCATION AND REWIRING TO NEW LOCATION. PROVIDE NEW PIPING AND HANGERS AS SHOWN ABOVE.
- 3 3/4" DIA. DRAIN PIPING TO BE REMOVED. 3/4" DIA. DRAIN PIPING TO REMAIN.
- 4 3/4" DIA. DRAIN PIPING TO BE REMOVED. 3/4" DIA. DRAIN PIPING TO REMAIN.
- 5 3/4" DIA. DRAIN PIPING TO BE REMOVED. 3/4" DIA. DRAIN PIPING TO REMAIN.
- 6 3/4" DIA. DRAIN PIPING TO BE REMOVED. 3/4" DIA. DRAIN PIPING TO REMAIN.
- 7 3/4" DIA. DRAIN PIPING TO BE REMOVED. 3/4" DIA. DRAIN PIPING TO REMAIN.
- 8 3/4" DIA. DRAIN PIPING TO BE REMOVED. 3/4" DIA. DRAIN PIPING TO REMAIN.
- 9 3/4" DIA. DRAIN PIPING TO BE REMOVED. 3/4" DIA. DRAIN PIPING TO REMAIN.
- 10 3/4" DIA. DRAIN PIPING TO BE REMOVED. 3/4" DIA. DRAIN PIPING TO REMAIN.
- 11 3/4" DIA. DRAIN PIPING TO BE REMOVED. 3/4" DIA. DRAIN PIPING TO REMAIN.
- 12 3/4" DIA. DRAIN PIPING TO BE REMOVED. 3/4" DIA. DRAIN PIPING TO REMAIN.
- 13 3/4" DIA. DRAIN PIPING TO BE REMOVED. 3/4" DIA. DRAIN PIPING TO REMAIN.
- 14 3/4" DIA. DRAIN PIPING TO BE REMOVED. 3/4" DIA. DRAIN PIPING TO REMAIN.

**GROUND FLOOR - PIPING**  
SCALE: 1/8"=1'-0"

**BASEMENT - DUCTWORK & GENERATOR EXHAUST**  
SCALE: 1/8"=1'-0"

**ROOF - PIPING & GENERATOR EXHAUST**  
SCALE: 1/8"=1'-0"

**FIRST FLOOR - PIPING**  
SCALE: 1/8"=1'-0"

**BASEMENT - PIPING**  
SCALE: 1/8"=1'-0"

**FIRST FLOOR - DUCTWORK**  
SCALE: 1/8"=1'-0"

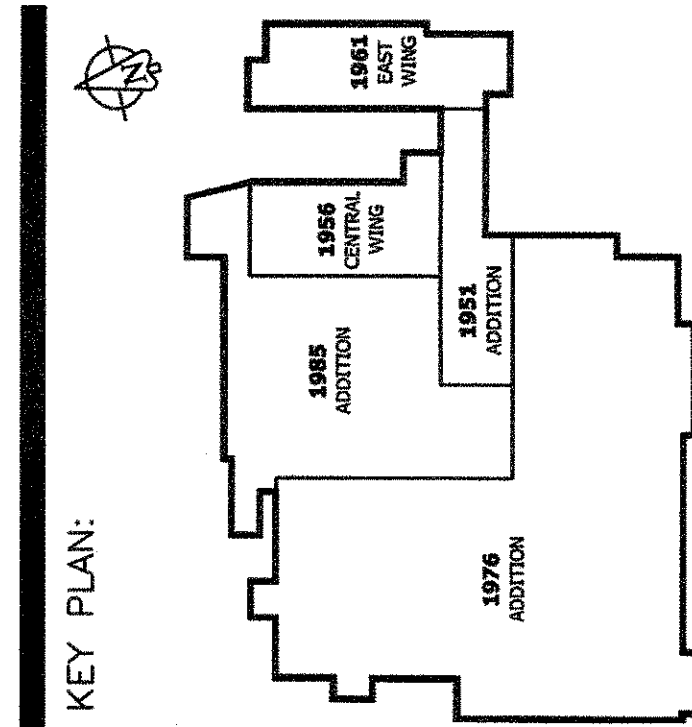

**KEY PLAN:**

REVISION NO.	DATE	DESCRIPTION
1		
2		
3		
4		
5		
6		
7		
8		
9		
10		
11		
12		
13		
14		
15		
16		
17		
18		
19		
20		
21		
22		
23		
24		
25		
26		
27		
28		
29		
30		
31		
32		
33		
34		
35		
36		
37		
38		
39		
40		
41		
42		
43		
44		
45		
46		
47		
48		
49		
50		
51		
52		
53		
54		
55		
56		
57		
58		
59		
60		

**ISSUE:**

**LETTER:** DATE DESCRIPTION

A 08/08/09 100% OWNER REVIEW SET

B 08/13/09 ISSUED FOR BIDD.

**REVISION:**

NO. DATE DESCRIPTION

**DRAWING TITLE:**  
BASEMENT, GROUND & FIRST FLOOR DUCTWORK & PIPING

**DRAWING NO.:**  
**M-201**

**SEAL:**

DESIGNED BY: [NAME]

CHECKED BY: [NAME]

DRAWN BY: [NAME]

DATE: [DATE]

PROJECT NO.: 083274.03E