

DISPLAY THIS CARD ON PRINCIPAL FRONTAGE OF WORK CITY OF PORTLAND

Please Read
Application And
Notes, If Any,
Attached

BUILDING INSPECTION PERMIT

Permit Number: 051463

PERMIT ISSUED
OCT 20 2005
CITY OF PORTLAND

This is to certify that WINSLOW CARLTON / Owner
has permission to demolish 14' x 24' building attached to the side of a brick masonry structure.
AT 368 BRIGHTON AVE PORTLAND, OR 97203 CALL 121 F014001

provided that the person or persons who perform or supervise the work accepting this permit shall comply with all of the provisions of the Statutes of the State of Oregon and of the Ordinances of the City of Portland regulating the construction, maintenance and use of buildings and structures, and of the application on file in this department.

Apply to Public Works for street line and grade if nature of work requires such information.

Notification of inspection must be given and when permission procedure is complete this building or part thereof shall be closed or otherwise closed-in for 24 HOUR NOTICE REQUIRED.

A certificate of occupancy must be procured by owner before this building or part thereof is occupied.

OTHER REQUIRED APPROVALS

Fire Dept. _____
Health Dept. _____
Appeal Board _____
Other _____
Department Name

[Handwritten Signature]
Director - Building & Inspection Services

PENALTY FOR REMOVING THIS CARD

City of Portland, Maine - Building or Use Permit Application

389 Congress Street, 04101 Tel: (207) 874-8703, Fax: (207) 874-8716

Permit No: 05-1463	Issue Date: PERMIT ISSUED OCT 20 2005	EBL: 121 FO 4001
-----------------------	--	---------------------

Location of Construction: 368 BRIGHTON AVE	Owner Name: WINSLOW CARLTON	Owner Address: 368 BRIGHTON AVE	Phone:
Business Name:	Contractor Name: Owner	Contractor Address: Portland	Phone:
Lessee/Buyer's Name	Phone:	Permit Type: Demolitions	Zone:

Past Use: Single Family Home	Single Family Home/ demolish 14' x 24' building attached to the side of the brick main structure.	\$30.00	\$500.00	3
Proposed Project Description: demolish 14' x 24' building attached to the side of the brick main structure.		FIRE DEPT: <input type="checkbox"/> Approved <input type="checkbox"/> Denied		INSPECTION: Use Group: <i>DEM</i> Type: <i>10/19/05</i>
		PEDESTRIAN ACTIVITIES DISTRICT (P.A.D.) Action <input type="checkbox"/> Approved <input type="checkbox"/> Approved w/Conditions <input type="checkbox"/> Denied Signature _____ Date _____		

Permit Taken By: Idobson	Date Applied For: 10/11/2005	Zoning Approval		
-----------------------------	---------------------------------	------------------------	--	--

1. 2. 3.	Special Zone or Reviews <input type="checkbox"/> Shoreland <input type="checkbox"/> Wetland <input type="checkbox"/> Flood Zone <input type="checkbox"/> Subdivision <input type="checkbox"/> Site Plan Maj <input type="checkbox"/> Minor <input type="checkbox"/> MM <input type="checkbox"/> late: _____	Zoning Appeal <input type="checkbox"/> Variance <input type="checkbox"/> Miscellaneous <input type="checkbox"/> Conditional Use <input type="checkbox"/> Interpretation <input type="checkbox"/> Approved <input type="checkbox"/> Denied late: _____	Historic Preservation <input type="checkbox"/> Not in District or Landmark <input type="checkbox"/> Does Not Require Review <input type="checkbox"/> Requires Review <input type="checkbox"/> Approved <input type="checkbox"/> Approved w/Conditions <input type="checkbox"/> Denied Date: _____
------------------------	---	---	---

CERTIFICATION

I hereby certify that I am the owner of record of the named property, or that the proposed work is authorized by the owner of record and that I have been authorized by the owner to make this application as his authorized agent and I agree to conform to all applicable laws of this jurisdiction. In addition, if a permit for work described in the application is issued, I certify that the code official's authorized representative shall have the authority to enter all areas covered by such permit at any reasonable hour to enforce the provision of the code(s) applicable to such permit.

SIGNATURE OF APPLICANT	ADDRESS	DATE	PHONE
RESPONSIBLE PERSON IN CHARGE OF WORK, TITLE		DATE	PHONE

10/12/05 I met with owner & walked through structure
to be demolished - all utilities disconnected & no
sign or rodents/insects. OK to demolish.

Tom M

City of Portland, Maine - Building or Use Permit

389 Congress Street, 04101 Tel: (207) 874-8703, Fax: (207) 874-8716

Permit No: 05-1463	Date Applied For: 10/11/2005	CBL: 121 F014001
------------------------------	--	----------------------------

Location of Construction: 368 BRIGHTON AVE	Owner Name: WINSLOW CARLTON	Owner Address: 368 BRIGHTON AVE	Phone:
Business Name:	Contractor Name: Owner	Contractor Address: Portland	Phone:
Lessee/Buyer's Name	Phone:	Permit Type: Demolitions	

Proposed Use: Single Family Home/ demolish 4' x 24' building attached to the side of the brick main structure.	Proposed Project Description: demolish 14' x 24' building attached to the side of the brick main structure.
--	---

Dept: Building **Status:** Approved **Reviewer:** Mike Nugent **Approval Date:** 10/19/2005
Note: **Ok to Issue:**

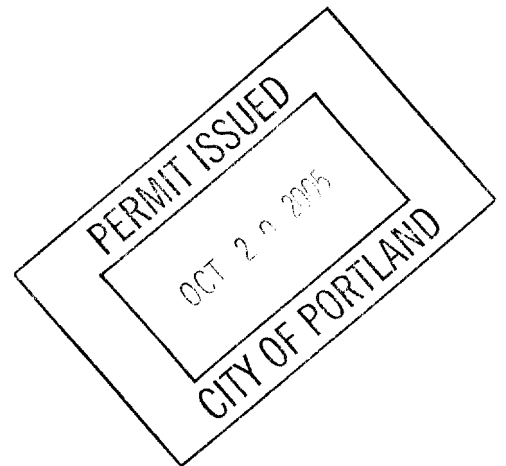

All Purpose Building Permit Application for Demolition of A Structure

-If you or the property owner **Owes** real estate or personal property taxes or user charges on any property within the City, payment arrangements must be made before permits of any kind are accepted.

Location/Address of Construction: <u>368 Brighton Avenue</u>		
Total Square Footage of Proposed Structure <u>336 Sq. ft. to be torn off</u>	Square Footage of Lot <u>18,387</u>	
Tax Assessor's Chart, Block & Lot Chart# <u>121</u> Block# <u>F</u> Lot# <u>14,13,17</u>	Owner: <u>Carlton Winslow</u>	Telephone: <u>773-8281</u>
Lessee/Buyer's Name (If Applicable) <u>(Phone 318-8284)</u>	Applicant name, address & telephone: <u>Carlton Winslow</u> <u>51-A Burnham St.</u> <u>Portland, Me. 04102</u>	cost Of Work: \$ <u>0</u> Fee: \$ _____
Current use: _____		
If the location is currently vacant, what was prior use: <u>Single family</u>		
Approximately how long has it been vacant: <u>3-4 years</u>		
Project description: <u>Removing deteriorated wooden addition right side</u>		
DEMOLITION CALL LIST MUST BE SUBMITTED WITH THIS APPLICATION		
Contractor's name, address & telephone: <u>To be done by Owner</u>		
Whom should we contact when the permit is ready: <u>Carlton Winslow</u>		
Mailing address: <u>Will Pick up - Please call 318-8284</u>		
Phone: _____		

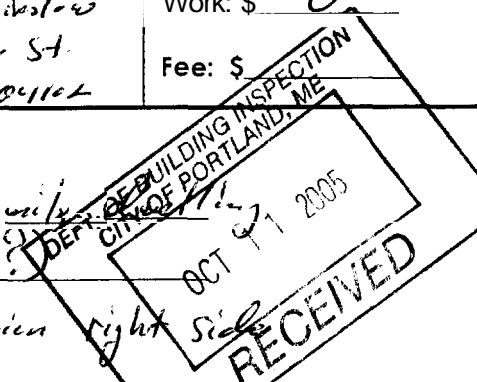

IF THE REQUIRED INFORMATION IS NOT INCLUDED IN THE SUBMISSIONS THE PERMIT WILL BE AUTOMATICALLY DENIED AT THE DISCRETION OF THE BUILDING/PLANNING DEPARTMENT, WE MAY REQUIRE ADDITIONAL INFORMATION IN ORDER TO APPROVE THIS PERMIT.

I hereby certify that I am the Owner of record of the named property, or that the owner of record authorizes the proposed work and that I have been authorized by the owner to make this application as his/her authorized agent. I agree to conform to all applicable laws of this jurisdiction. In addition, if a permit for work described in this application is issued, I certify that the Code Official's authorized representative shall have the authority to enter all areas covered by this permit at any reasonable hour to enforce the provisions of the codes applicable to this permit.

Signature of applicant: <u>Carlton Winslow</u>	Date: <u>10/11/2005</u>
--	-------------------------

This is not a permit, you may not commence ANY work until the permit is issued. This is for residential demolition. Commercial demolition will require other types of permittin along with this permit, please inquire with support staff

BUILDING PERMIT INSPECTION PROCEDURES

Please call 874-8703 or 874-8693 to schedule your inspections as agreed upon

Permits expire in 6 months, if the project is not started or ceases for 6 months.

The Owner or their designee is required to notify the inspections office for the following inspections and provide adequate notice. Notice must be called in 48-72 hours in advance in order to schedule an inspection:

By initializing at each inspection time, you are agreeing that you understand the inspection procedure and additional fees from a "Stop Work Order" and "Stop Work Order Release" will be incurred if the procedure is not followed as stated below.

A Pre-construction Meeting will take place upon receipt of your building permit.

- N/A Footing/Building Location Inspection: Prior to pouring concrete
- N/A Re-Bar Schedule Inspection: Prior to pouring concrete
- N/A Foundation Inspection: Prior to placing ANY backfill
- N/A Framing/Rough Plumbing/Electrical: Prior to any insulating or drywalling
- ~~Final/Certificate of Occupancy:~~ Prior to any occupancy of the structure or use. NOTE: There is a ~~\$75.00 fee per~~ inspection at this point.

Certificate of Occupancy is not required for certain projects. Your inspector can advise you if your project requires a Certificate of Occupancy. All projects DO require a final inspection

N/A If any of the inspections do not occur, the project cannot go on to the next phase, REGARDLESS OF THE NOTICE OR CIRCUMSTANCES.

N/A CERTIFICATE OF OCCUPANCIES MUST BE ISSUED AND PAID FOR, BEFORE THE SPACE MAY BE OCCUPIED

[Signature] Signature of Applicant/Designee 10/20/05 Date
[Signature] Signature of Inspections Official 10/20/05 Date

CBL: 121-F-14 Building Permit #: 05/1463

City of Portland Inspection Services Division Demolition Call List and Requirements

Site Address: 368 Brighton Ave.

Owner: Carleton Winslow

Structure Type: Single Family Dwelling

Contractor: Self

<u>UTILITY APPROVALS</u>	<u>NUMBER</u>	<u>CONTACT NAME/DATE CONTACTED</u>
Central Maine Power	1-800-750-4000	<u>Anita - Dept of Acit. 10/7/05</u>
Verizon	1-800-941-9900	<u>Green Hillwood - Engineering 10/7/05</u>
Northern Utilities	797-8002 ext 6241	<u>Ric Bellemere 10/7/05</u>
Portland Water District	761-8310	<u>Douglas Barnes 10/7/05</u>
Time Warner Cable Co.	253-2222	<u>Barbara Seale 10/7/05</u>
Dig Safe ***	1-888-344-7233	<u>DigSafe No is 10/7/05</u>

***(After Call, There is a wait of 72 Business Hours before digging can begin) → 2005 4111093

<u>CITY APPROVALS</u>	<u>NUMBER</u>	<u>CONTACT NAME/DATE CONTACTED</u>
DPW/ Traffic Division	874-8891	<u>(L. Cote) ✓ 10/7/05</u>
DPW/ Forestry Division	874-8389	<u>(J. Tarling) ✓</u>
DPW/ Sealed Drain Permit	874-8822	<u>(C. Merritt) ✓ 10/7/05</u>
Building Inspections (Insp. Req'd.)	874-8703	<u>Jana Marshall 10/12/05</u>
Historic Preservation	874-8726	<u>NOT HISTORIC in DISTRICT</u>
Fire Dispatcher	874-8576	
DEP - Environmental (Augusta)	287-2651	<u>NOT REQUIRED</u>

U.S. EPA Region 1 - No Phone call required. Just mail copy of State notification to:

Demo / Reno Clerk
US EPA Region I (SEA)
JFK Federal Building
Boston, MA 02203

ADDITIONAL REQUIREMENTS:

- 1) Written Notice to Adjoining Owners: Only when written notice has been given by the Applicant to the owners of adjoining lots will a demolition permit be issued. Provide a list of those notified and a copy of the notification sent with your completed application.
- ✓ 2) A Photo of the Structure(s) to be demolished must be submitted with your application.
- NOT REQUIRED 3) Certification From an Asbestos Abatement Company that the building is asbestos-free may be required as per state law notification form attached.

I have contacted all of the necessary companies / departments as indicated above and attached all required documentation.

Signed: Carleton Winslow

Date: 10/11/2005



DELETE 505-533

V VACANT DWELLING OTHER

STORY HEIGHT
1.0 1.5 2.0 2.5 3.0

EXTERIOR WALLS
1 FRAME 4 BLOCK 7 STONE
2 BRICK 5 STUCCO 8 ASBESTOS
3 MAS. & FRAME 6 ALUM./VINYL 9 CONCRETE

STYLE
1 RAISED RANCH 7 CONDO 13 MANSION
2 SPLIT LEVEL 8 CONTEMP. 14 GAMBREL
3 RANCH 9 TOWNHSE/ROW 15 GARRISON
4 CAPE 10 COTTAGE 16 OTHER
5 OLD STYLE 11 BUNGALOW
6 COLONIAL 12 DUPLEX

AGE
ERECTED 1932 EST. 1 REMODELED 19 ___

LIVING ACCOMMODATIONS
TOTAL ROOMS 07 BED ROOMS 03 FAMILY ROOMS 01
FULL BATHS 1 HALF BATHS 1 ADDN'T FIXT. 0 TOTAL FIXT. 07 ✓

NO KITCHEN YES
REMODELED 2 NO YES NO

BASMENT
1 NONE 2 CRAWL 3 PART 4 FULL

HEATING
1 NONE 2 BASIC 3 CENTRAL AIR COND

HEATING FUEL TYPE
1 NONE 2 GAS 3 ELEC 4 OIL 5 COAL 6 SOLAR

HEATING SYSTEM TYPE
1 NONE 2 WARM AIR 3 ELEC 4 HOT WATER 5 STEAM ✓

ATTIC
1 NONE 2 UNFIN 3 PT FIN 4 FULL FIN 5 FULL FIN/WH ✓

INTERIOR CONDITION
1 BETTER 2 SAME 3 POORER

PHYSICAL CONDITION
1 EX 2 GD 3 AV 4 FR 5 PR 6 VP 7 UN

SFLA

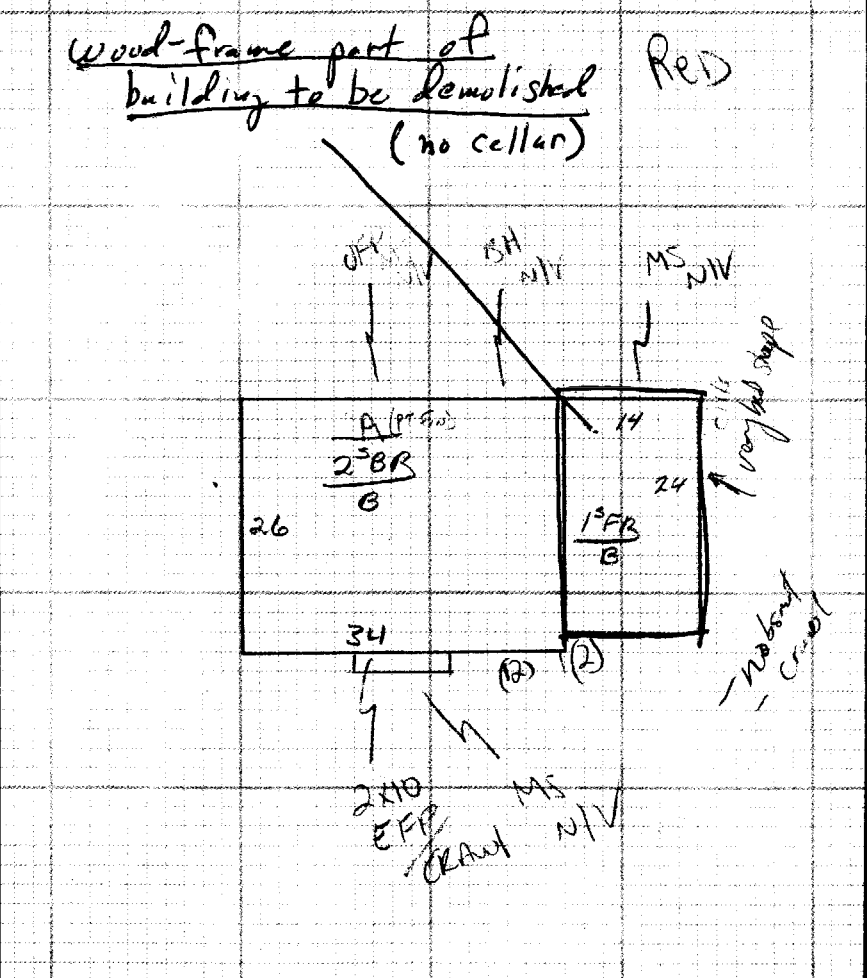

NOTES

471	
472	
473	
474	

BUILDING PERMIT RECORD

NUMBER	DATE	AMOUNT	DESCRIPTION
461			
462			
463			
464			
465			

599 DELETE 601-608 ADDITIONS

ADD	CD	LWR	1ST	2ND	3RD	AREA
601	A1	<u>50</u>	<u>10</u>			
602	A2		<u>12</u>			
603	A3					
604	A4					
605	A5					
606	A6					
607	A7					
608	A8					

CONDO LEVEL ___ 518 CONDO 1. INTERIOR TYPE 2. CORNER

OTHER FEATURES
1 BRICK TRIM ___
2 STONE TRIM ___
3 RECROOM ___
4 FIN. BSMT LIVING AREA ___
5 WBFP: STACKS ___ OPENINGS ___
6 METALFP: STACKS ___ OPENINGS ___
7 WOOD COAL BURNING ___
8 BSMT GARAGE NO OF CARS ___
9 UNFINISHED AREA (-) ___ %
10 UNHEATED AREA (-) ___ %

GROUND FLOOR AREA 1 ___

GRADE FACTOR AA A B C D E [] ✓

COST & DESIGN FACTOR [] ___ %

CDU EX VG GO AV FR PR VP UN Wall

MARKET ADJUSTMENT ___ %

RESIDENTIAL POOLS ADDITION CODES DWELLING COMPUTATIONS

RC1 Carport RC2 Canopy RG1 Frame/CB Detached Garage RG2 Brick/Stone Detached Garage RS1 Frame Shed RS2 Metal Shed

RP1 Plastic Liner RP2 Prefabricated Vinyl RP3 Reinforced Concrete RP4 Fiberglass RP5 Gunite

10 1s Frame 11 OFF 12 EFP 13 Frame Garage 14 Frame Utility 15 Frame Bay 16 Frame OH 17 1/2s Frame 18 Unfin. Attic 19 Fin. Attic 20 1s Mas 21 OMP 22 EMP 23 Mas. Garage 24 Mas. Utility 25 Mas. Bay 30 Carport 31 Wood Deck 32 Canopy 33 Conc. Patio 34 Stone Patio 35 Mas. Stoop 36 An. Greenhouse 50 Unfin. Bsmt 99 Min. Value

799 DELETE 801410 OTHER BUILDINGS & YARD IMPROVEMENTS

TYPE	CODE	QTY	YR	SIZE	G	COND	RATE	BASE VALUE	MA	MOD CODES	TRUE VALUE
801											
802											
803											
804											
810	MISCELLANEOUS IMPROVEMENTS										
800	1 SEE DETAILED CARD 2 SEE DETAILED REPORT										

BASEMENT HEATING PLUMBING ATTIC ADDITIONS OTHER FEATURES SUB TOTAL x GRADE FACTOR x C & O FACTOR = BASE VALUE x MARKET AOJ = TRUE VALUE

TOTAL GROSS VALUE

HAND DELIVERED 10/8/05

51-A Burdick St.
Portland, Me. 04102

October 8, 2005

Christopher + Emily Makrides
378 Brighton Ave. (121-F-9)
Portland, Maine 04102

Dear Neighbor:

As you may know, I own the brick house at 368 Brighton Avenue, which has been vacant for several years. As part of on-going renovations I need to remove the badly-deteriorated wooden addition on the right side of the building. The City of Portland requires that I notify you as an abutter as part of its demolition permit process. The demolition will be done mostly by hand and all debris promptly removed. If you have any questions please call me (preferably evenings) at 773-8281. I plan to start and complete most of the work during October. I'm quite sure you will be pleased with the resulting improvement in the building's appearance.

Sincerely,

Carleton Winslow
Carleton Winslow, Owner

HAND DELIVERED 10/8/05

51-A Barreham St.
Portland, Me. 04102
October 8, 2005

Theodore + Diane Kirchner
192 Caleb Street (121-F-12-16)
Portland, Me. 04102

Dear Neighbor:

As you may know, I own the brick house at 368 Brighton Avenue, which has been vacant for several years. As part of on-going renovations, I need to remove the badly-deteriorated wooden addition on the right side of the building. The City of Portland requires that I notify you as an abutter as part of its demolition permit process. The demolition will be done mostly by hand and all debris promptly removed. If you have any questions, please call me (preferably evenings) at 773-8281. I plan to start and complete most of the work during October. I'm quite sure you will be pleased with the resulting improvement in the building's appearance.

Sincerely,

Carleton Winslow
Carleton Winslow, Owner



CITY OF PORTLAND, MAINE

Department of Building Inspections

_____ 20 _____

Received from _____

Location of Work _____

Cost of Construction \$ _____

Permit Fee \$ _____

Building (IL) ____ Plumbing (I5) ____ Electrical (I2) ____ Site Plan (U2) ____

Other _____

CBL: _____

Check #: _____

Total Collected \$ _____

THIS IS NOT A PERMIT

No work is to be started until PERMIT CARD is actually posted upon the premises. Acceptance of fee is no guarantee that permit will be granted. PRESERVE THIS RECEIPT. In case permit cannot be granted the amount of the fee will be refunded upon return of the receipt less \$10.00 or 10% whichever is greater.

WHITE - Applicant's Copy

YELLOW - Office Copy

PINK - Permit Copy