

- NOTES:**
- SEE SHEET E-001 FOR LEGEND AND GENERAL NOTES.
 - WHERE SWITCHES AND MOTION SENSORS ARE SHOWN IN A ROOM, THE SWITCHES ENABLE THE MOTION SENSORS.
 - FOR LOCATION OF PANELBOARD LSB3-4, SEE EL102.

KEYED NOTE:

- EXISTING LIGHT FIXTURES REMOVED: SWITCH S_c CONTROLS THE LIGHT FIXTURES.
- NEW LIGHT FIXTURES: SWITCH S_n CONTROLS THE LIGHT FIXTURES.
- EXISTING MOTION SENSORS REMOVED: SWITCH S_m CONTROLS THE MOTION SENSORS.
- NEW MOTION SENSORS: SWITCH S_n CONTROLS THE MOTION SENSORS.
- EXISTING MOTION SENSORS REMOVED: SWITCH S_m CONTROLS THE MOTION SENSORS.
- NEW MOTION SENSORS: SWITCH S_n CONTROLS THE MOTION SENSORS.

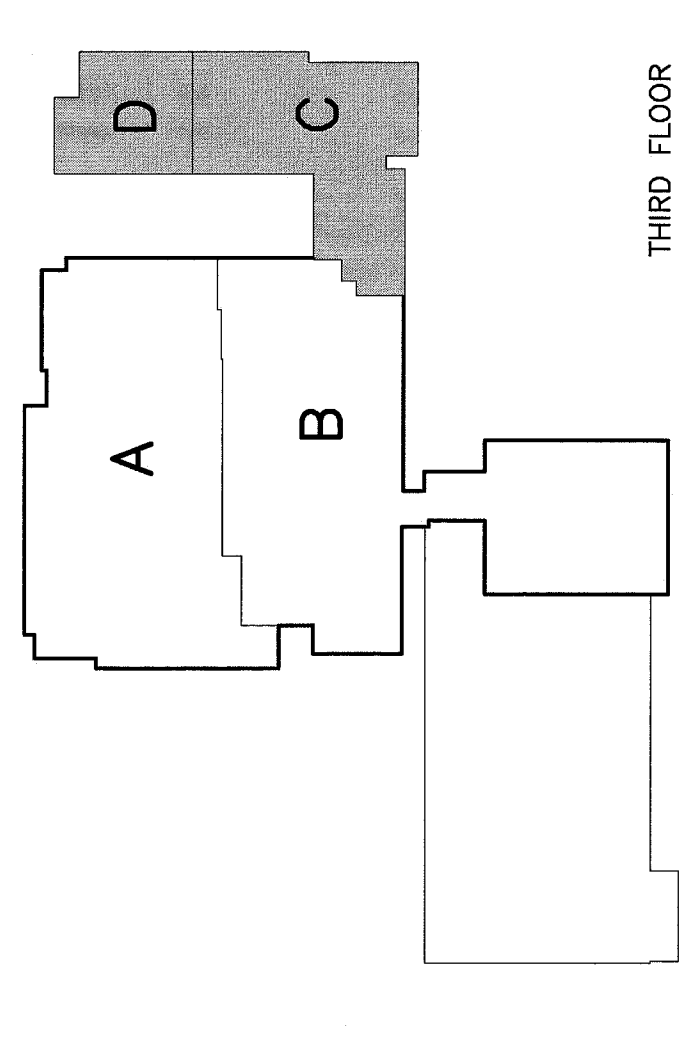
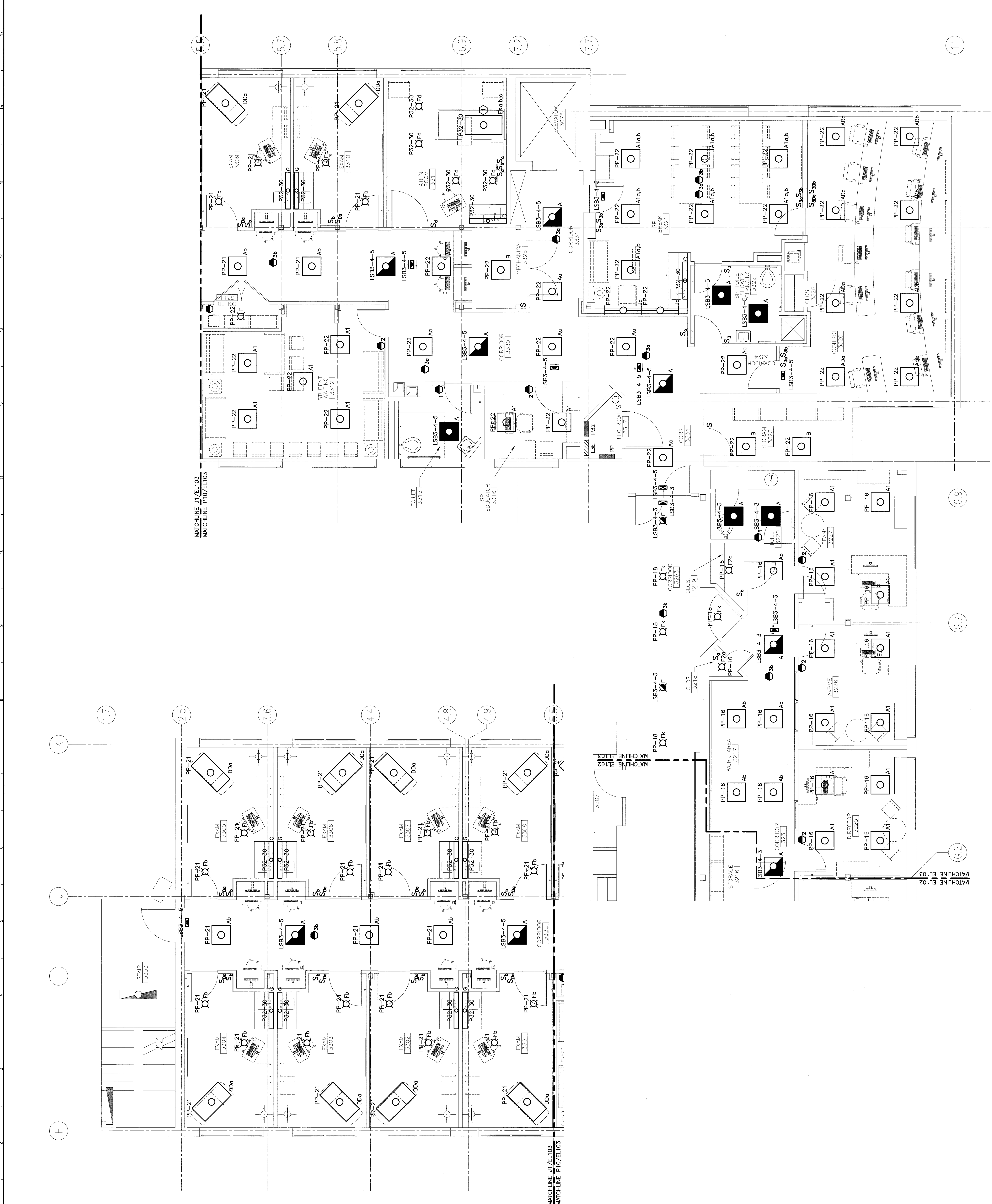

F18 KEY PLAN

| REV. | ISSUED FOR CONSTRUCTION | DESCRIPTION | DATE |
|------|-------------------------|-------------|---------|
| 0 | ISSUED FOR CONSTRUCTION | | 4-24-09 |

ISSUED FOR CONSTRUCTION
4-24-09

CURRENT ISSUE STATUS

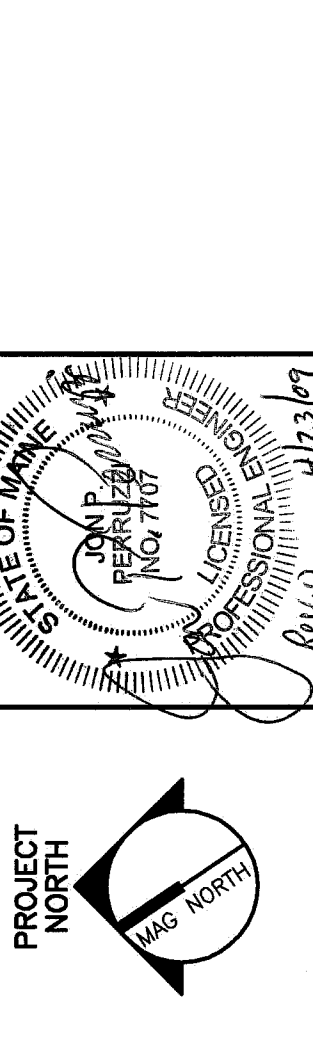

SMART
ARCHITECTURE
ENGINEERING
PLANNING
INTERIOR DESIGN
COMMISSIONING

144 Fore Street, 13th Fl.
Portland, Maine 04104
Tel: (207) 772-5866
Tel: (207) 772-6070
www.smartinc.com

MAINE MEDICAL CENTER
OFFICE OF MEDICAL EDUCATION
PORTLAND, MAINE

THIRD FLOOR AREA C & D
LIGHTING PLAN

| | | | |
|------------------|-------------|----------------|---------|
| SCALE: | 1/4"=1'-0" | DATE: | 4-24-09 |
| PROJECT MANAGER: | CHUCK | GRAPHIC SCALE: | 0' |
| DESIGNER/DRAWN: | PP | | |
| DATE OF RECORD: | EL102-08093 | | |
| SMART CAD FILE: | EL102-08093 | | |
| PROJECT NO.: | 08093-00 | SHEET NO.: | EL103 |

A1 THIRD FLOOR PLAN

1/4"=1'-0"