

NOTES:

- SEE SHEET E-001 FOR LEGEND AND GENERAL NOTES.
- RECEPTACLES IN ICU/TRAUMA 3101, OR 3103 AND SIM INTERFACES SHALL BE PROVIDED IN THE ADJACENT CONTROL ROOM - SEE EPT101 FOR TYPICAL CONTROL SCHEMATIC.
- FOR LOCATIONS OF PANELBOARDS L23NC & L23NCA, SEE EPT02.
- IN BOTH THE OR 3103 AND ICU/TRAUMA 3101, PROVIDE A 6" CABLE TRAY ON THE 2ND FLOOR BETWEEN THE SIM INTERFACE RACK AND BOTH THE SIM PATIENT LABEL AND PARTITION CABLE TRAY TO SEPARATE THE GASES FROM THE CONTROL WIRING.

KEYED NOTES:

- INSTALL 8" ABOVE COUNTER TO CENTER.
- INSTALL 24" AFF TO CENTER.
- INSTALL 36" AFF TO CENTER.
- INSTALL 48" AFF TO CENTER.
- INSTALL 60" AFF TO CENTER.
- INSTALL 72" AFF TO CENTER.
- INSTALL 84" AFF TO CENTER.
- PROVIDE CONNECTION TO PROJECTION SCREEN.
- PROVIDE CONNECTION TO EQUIPMENT BOOM.
- PROVIDE CONNECTION TO PATIENT LIFT.
- PROVIDE 5" STEEL MULTIOUTLET ASSEMBLY WITH SINGLE 20A, 120V RECEPTACLES SPACED 12" ON CENTER. REMOVAL MARK # Y248512 OR APPROVED EQUAL.
- RE-USE CIRCUIT FROM EXISTING PANEL. SEE EPT01 FOR EXISTING PANEL LOCATION.

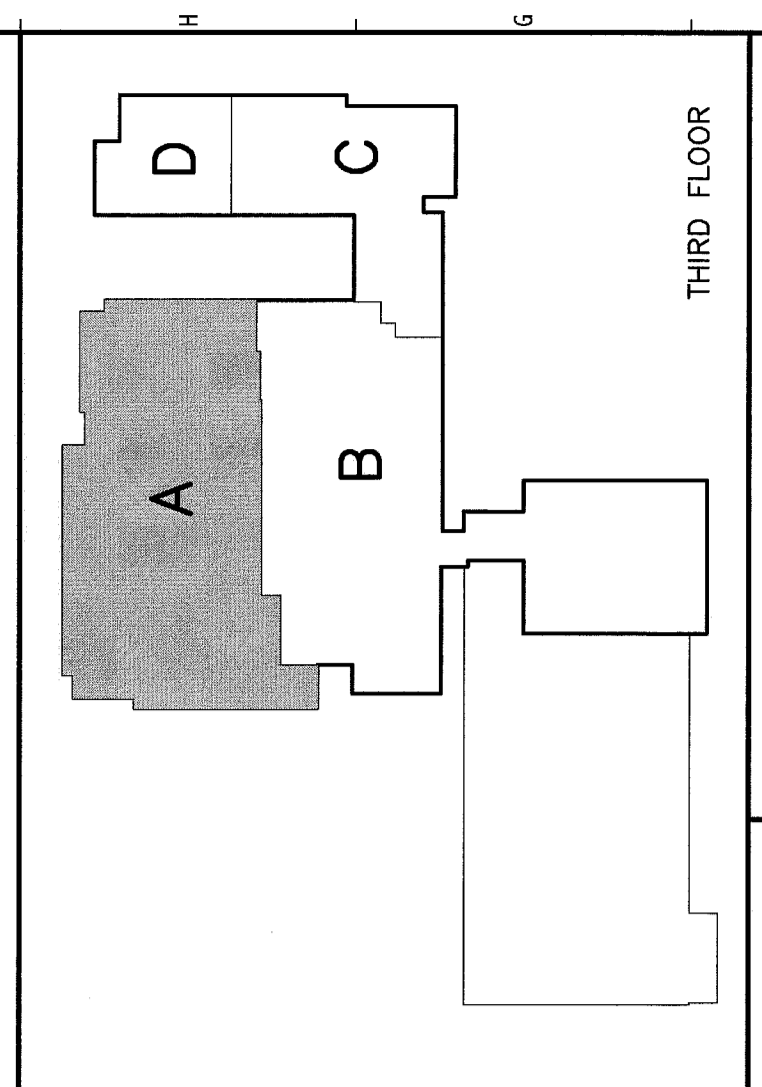

REV.	DESCRIPTION	DATE
0	ISSUED FOR CONSTRUCTION	4-24-09

ISSUED FOR CONSTRUCTION
4-24-09

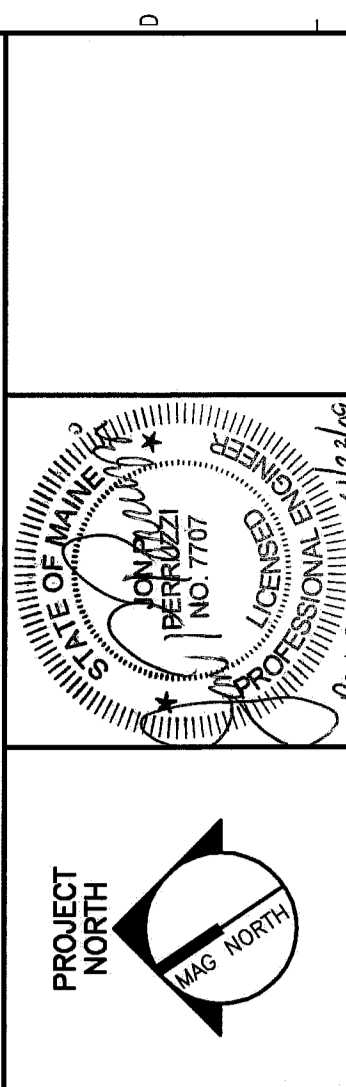

SMRT
ARCHITECTURE
ENGINEERING
PLANNING
INTERIOR DESIGN
COMMISSIONING

144 Fore Street, P.O. Box 618
Portland, Maine 04104
Tel: (207) 772-8466
Fax: (207) 772-1079
www.smrtinc.com

MAINE MEDICAL CENTER
OFFICE OF MEDICAL EDUCATION
PORTLAND, MAINE

THIRD FLOOR AREA A
POWER PLAN

SCALE: 1/4"=1'-0" DATE: 4-24-09
PROJECT MANAGER: COP GRAPHIC SCALE: 0"=1'-0"
JOB CAP/DRAWN: CHUCOS
A/E OF RECORD: JPP SHEET No.: EP101
PROJECT No.: 08093-200

A1	THIRD FLOOR PLAN
-----------	-------------------------

1/4"=1'-0"