

NOTES:

- SEE SHEET F100 FOR LEGEND AND ABBREVIATIONS.
- REWORK EXISTING SPRINKLER PIPING TO MATCH NEW FLOOR FINISH. RECONNECT FIRE PROTECTION PIPING TO EXISTING FIRE DEPARTMENT VALVE/NOSE STATIONS.
- REFER TO DRAWING A-001 FOR DEFINITION OF ALTERNATES.

KEYED NOTES:

- RELOCATED FIRE DEPARTMENT VALVE, FLOOR CONTROL VALVE ASSEMBLY, 2" DRAIN RISER, 4" SPK RISER AND PIPING IN CEILING OF FLOOR BELOW AND CONNECT TO EXISTING.

NOTE 2

NOTE 2

NOTE 2

NOTE 2

NOTE 2

NOTE 2

NOTE 2

NOTE 2

NOTE 2

NOTE 2

NOTE 2

NOTE 2

NOTE 2

NOTE 2

NOTE 2

NOTE 2

NOTE 2

NOTE 2

NOTE 2

NOTE 2

NOTE 2

NOTE 2

NOTE 2

NOTE 2

NOTE 2

NOTE 2

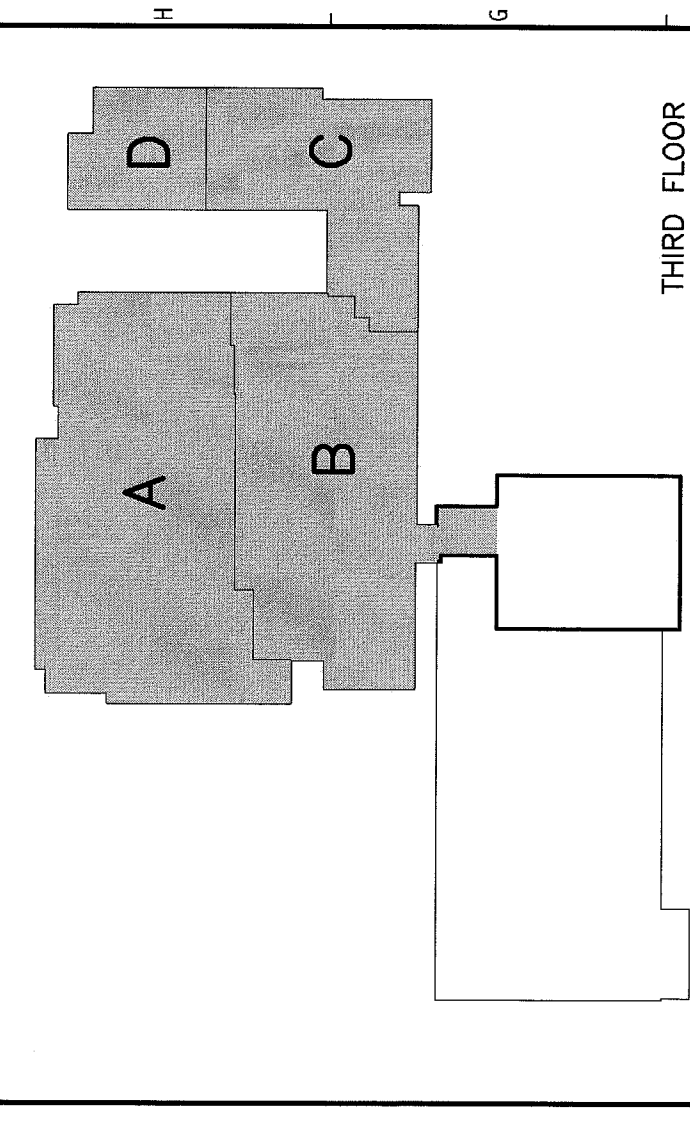

F18 KEY PLAN

REV.	ISSUED FOR CONSTRUCTION	DATE
0		4-24-09

ISSUED FOR CONSTRUCTION
4-24-09

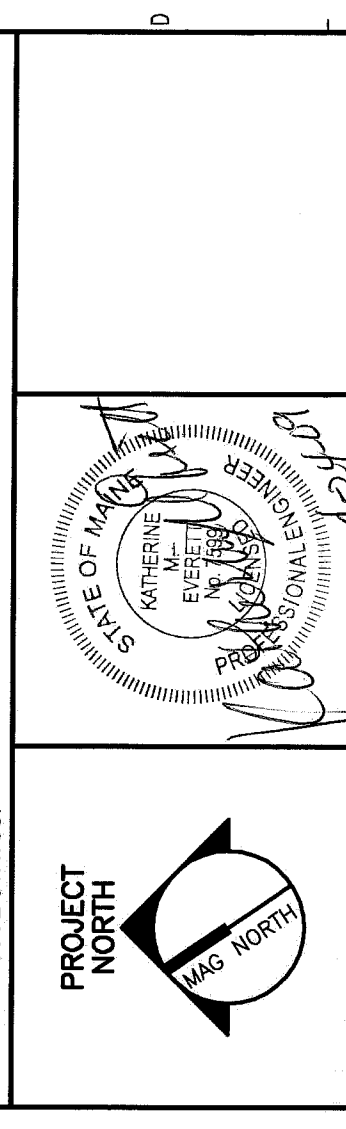

PROJECT NORTH
STATE OF MAINE
SMRTI
ARCHITECTURE
ENGINEERING
PLANNING
INTERIOR DESIGN
COMMISSIONING
MAINE MEDICAL CENTER
OFFICE OF MEDICAL EDUCATION
PORTLAND, MAINE

THIRD FLOOR
FIRE PROTECTION PLAN

SCALE: 1/8" = 1'-0"
DATE: 4-24-09
GRAPHIC SCALE: 0'

PROJECT MANAGER: BALDWIN
JOB CAPTAIN: KNE
SHEET NO.: FP101
SHEET FILE: FP101-08093
PROJECT NO.: 08093-00

A1 THIRD FLOOR FACILITY PLAN

1/8" = 1'-0"