

DEMOLITION NOTES:

1. REMOVE ALL MATERIALS AND DEBRIS FROM THE WORK AREA AND PLACE IN THE DESIGNATED AREA.
2. ALL WALL, PARTIAL SURFACE, CEILING, FLOOR OR PARTIAL FLOOR SHALL BE PULVERIZED AND REMOVED TO THE EXISTING GRADE.
3. PROTECT ALL EXISTING MATERIALS AND EQUIPMENT NOT TO BE DEMOLISHED. CONTRACTOR SHALL BE RESPONSIBLE FOR DAMAGED ITEMS.
4. OPERATIONS INDICATED AS "I" ARE INSTANTANEOUS OPERATIONS TO BE COMPLETED.
5. DEMOLITION NOTES ARE BASED ON THE BUILDING CONSTRUCTION DOCUMENTS. GC TO VERIFY ARCHITECT AND ENGINEER'S INTENT AND FIELD CONDITIONS.
6. ALL DEMOLITION OPERATIONS SHALL BE COMPLETED WITHIN THE SPECIFIED TIME FRAME AND SHALL BE SUBJECT TO THE APPROVAL OF THE ARCHITECT AND ENGINEER.
7. REMOVE ALL EXISTING PARTITIONS, WALLS, CEILING, FLOOR, AND PARTIAL FLOOR.
8. WALLS INDICATED WITH "I" ARE TO BE REMOVED COMPLETE. INTERIOR WALLS BEARING LOADS TO BE REMOVED WITH PROPER BRACING.
9. SEE MECHANICAL, ELECTRICAL AND PLUMBING DRAWINGS FOR DEMOLITION OF THESE SYSTEMS.
10. REMOVE CEILING MATERIALS TO EXPOSE CEILING. REFER TO ELECTRICAL AND MECHANICAL DRAWINGS FOR ACCURATE LIGHT FIXTURE AND VENTILATION LOCATIONS.
11. REMOVE FLOORING MATERIALS TO EXPOSE SUBFLOOR. REFER TO FLOORING DRAWINGS FOR ACCURATE LOCATION OF FLOORING MATERIALS.
12. COORDINATE LOCATION OF DEMOLITION OPERATIONS WITH MECHANICAL AND ELECTRICAL WORK.
13. VERIFY ARCHITECT WHEN DEMOLITION IS COMPLETE IN ORDER TO VERIFY EXISTING STRUCTURE.

DEMOLITION KEYED NOTES:

1. REMOVE VENT BOX AND ALL ASSOCIATED COMPONENTS COMPLETE. TURN OVER TO OWNER.
2. REMOVE DOOR FRAME AND USURANCE CONCRETE.
3. REMOVE DOOR AND PARTIAL FLOOR COMPLETE. REMOVE ANY FOOTINGS AND PARTIAL FLOORING. REPAIR AND FINISH FLOOR WITH POLISHED CONCRETE.
4. REMOVE DOOR FRAME AND USURANCE CONCRETE.
5. REMOVE DOOR AND PARTIAL FLOOR COMPLETE. REMOVE ANY FOOTINGS AND PARTIAL FLOORING. REPAIR AND FINISH FLOOR WITH POLISHED CONCRETE.
6. REMOVE DOOR FRAME AND USURANCE CONCRETE.
7. REMOVE DOOR AND PARTIAL FLOOR COMPLETE. REMOVE ANY FOOTINGS AND PARTIAL FLOORING. REPAIR AND FINISH FLOOR WITH POLISHED CONCRETE.
8. REMOVE DOOR FRAME AND USURANCE CONCRETE.
9. REMOVE DOOR AND PARTIAL FLOOR COMPLETE. REMOVE ANY FOOTINGS AND PARTIAL FLOORING. REPAIR AND FINISH FLOOR WITH POLISHED CONCRETE.
10. REMOVE DOOR FRAME AND USURANCE CONCRETE.
11. REMOVE DOOR AND PARTIAL FLOOR COMPLETE. REMOVE ANY FOOTINGS AND PARTIAL FLOORING. REPAIR AND FINISH FLOOR WITH POLISHED CONCRETE.
12. REMOVE DOOR FRAME AND USURANCE CONCRETE.
13. REMOVE DOOR AND PARTIAL FLOOR COMPLETE. REMOVE ANY FOOTINGS AND PARTIAL FLOORING. REPAIR AND FINISH FLOOR WITH POLISHED CONCRETE.
14. REMOVE DOOR FRAME AND USURANCE CONCRETE.
15. REMOVE DOOR AND PARTIAL FLOOR COMPLETE. REMOVE ANY FOOTINGS AND PARTIAL FLOORING. REPAIR AND FINISH FLOOR WITH POLISHED CONCRETE.
16. REMOVE DOOR FRAME AND USURANCE CONCRETE.
17. REMOVE DOOR AND PARTIAL FLOOR COMPLETE. REMOVE ANY FOOTINGS AND PARTIAL FLOORING. REPAIR AND FINISH FLOOR WITH POLISHED CONCRETE.
18. REMOVE DOOR FRAME AND USURANCE CONCRETE.
19. REMOVE DOOR AND PARTIAL FLOOR COMPLETE. REMOVE ANY FOOTINGS AND PARTIAL FLOORING. REPAIR AND FINISH FLOOR WITH POLISHED CONCRETE.
20. REMOVE DOOR FRAME AND USURANCE CONCRETE.
21. REMOVE DOOR AND PARTIAL FLOOR COMPLETE. REMOVE ANY FOOTINGS AND PARTIAL FLOORING. REPAIR AND FINISH FLOOR WITH POLISHED CONCRETE.
22. REMOVE DOOR FRAME AND USURANCE CONCRETE.

DEMOLITION LEGEND:

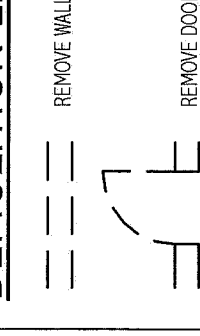

ISSUED FOR CONSTRUCTION
4-24-09

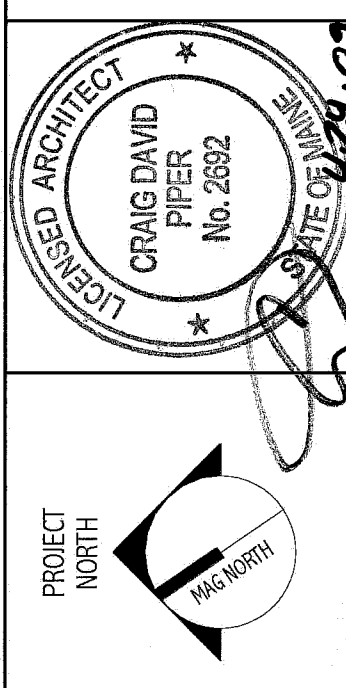

ARCHITECTURE
ENGINEERING
PLANNING
INTERIOR DESIGN
COMMISSIONS

SMRTI
Maine Medical Center - Office of Medical Education

Project Name
THIRD FLOOR DEMOLITION PLAN

SCALE	A = 1/8" = 1'-0"	DATE	4-24-09
PROJECT MANAGER	CP	DRAWING SCALE	1"
JOB APPROVER	CP	DATE	
DATE OF RECORD	CP	SHEET NO.	AD101
PROJECT NO.	08033		

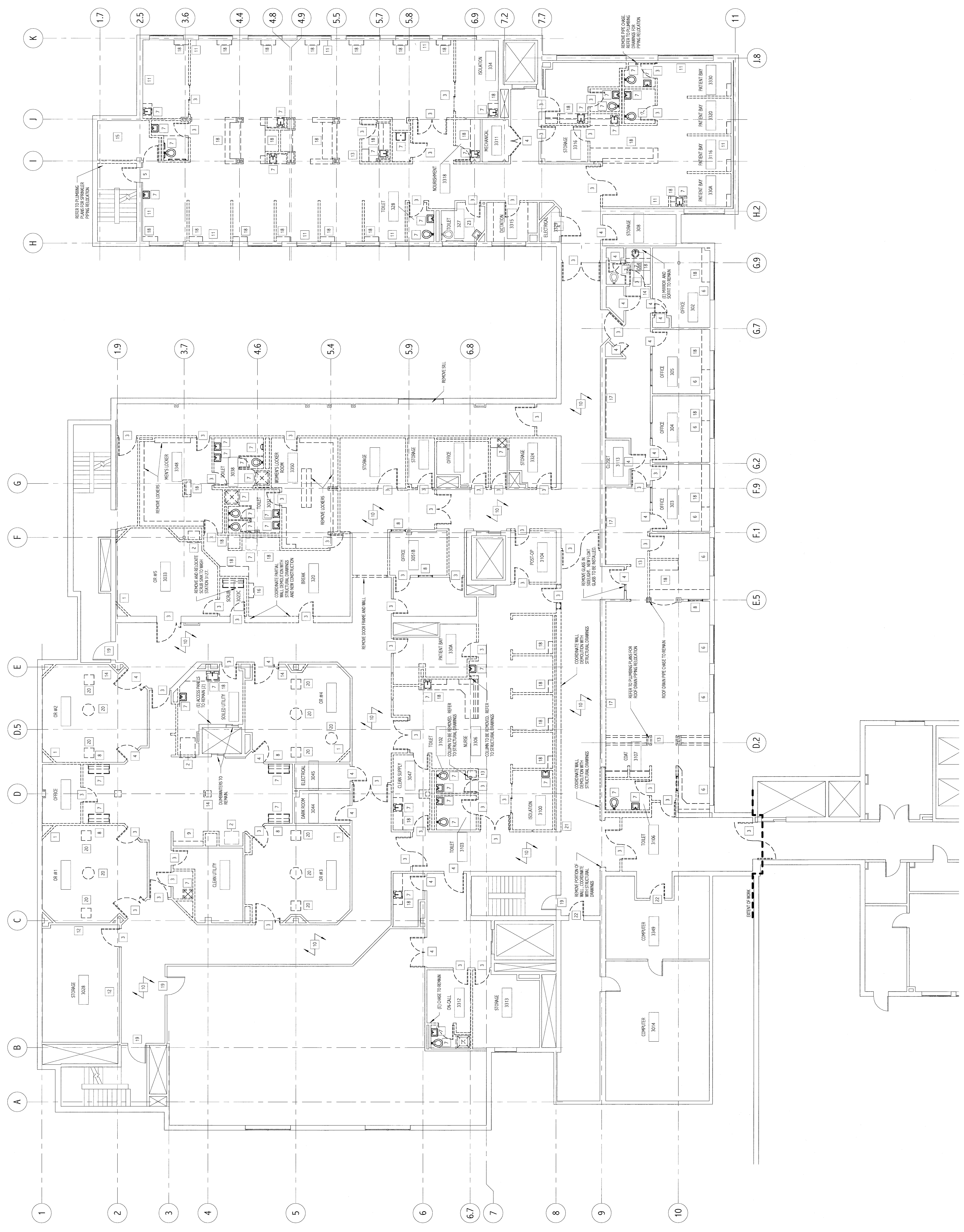

1. THIRD FLOOR DEMOLITION
1/8" = 1'-0"