

1 CARPET TO PORCELAIN TILE
SCALE: 6" = 1'-0"

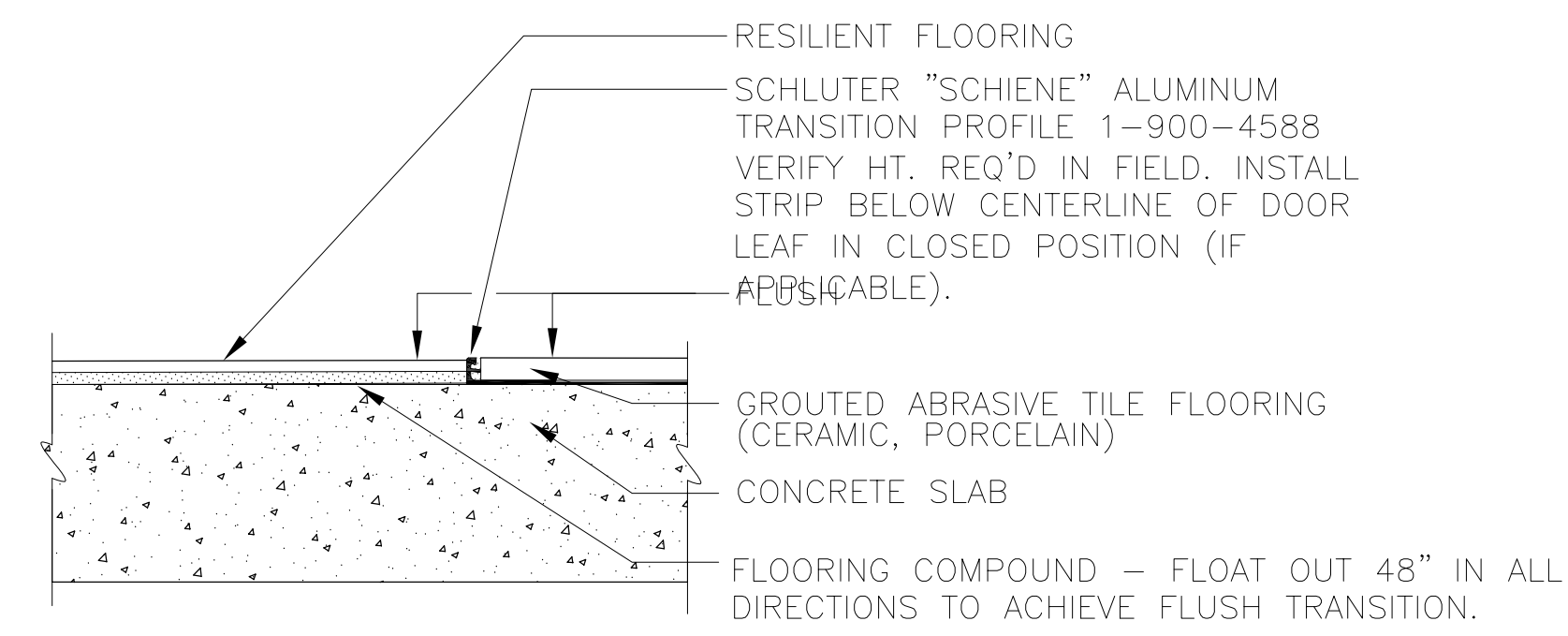

2 RESILIENT TILE TO PORCELAIN TILE
SCALE: 6" = 1'-0"

SEE INTERIOR DESIGN DRAWINGS FOR FURTHER REQUIREMENTS

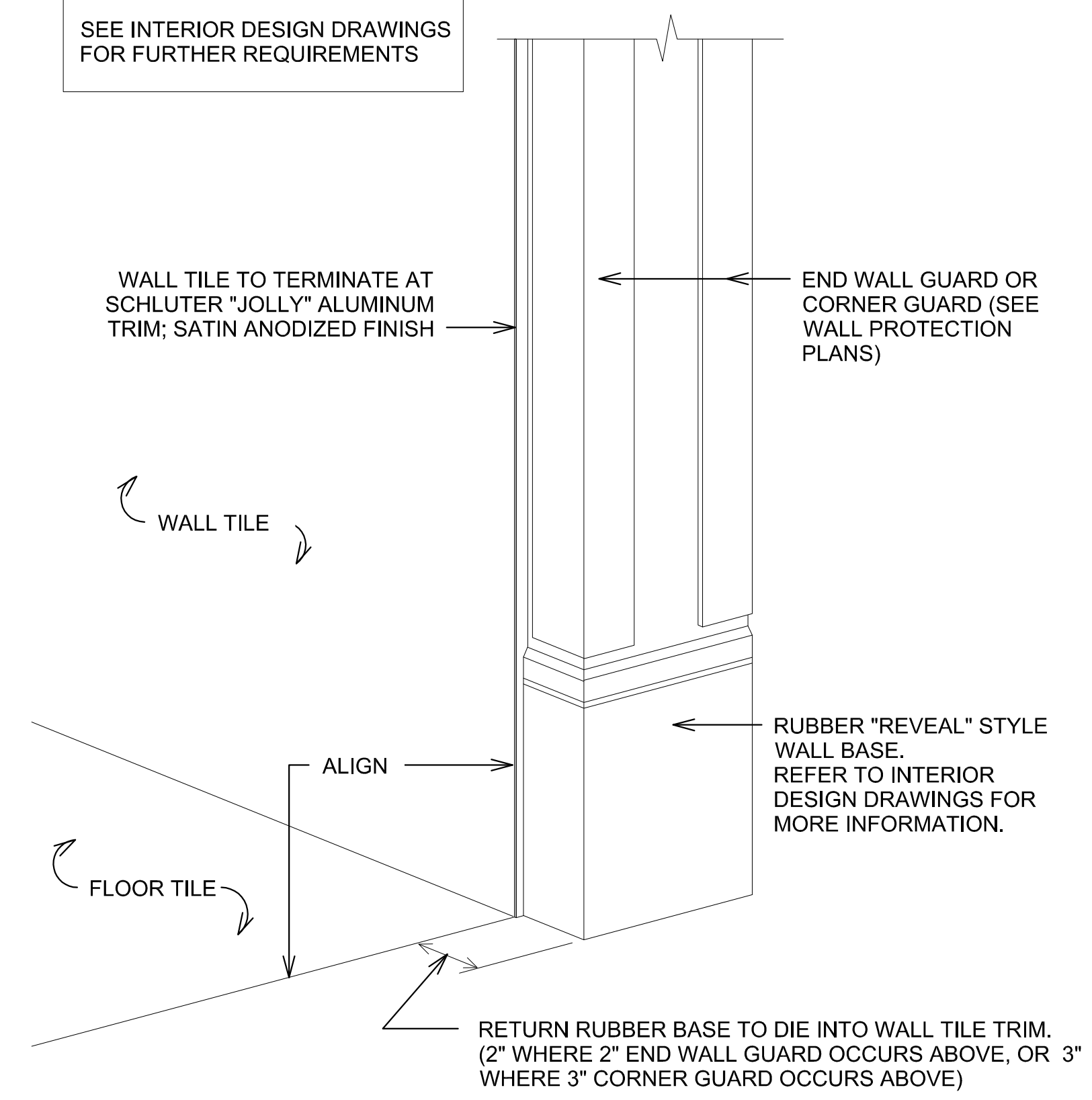

3 SERVERLY WALL ISO AT TILE TO RUBBER BASE TRANSITION AT END WALL
SCALE: NOT TO SCALE

SEE INTERIOR DESIGN DRAWINGS FOR FURTHER REQUIREMENTS

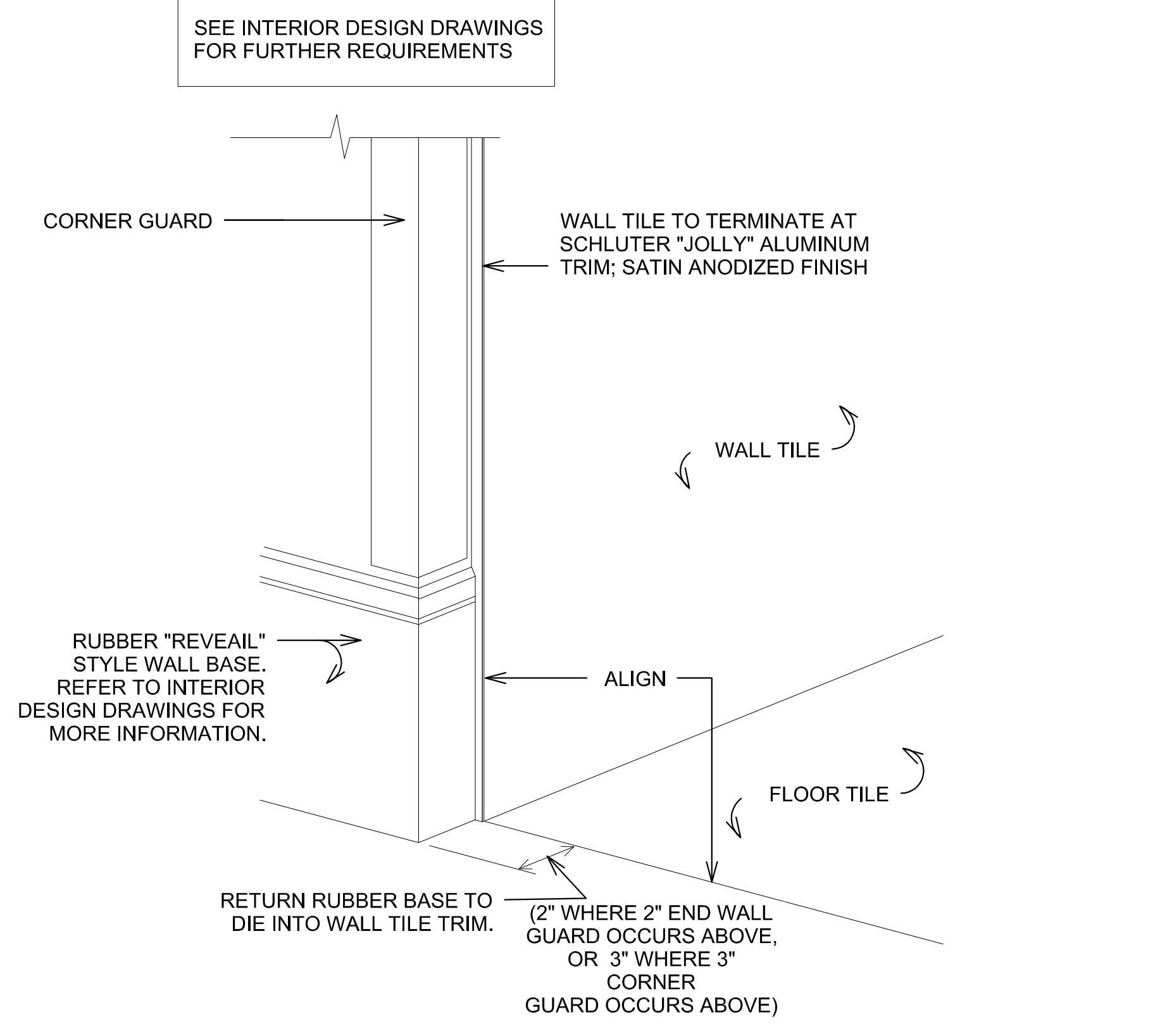

4 SERVERLY WALL ISO AT TILE TO RUBBER BASE TRANSITION AT CORNERS
SCALE: NOT TO SCALE

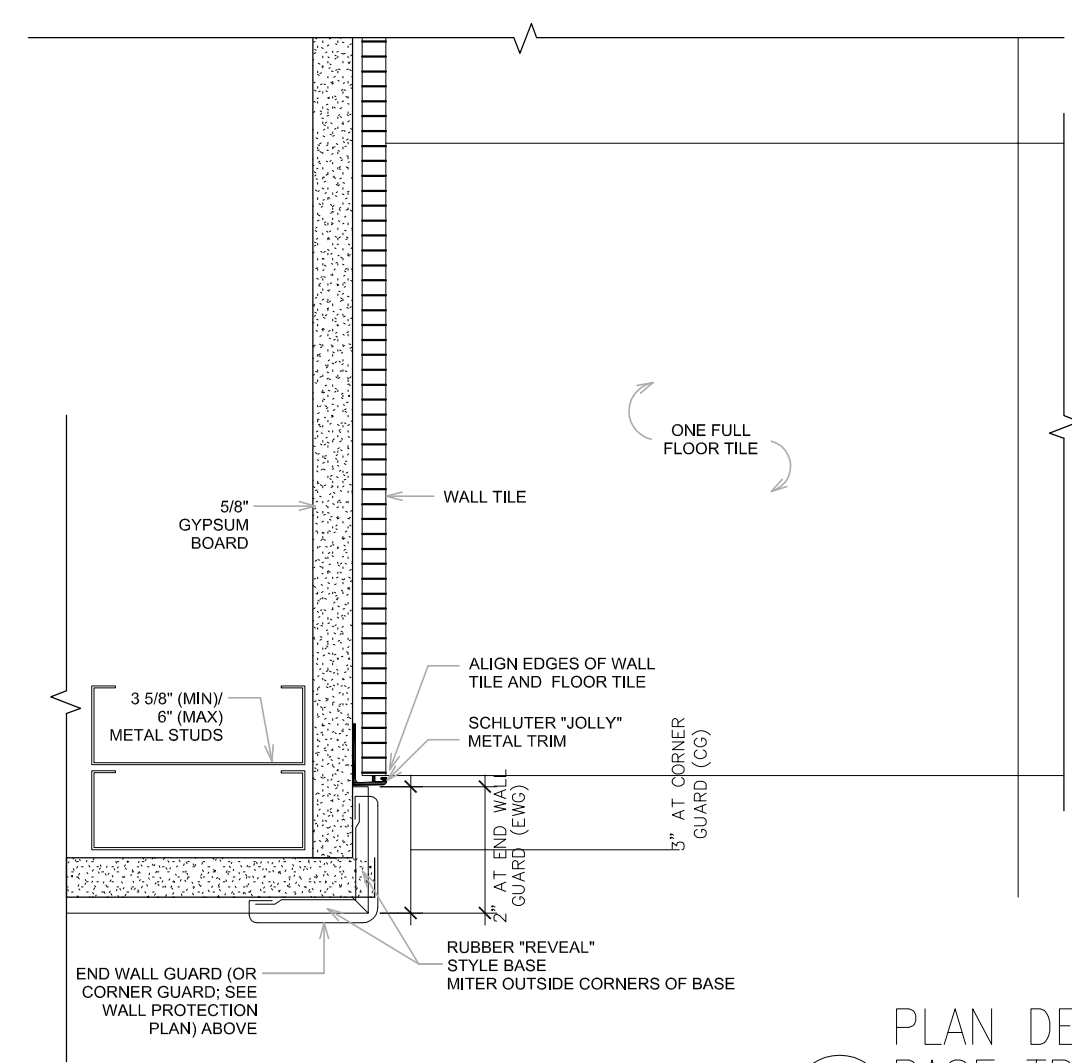

5 PLAN DETAIL AT TILE TO RUBBER BASE TRANSITION AT CORNERS
SCALE: NOT TO SCALE

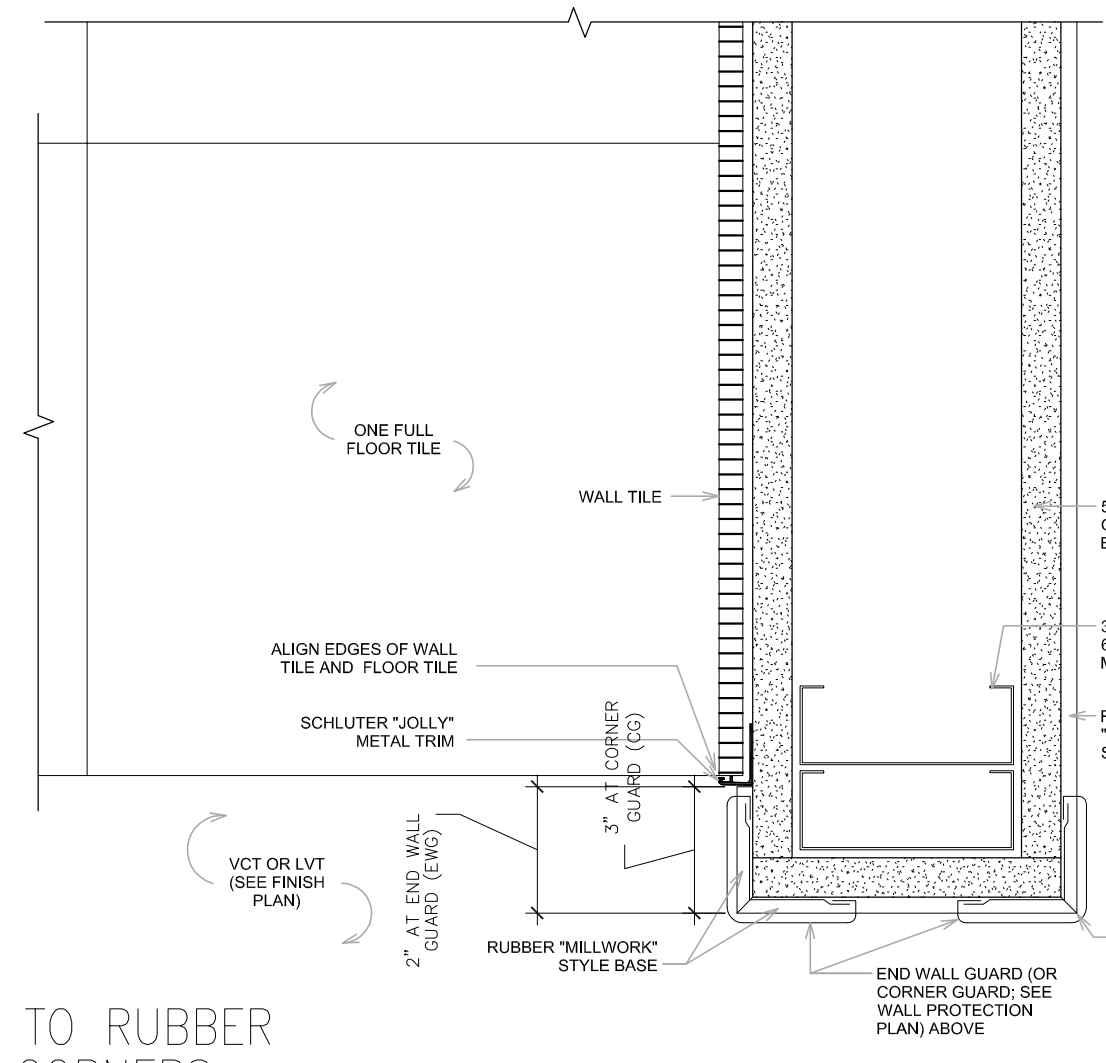

6 PLAN DETAIL AT TILE TO RUBBER BASE TRANSITION AT END WALL
SCALE: NOT TO SCALE

SCHLUTER "RONDEC" TRIM PROFILE. REFERENCE FINISH MATERIAL LEGEND FOR FINISH. SUBMIT COLOR OPTIONS WITH THE TILE SUBMITTAL SAMPLES. PAINTED POWDER COATED FINISH NOT ACCEPTABLE. COORD. TRIM PROFILE W/ SPECIFIED TILE THICKNESS. VERIFY IN FIELD PRIOR TO ORDERING. CONTACT DESIGNER WITH ANY DISCREPANCIES.

SCHLUTER "DECO-DE" TRIM PROFILE. REFERENCE FINISH MATERIAL LEGEND FOR FINISH. SUBMIT COLOR OPTIONS WITH THE TILE SUBMITTAL SAMPLES. PAINTED POWDER COATED FINISH NOT ACCEPTABLE. COORD. TRIM PROFILE W/ SPECIFIED TILE THICKNESS. VERIFY IN FIELD PRIOR TO ORDERING. CONTACT DESIGNER WITH ANY DISCREPANCIES.

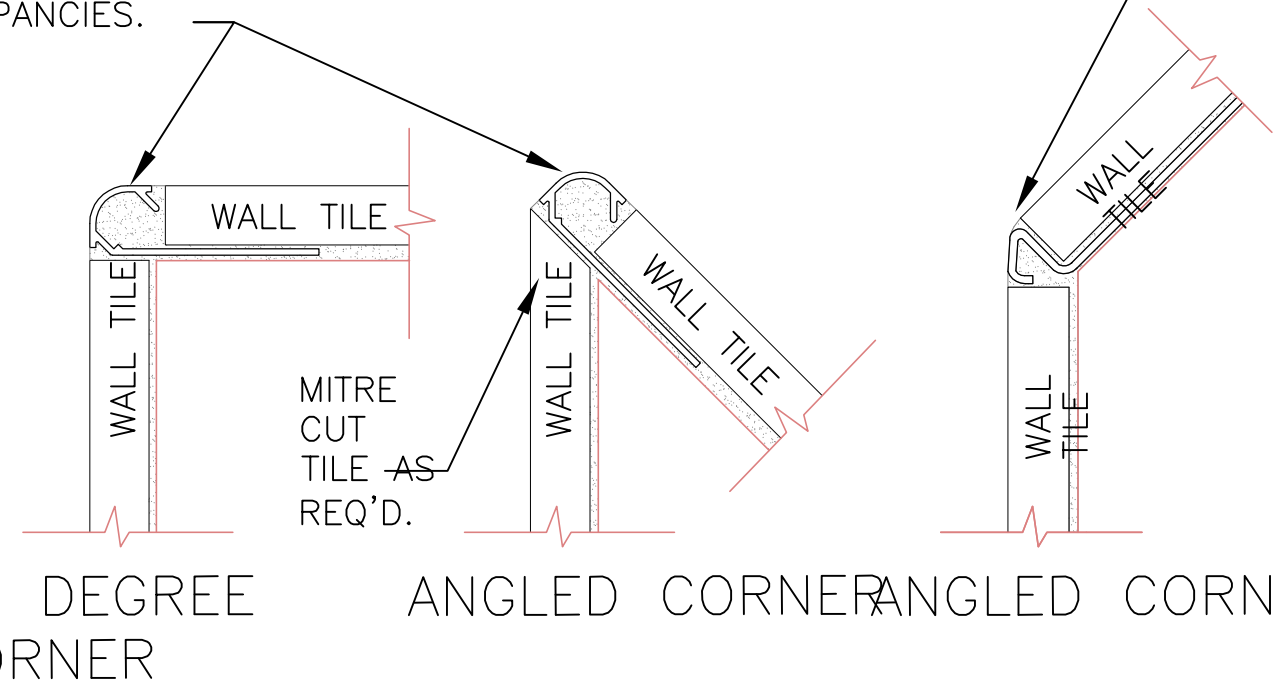

7 SCHLUTER RONDEC PORCELAIN TILE TRIM PIECE AT ANGLED OUTSIDE CORNERS
SCALE: 1'-0" = 1'-0"

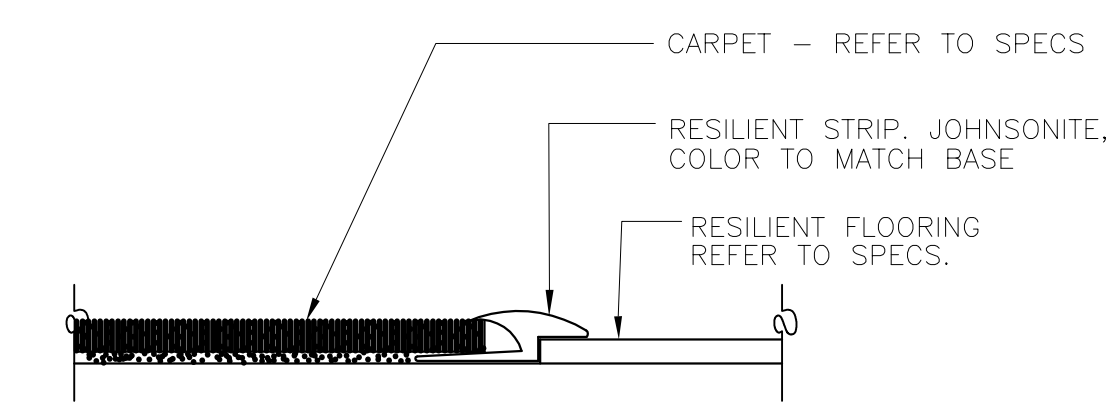

8 CARPET TO RESILIENT FLOORING
SCALE: 1'-0" = 1'-0"

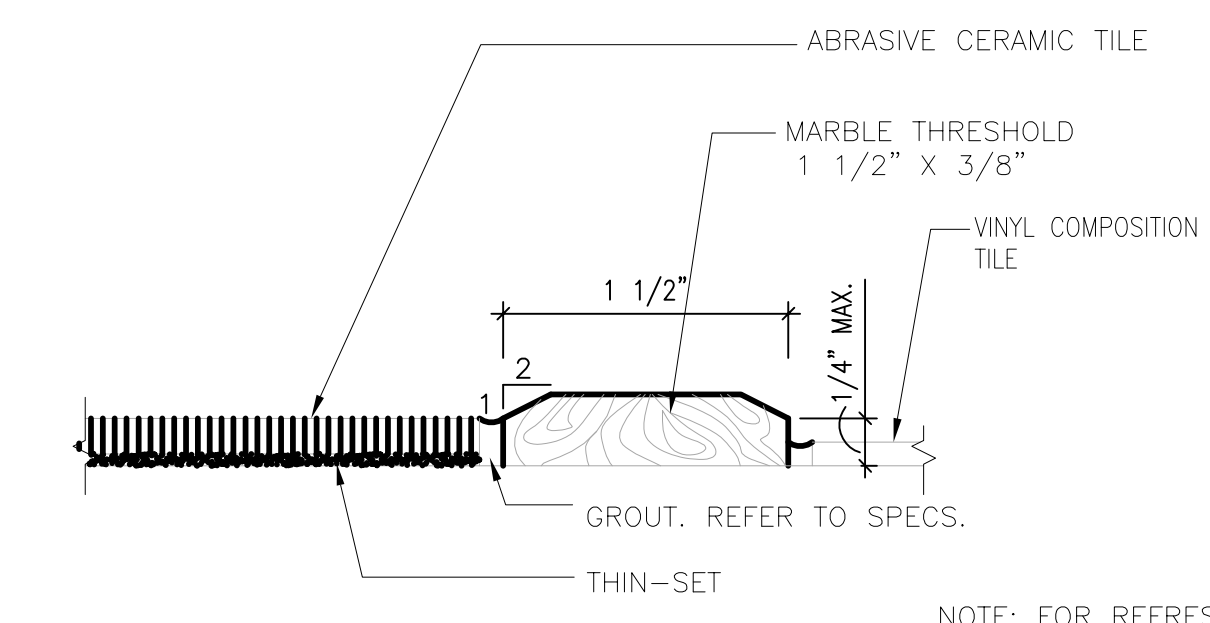

9 MARBLE THRESHOLD TO VCT
SCALE: 1'-0" = 1'-0"

NOTE: FOR REFRESH / RENO PROJECTS ONLY, AS NECESSARY, DUE TO SLOPE ISSUES

DESIGNER:
BOULOS COMMERCIAL DESIGN, PLLC
1 CANAL PLAZA SUITE 500
PORTLAND ME 04101
www.bouloscommercialdesign.com
207-749-1795

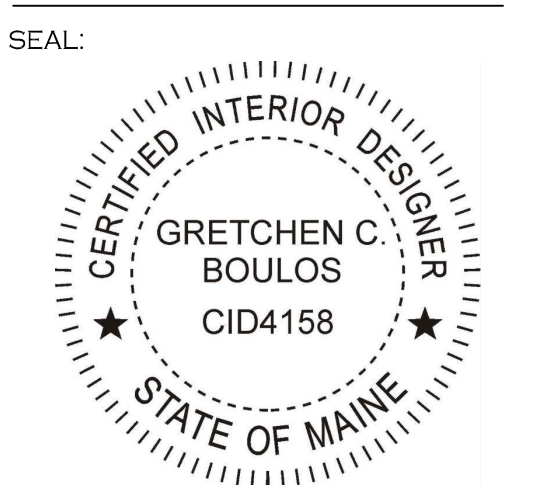

OWNER:
HEALTHSOUTH
NEW ENGLAND REHABILITATION HOSPITAL OF PORTLAND
335 Brighton Avenue,
Portland, ME 04102

LANDLORD:
Maine Medical Center
335 Brighton Avenue,
Portland, ME 04102

GENERAL CONTRACTOR
HEBERT CONSTRUCTION
9 Gould Road
Lewiston, ME 04240

REVISIONS:
DELTA: DATE:
1 07-06-2017

TITLE:
DETAILS

SCALE: 1/8" = 1'-0"
DATE: '01-19-2017

