

REFERENCE DOCUMENT - NOT FOR CONSTRUCTION

ATTENTION! SHADED AREAS INDICATED MUST BE KEPT FREE OF CEILING FIXTURES AND OTHER NON-SYSTEM ITEMS THAT MAY PROJECT DOWNWARD FROM THE CEILING (I.E. AIR VENTS, SPRINKLERS, CEILING LIGHTS, ETC.). PLEASE COORDINATE ANY POSSIBLE CONFLICTS WITH SIEMENS PROJECT MANAGER.

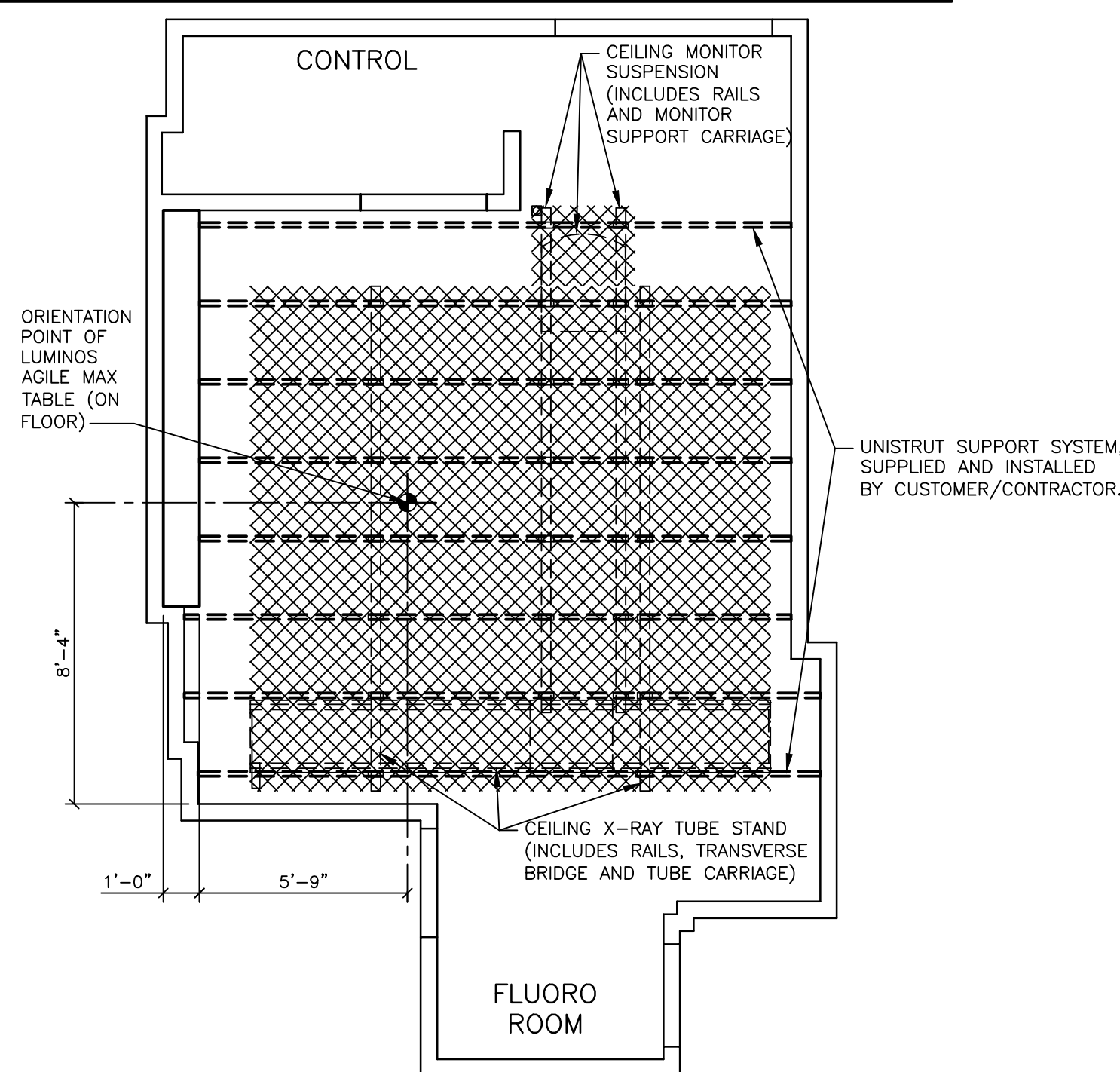

REFLECTED CEILING PLAN

SCALE: 1/4" = 1'-0"

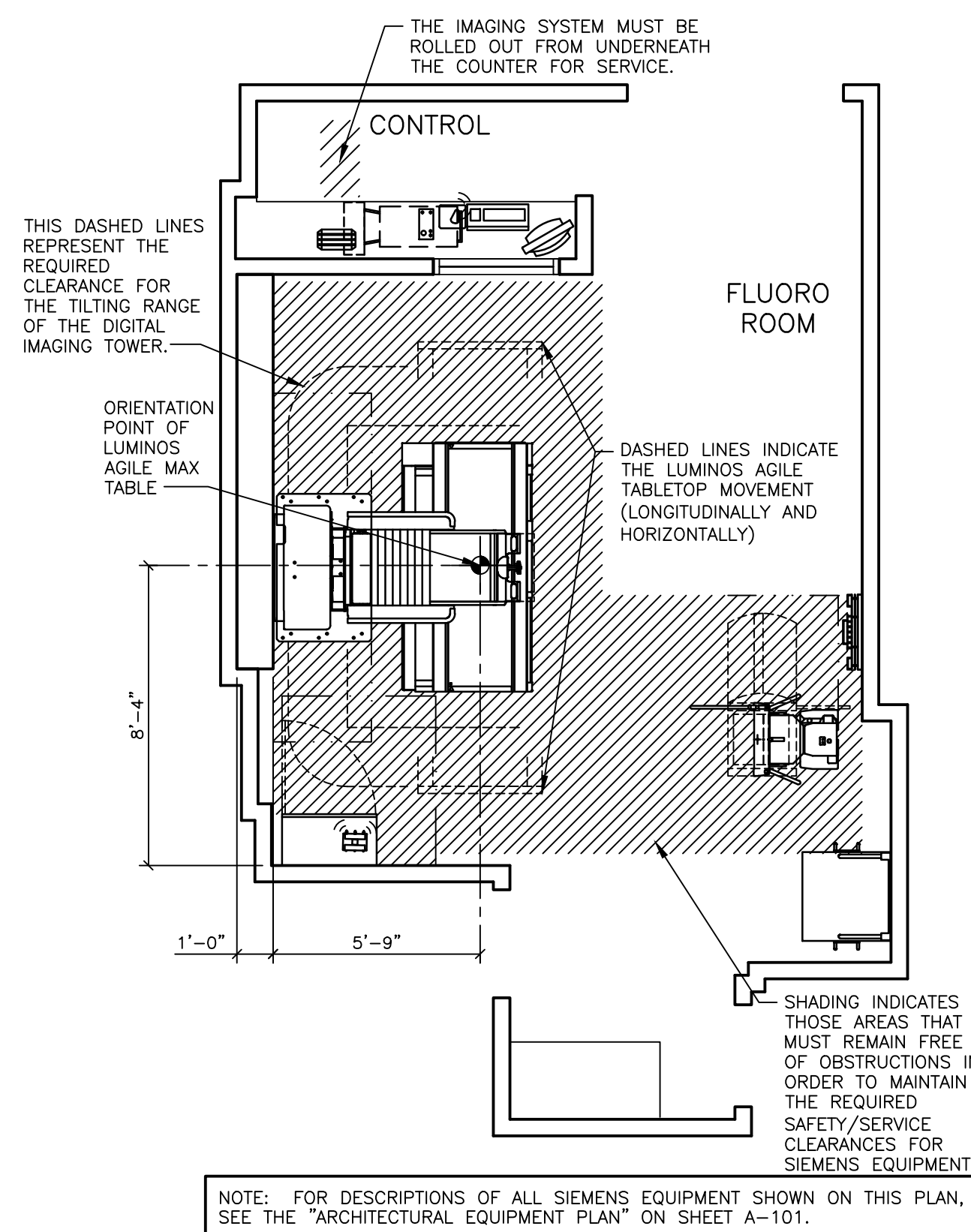

SAFETY/SERVICE CLEARANCE PLAN

SCALE: 1/4" = 1'-0"

CEILING NOTES

- 1) ALL CEILING MOUNTED LIGHT FIXTURES, MECHANICAL REGISTERS AND SPRINKLER HEADS SHALL BE FLUSH WITH FINISHED CEILING, SHALL BE OUTSIDE OF ALL HATCHED AREAS AND SHALL BE SPECIFIED BY THE ARCHITECT OF RECORD AND SUBSEQUENT CONSULTING ENGINEERS.
- 2) THE ACTUAL CEILING DESIGN AND COORDINATION OF LIGHTING AND MECHANICAL SYSTEMS SHALL BE THE RESPONSIBILITY OF THE ARCHITECT OF RECORD AND HIS SUBSEQUENT CONSULTING ENGINEERS.
- 3) THE CUSTOMER/CONTRACTOR SHALL BE RESPONSIBLE FOR FABRICATING, SUPPLYING AND INSTALLING ALL LIGHT, MECHANICAL AND STRUCTURAL SUPPORTING SYSTEMS. SIEMENS MEDICAL SOLUTIONS INC. IS ONLY RESPONSIBLE FOR THE SUPPLYING, INSTALLING AND CALIBRATION OF SMS EQUIPMENT AS SPECIFIED ON THE EQUIPMENT SCHEDULE AS SHOWN ON SHEET A-101.
- 4) ALL ELECTRICAL AND STRUCTURAL SYSTEMS SHOWN ON THE REFLECTED CEILING PLAN HAVE BEEN COORDINATED WITH THE EQUIPMENT LOCATIONS AS SHOWN ON THE 1/4" SCALE ARCHITECTURAL EQUIPMENT PLAN (SHEET A-101). ANY CHANGES TO THE SMS EQUIPMENT CONFIGURATION AS SHOWN, DUE TO PLACEMENT OF LIGHTING, STRUCTURAL, ELECTRICAL AND MECHANICAL SYSTEMS, MUST BE APPROVED IN WRITING BY THE SMS PROJECT MANAGER PRIOR TO THE COMPLETION OF CONSTRUCTION DOCUMENTS.

ATTENTION:

- THIS DRAWING IS DESIGNED TO CONFORM TO FEATURES AND EQUIPMENT REQUIREMENTS PRESENTED AT THE TIME OF THEIR PREPARATION. SINCE BOTH THESE FACTORS ARE SUBJECT TO DESIGN MODIFICATION, THEY ARE NOT TO BE USED FOR CONSTRUCTION PURPOSES.
- THIS SET OF PLANS REPRESENTS A COMPLETE SET OF DETAILS AND SHOULD NOT BE SEPARATED.

- IT IS RECOMMENDED THAT THE SIEMENS DRAWINGS BE INCORPORATED WITH THE CONSTRUCTION DOCUMENTS FOR REFERENCE.

- ALL DIMENSIONS SHOWN ON THIS DRAWING ARE FROM FINISHED SURFACES.
- THIS DRAWING DOES NOT PROVIDE RADIATION SHIELDING REQUIREMENTS FOR X-RAY AND ASSOCIATED EQUIPMENT. THE CUSTOMER IS RESPONSIBLE FOR CONSULTING WITH A REGISTERED RADIATION PHYSICIST TO SPECIFY RADIATION PROTECTION.

MINIMUM CEILING HEIGHT	CEILING HEIGHT WITHOUT RESTRICTION	RECOMMENDED CEILING HEIGHT
SEE RM HT REQMS	SEE RM HT REQMS	9'-6"

SYM	DATE	DESCRIPTION
△	10/21/16	R-101 VERSION A, DATED 04/07/16 APPROVED BY CUSTOMER FOR FINALS.
-ISSUE BLOCK-		

PROJECT MANAGER: RICH DEISTER TEL: (207) 712-3205 FAX: (207) 929-3776 EMAIL: RICH.DEISTER@SIEMENS.COM		SIEMENS	
BRIGHTON MEDICAL CENTER			
335 BRIGHTON AVE., PORTLAND, ME 04102 FLUORO ROOM - LUMINOS AGILE MAX			
PROJECT #: 1601355		SHEET: A-102	
THE USE OR REPRODUCTION OF THIS TITLE BLOCK WITHOUT SIEMENS AUTHORIZATION WILL RESULT IN PROSECUTION UNDER FULL EXTENT OF THE LAW.		ALL RIGHTS ARE RESERVED.	
SCALE: AS NOTED	REF: # FFKJW.7	SHEET 2 OF	DRAWN BY: D. CAPSTICK
DATE: 10/21/16			

LUMINOS AGILE
REV 10