

Upper Floor Plan
1/4" = 1'-0"

EXISTING RESIDENCE

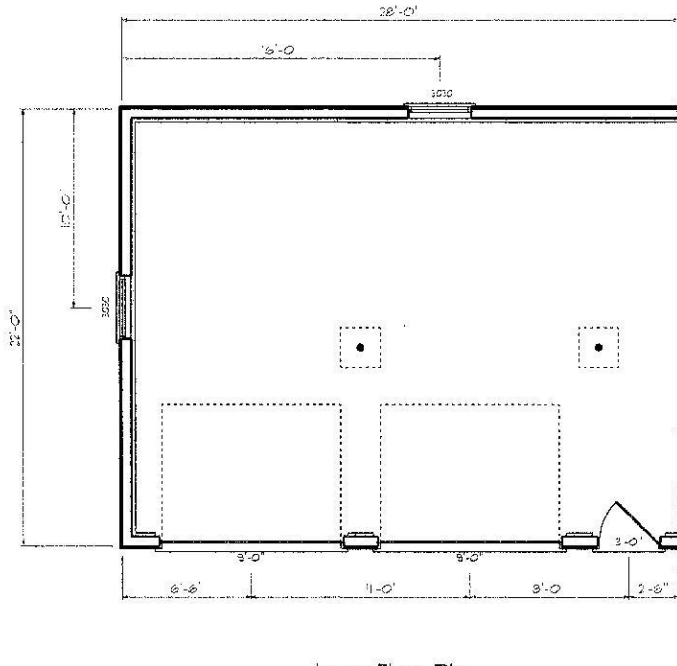

Lower Floor Plan
1/4" = 1'-0"

Is there a stairway from the garage to the living space above the garage? Clarify if the only access is from the existing house to the new living space above the garage is the 3' wide opening shown. No, there is no stairway from the garage to the living space above the garage. Yes the

3' wide opening shown is the only access from the existing house to the new living space above the garage.

GRAY'S <small>Building fine homes for over 20 years</small>		Note Owner to check plans for compliance with all applicable codes Custom 28'x28' ADDITION	
Plan For:	Joyce Johnson	2	2
Drawn By:	Wayne Parodie	Aug 10, 2014	