

PERMIT ISSUED

City of Portland, Maine - Building or Use Permit Application
 389 Congress Street, 04101 Tel: (207) 874-8703, Fax: (207) 874-8716

Permit No: 03-1425	Issue Date: NOV 25 2003	CBL: 120 C017001
-----------------------	-----------------------------------	---------------------

Location of Construction: 190 Edwards St	Owner Name: Mulkern Catherine E	Owner Address: 190 Edwards St CITY OF PORTLAND	Phone: 329-4200
Business Name:	Contractor Name: John Poirier	Contractor Address: 27 Bonin Road Monmouth	Phone: 2077497422
Lessee/Buyer's Name	Phone:	Permit Type: Alterations - Dwellings	Zone: R3

Past Use: Single Family	Proposed Use: Single Family w/10' x 14' deck	Permit Fee: \$30.00	Cost of Work: \$300.00	CEO District: 3
----------------------------	---	------------------------	---------------------------	--------------------

Proposed Project Description:
 Build a 10' x 14' deck extension on grade

FIRE DEPT: <input type="checkbox"/> Approved <input type="checkbox"/> Denied	INSPECTION: Use Group: R3 Type: 5B BOCA 1999 Signature: JMB 11/25/03
---	---

PEDESTRIAN ACTIVITIES DISTRICT (P.A.D.)

Action: Approved Approved w/Conditions Denied

Signature: _____ Date: _____

Permit Taken By: jmb	Date Applied For: 11/17/2003	Zoning Approval
-------------------------	---------------------------------	------------------------

<ol style="list-style-type: none"> 1. This permit application does not preclude the Applicant(s) from meeting applicable State and Federal Rules. 2. Building permits do not include plumbing, septic or electrical work. 3. Building permits are void if work is not started within six (6) months of the date of issuance. False information may invalidate a building permit and stop all work.. 	Special Zone or Reviews <input type="checkbox"/> Shoreland <input type="checkbox"/> Wetland <input type="checkbox"/> Flood Zone <input type="checkbox"/> Subdivision <input type="checkbox"/> Site Plan Maj <input type="checkbox"/> Minor <input type="checkbox"/> MM <input type="checkbox"/> Date: 11/25/03 JMB	Zoning Appeal <input type="checkbox"/> Variance <input type="checkbox"/> Miscellaneous <input type="checkbox"/> Conditional Use <input type="checkbox"/> Interpretation <input type="checkbox"/> Approved <input type="checkbox"/> Denied Date: _____	Historic Preservation <input checked="" type="checkbox"/> Not in District or Landmark <input type="checkbox"/> Does Not Require Review <input type="checkbox"/> Requires Review <input type="checkbox"/> Approved <input type="checkbox"/> Approved w/Conditions <input type="checkbox"/> Denied Date: JMB
--	---	---	---

CERTIFICATION

I hereby certify that I am the owner of record of the named property, or that the proposed work is authorized by the owner of record and that I have been authorized by the owner to make this application as his authorized agent and I agree to conform to all applicable laws of this jurisdiction. In addition, if a permit for work described in the application is issued, I certify that the code official's authorized representative shall have the authority to enter all areas covered by such permit at any reasonable hour to enforce the provision of the code(s) applicable to such permit.

SIGNATURE OF APPLICANT	ADDRESS	DATE	PHONE
RESPONSIBLE PERSON IN CHARGE OF WORK, TITLE		DATE	PHONE

DISPLAY THIS CARD ON PRINCIPAL FRONTAGE OF WORK CITY OF PORTLAND

Please Read Application And Notes, If Any, Attached

BUILDING INSPECTION

PERMIT ISSUED

Permit Number: 031425
NOV 25 2003

This is to certify that Mulkern Catherine E/John P
has permission to Build a 10' x 14' deck extension on grade
AT 190 Edwards St 120 C017001
CITY OF PORTLAND

provided that the person or persons, firm or corporation accepting this permit shall comply with all of the provisions of the Statutes of Maine and of the ordinances of the City of Portland regulating the construction, maintenance and use of buildings and structures, and of the application on file in this department.

Apply to Public Works for street line and grade if nature of work requires such information.

Notification of inspection must be given and when permission is procured before this building or part thereof is occupied or closed-in.
48 HOUR NOTICE IS REQUIRED.

A certificate of occupancy must be procured by owner before this building or part thereof is occupied.

OTHER REQUIRED APPROVALS

Fire Dept. _____
Health Dept. _____
Appeal Board _____
Other _____
Department Name

Janice Bourke 11/25/03
Director - Building & Inspection Services

PENALTY FOR REMOVING THIS CARD

BUILDING PERMIT INSPECTION PROCEDURES

Please call 874-8703 or 874-8693 to schedule your inspections as agreed upon

Permits expire in 6 months, if the project is not started or ceases for 6 months.

The Owner or their designee is required to notify the inspections office for the following inspections and provide adequate notice. Notice must be called in 48-72 hours in advance in order to schedule an inspection:

By initialzing at each inspection time, you are agreeing that you understand the inspection procedure and additional fees from a "Stop Work Order" and "Stop Work Order Release" will be incurred if the procedure is not followed as stated below.

JB **Pre-construction Meeting:** Must be scheduled with your inspection team upon receipt of this permit. Jay Reynolds, Development Review Coordinator at ~~874-8632~~ must also be contacted at this time, before any site work begins on any project other than single family additions or alterations.

- Footing/Building Location Inspection:** Prior to pouring concrete
- NA **Re-Bar Schedule Inspection:** Prior to pouring concrete
- NA **Foundation Inspection:** Prior to placing ANY backfill
- Framing/Rough Plumbing/Electrical:** Prior to any insulating or drywalling
- NA **Final/Certificate of Occupancy:** Prior to any occupancy of the structure or use. NOTE: ~~There is a \$75.00 fee per~~ inspection at this point.

Certificate of Occupancy is not required for certain projects. Your inspector can advise you if your project requires a Certificate of Occupancy. All projects DO require a final inspection

If any of the inspections do not occur, the project cannot go on to the next phase, REGARDLESS OF THE NOTICE OR CIRCUMSTANCES.

NA **CERIFICATE OF OCCUPANICES MUST BE ISSUED AND PAID FOR, BEFORE THE SPACE MAY BE OCCUPIED**

[Signature]
Signature of applicant/designee

11/25/03
Date

[Signature]
Signature of Inspections Official

11/25/03
Date

CBL: 120-C-17 Building Permit #: 03-1425

City of Portland, Maine - Building or Use Permit

389 Congress Street, 04101 Tel: (207) 874-8703, Fax: (207) 874-8716

Permit No: 03-1425	Date Applied For: 11/17/2003	CBL: 120 C017001
------------------------------	--	----------------------------

Location of Construction: 190 Edwards St	Owner Name: Mulkern Catherine E	Owner Address: 190 Edwards St	Phone: () 329-4200
Business Name:	Contractor Name: John Poirier	Contractor Address: 27 Bonin Road Monmouth	Phone: (207) 749-7422
Lessee/Buyer's Name	Phone:	Permit Type: Alterations - Dwellings	

Proposed Use: Single Family w/10' x 14' deck	Proposed Project Description: Build a 10' x 14' deck extension on grade
--	---

Dept: Zoning	Status: Approved	Reviewer: Jeanine Bourke	Approval Date: 11/25/2003
Note:	Ok to Issue: <input checked="" type="checkbox"/>		
Dept: Building	Status: Approved	Reviewer: Jeanine Bourke	Approval Date: 11/25/2003
Note:	Ok to Issue: <input checked="" type="checkbox"/>		
1) If the height off grade is 15-1/2" or less guardrails are not required 2) Application approval based upon information provided by applicant. Any deviation from approved plans requires separate review and approval prior to work.			

All Purpose Building Permit Application

If you or the property owner owes real estate or personal property taxes or user charges on any property within the City, payment arrangements must be made before permits of any kind are accepted.

Location/Address of Construction: <u>890 EDWARDS ST</u>			
Total Square Footage of Proposed Structure <u>80 sq ft</u>		Square Footage of Lot <u>9775</u>	
Tax Assessor's Chart, Block & Lot Chart# <u>120</u> Block# <u>C</u> Lot# <u>17</u>		Owner: <u>MARK POIRIER</u>	Telephone: 749 <u>7200</u>
Lessee/Buyer's Name (if Applicable)		Applicant name, address & telephone: <u>Mark Poirier</u>	Cost Of Work: \$ <u>300.00</u> Fee: \$ <u>30.00</u>
Current use: _____			
If the location is currently vacant, what was prior use: <u>Home</u>			
Approximately how long has it been vacant: _____			
Proposed use: <u>Deck Addition</u>			
Project description: <u>10 x 10 deck</u>			
Contractor's name, address & telephone: <u>John Poirier</u>			
Who should we contact when the permit is ready: <u>John Poirier</u>			
Mailing address: <u>27 Bonin Rd. Monmouth Me. 04259</u>			
We will contact you by phone when the permit is ready. You must come in and pick up the permit and review the requirements before starting any work, with a Plan Reviewer. A stop work order will be issued and a \$100.00 fee if any work starts before the permit is picked up. PHONE: <u>749 7422</u>			

IF THE REQUIRED INFORMATION IS NOT INCLUDED IN THE SUBMISSIONS THE PERMIT WILL BE AUTOMATICALLY DENIED AT THE DISCRETION OF THE BUILDING/PLANNING DEPARTMENT, WE MAY REQUIRE ADDITIONAL INFORMATION IN ORDER TO APPROVE THIS PERMIT.

I hereby certify that I am the Owner of record of the named property, or that the owner of record authorizes the proposed work and that I have been authorized by the owner to make this application as his/her authorized agent. I agree to conform to all applicable laws of this jurisdiction. In addition, if a permit for work described in this application is issued, I certify that the Code Official's authorized representative shall have the authority to enter all areas covered by this permit at any reasonable hour to enforce the provisions of the codes applicable to this permit.

Signature of applicant: <u>Mark Poirier</u>	Date: <u>11/25/02</u>
---	-----------------------

**This is NOT a permit, you may not commence ANY work until the permit is issued.
If you are in a Historic District you may be subject to additional permitting and fees with the
Planning Department on the 4th floor of City Hall**

This page contains a detailed description of the Parcel ID you selected. Press the **New Search** button at the bottom of the screen to submit a new query.

Current Owner Information

Card Number 1 of 1
 Parcel ID 120 C017001
 Location 190 EDWARDS ST
 Land Use SINGLE FAMILY

Owner Address MULKERN CATHERINE E
 190 EDWARDS ST
 PORTLAND ME 04102

Book/Page 10904/148
 Legal 120-C-17-18
 EDWARDS ST 190
 10030 SF

*mark 3PM 11/17
2nd PL
Addition.*

#1425

R 3

11/25 3PM

Valuation Information

Land	Building	Total
\$34,970	\$62,260	\$97,230

Property Information

Year Built 1952	Style Ranch	Story Height 1	Sq. Ft. 912	Total Acres 0.23
Bedrooms 2	Full Baths 1	Half Baths	Total Rooms 5	Attic None
				Basement Full

Outbuildings

Type	Quantity	Year Built	Size	Grade	Condition
GARAGE-WD/CB	1	1952	12X22	C	A
SHED-FRAME	1	1970	8X8	C	A

Sales Information

Date 08/01/1993	Type LAND + BLDING	Price \$85,500	Book/Page 10904-148
---------------------------	------------------------------	--------------------------	-------------------------------

Picture and Sketch

Picture Sketch

[Click here to view Tax Roll Information.](#)

Any information concerning tax payments should be directed to the Treasury office at 874-8490 or e-mailed.



Deed

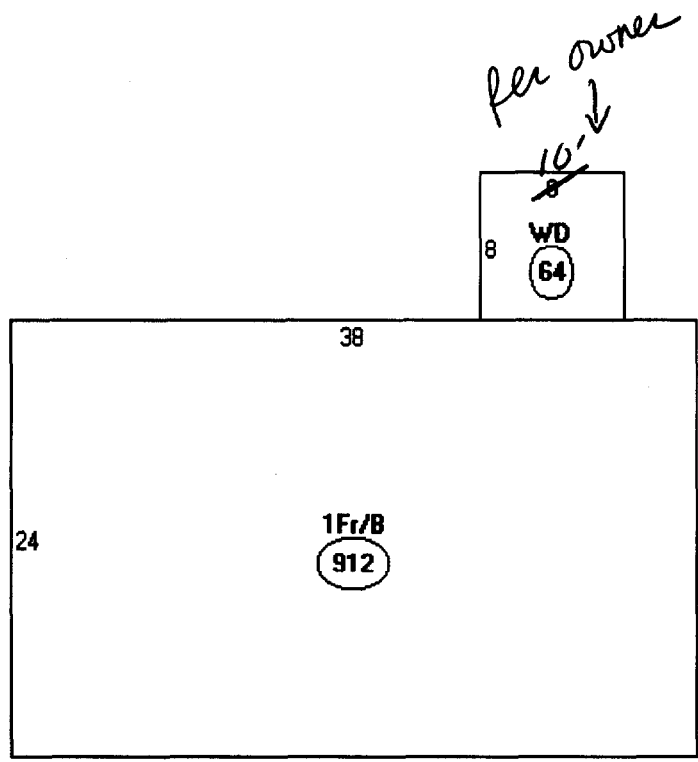

Descriptor/Area

A: 1Fr/B
912 sqft

B: WD
64 sqft

80



992
 264 garage
 64 shed
 35 steps

1355 SF
 140 new deck

1,495

Lot 10,030 SF
 4.25%

2,515 SF

OK



No guard rail required

2-2x80 Beam

1" off grade

Just roughs

~~we have 1017~~
~~we need 10694~~
~~boards 912~~
~~we need to use (72)~~

Intended addition to deck

2x10 pt. 16 O.C. Joists
5/8 Decking - PA
3 Sones 48" to Frost

STEP DOWN

10'

80sq ft

Garage

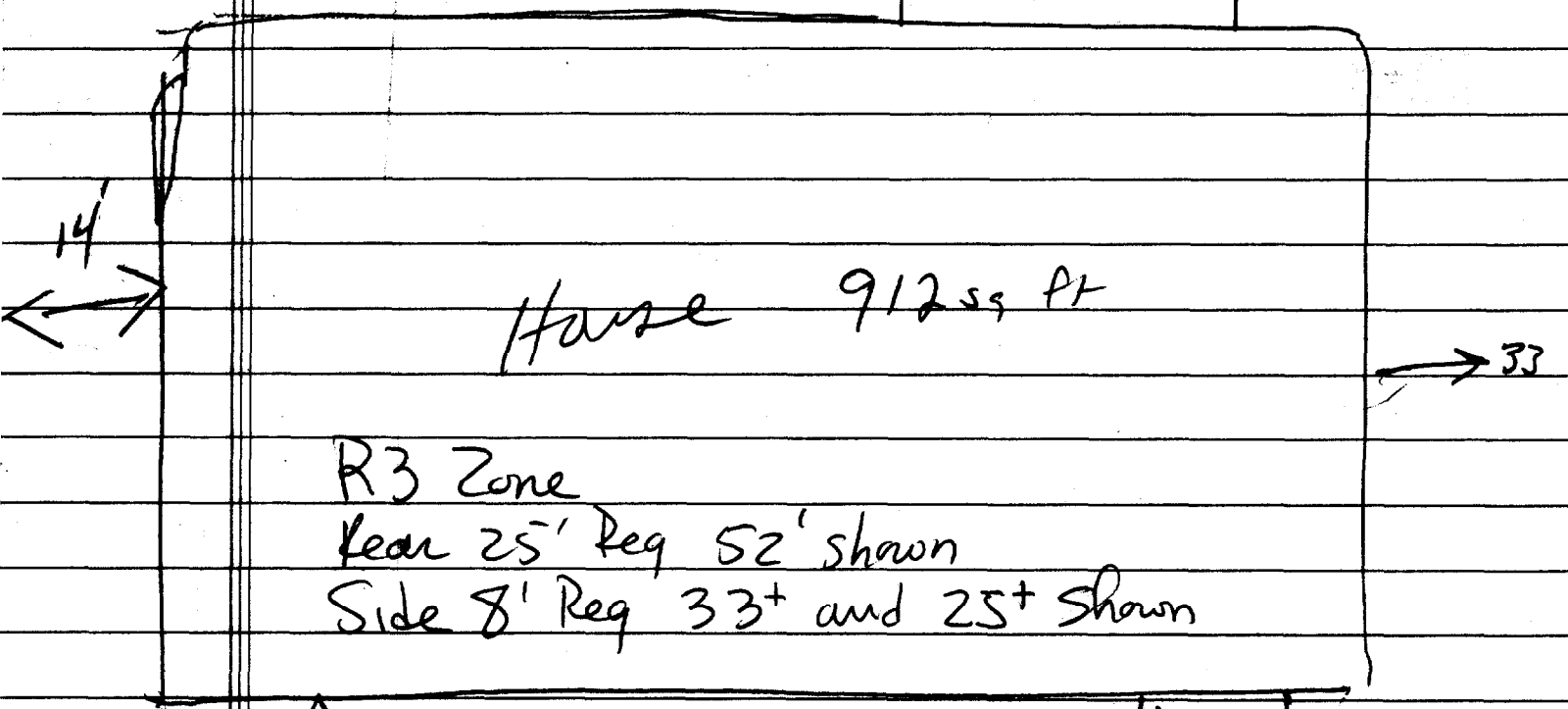

R3 Zone
Rear 25' Req 52' shown
Side 8' Req 33+ and 25+ shown

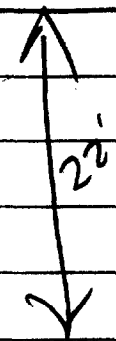

EDWARDS ST.

