

**City of Portland, Maine - Building or Use Permit Application**

389 Congress Street, 04101 Tel: (207) 874-8703, Fax: (207) 874-8716

Permit No: 10-0142	Issue Date:	CBL: 120 A011001
-----------------------	-------------	---------------------

Location of Construction: 135 CALEB ST	Owner Name: WELCH JILL	Owner Address: 135 CALEB ST	Phone:
Business Name:	Contractor Name: Main Gas	Contractor Address: 908 Roosevelt Trail Windham	Phone 2078926744
Lessee/Buyer's Name	Phone:	Permit Type: Tanks - Dwellings	Zone:

Past Use: Single Family Home	Proposed Use: Single Family Home - install a cooking range and (1) 50 gallon propane tank	Permit Fee: \$30.00	Cost of Work: \$30.00	CEO District: 3
		FIRE DEPT: <input type="checkbox"/> Approved <input type="checkbox"/> Denied	INSPECTION: Use Group: R-3 Type: LP TANK NFPASS	

Proposed Project Description: install a cooking range and (1) 50 gallon propane tank	Signature:	Signature: JMB 2/24/10
PEDESTRIAN ACTIVITIES DISTRICT (P.A.D.)		
Action: <input type="checkbox"/> Approved <input type="checkbox"/> Approved w/Conditions <input type="checkbox"/> Denied		
Signature: _____ Date: _____		

Permit Taken By: ldobson	Date Applied For: 02/17/2010	<b>Zoning Approval</b>
-----------------------------	---------------------------------	------------------------

1. This permit application does not preclude the Applicant(s) from meeting applicable State and Federal Rules.
2. Building permits do not include plumbing, septic or electrical work.
3. Building permits are void if work is not started within six (6) months of the date of issuance. False information may invalidate a building permit and stop all work..

<b>Special Zone or Reviews</b> <input type="checkbox"/> Shoreland <input type="checkbox"/> Wetland <input type="checkbox"/> Flood Zone <input type="checkbox"/> Subdivision <input type="checkbox"/> Site Plan <i>OK</i> Maj <input type="checkbox"/> Minor <input type="checkbox"/> MM <input type="checkbox"/> Date: <i>JMB 2/24/10</i>	<b>Zoning Appeal</b> <input type="checkbox"/> Variance <input type="checkbox"/> Miscellaneous <input type="checkbox"/> Conditional Use <input type="checkbox"/> Interpretation <input type="checkbox"/> Approved <input type="checkbox"/> Denied Date: _____	<b>Historic Preservation</b> <input checked="" type="checkbox"/> Not in District or Landmark <input type="checkbox"/> Does Not Require Review <input type="checkbox"/> Requires Review <input type="checkbox"/> Approved <input type="checkbox"/> Approved w/Conditions <input type="checkbox"/> Denied Date: <i>JMB</i>
--	---	---

**PERMIT ISSUED**

MAR - 4 2010

City of Portland

**CERTIFICATION**

I hereby certify that I am the owner of record of the named property, or that the proposed work is authorized by the owner of record and that I have been authorized by the owner to make this application as his authorized agent and I agree to conform to all applicable laws of this jurisdiction. In addition, if a permit for work described in the application is issued, I certify that the code official's authorized representative shall have the authority to enter all areas covered by such permit at any reasonable hour to enforce the provision of the code(s) applicable to such permit.

SIGNATURE OF APPLICANT	ADDRESS	DATE	PHONE
RESPONSIBLE PERSON IN CHARGE OF WORK, TITLE		DATE	PHONE



FILL IN AND SIGN WITH INK

# APPLICATION FOR PERMIT HEATING OR POWER EQUIPMENT

PERMIT ISSUED

MAR - 4 2010

City of Portland

To the INSPECTOR OF BUILDINGS, PORTLAND, ME.

The undersigned hereby applies for a permit to install the following heating, cooking or power equipment in accordance with the Laws of Maine, the Building Code of the City of Portland, and the following specifications:

Location / CBL 135 COLER ST 120-A-11 Use of Building RES Date 03-17-10  
 Name and address of owner of appliance Jill Welch  
135 COLER ST Portland ME  
 Installer's name and address MARGAS  
508 Rosmont Trail Windham ME Telephone 207-892-6244

**Location of appliance:**

- Basement
- Floor
- Attic
- Roof

**Type of Fuel:**

- Gas
- Oil
- Solid

Appliance Name: COOKING RANGE

U.L. Approved  Yes  No

Will appliance be installed in accordance with the manufacture's installation instructions?  Yes  No

IF NO Explain: \_\_\_\_\_

**The Type of License of Installer:**

- Master Plumber # \_\_\_\_\_
- Solid Fuel # \_\_\_\_\_
- Oil # \_\_\_\_\_
- Gas # MARGAS
- Other \_\_\_\_\_

**Type of Chimney:**

- Masonry Lined  
Factory built \_\_\_\_\_
- Metal  
Factory Built U.L. Listing # \_\_\_\_\_
- Direct Vent  
Type \_\_\_\_\_

**Type of Fuel Tank**

- Oil
- Gas

Size of Tank 50 GAL

Number of Tanks 1

Distance from Tank to Center of Flame 25 feet.

Cost of Work: \$ \_\_\_\_\_

Permit Fee: \$ 30

**RECEIVED**  
 FEB 17 2010  
 Dept. of Building Inspections  
 City of Portland Maine

Approved

Approved with Conditions

Fire: \_\_\_\_\_  
 Ele.: \_\_\_\_\_  
 Bldg.: \_\_\_\_\_

See attached letter or requirement

Inspector's Signature

Date Approved

Signature of Installer

Margas

White - Inspection    Yellow - File    Pink - Applicant's    Gold - Assessor's Copy

**BUILDING PERMIT INSPECTION PROCEDURES**

**Please call 874-8703 or 874-8693 (ONLY)**

**to schedule your inspections as agreed upon**

**Permits expire in 6 months, if the project is not started or ceases for 6 months.**

The Owner or their designee is required to notify the inspections office for the following inspections and provide adequate notice. Notice must be called in 48-72 hours in advance in order to schedule an inspection:

**By initializing at each inspection time, you are agreeing that you understand the inspection procedure and additional fees from a "Stop Work Order" and "Stop Work Order Release" will be incurred if the procedure is not followed as stated below.**

**A Pre-construction Meeting will take place upon receipt of your building permit.**

  **X**   **Final inspection required at completion of work.**

Certificate of Occupancy is not required for certain projects. Your inspector can advise you if your project requires a Certificate of Occupancy. All projects DO require a final inspection.

**If any of the inspections do not occur, the project cannot go on to the next phase, REGARDLESS OF THE NOTICE OR CIRCUMSTANCES.**

**CERIFICATE OF OCCUPANICES MUST BE ISSUED AND PAID FOR, BEFORE THE SPACE MAY BE OCCUPIED.**

\_\_\_\_\_  
Signature of Applicant/Designee

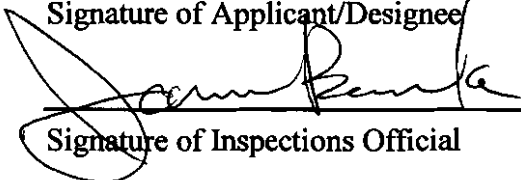

\_\_\_\_\_  
Signature of Inspections Official

\_\_\_\_\_  
Date

  2/24/10    
Date

**City of Portland, Maine - Building or Use Permit**

389 Congress Street, 04101 Tel: (207) 874-8703, Fax: (207) 874-8716

<b>Permit No:</b> 10-0142	<b>Date Applied For:</b> 02/17/2010	<b>CBL:</b> 120 A011001
------------------------------	--	----------------------------

<b>Location of Construction:</b> 135 CALEB ST	<b>Owner Name:</b> WELCH JILL	<b>Owner Address:</b> 135 CALEB ST	<b>Phone:</b>
<b>Business Name:</b>	<b>Contractor Name:</b> Main Gas	<b>Contractor Address:</b> 908 Roosevelt Trail Windham	<b>Phone</b> (207) 892-6744
<b>Lessee/Buyer's Name</b>	<b>Phone:</b>	<b>Permit Type:</b> Tanks - Dwellings	

<b>Proposed Use:</b> Single Family Home - install a cooking range and (1) 50 gallon propane tank	<b>Proposed Project Description:</b> install a cooking range and (1) 50 gallon propane tank
---	--

<b>Dept:</b> Zoning	<b>Status:</b> Approved with Conditions	<b>Reviewer:</b> Jeanine Bourke	<b>Approval Date:</b> 02/24/2010
<b>Note:</b>			<b>Ok to Issue:</b> <input checked="" type="checkbox"/>
1) This property shall remain a single family dwelling. Any change of use shall require a separate permit application for review and approval.			
<b>Dept:</b> Building	<b>Status:</b> Approved with Conditions	<b>Reviewer:</b> Jeanine Bourke	<b>Approval Date:</b> 02/24/2010
<b>Note:</b>			<b>Ok to Issue:</b> <input checked="" type="checkbox"/>
1) Tanks shall be installed per NFPA 58			

**Maingas (Branch #17)  
Customer Site Plan**

New Account:	
Existing Account:	
Date:	02-12-10
Phone #:	318-1651
Work #:	

CUSTOMER NAME: JILL WELCH  
 STREET ADDRESS: 135 CALER ST  
 TOWN: Portland ME 04102

**DELIVERY INSTRUCTIONS:**

**Appliance(s) being installed:** (1)Type: \_\_\_\_\_ Btu's: \_\_\_\_\_ (2)Type: \_\_\_\_\_ Btu's: \_\_\_\_\_  
 (3)Type: \_\_\_\_\_ Btu's: \_\_\_\_\_ (4)Type: \_\_\_\_\_ Btu's: \_\_\_\_\_

**Total System (Btu) load:** \_\_\_\_\_ Btu's: \_\_\_\_\_

**Tank/Regulator Information:** Tank Size:  Regulator(s): Twin  1st  2nd

**Additional tank/reg. Info.:** \_\_\_\_\_

**Piping Information:** Type: \_\_\_\_\_ Size: \_\_\_\_\_ Quantity: \_\_\_\_\_

**Additional piping information:** \_\_\_\_\_

**Parts/Fittings Information:** \_\_\_\_\_

**Special tools required:** \_\_\_\_\_

**VENTING**

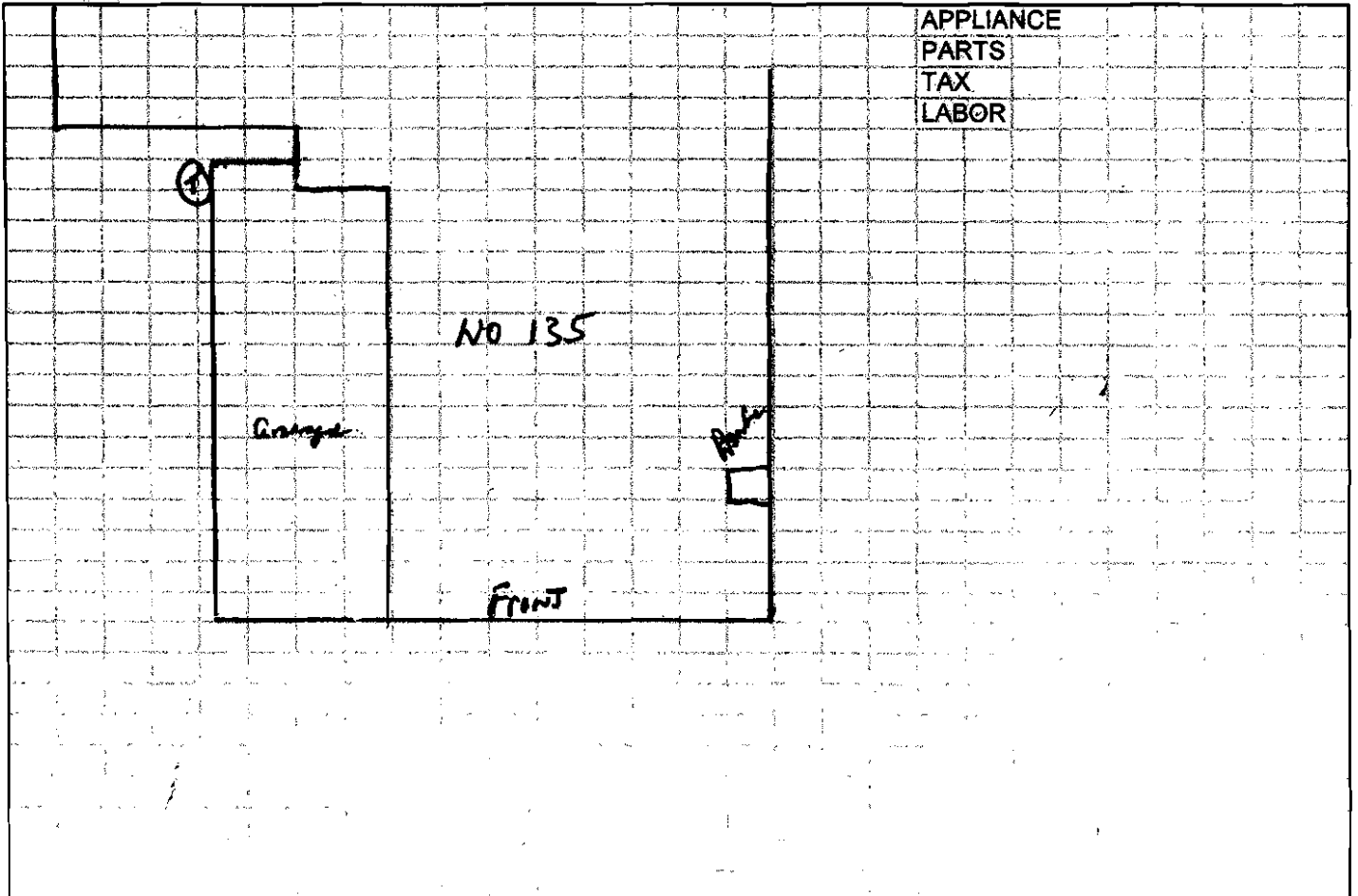

**Additional Instructions/Comments:**

← CALER ST →