

# DISPLAY THIS CARD ON PRINCIPAL FRONTAGE OF WORK CITY OF PORTLAND

Please Read Application And Notes, If Any, Attached

## BUILDING DEPARTMENT PERMIT

Permit Number: 030552

This is to certify that Temple Beth-el/Leavitt & Partners Inc.  
has permission to Erect 4 tents from May 22-28 03: 40' x 100'; 20' x 10'; 50' x 10'; 20' x 40'  
AT 400 Deering Ave Call 119 I001001

provided that the person or persons, firm or corporation accepting this permit shall comply with all of the provisions of the Statutes of Maine and of the Ordinances of the City of Portland regulating the construction, maintenance and use of buildings and structures, and of the application on file in this department.

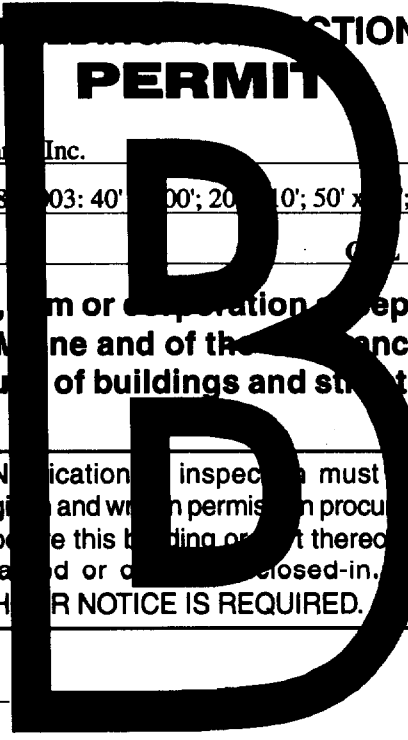

Apply to Public Works for street line and grade if nature of work requires such information.

Notification of inspection must be given and work on permit must be completed before this building or part thereof is occupied or enclosed-in. HEAVY NOTICE IS REQUIRED.

A certificate of occupancy must be procured by owner before this building or part thereof is occupied.

### OTHER REQUIRED APPROVALS

Fire Dept. WMM  
Health Dept. \_\_\_\_\_  
Appeal Board \_\_\_\_\_  
Other \_\_\_\_\_  
Department Name

*Ch. Knight*  
Director - Building & Inspection Services

**PENALTY FOR REMOVING THIS CARD**

**City of Portland, Maine - Building or Use Permit Application**

389 Congress Street, 04101 Tel: (207) 874-8703, Fax: (207) 874-8716

Permit No: 03-0552	Issue Date:	CBL: 119 I001001
-----------------------	-------------	---------------------

Location of Construction: 400 Deering Ave	Owner Name: Temple Beth-el	Owner Address: 400 Deering Ave	Phone: 774-2649
Business Name:	Contractor Name: Leavitt & Parris Inc.	Contractor Address: 256 read St. Portland	Phone: 2077970100
Lessee/Buyer's Name	Phone:	Permit Type: Tents	Zone: R5

Past Use: Temple Beth El	Proposed Use: Temple Beth El with 4 tents from May 22-28, 2003: 40' x 100'; 20' x 10'; 50' x 33'; 20' x 40'	Permit Fee: \$35.00	Cost of Work: \$0.00	CEO District: 3
-----------------------------	--	------------------------	-------------------------	--------------------

FIRE DEPT: <input checked="" type="checkbox"/> Approved <input type="checkbox"/> Denied	INSPECTION: Use Group: TENT Type: A
---	--

Proposed Project Description:  
Erect 4 tents from May 22-28, 2003: 40' x 100'; 20' x 10'; 50' x 33'; 20' x 40'

Signature: *[Handwritten Signature]* Signature: *[Handwritten Signature]*  
PEDESTRIAN ACTIVITIES DISTRICT (P.A.D.)

Action:  Approved  Approved w/Conditions  Denied  
Signature: Date:

Permit Taken By: kwd	Date Applied For: 05/22/2003	<b>Zoning Approval</b>	
-------------------------	---------------------------------	------------------------	--

<p>1. This permit application does not preclude the Applicant(s) from meeting applicable State and Federal Rules.</p> <p>2. Building permits do not include plumbing, septic or electrical work.</p> <p>3. Building permits are void if work is not started within six (6) months of the date of issuance. False information may invalidate a building permit and stop all work..</p>	<p>Special Zone or Reviews</p> <p><input type="checkbox"/> Shoreland</p> <p><input type="checkbox"/> Wetland</p> <p><input type="checkbox"/> Flood Zone</p> <p><input type="checkbox"/> Subdivision</p> <p><input type="checkbox"/> Site Plan</p> <p>Maj <input type="checkbox"/> Minor <input type="checkbox"/> MM <input type="checkbox"/></p> <p>Date: <i>[Handwritten Signature]</i></p>	<p>Zoning Appeal</p> <p><input type="checkbox"/> Variance</p> <p><input type="checkbox"/> Miscellaneous</p> <p><input type="checkbox"/> Conditional Use</p> <p><input type="checkbox"/> Interpretation</p> <p><input type="checkbox"/> Approved</p> <p><input type="checkbox"/> Denied</p> <p>Date: <i>[Handwritten Signature]</i></p>	<p>Historic Preservation</p> <p><input type="checkbox"/> Not in District or Landmark</p> <p><input type="checkbox"/> Does Not Require Review</p> <p><input type="checkbox"/> Requires Review</p> <p><input type="checkbox"/> Approved</p> <p><input type="checkbox"/> Approved w/Conditions</p> <p><input type="checkbox"/> Denied</p> <p>Date:</p>
---	--	--	---

**CERTIFICATION**

I hereby certify that I am the owner of record of the named property, or that the proposed work is authorized by the owner of record and that I have been authorized by the owner to make this application as his authorized agent and I agree to conform to all applicable laws of this jurisdiction. In addition, if a permit for work described in the application is issued, I certify that the code official's authorized representative shall have the authority to enter all areas covered by such permit at any reasonable hour to enforce the provision of the code(s) applicable to such permit.

\_\_\_\_\_  
SIGNATURE OF APPLICANT ADDRESS DATE PHONE

\_\_\_\_\_  
RESPONSIBLE PERSON IN CHARGE OF WORK, TITLE DATE PHONE

# Tent Permit Application

If you or the property owner owes real estate or personal property taxes or user charges on any property within the City, payment arrangements must be made before permits of any kind are accepted.

Location/Address of Construction: <u>400 Deering Ave.</u>		
Date of Tent setup: <u>May 22</u>	Date of Tent breakdown: <u>May 28</u>	
Tax Assessor's Chart, Block & Lot Chart# <u>119</u> Block# <u>I</u> Lot# <u>001</u>	Owner: <u>Temple Beth El</u>	Telephone: <u>774-2649</u>
Lessee/Buyer's Name (If Applicable)	Applicant name, address & telephone: <u>Karen + Irv Shapell</u> <u>Leavitt + Parris</u>	<b>Fee: \$ 35.00</b>

**The following must be included as submissions:**

1. Certificate of Flammability
2. Letter of approval from property owner. If the City is the owner, please contact Ted Musgrave from the Parks & Recreation @ 874-8793
3. Plot Plan showing the following:
  - i. Property lines
  - ii. Parking
  - iii. Building locations
4. Tent location, including dimensions of tent, exits and entrances in tent.
5. If the City is the property owner, Certificate of Insurance listing the City as additional insured. Minimum amount of coverage is \$400,000.00

Whom should we contact when the permit is ready: Leavitt + Parris Inc.  
 Mailing address:  
 PHONE: \_\_\_\_\_

We will contact you by phone when the permit is ready. You must come in and pick up the permit and review the requirements before starting any work, with a Plan Reviewer. A STOP WORK ORDER WILL BE ISSUED AND A \$100.00 FINE LEVIED IF ANY WORK STARTS BEFORE THE PERMIT IS PICKED UP.

**IF THE REQUIRED INFORMATION IS NOT INCLUDED IN THE SUBMISSIONS THE PERMIT WILL BE AUTOMATICALLY DENIED AT THE DISCRETION OF THE BUILDING/PLANNING DEPARTMENT, WE MAY REQUIRE ADDITIONAL INFORMATION IN ORDER TO APPROVE THIS PERMIT.**

*I hereby certify that I am the Owner of record of the named property, or that the owner of record authorizes me to make this application as his/her authorized agent. I agree to comply with all applicable laws of this jurisdiction. In addition, if a permit for work described in this application is issued, I certify that the Code Enforcement Department representative shall have the authority to enter all areas covered by this permit at any reasonable time to enforce the provisions of the codes applicable to this permit.*

Signature of applicant: [Handwritten Signature]

DEPT. OF BUILDING INSPECTION  
CITY OF PORTLAND, ME

RECEIVED

MAY 22 2003

CITY OF PORTLAND

DEPT. OF BUILDING INSPECTION  
CITY OF PORTLAND, ME

**This is NOT a permit; you may not commence ANY work until the permit is issued.**



# Temple Beth El

400 Deering Avenue  
 Portland, ME 04103  
 Tel: (207) 774-2649  
 Fax: (207) 774-7518

**Rabbi**  
 Carolyn Braun  
*The Meyer Levine*  
*Chair of Robbinics*

**Cantor**  
 Ruth L. Ross

**Rabbi Emeritus**  
 Harry Z. Sky

**Cantor Emeritus**  
 Kurt Messerschmidt

**President**  
 Barbara Dichter

**Administrator**  
 Kenneth Levinsky

**Education Director**  
 Avis Smith

Thursday, May 22, 2003

Irvin and Karen Shapell are members of Temple Beth El in Portland. They have full authorization to erect tenting on our property from May 22 until May 28, 2003. Please call me if I can be of any assistance.

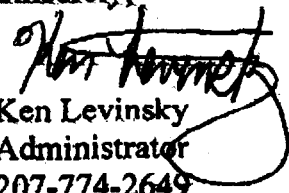
Sincerely,  
  
 Ken Levinsky  
 Administrator  
 207-774-2649

Post-It <sup>®</sup> Fax Note	7671	Date	5/22/03	# of Pages	1
To	Karen Duany		From	Ken Levinsky	
Co./Dept.			Co.	Beth El	
Phone #			Phone #	774-2649	
Fax #	874-8716		Fax #	774-7515	

office@templebethel-maine.org    www.templebethel-maine.org

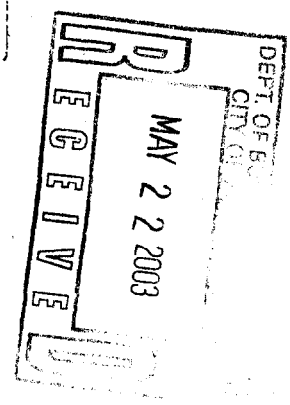

**Temple Beth-El  
Shapell Bar Mitzvah  
Memorial Weekend**

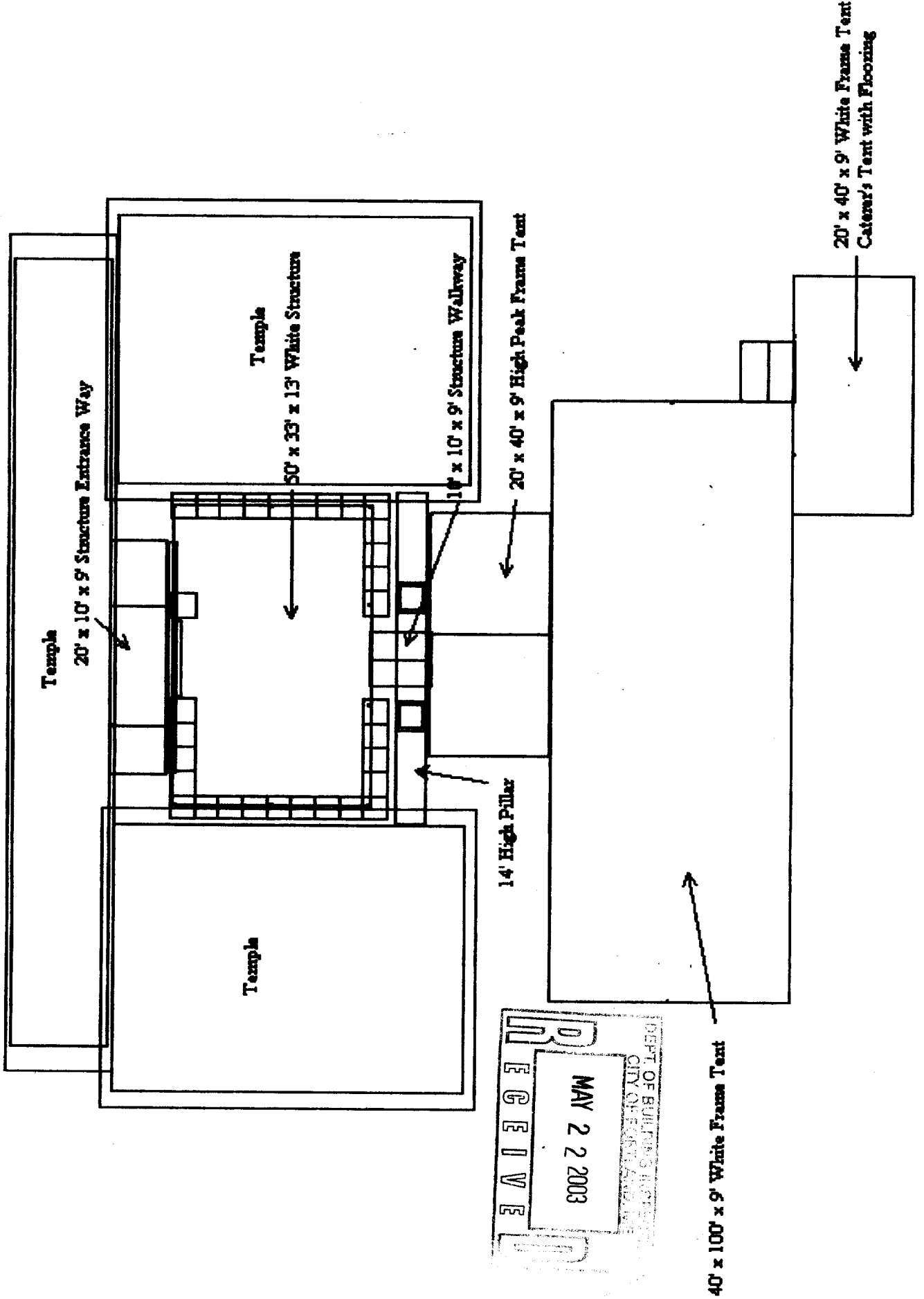

# LEAVITT & PARRIS, INC.

ESTABLISHED 1919

AWNINGS  
PORCH CURTAINS  
TARPAULINS  
BOAT COVERS  
TRUCK COVERS  
SALES  
CUSHIONS

AWNINGS, TENTS AND CANVAS PRODUCTS  
FOR HOME, INDUSTRY AND MARINE

256 READ STREET  
PORTLAND, MAINE 04103  
(207) 797-0100  
1-800-833-6679  
FAX 797-4194

TENTS, CANOPIES,  
ALL ACCESSORIES  
RENTED FOR  
WEDDINGS AND  
ALL OCCASSIONS

5/22/03

To whom it may concern:

This is to certify that the tents supplied to Temple Beth El/Shapell  
are certified flame resistance that meets the requirements of the  
California Fire Marshall, Underwriters Laboratory Test Flamibility  
354-H and Government Spec. CCC-C-428A.

Very truly yours,

Leavitt & Parris, Inc.

*John H. Hutchins, III*

John H. Hutchins, III  
President

