

Lenny,

I am reviewing the plans submitted for 257 Brighton Avenue and have the following plan review comments:

- Provide emergency escape and rescue opening per R310 for habitable attics.
- Clarify what the existing conditions are for the exterior walls and ceilings in the attic space. What is the existing insulation for the walls and ceilings? Provide R value for proposed insulation. *No Existing Insulation, wall + ceilings will be 2x6 Frame*
- Provide proposed GWB on walls and ceiling. *1/2 inch Gyp Board*
- Provide stair rise and run of existing stairs to attic space per R311.7.4. *7 3/4 x 10*
- Provide headroom of stairs to attic per R311.7.2. *71" existing, will be framed to 6'8"*
- Provide width of existing stair to attic space per R311.7. *35"*
- Provide handrail height and dimensions per R311.7.7. *None Existing new railing will comply*
- Provide CO and smoke alarms per R314 and R315. *They will be installed per code*
- Clarify the ceiling height throughout the entire attic space per R305.1.

*Existing 22" off floor
R38*

Ceilings throughout will be atleast 7' and over 50 percent of floor space

Please revise your floor plan clarifying the above items. Feel free to call or email if you have any questions.

Thanks,

ie

Leader
Review/Code Enforcement
Portland, Maine
Inspections Division
Congress Street
Portland, ME 04101

74-8714

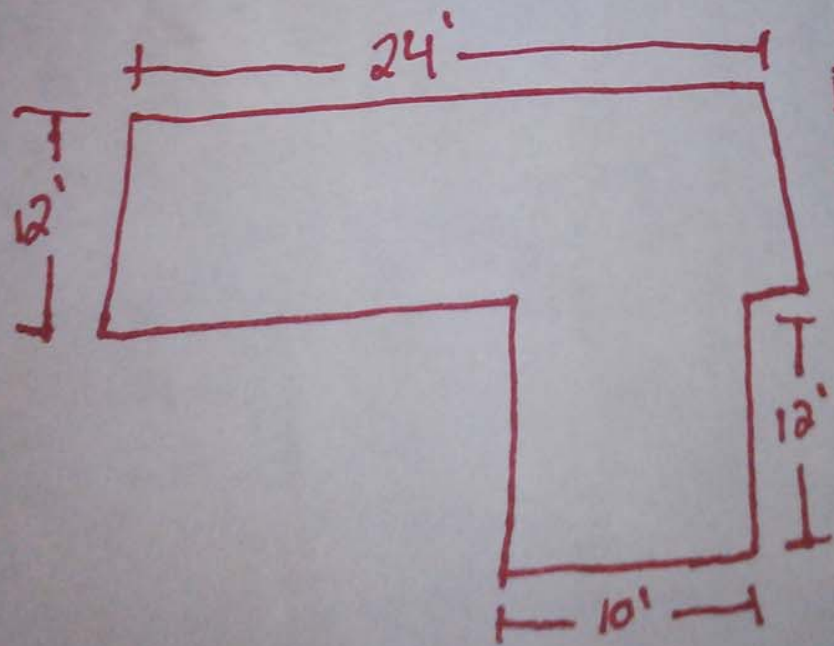

Dimensions from inside of knee walls.

65% of overall floor space will be over 7'