

THIS IS NOT A BOUNDARY SURVEY

MORTGAGE INSPECTION OF: DEED BOOK 16206 PAGE 179 COUNTY Cumberland
PLAN BOOK --- PAGE --- LOT ---

ADDRESS: 106 Dartmouth Street, Portland, Maine

Job Number: 388-02-R

Inspection Date: 08-18-04

Scale: 1" = 20'

Client File#: R-JACOBSKY.A

Buyers: Bridget A. &
Anthony M. Jacobsky, Jr.

Sellers: G. Edward &
Rebekah S. Drysdale

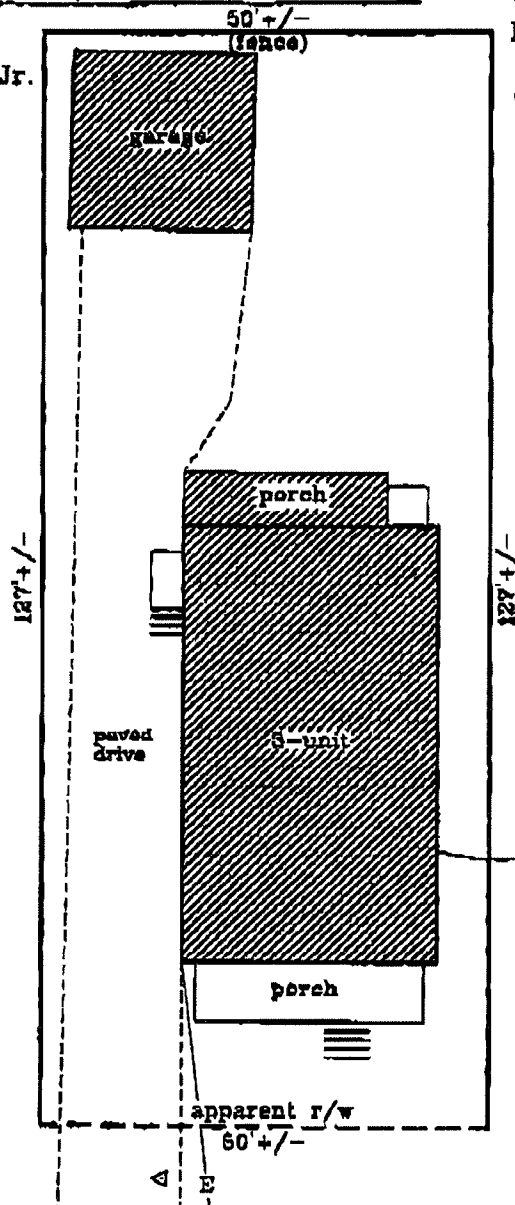

Notes:
Lines of occupation
are shown.
A boundary survey
may yield different
results.

Diene Watson
775-0135

[Handwritten signature] Dartmouth St. to Forest Ave.

I HEREBY CERTIFY TO: Hopkinson, Abbondanza & Backer,
The Lender, and its title insurer.

- Monuments found did not conflict with the deed description.
- The dwelling setbacks do not violate town zoning requirements.
- As delineated on the Federal Emergency Management Agency Community Panel: 230051-0013 B
- The structure does not fall within the special flood hazard zone.
- The land does not fall within the special flood hazard zone.

APPARENT EASEMENTS AND RIGHTS OF WAY ARE SHOWN. OTHER ENCUMBRANCES, RECORDED OR NOT, MAY EXIST. THIS SKETCH WILL NOT REVEAL ABUTTING DEED CONFLICTS, IF ANY.

Livingston - Hughes
Professional Land Surveyors
88 Guinea Road
Kennebunkport - Maine 04046
207-967-8761 phone 207-987-4881 fax