

63 William St - Chart 117 Block D Lot 021.

Basement.

Original scale 1" = 5' (dimensions below in feet; one large block = 5')

Boiler will be hung on "east" wall of existing boiler room

Boiler room constructed with cinder block revetment 6" high, stud-and-drywall construction. This room was constructed under a previous owner and was originally intended to be a fire barrier. However, insufficient air was supplied to the existing boiler, so additional inlet vents were added and the room is piped with its own sprinkler system.

Boiler room is vented to window immediately below this text as shown.

Boiler gas supply will be tapped from gas supply to existing boiler approximately as shown

Boiler vent will go to boarded window as shown

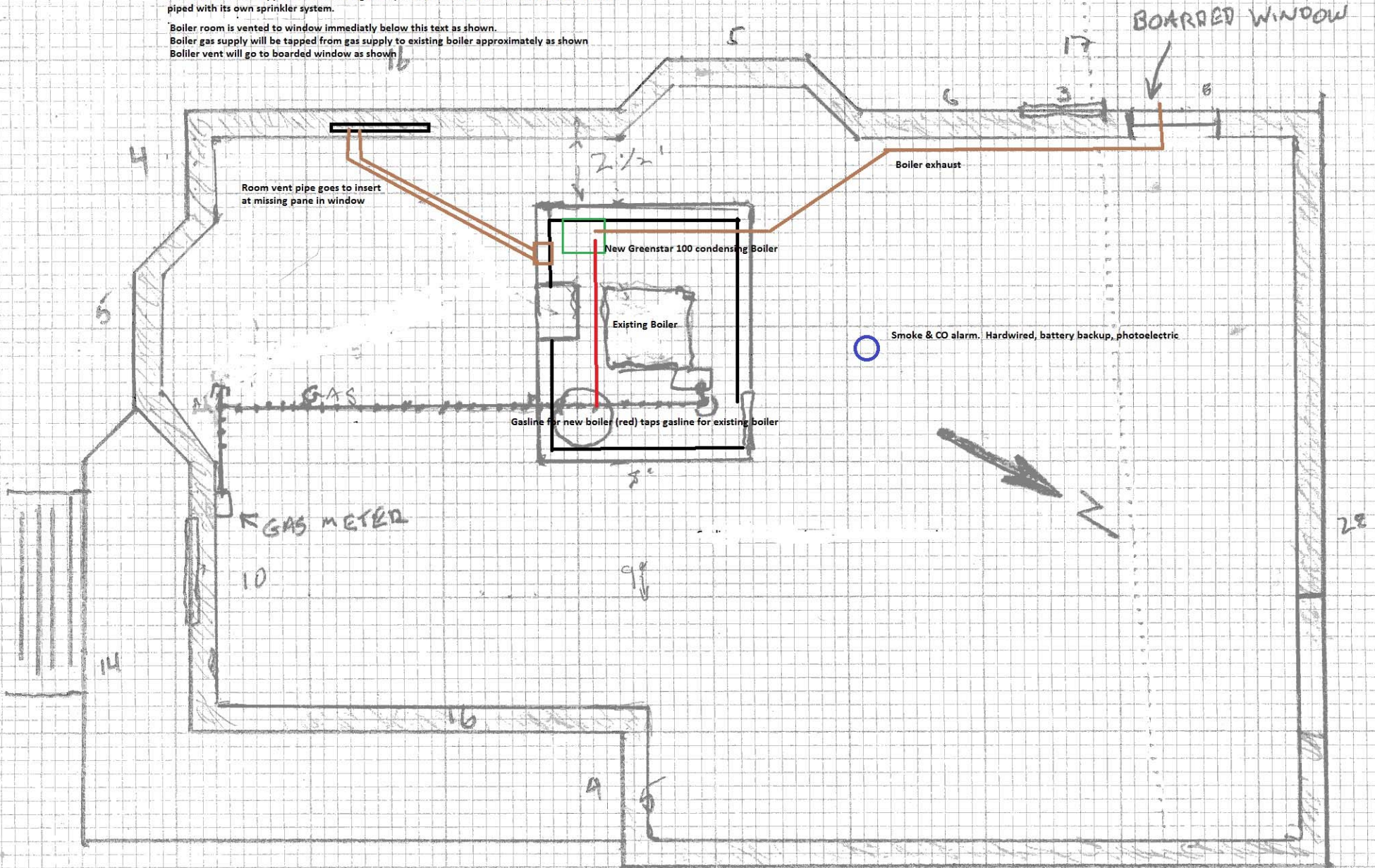

20

26