

PERMIT ISSUED

City of Portland, Maine - Building or Use Permit Application

389 Congress Street, 04101 Tel: (207) 874-8703, Fax: (207) 874-8716

Permit No: 03-1316	Issue Date: OCT 23 2003	CBL: 117 B025001
-----------------------	-----------------------------------	---------------------

Location of Construction: 105 Fessenden St	Owner Name: Brennan Leonard J &	Owner Address: 105 Fessenden St CITY OF PORTLAND	Phone:
Business Name:	Contractor Name: Dupuis, Raymond	Contractor Address: Box 8119 Portland	Phone: 2077884901
Lessee/Buyer's Name	Phone:	Permit Type: Additions - Dwellings	Zone: R-5

Past Use: single family	Proposed Use: single family - rebuild 10' x 12' rear porch	Permit Fee: \$39.00	Cost of Work: \$1,500.00	CEO District: 2
		FIRE DEPT: <i>N/A</i> <input type="checkbox"/> Approved <input type="checkbox"/> Denied	INSPECTION: Use Group: R-3 Type: SB BOCA 99	

Proposed Project Description:
rebuild 10' x 12' rear porch

Signature: _____

Signature: _____

PEDESTRIAN ACTIVITIES DISTRICT (P.A.D.)

Action: Approved Approved w/Conditions Denied

Signature: _____ Date: _____

Permit Taken By: tmm	Date Applied For: 10/23/2003	Zoning Approval	
-------------------------	---------------------------------	------------------------	--

- This permit application does not preclude the Applicant(s) from meeting applicable State and Federal Rules.
- Building permits do not include plumbing, septic or electrical work.
- Building permits are void if work is not started within six (6) months of the date of issuance. False information may invalidate a building permit and stop all work..

<p>Special Zone or Reviews</p> <input type="checkbox"/> Shoreland <input type="checkbox"/> Wetland <input type="checkbox"/> Flood Zone <input type="checkbox"/> Subdivision <input type="checkbox"/> Site Plan Maj <input type="checkbox"/> Minor <input type="checkbox"/> MM <input type="checkbox"/> Date: 10/23/03	<p>Zoning Appeal</p> <input type="checkbox"/> Variance <input type="checkbox"/> Miscellaneous <input type="checkbox"/> Conditional Use <input type="checkbox"/> Interpretation <input type="checkbox"/> Approved <input type="checkbox"/> Denied Date: _____	<p>Historic Preservation</p> <input checked="" type="checkbox"/> Not in District or Landmark <input type="checkbox"/> Does Not Require Review <input type="checkbox"/> Requires Review <input type="checkbox"/> Approved <input type="checkbox"/> Approved w/Conditions <input type="checkbox"/> Denied Date: 10/23/03
---	---	--

PERMIT ISSUED

OCT 23 2003

CITY OF PORTLAND

CERTIFICATION

I hereby certify that I am the owner of record of the named property, or that the proposed work is authorized by the owner of record and that I have been authorized by the owner to make this application as his authorized agent and I agree to conform to all applicable laws of this jurisdiction. In addition, if a permit for work described in the application is issued, I certify that the code official's authorized representative shall have the authority to enter all areas covered by such permit at any reasonable hour to enforce the provision of the code(s) applicable to such permit.

SIGNATURE OF APPLICANT _____ ADDRESS _____ DATE _____ PHONE _____

RESPONSIBLE PERSON IN CHARGE OF WORK, TITLE _____ DATE _____ PHONE _____

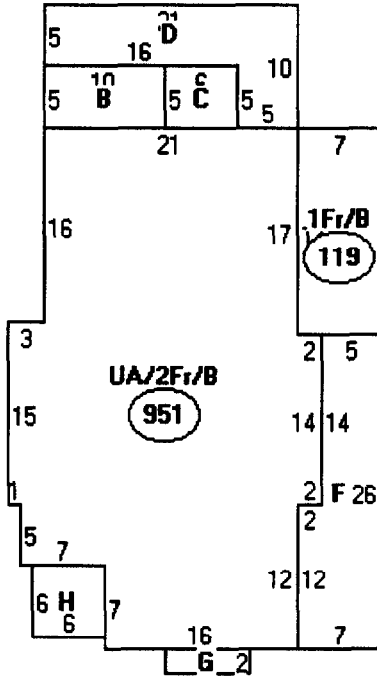

Descriptor/Area

- A:UA/2Fr/B
951 sqft
- B:EP/1Fr/B
50 sqft
- C:EP/WD
30 sqft
- D:EP
130 sqft
- E:1Fr/B
119 sqft
- F:QFP
154 sqft
- G:FBAY/B
14 sqft
- H:QFP
36 sqft

R-S

1484

6501
x .4

2632
- 1484

1148 left
- 360 garage

788 left ok

R-S
Front - rear 20'
Sides - 8'

This page contains a detailed description of the Parcel ID you selected. Press the **New Search** button at the bottom of the screen to submit a new query.

Current Owner Information

Card Number	1 of 1
Parcel ID	117 B025001
Location	105 FESSENDEN ST
Land Use	SINGLE FAMILY
Owner Address	BRENNAN LEONARD J & SUSAN H JTS 105 FESSENDEN ST PORTLAND ME 04103
Book/Page	
Legal	117-8-25 FESSENDEN ST 103-105 6561 SF

Valuation Information

Land	Building	Total
\$31,290	\$111,200	\$142,490

Property Information

Year Built 1895	Style Old Style	Story Height 2	Sq. Ft. 2085	Total Acres 0.151		
Bedrooms 5	Full Baths 2	Half Baths	Total Rooms 10	Attic Unfin	Basement Full	

Outbuildings

Type GARAGE-WD/CB	Quantity 1	Year Built 1948	Size 18X20	Grade C	Condition A
-----------------------------	----------------------	---------------------------	----------------------	-------------------	-----------------------

Sales Information

Date	Type	Price	Book/Page
-------------	-------------	--------------	------------------

Picture and Sketch

<u>Picture</u>	<u>Sketch</u>
--------------------------------	-------------------------------

[Click here](#) to view Tax Roll Information.

Any information concerning tax payments should be directed to the Treasury office at 874-8490 or [e-mailed](#).



DISPLAY THIS CARD ON PRINCIPAL FRONTAGE OF WORK CITY OF PORTLAND

BUILDING INSPECTION

PERMIT

Permit Number: 031316

Please Read
Application And
Notes, If Any,
Attached

This is to certify that Brennan Leonard J &/Dupuis Raymond

has permission to rebuild 10' x 12' rear porch

AT 105 Fessenden St 117 B025001

provided that the person or persons, firm or corporation accepting this permit shall comply with all of the provisions of the Statutes of Maine and of the Ordinances of the City of Portland regulating the construction, maintenance and use of buildings and structures, and of the application on file in this department.

Apply to Public Works for street line and grade if nature of work requires such information.

Notification inspection must given and when permission procured before this building or part thereof laid or otherwise used-in. **NO OTHER NOTICES REQUIRED.**

A certificate of occupancy must be procured by owner before this building or part thereof is occupied.

OTHER REQUIRED APPROVALS

Fire Dept. **PERMIT ISSUED**

Health Dept. _____

Appeal Board **OCT 23 2003**

Other _____

Department Name

CITY OF PORTLAND

PENALTY FOR REMOVING THIS CARD

[Handwritten Signature]
Director - Building & Inspection Services

Sue + Leonard Brennan
 105 Fessenden

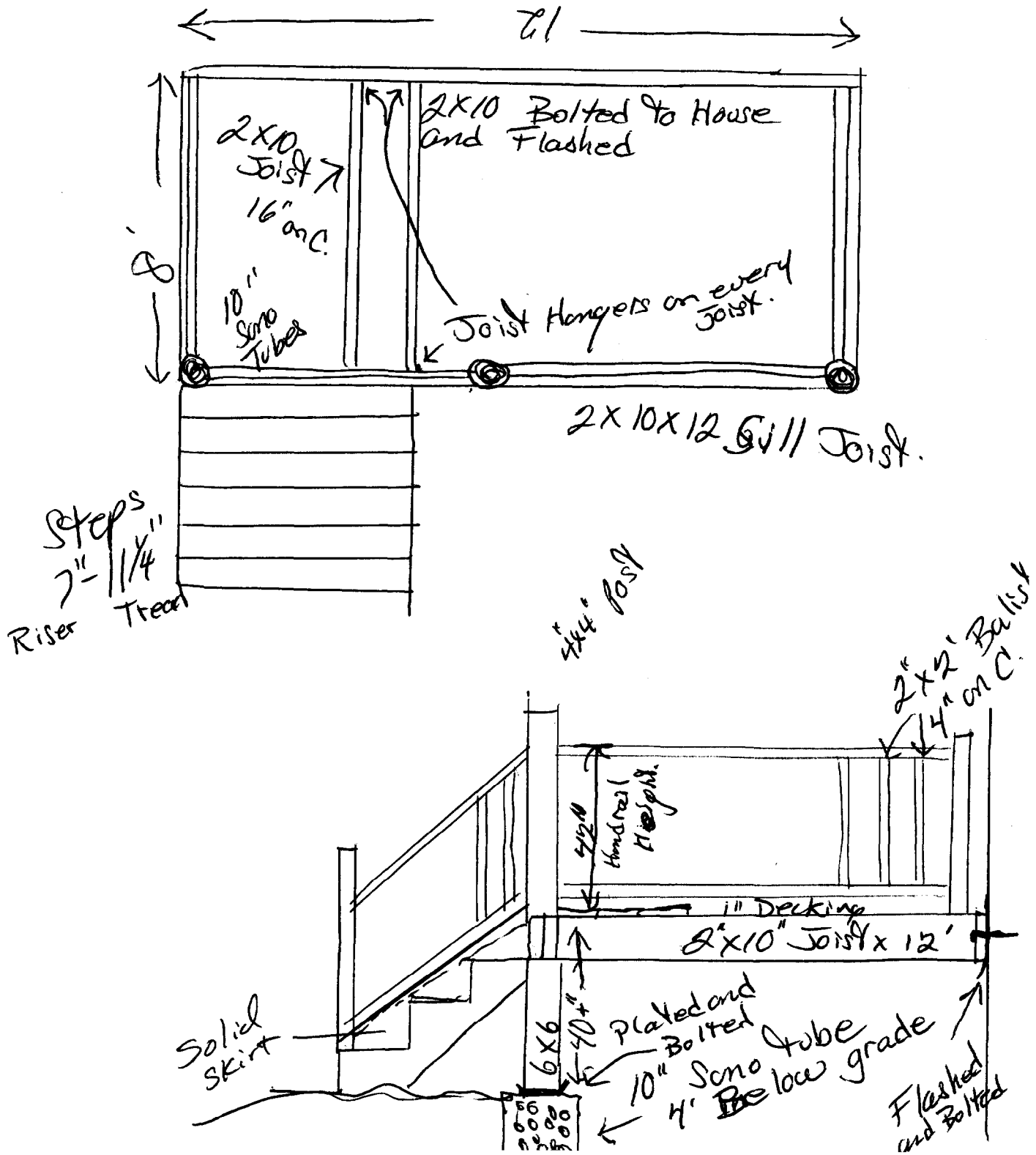

BUILDING PERMIT INSPECTION PROCEDURES

Please call 874-8703 or 874-8693 to schedule your inspections as agreed upon

Permits expire in 6 months, if the project is not started or ceases for 6 months.

The Owner or their designee is required to notify the inspections office for the following inspections and provide adequate notice. Notice must be called in 48-72 hours in advance in order to schedule an inspection:

By initialzing at each inspection time, you are agreeing that you understand the inspection procedure and additional fees from a "Stop Work Order" and "Stop Work Order Release" will be incurred if the procedure is not followed as stated below.

_____ **Pre-construction Meeting:** Must be scheduled with your inspection team upon receipt of this permit. Jay Reynolds, Development Review Coordinator at 874-8632 must also be contacted at this time, before any site work begins on any project other than single family additions or alterations.

_____ **Footing/Building Location Inspection:** Prior to pouring concrete

_____ **Re-Bar Schedule Inspection:** Prior to pouring concrete

_____ **Foundation Inspection:** Prior to placing ANY backfill

Framing/Rough Plumbing/Electrical: Prior to any insulating or drywalling

Final/Certificate of Occupancy: Prior to any occupancy of the structure or use. NOTE: There is a \$75.00 fee per inspection at this point.

Certificate of Occupancy is not required for certain projects. Your inspector can advise you if your project requires a Certificate of Occupancy. All projects DO require a final inspection

_____ **If any of the inspections do not occur, the project cannot go on to the next phase, REGARDLESS OF THE NOTICE OR CIRCUMSTANCES.**

CERIFICATE OF OCCUPANICES MUST BE ISSUED AND PAID FOR, BEFORE THE SPACE MAY BE OCCUPIED

[Signature]
Signature of applicant/designee

Date

10/23/03
Date

Signature of Inspections Official

CBL: 117-B-25 Building Permit #: 031314