

DOOR SCHEDULE

ABBREVIATIONS

ALUM	ALUMINUM	SS	STAINLESS STEEL
BLKD	BLACK	TH	THERMAL INSULATED
EMC	ELECTRO-MAGNETIC SHIELD OTHER	V	VENEER
FR	FLAME RESISTANT	W	WOOD
GL	GLASS	WO	WOOD
GLS	GLASS	WM	WOOD
HAL	HOLLOW METAL		
INSUL	INSULATED		

NO.	TYPE	SIZE (WxH)	THK	INSUL	HDWE	FR	GLASS		REMARKS	FRAMES		THRESHOLDS	
							TYPE	SIZE		TYPE	FR	PROFILE	MATERIAL
101	C	3070	1 3/4"	YES	HW-1	NO	---	---	---	MTL	NO	MTL	---
102	A	3070	1 3/4"	NO	HW-1	20mm	---	---	---	MTL	20mm	MTL	---
								min R-VALUE 17.50					

- NOTES
1. ALL RATED DOORS TO HAVE CLOSERS
 2. ALL INTERIOR DOORS TO BE SOLID CORE WOOD COMPOSITE WITH WOOD CASINGS. SIZE AND SWING AS NOTED ON THE FLOOR PLANS

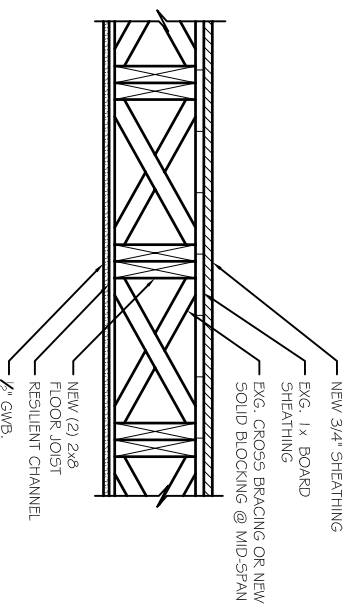

UL DESIGN L502
1 HR FLOOR CEILING ASSEMBLY

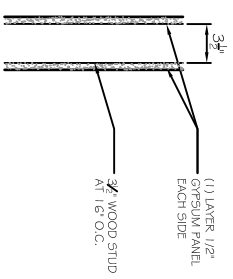

UL DESIGN: U 317 FIRE CAULK PERIMETER
3/4 HOUR INTERIOR WALL

DOOR TYPES

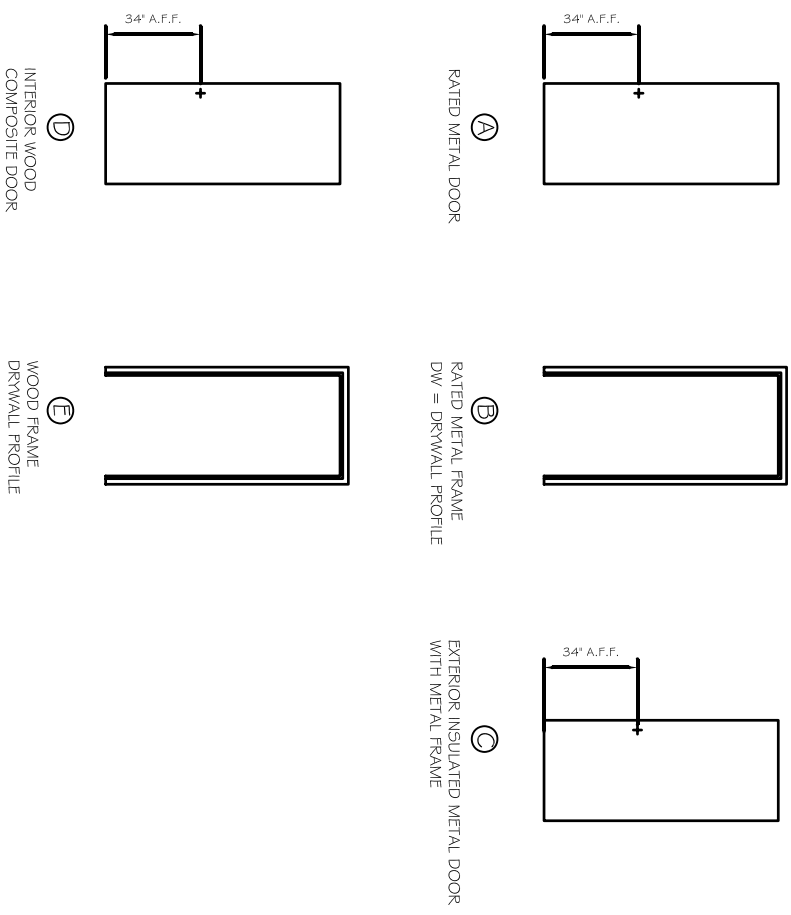

- | | |
|------|----------------------------------------------------------------------------------------------|
| HW-1 | BUTTS; CLOSER; LEVER EXIT FUNCTION; THRESHOLD; WEATHER STRIPPING; LOCKSET; DOOR BOTTOM/SWEEP |
| HW-2 | BUTTS; LEVER PASSAGE FUNCTION LATCHSET; SILENCERS |
| HW-3 | BUTTS; CLOSER; LEVER EXIT FUNCTION (PANIC DEVICE) LOCKSET; SILENCERS |
| HW-4 | BUTTS; CLOSER; PUSH/PULL UNIT; SILENCERS |
| HW-5 | BUTTS; CLOSER; EXIT FUNCTION LEVER LOCKSET; SILENCERS |
| HW-6 | BUTTS; LEVER PRIVACY LOCKSET; SILENCERS |
| HW-7 | BUTTS; LEVER OFFICE FUNCTION LOCKSET; SILENCERS |
| HW-8 | BUTTS; LEVER PASSAGE FUNCTION LATCHSET; CLOSER; SILENCERS |

HARDWARE SETS

NO	BY	DESCRIPTION	DATE
1			
2			
3			

PROJECT: **BOLES RESIDENCE**
 PORTLAND, MAINE
 FOR: ELIAS BOLES

SHEET TITLE:
DOOR SCHEDULE AND DETAILS
 ISSUED FOR PERMITTING

THESE DRAWINGS, SPECIFICATIONS AND SCHEDULES ARE THE PROPERTY OF ASSOCIATED DESIGN PARTNERS, INC. AND ARE NOT TO BE REPRODUCED OR TRANSMITTED IN ANY FORM OR BY ANY MEANS, ELECTRONIC OR MECHANICAL, WITHOUT THE WRITTEN CONSENT OF ASSOCIATED DESIGN PARTNERS, INC.

ASSOCIATED DESIGN PARTNERS INC.

80 Leighton Road
 Falmouth, Maine 04105

Office: (207) 878-1751
 Fax: (207) 878-1788
 E-Mail: adp@adpengineering.com

DATE: 12/15/08
 SCALE: AS NOTED
 DESIGN BY: ASW
 DRAWN BY: RSC

FILE # 06095-ADP108
 PROJECT NUMBER:
06095
 SHEET NO.:
A601