

REBUILD STAIRS NOTES:

1. TOTAL FLOOR TO FLOOR RISE = 110", SO 110"/15 RISES = 7 $\frac{5}{8}$ "/RISE
2. EACH STAIR RUN = 10" TREAD DEPTH
3. 1.5" ROUND WOOD HANDRAIL TO BE CONTINUOUS ON INSIDE OF STAIRS, AND 35" ABOVE TREAD NOSING. 1.5" SPACING BETWEEN HANDRAIL AND WALL. MIN 31.5" CLEAR BETWEEN HANDRAIL AND OPPOSITE WALL.
4. 6'8 MIN HEADROOM ALONG LENGTH OF STAIRS
5. 3' CLEAR AT ALL POINTS OF STAIRS.
6. 2'6" DOOR OPENING AT BOTTOM OF STAIRS TO 2ND FLOOR HALLWAY (DOOR TO BE PERMANENTLY REMOVED FROM FRAME.
7. MAPLE TOPRAIL AND PAINTED WOOD BALLUSTERS TO MATCH EXISTING IN REST OF HOUSE. MAX 4" BALLUSTER SPACING. BALLUSTERS NOT TO ALLOW 4" SPHERE OPENINGS BETWEEN BALLUSTERS.
8. RAILING AND BALLUSTERS FORM AN OPEN BALLUSTRADE WITH A CURB.

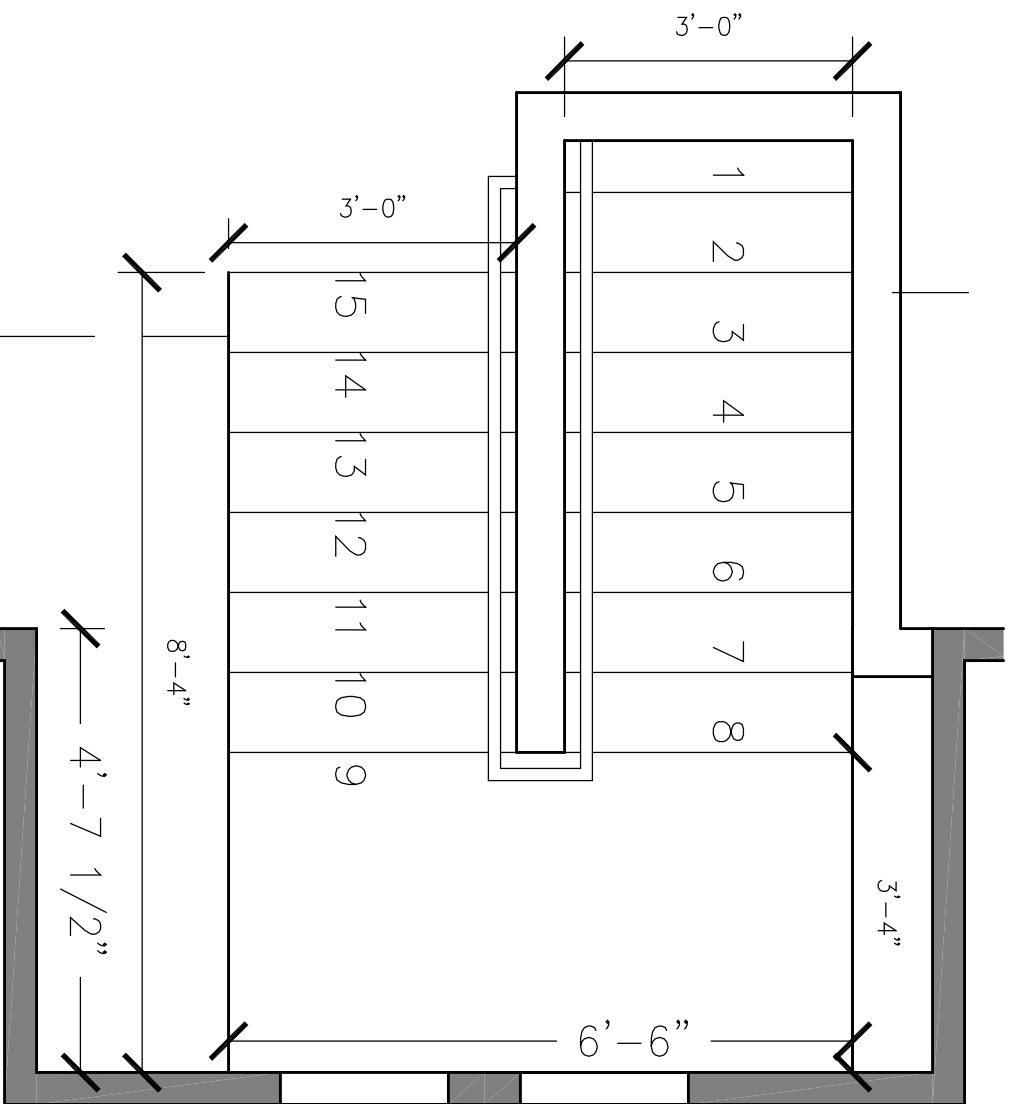

1	STAIRS PLAN
SCALE = 1/2" = 1'-0"	

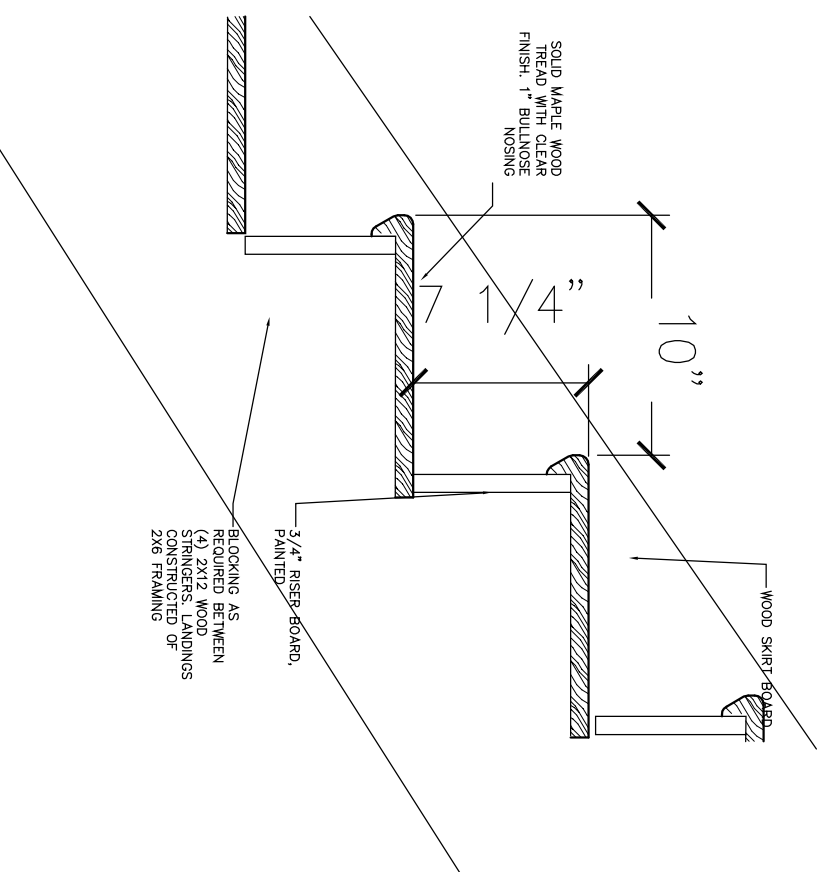

2	STAIRS DETAIL
SCALE = 1 1/2" = 1'-0"	

3RD FLOOR AND GARAGE ALTERATIONS
88 FESSENDEN STREET

PORTLAND, ME

TITLE:
STAIRS PLAN,
SECTION, AND
DETAILS

DATE:
08/28/16

ISSUED FOR:
PERMITTING

DATE:
A2.0